

Remove Ex. RCB, Lay RCB From R/W to R/W. & Const. Headwall & Wingwalls. (Hydraulic may be closed to traffic from 7:00am on day one until 5:00pm on day three.)

Type III w/ "Road Closed", "Local Traffic Only", and w/ "Detour"

Type III w/ "Road Closed", "Local Traffic Only", and w/ "Detour"

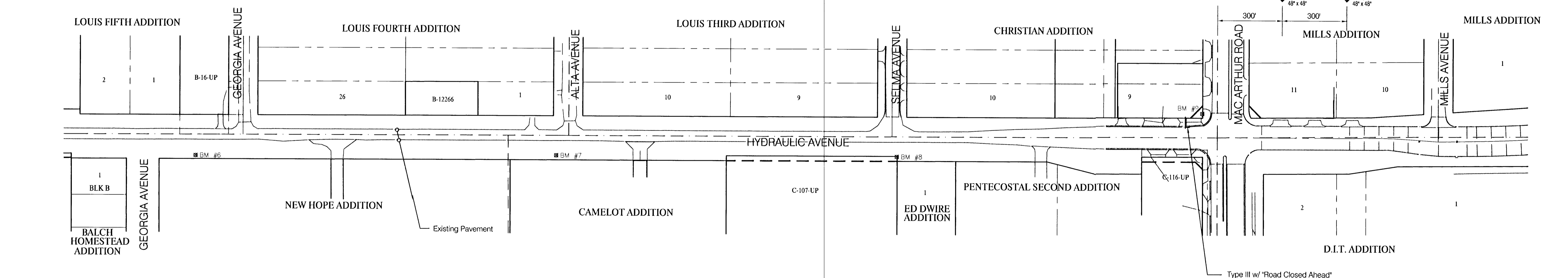
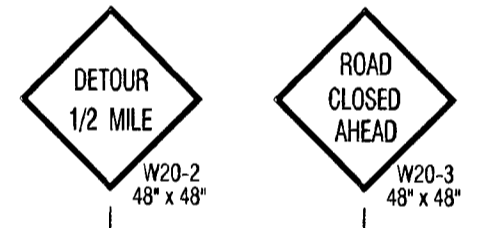

LEGEND	
	Work Area
	Temporary Pavement
	Traffic Sign
	Reflectorized Drum
	Tubular Marker
	Type III Barricade
	Temp Lane Markings (White)
	Temp Lane Markings (Yellow)
	Traffic Flow Pattern

PROJECT NUMBER 472-76-245-83324		SHEET NAME Traffic		ENGINEERING DIRECTORY E:\Hydraulic\Pond	
DESIGN JFB	DRAWN KWR	APPROVED JFB	DATE Sept 2001	SCALE Noted	BAUGHMAN NO 99-09-E453

CAPITAL IMPROVEMENT PROJECT  
**HYDRAULIC AVENUE**  
**TRAFFIC CONTROL**  
HYDRAULIC AVENUE PAVING - INCIDENTAL DRAINAGE PROJECT - PHASE 2

**BAUGHMAN COMPANY, P.A.**  
ENGINEERING, SURVEYING, & PLANNING  
316-262-7271 • 315 ELLIS • WICHITA, KANSAS 67211

SHEET  
30  
OF  
47

F:\Eng\Hydraulic\Pond\Traffic-tyler.dwg Tue Sep 18 11:32:52 2001