

**BENCHMARK:**

- BM #1 - City of Wichita bench Mark Disc on signal pole base 40.4' south and 57.5' East of centerlines of Hydraulic & 47th St. South. Sta. 115+07.4, 57.5' Rt. Elev. = 84.99 (City Datum)
- BM #2 - RR Spike in West face of HLP, East side of Hydraulic, South of Fernwood and North of 46th St. South. Sta. 122+83, 41' Rt. Elev. = 85.33 (City Datum)
- BM #3 - RR Spike in West face of HLP, East side of Hydraulic, North of 45th St South, North of the Mobile home Park Entrance. Sta. 131+21, 41' Rt. Elev. = 82.72 (City Datum)
- BM #4 - RR Spike in West face of 2nd HLP, South of 43rd St. South, East side of Hydraulic. Sta. 136+57, 41' Rt. Elev. = 82.34 (City Datum)

- BM #5 - City of Wichita Bench Mark Disc, 35' South and 25' East of Centerlines Hydraulic and 43rd St. South. Sta. 141+72.24, 25' Rt. Elev. = 82.13 (City Datum)
- BM #6 - RR Spike in West face of HLP, East side of Hydraulic, South of Georgia St. Sta. 147+70, 43' Rt. Elev. 84.51 (City Datum)
- BM #7 - RR Spike in West face of HLP, East side of Hydraulic, South of Alta Street. Sta. 155+07, 41' Rt. Elev. = 86.12 (City Datum)
- BM #8 - RR Spike in West face of HLP, East side of Hydraulic, at the Centerline of Selma St. Sta. 162+06, 41' Rt. Elev. = 89.66 (City Datum)
- BM #9 - City of Wichita Bench Mark Disc, 48.6' South and 32.4' West of Centerlines Hydraulic and Mac Arthur Sta. 168+35.3, 32.4' Rt. Elev. = 86.98 (City Datum)

# HYDRAULIC AVENUE STREET & SWS IMPROVEMENTS KEY SHEET

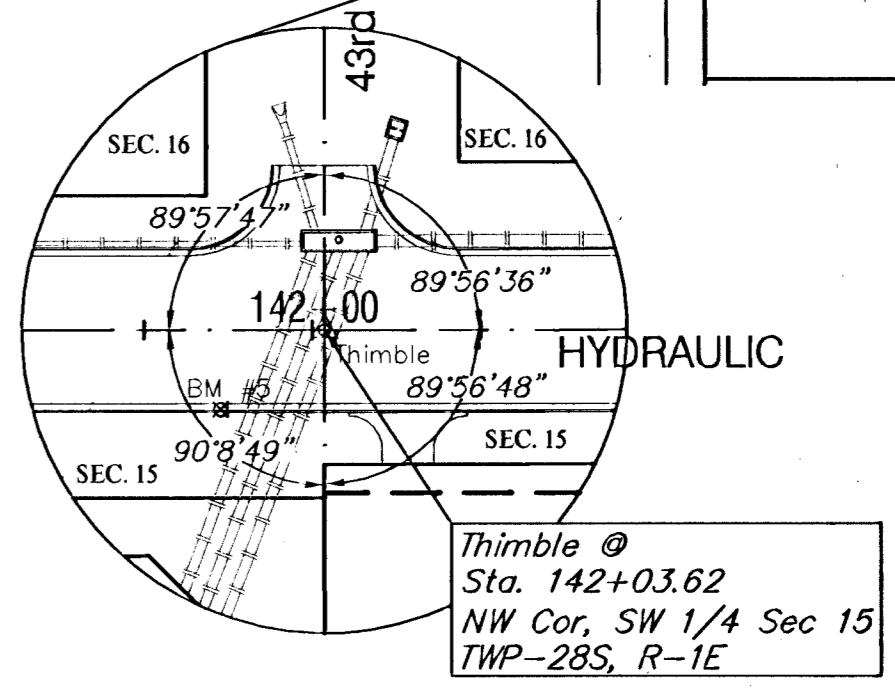
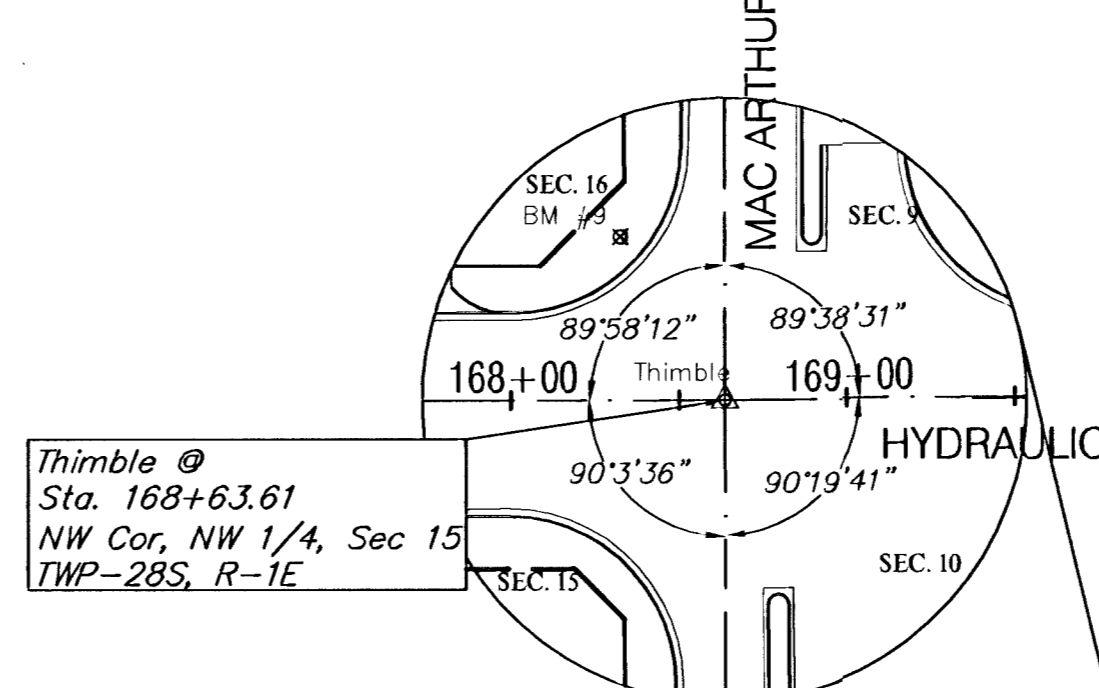
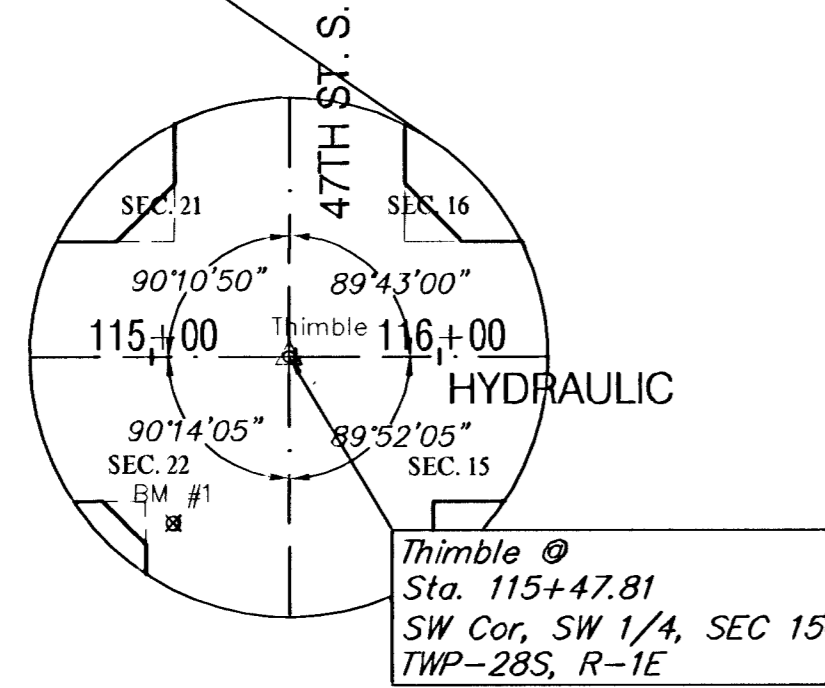
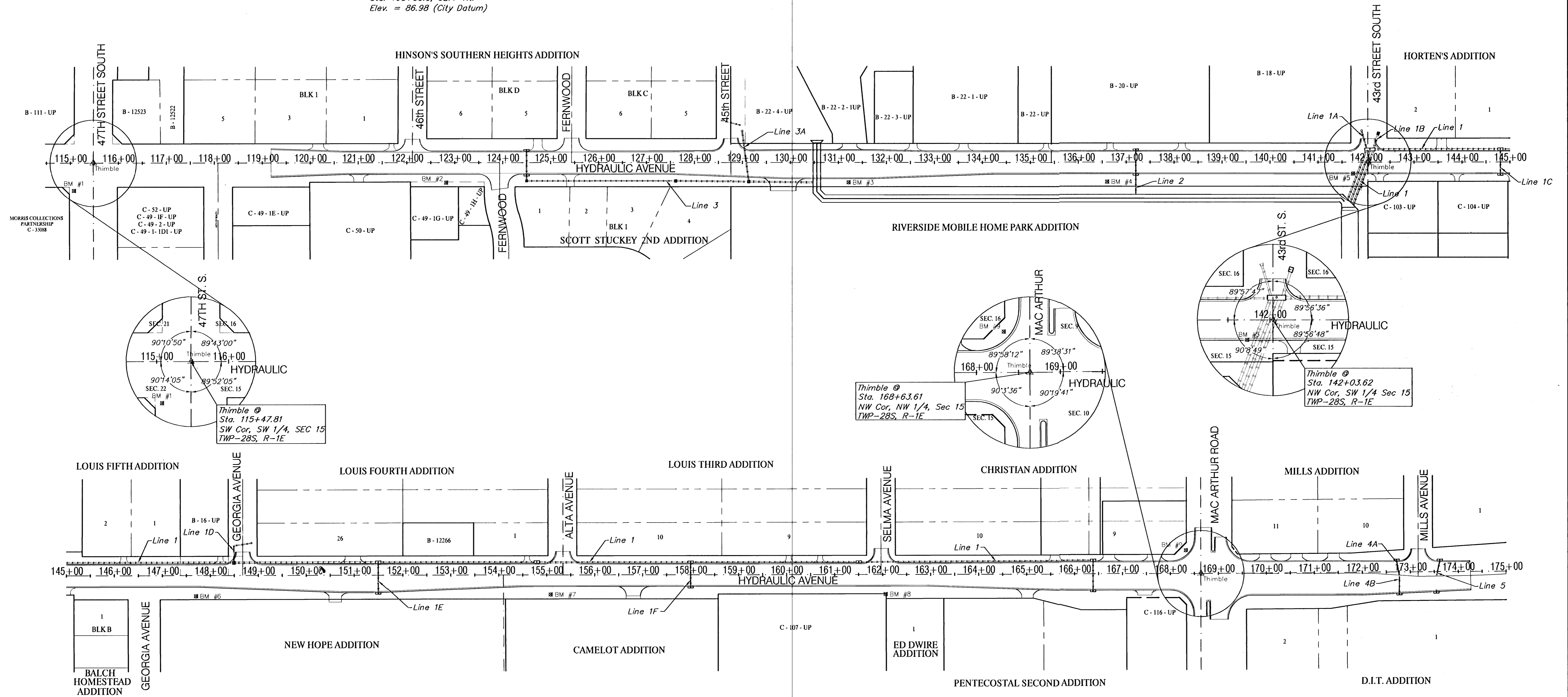
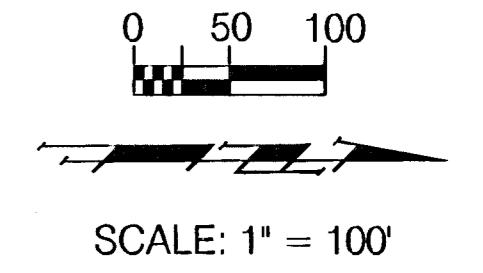

PROJECT NUMBER 472-76-245-83324			SHEET NAME Keysheet		ENGINEERING DIRECTORY F:EngHydraulic		CAPITAL IMPROVEMENT PROJECT <b>HYDRAULIC AVENUE</b> KEY SHEET <small>HYDRAULIC AVENUE PAVING - 47th STREET SOUTH TO MACARTHUR ROAD</small>			<b>BAUGHMAN COMPANY, P.A.</b> ENGINEERING, SURVEYING, & PLANNING <small>316-262-7271 • 315 ELLIS • WICHITA, KANSAS 67211</small>		SHEET 2
DESIGN JFB	DRAWN KWR	APPROVED JFB	DATE Sept. 2002	SCALE Noted	BAUGHMAN NO 99-09-E450							-OF 102