

**BENCHMARK:**

BM #7 - RR Spike in West face of HLP, East side of Hydraulic,  
South of Alta Street, Sta. 155+07, 41' Rt.  
Elev. = 86.12 (City Datum)

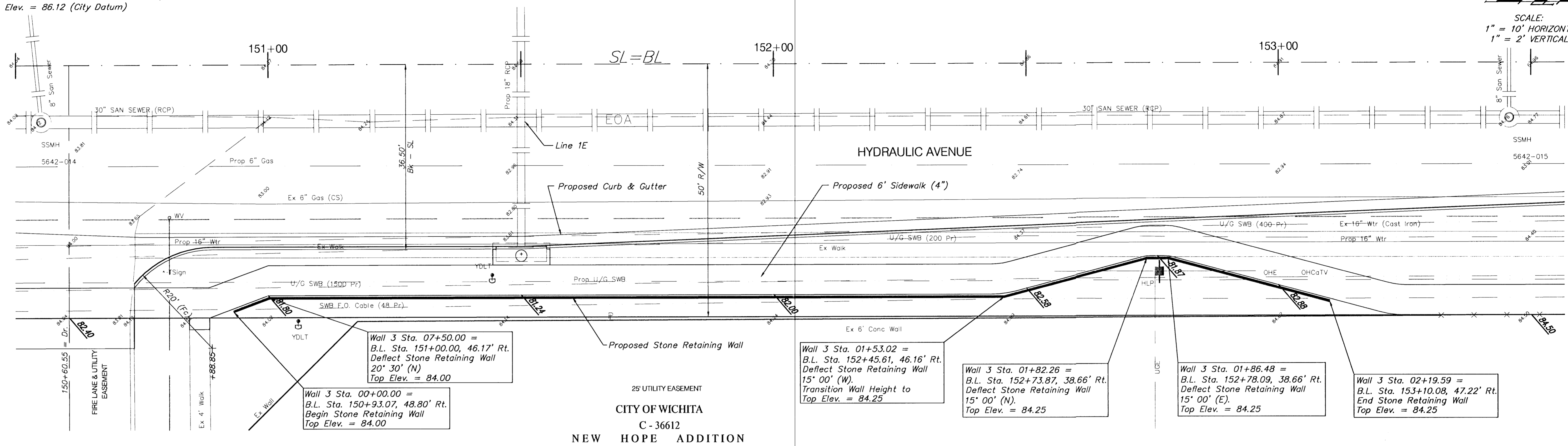

25' UTILITY EASEMENT  
**CITY OF WICHITA**  
C - 36612  
**NEW HOPE ADDITION**

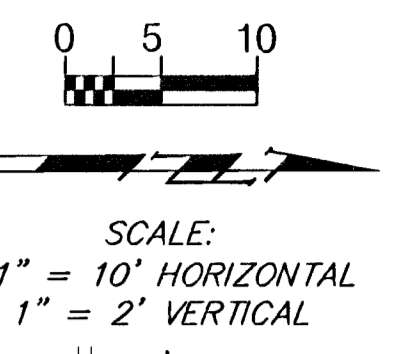
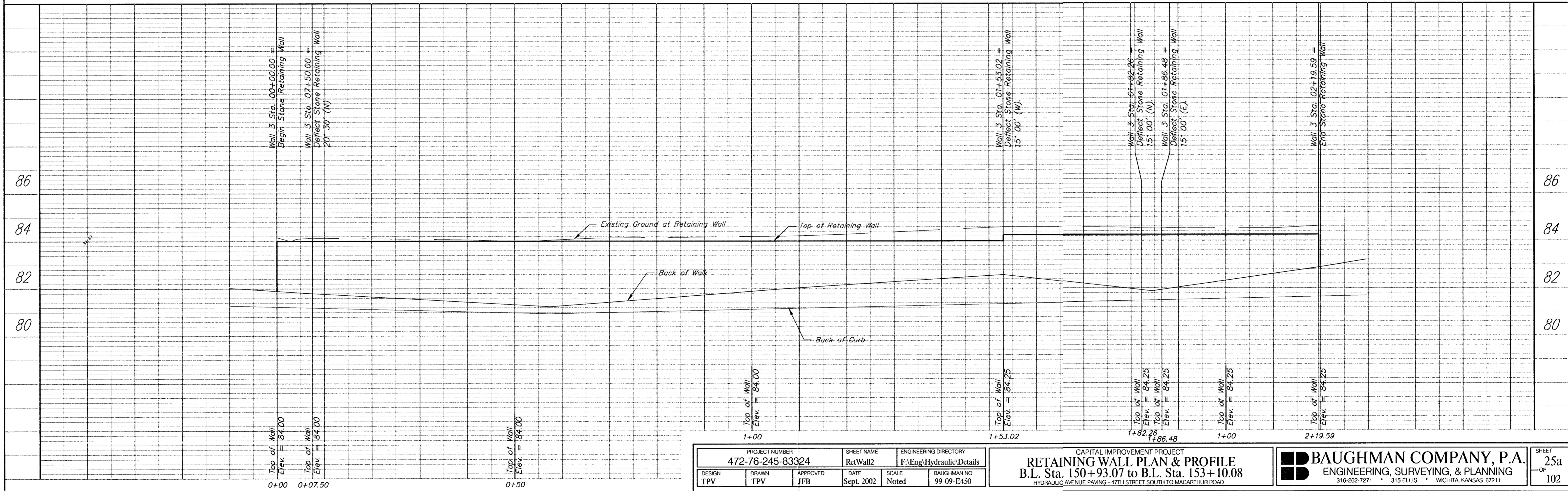

PROJECT NUMBER <b>472-76-245-83324</b>		SHEET NAME <b>RetWall2</b>		ENGINEERING DIRECTORY <b>F:\Eng\Hydraulic\Details</b>	
DESIGN TPV	DRAWN TPV	APPROVED JFB	DATE Sept. 2002	SCALE Noted	BAUGHMAN NO 99-09-E450
CAPITAL IMPROVEMENT PROJECT <b>RETAINING WALL PLAN &amp; PROFILE</b> B.L. Sta. 150+93.07 to B.L. Sta. 153+10.08 HYDRAULIC AVENUE PAVING - 47TH STREET SOUTH TO MACARTHUR ROAD				<b>BAUGHMAN COMPANY, P.A.</b> ENGINEERING, SURVEYING, & PLANNING 316-262-7271 • 315 ELLIS • WICHITA, KANSAS 67211	