

SCALE:
1" = 20' HORIZONTAL
1" = 5' VERTICAL

JERRY & LINDA
HANSEN
B - 12208
Part of Lot 9
Asphalt

GLADYS MORRIS, et al
C - 116 - UP
Asph Prkng

BENCHMARK:
BM #8 - RR Spike in West face of HLP, East side of Hydraulic, C - 39462
at the Centerline of Selma St. Sta. 162+06, 41' Rt.
Elev. = 89.66 (City Datum)
BM #9 - City of Wichita Bench Mark Disc, 48.6' South and
32.4' West of Centerlines Hydraulic and Mac Arthur
Sta. 168+35.3, 32.4' Rt.
Elev. = 86.98 (City Datum)

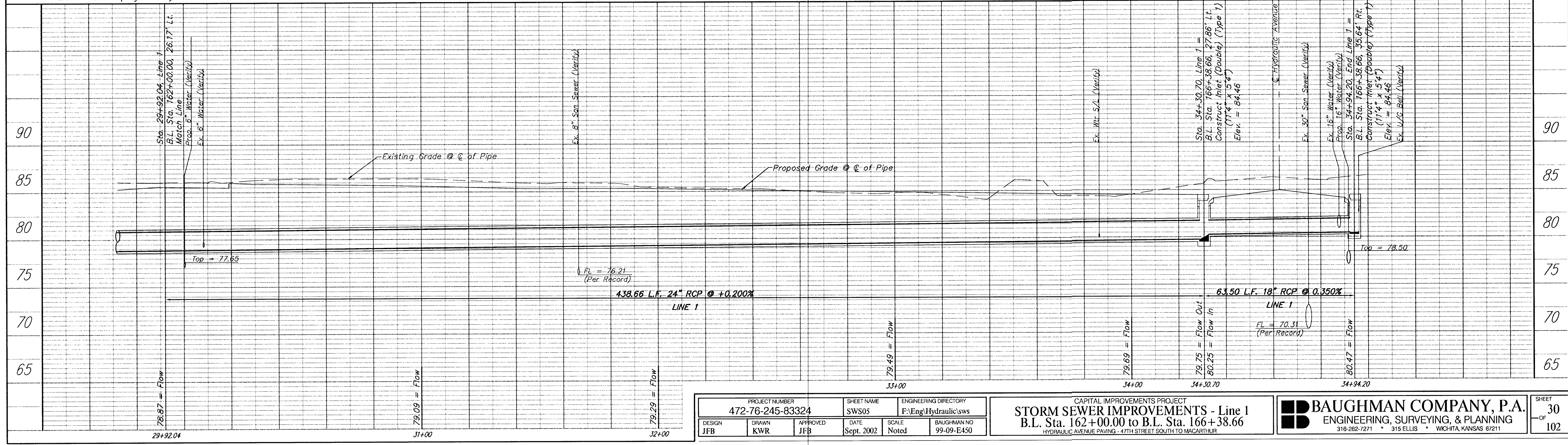

| | | | | | | | | | | |
|------------------------------------|--------------|---------------------|--------------------|---|---------------------------|--|--|---|--|--------------------------|
| PROJECT NUMBER 472-76-245-83324 | | SHEET NAME SWS05 | | ENGINEERING DIRECTORY F:EngHydraulic/sws | | CAPITAL IMPROVEMENTS PROJECT STORM SEWER IMPROVEMENTS - Line 1 B.L. Sta. 162+00.00 to B.L. Sta. 166+38.66 HYDRAULIC AVENUE PAVING - 4TH STREET SOUTH TO MACARTHUR | | BAUGHMAN COMPANY, P.A. ENGINEERING, SURVEYING, & PLANNING 316-262-7271 • 315 ELLIS • WICHITA, KANSAS 67211 | | SHEET OF 30 102 |
| DESIGN JFB | DRAWN KWR | APPROVED JFB | DATE Sept. 2002 | SCALE Noted | BAUGHMAN NO 99-09-E430 | | | | | |