

JOHN C. II & DIANA M.  
VAN VESSUM  
B - 12205  
Part of Lot 8

B - 12207  
Part of Lot 9  
SPEED LIMIT 40  
R2-1  
24\"/>

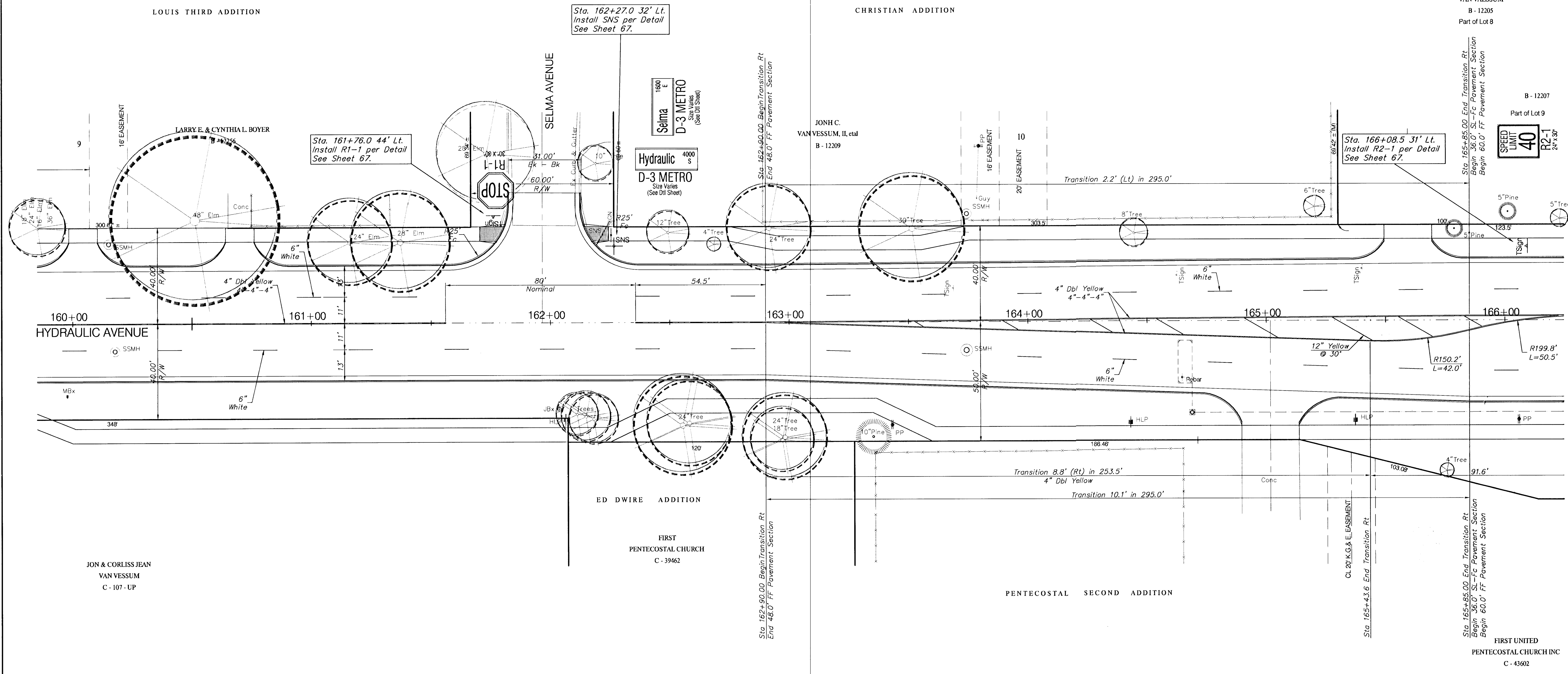

JON & CORLISS JEAN  
VAN VESSUM  
C - 107 - UP

ED WIRE ADDITION  
FIRST  
PENTECOSTAL CHURCH  
C - 39462

PENTECOSTAL SECOND ADDITION

FIRST UNITED  
PENTECOSTAL CHURCH INC  
C - 43602

PROJECT NUMBER 472-76-245-83324		SHEET NAME MARK08		ENGINEERING DIRECTORY F:\Eng\Hydraulic\Traffic		CAPITAL IMPROVEMENT PROJECT <b>PAVEMENT MARKING PLAN</b> HYDRAULIC AVENUE PAVING - 47TH STREET SOUTH TO MACARTHUR ROAD		<b>BAUGHMAN COMPANY, P.A.</b> ENGINEERING, SURVEYING, & PLANNING 318-262-7271 • 315 ELLIS • WICHITA, KANSAS 67211	SHEET 64 OF 102
DESIGN JFB	DRAWN STAFF	APPROVED JFB	DATE Sept. 2002	SCALE Noted	BAUGHMAN NO 99-09-E450				