

⊙ Increase from 1'-9" to 2'-8 1/4" by 1/4" increments. Cut 4 ea. length.
 ** Increase from 2'-7" to 3'-3 1/4" by 3/4" increments. Cut 4 ea. length.
 † Increase from 1'-1 1/4" to 1'-8 3/4" by 1/4" increments. Cut 8 ea. length.

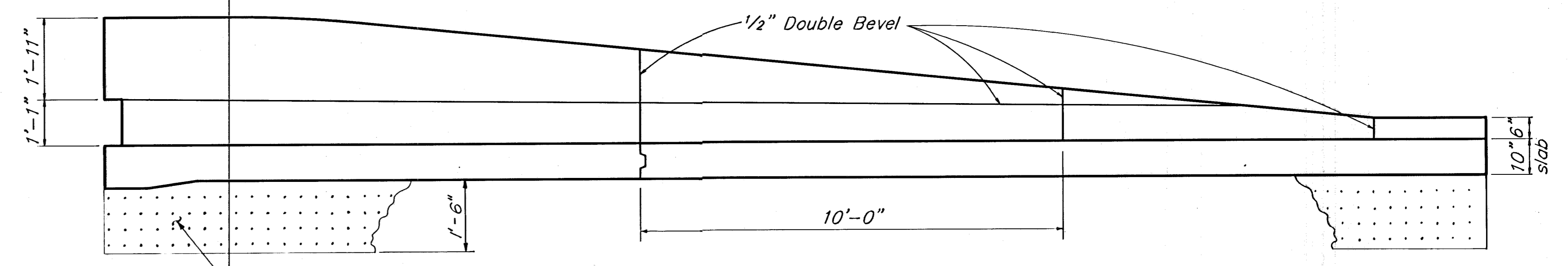

DOUBLE BEVEL LOCATION

BILL OF REINFORCING STEEL															
CONCRETE SAFETY BARRIER (2 THUS)								SPECIAL APPROACH SLAB (2 THUS)							
Straight Bars				Bent Bars				Straight Bars				Bent Bars			
Mark	Quan.	Size	Length	Mark	Quan.	Size	Length	Mark	Quan.	Size	Length	Mark	Quan.	Size	Length
a	12	5	*	b	13	5	15'-2"	RL3	12	6	12'-4"	RP3	16	5	4'-10"
a1	12	5	*	b1	21	5	14'-10"	RL4	12	6	11'-6"	RP4	16	7	6'-10"
a2	15	5	*	b2	17	5	14'-4"	h	14	6	2'-6"	RP5	24	5	*
a3	15	5	*	b3	54	5	11'-10"	i	1	6	17'-4"	RP6	24	7	*
c	9	5	14'-0"	b4	16	5	*	j	5	6	19'-8"	RC	28	5	*
c1	35	5	10'-8"	b5	12	5	*	RL5	4	6	11'-11"	RO3	36	3	5'-0"
c2	12	5	13'-2"	f	100	6	*	RL6	8	6	11'-6"	RP7	20	5	*
c3	13	5	13'-8"									RP8	20	7	*
c4	10	5	*												
c5	8	5	*												
e	36	6	3'-0"	* See bending diagram								* See bending diagram			
e1	56	4	3'-0"												
Reinforcing steel = 2,060 Lbs.								Reinforcing steel = 9,105 Lbs.							

Increase from 22'-0" to 29'-4" by 0'-8" inc.	a
Increase from 29'-8" to 37'-0" by 0'-8" inc.	a1
Increase from 12'-1" to 21'-5" by 0'-8" inc.	a2
Increase from 37'-6" to 46'-10" by 0'-8" inc.	a3

Cut 2 ea. length

7" hk.	14'-0"	7" hk. b
7" hk.	13'-8"	7" hk. b1
7" hk.	13'-2"	7" hk. b2
7" hk.	10'-8"	7" hk. b3
7" hk.	Increase from 2'-7" to 12'-6 5/8" by 1'-5 5/8" inc.	7" hk. † b4
7" hk.	Increase from 2'-1" to 9'-2 3/8" by 1'-5 5/8" inc.	7" hk. † b5

† Cut 4 ea. length

Increase from 2'-11 1/2" to 11'-6 1/2" by 2'-1 1/4" inc.	c4
Increase from 2'-1" to 8'-7" by 2'-2" inc.	c5

Cut 4 ea. length

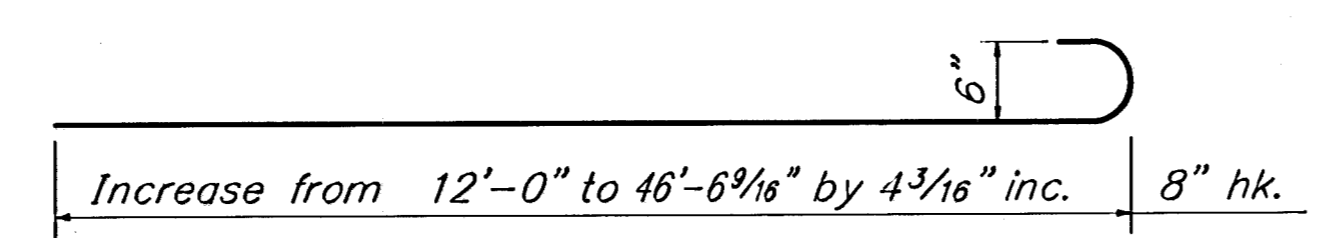

f bars

SUMMARY OF QUANTITIES (TOTAL)	
Concrete Pavement (Unif.) (AE)(10")	554 Sq. Yd.
Concrete Pavement (Unif.) (AE)(6")	60 Sq. Yd.
Concrete Safety Barrier (Special)(AE)	132 L.F.
⊗ Reinforcing Steel	22,330 Lbs.
⊗ Welded Wire Fabric 6x6-W2.9 x W2.9	230 Lbs.
⊗ Welded Wire Fabric 6x12-W4 x W4	780 Lbs.

⊗ Items are subsidiary to bid items "Concrete Pavement (10" Uniform)(AE)," "Concrete Safety Barrier (Special)(AE)" or "Concrete Pavement (6" Uniform)(AE)."

NOTE:
All dimensions in bending diagrams are out to out of bars.

SURV. PLOT CAD D.S. A.H./P. DR. A.H. TR. CKD. R.G. APP. S.K.B.

K9331/BEND01A
SCALE 1"=4'(1/4")

CITY OF WICHITA
 GEORGE WASHINGTON BLVD. BRIDGE
 OVER GYPSUM CREEK
**SPECIAL CONCRETE
 APPROACH II**
 CITY OF WICHITA PROJ. NO. 472-82156
Booker ASSOCIATES INC.
 OF KANSAS
 Wichita Kansas
 SCALE _____ DATE June, 1992 DWG. NO. K-9331