

SCALE 1"=10'

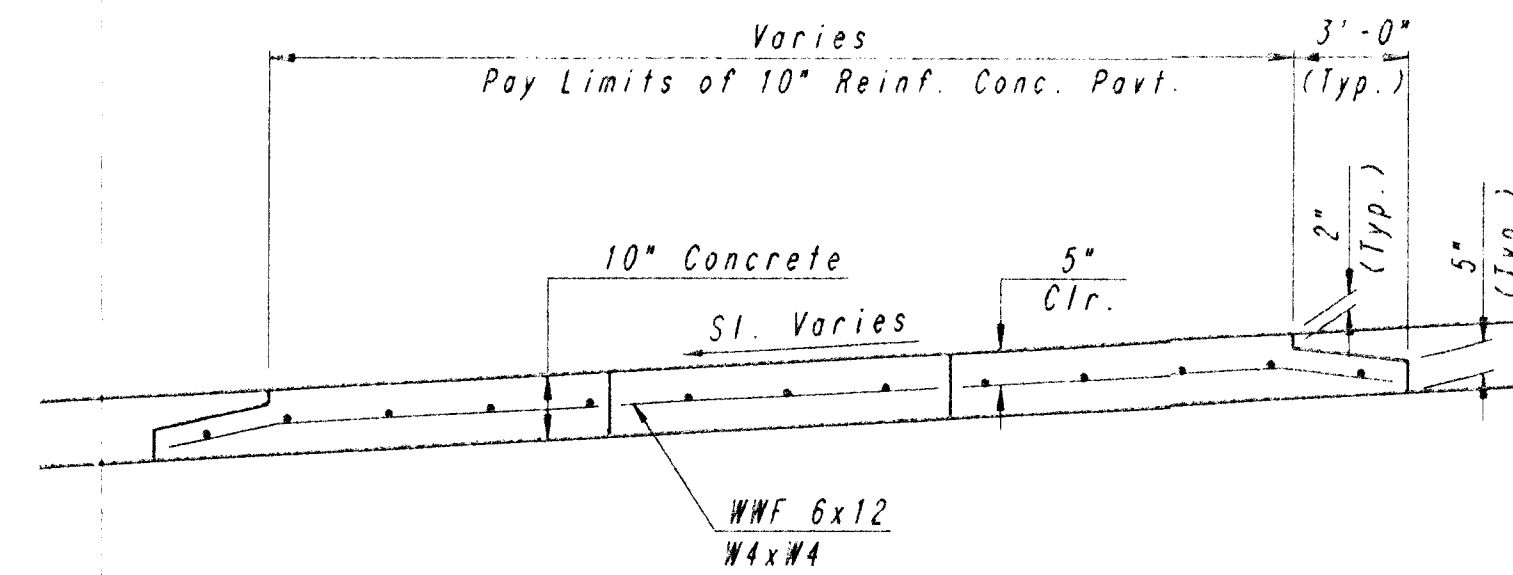
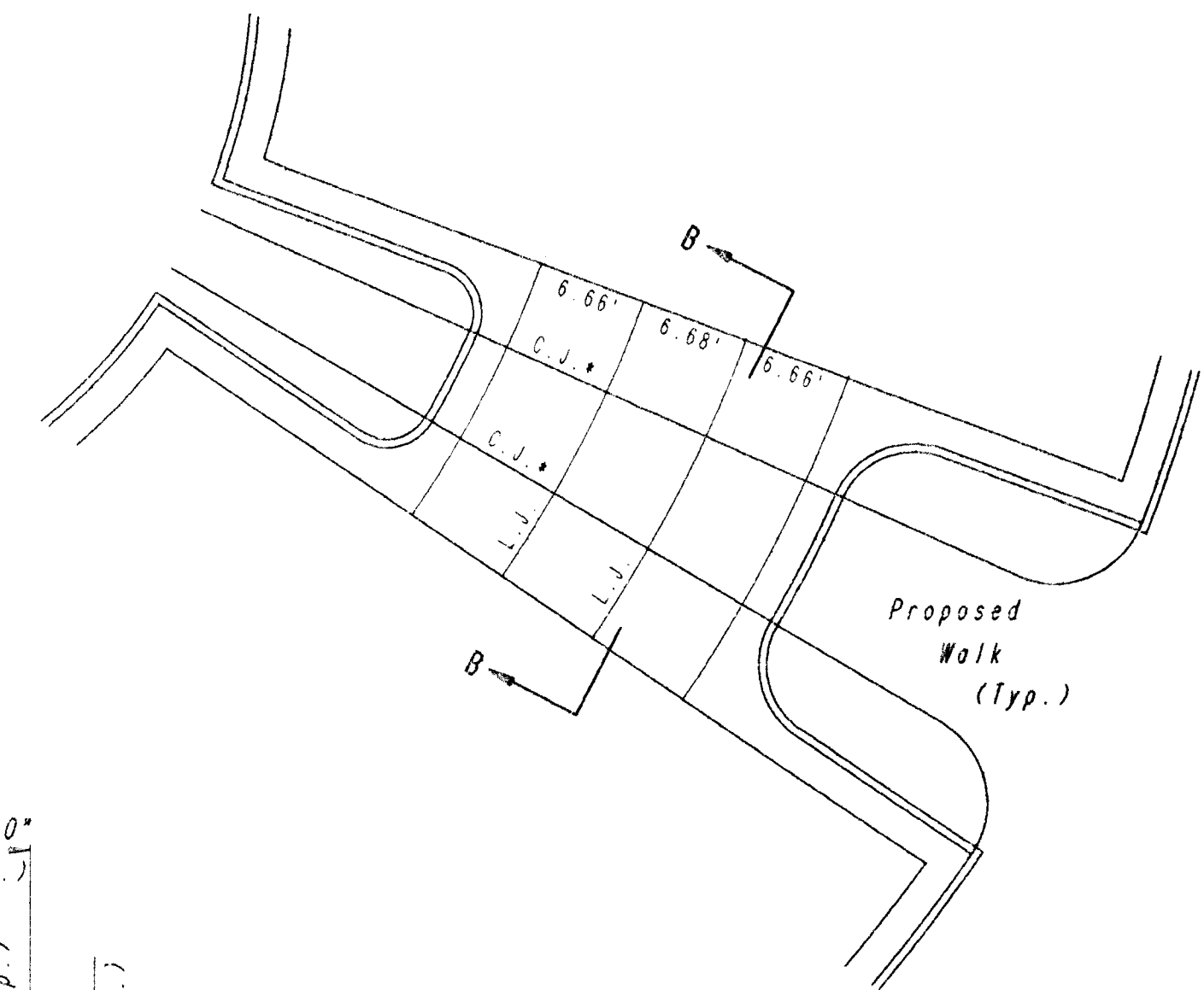
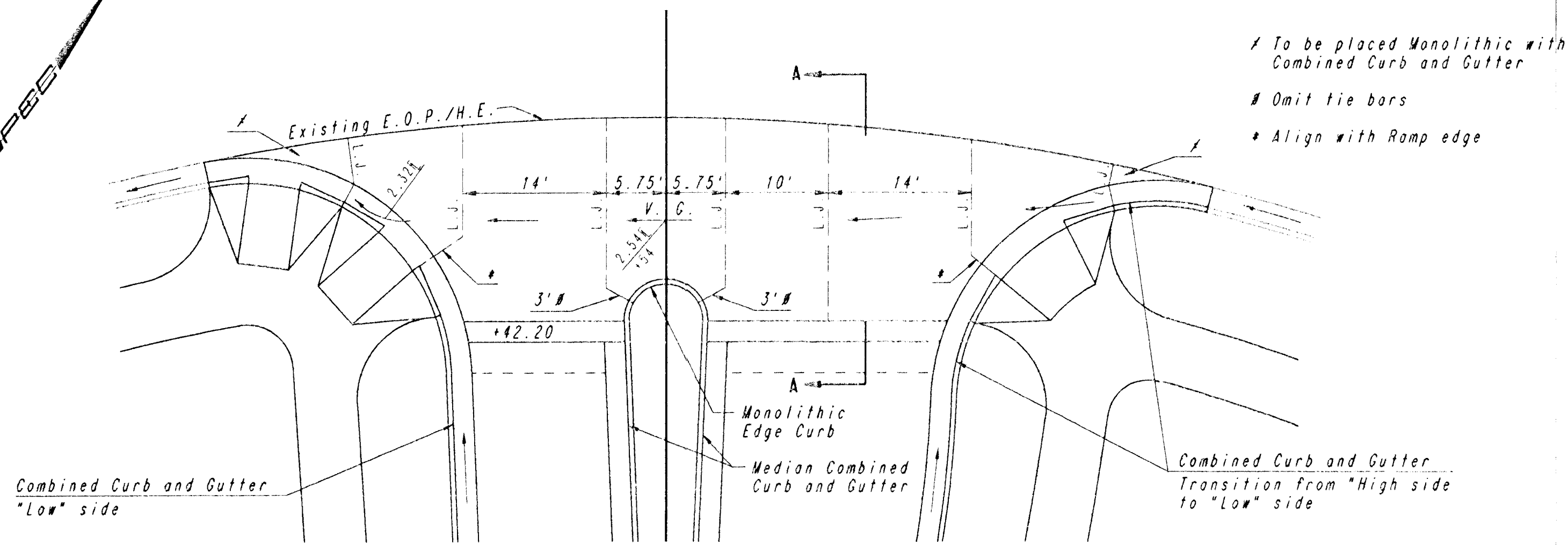

SECTION B-B

NOTE: OMIT REINFORCING MESH AT ALL JOINTS

NOTE: ALL CONCRETE VALLEY GUTTER REINFORCEMENT SHALL BE ADEQUATELY SUPPORTED BY BAR CHAIRS IN THE REQUIRED POSITION UNLESS APPROVED OTHERWISE BY THE ENGINEER.

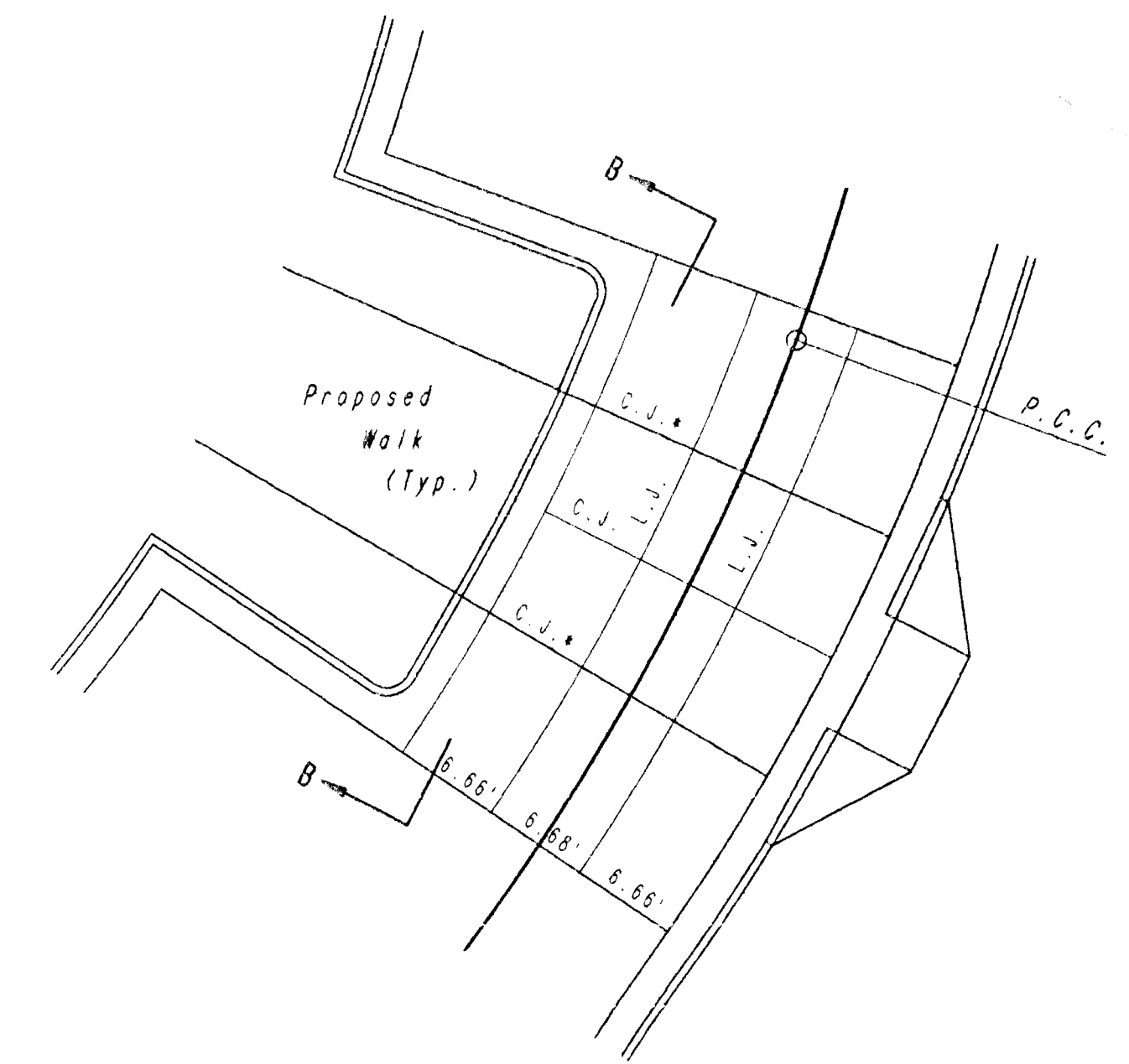

See Sh. No. P3 for additional Joint and Miscellaneous Details.

PLAN	SURVEYED	BY	DATE
NOTE: BOOM PLOTTED			
NO. _____			
RT. OF WAY CHECKED			

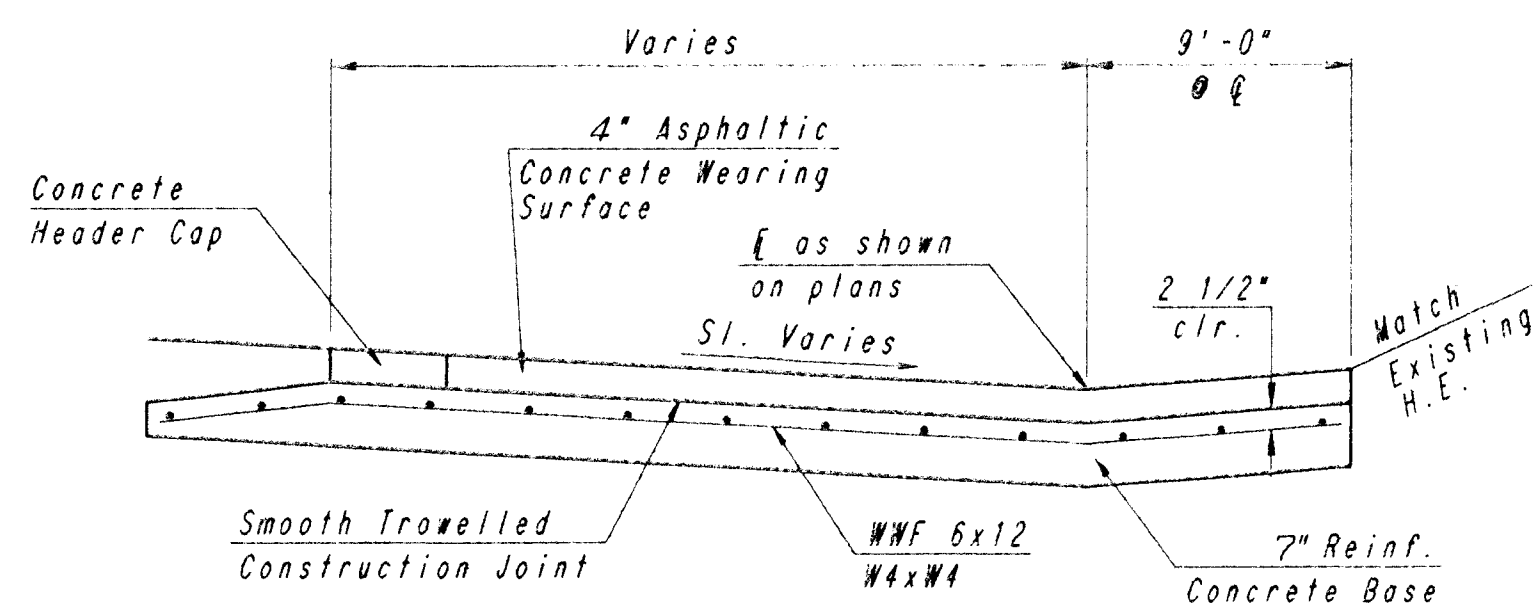

SECTION A-A

NOTE: OMIT REINFORCING MESH AT ALL JOINTS

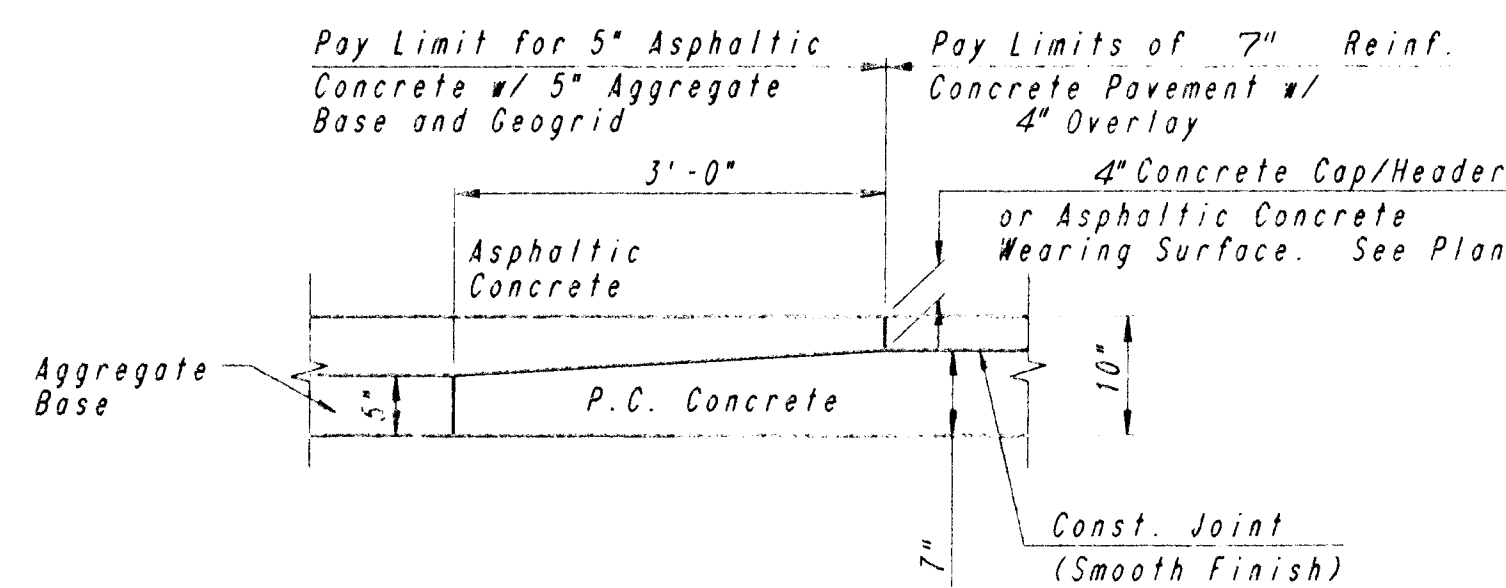

CONCRETE BASE FOR FUTURE BRICK CROSSWALK

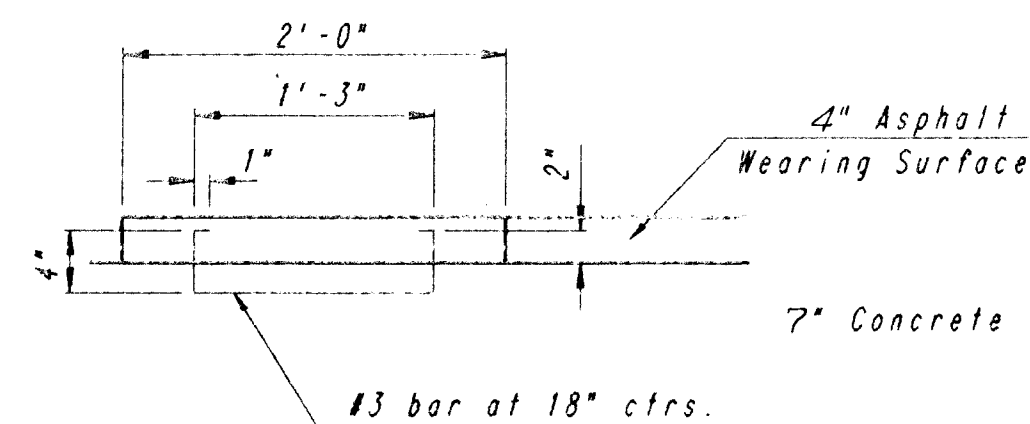

HEADER CAP DETAIL

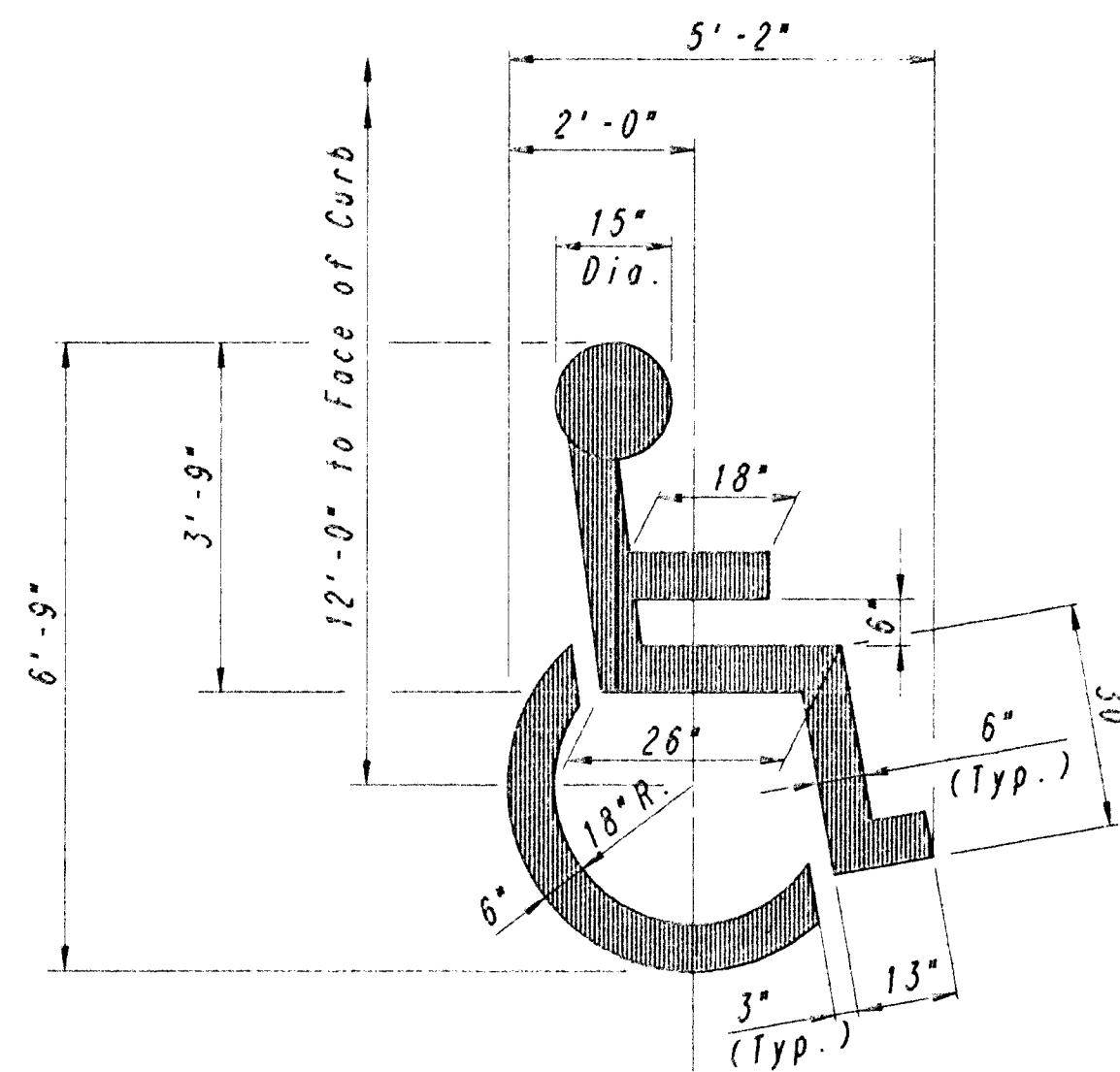

HANDICAP SYMBOL MARKING



R7-8 (12" x 18")

HANDICAPPED PARKING SIGN (One each required at each Parking Stall)

REV.	DATE	DESCRIPTION

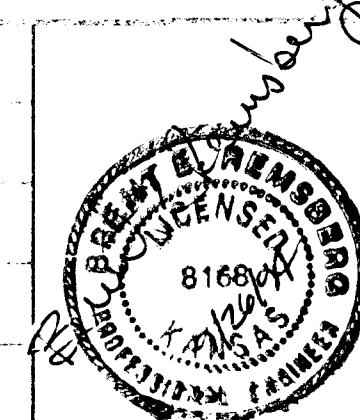

HELLMUTH, OBATA & KASSEBAUM, INC.  
DALLAS, TEXAS

PROFESSIONAL ENGINEERING  
CONSULTANTS, P.A.  
WICHITA, KANSAS

BRAD J. GOLDBERG  
DALLAS, TEXAS

MID-AMERICA  
ALL-INDIAN CENTER  
SITE IMPROVEMENTS  
CITY OF WICHITA, KANSAS

PAVEMENT DETAILS

PROJECT NO.	ISSUE DATE	SCALE NO SCALE	SHEET P4
-------------	------------	-------------------	-------------

DRAWING NAME: 36-52005 1C PAVT DTLS  
CITY OF WICHITA, KANSAS  
ROTATION ANGLE:  
DATE LAST WORKED ON: SEPT. 22, 1984  
BRENT REWBERG