

PLAN SURVEYED BY DATE
 NOTE BOOK PLOTTED ALIGNED CHECKED NO. OF SHEETS CHECKED REL. OF SHEETS CHECKED

DRAWING NAME: 36-92005 1C IF SGNL CONT.
 LOCATION: 36-92005 1C IF SGNL CONT.
 PROJECT: 36-92005 1C IF SGNL CONT.
 DATE LAST WORKED ON: SEPT. 1, 1984
 BENT REMSBERG

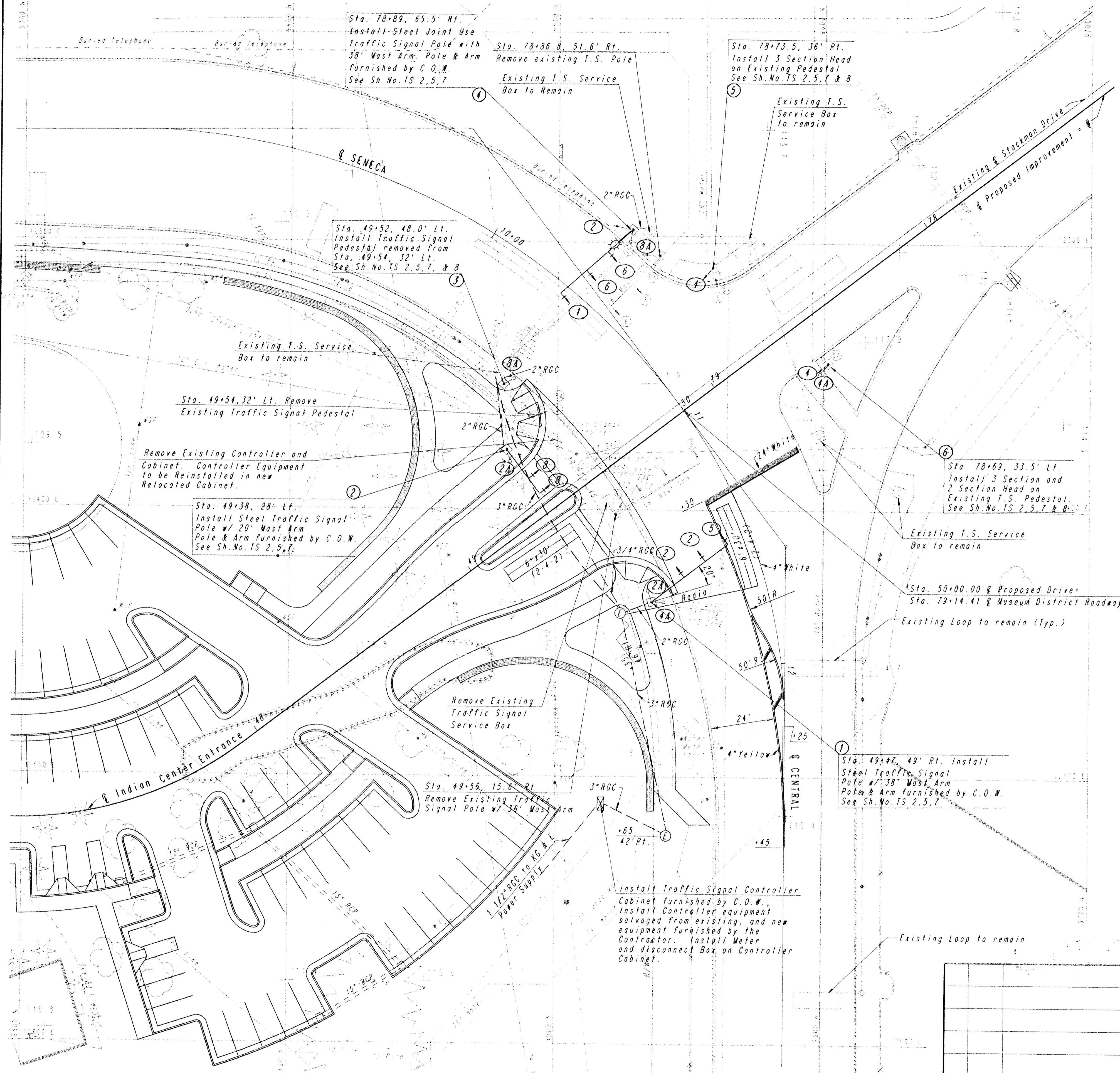

NOTE: The Contractor shall coordinate with K G & E on Lighting & Power Feed.

NOTE: Permanent pavement marking on Central shall be accomplished with cold plastic pavement marking material as specified in KDOT Sec. 2204, 1990 Ed.. Existing markings which conflict with the proposed markings shall be thoroughly removed. This work, along with the painting of parking lot pavement markings with Sherman Williams Baltimore Chemical Chlorinated Rubber Yellow Traffic Line paint, or approved equal, shall be measured & paid for at the lump sum price bid for "Pavement Marking". See Sh. No. P1 & 4 for layout data.

INTERVAL	PHASE								FEATURES										
	1	2	3	4	5	6	7	8	F										
MAX	30	80		30	30	80		30	VEH RECALL										
MAX 2	30	80		30	30	80		30	PED RECALL										
WALK				8				8	RED LOCK										
FLASH DW		10		10		10		10	YEL LOCK										
MAX. INITIAL	10.0	25		10.0	10.0	25		10.0	# PERMIT										
MIN. GREEN	5.0	8		5.0	5.0	8		5.0	PED PHASES										
T B R	1.0	11.50		1.0	1.0	15		1.0	LEAD PHASES										
T T R	1.0	25		1.0	1.0	25		1.0	DBL ENTRY										
									SEQUENTIAL										
PASSAGE	1	4.0		1	1	4.0		1	START UP										
MIN. GAP	1	2.0		1	1	2.0		1	OVERLAP A										
ADDED ACTUATION	1	2.3		1	1	2.3		1	OVERLAP B										
YELLOW	3.0	3.0		3.0	3.0	3.0		3.0	OVERLAP C										
RED CLEAR	0.5	1.0		1.0	0.5	1.0		1.0	OVERLAP D										
RED REVERT									EXCLUSIVE										
WALK II									SIM GAP										

LEGEND

- ⊙ Pre-Fab Junction Box
- ⊙ Junction Box
- ⊙ Service Box
- ⊙ Traffic Signal Pole with Mast Arm
- ⊙ Traffic Signal Pedestal
- ⊙ Traffic Signal Indication (Vehicular) with Back Plate
- ⊙ Traffic Signal Indication (Pedestrian)
- ⑥ Movement Identification No.
- ⊙ Traffic Signal Controller
- ⊙ Vehicle Sensor
- ⊙ Quadrapole Loop
- ⊙ Proposed Conduit (RCC)
- ⊙ Luminaire & Arm (By Others)

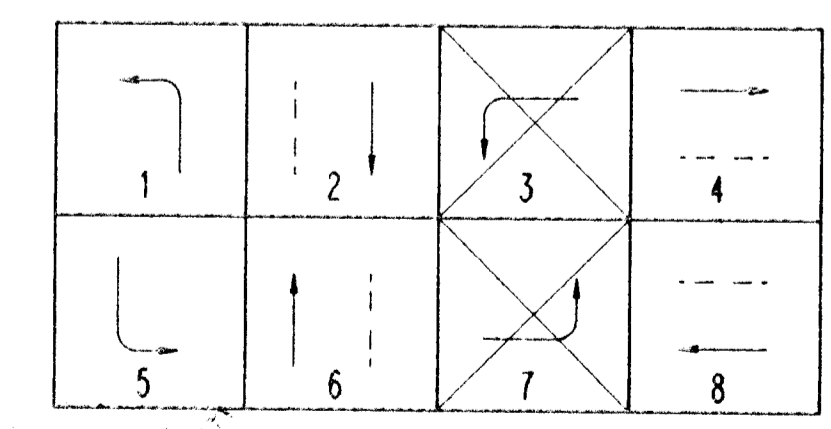

REV.	DATE	DESCRIPTION



HELLMUTH, OBATA & KASSEBAUM, INC.
 DALLAS, TEXAS
 PROFESSIONAL ENGINEERING
 CONSULTANTS, P.A.
 WICHITA, KANSAS
 BRAD J. GOLDBERG
 DALLAS, TEXAS

MID-AMERICA
 ALL-INDIAN CENTER
 SITE IMPROVEMENTS
 CITY OF WICHITA, KANSAS
 TRAFFIC SIGNAL MODIFICATION
 CENTRAL/STACKMAN
 PROJECT NO. ISSUE DATE SCALE 1" = 20' SHEET TS1