

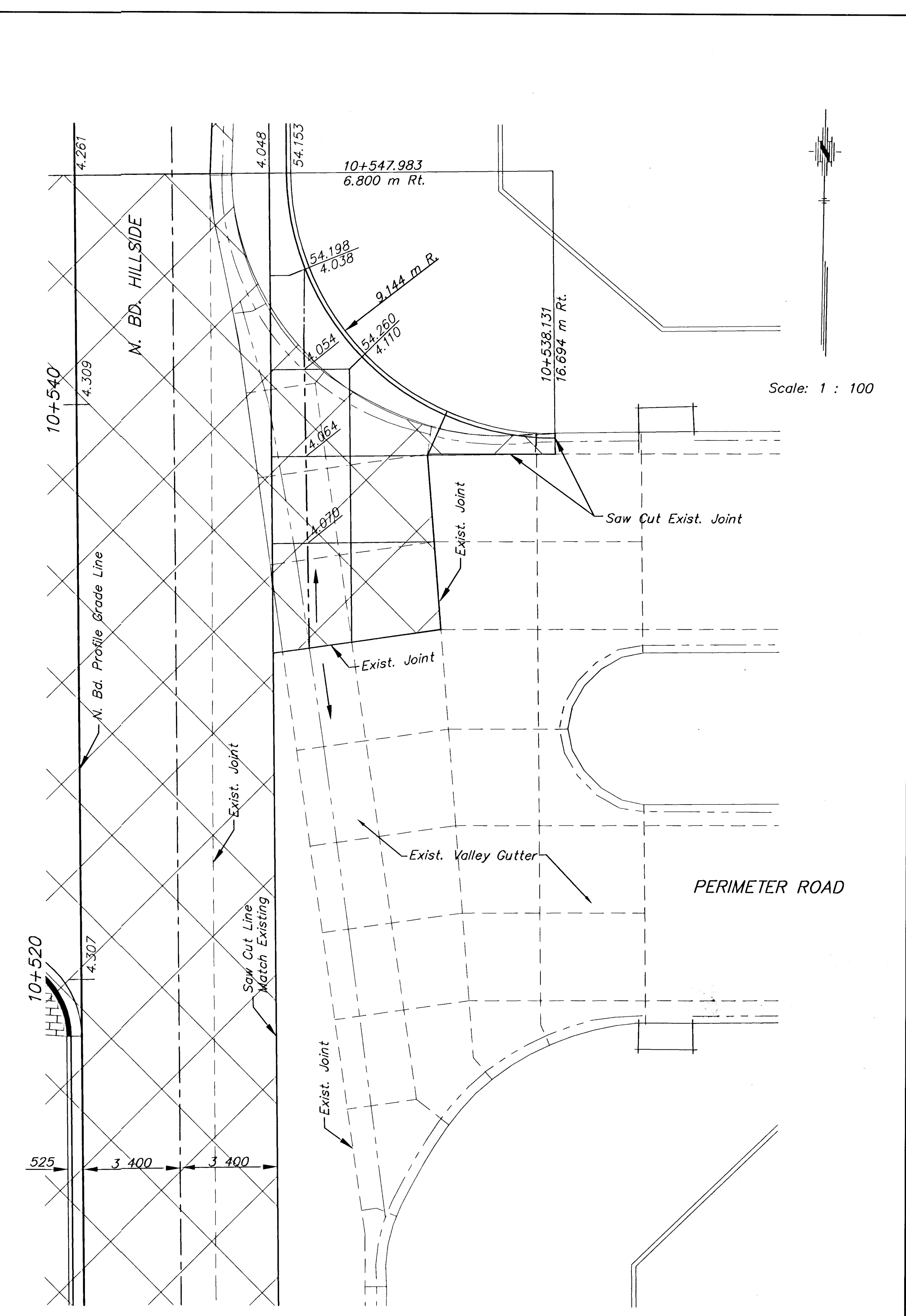

PLAN - HILLSIDE & 18TH STREET



PLAN - HILLSIDE & PERIMETER ROAD

**LEGEND**

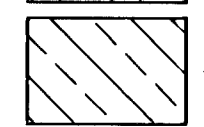
-  Pavement Removal
-  Demolition backfill stabilization  
See Note on Sheet No. 2)

See Valley Gutter Detail Sh. No. 14 for additional information

H:\CIVIL\01053\PAVE\01053PL5.DWG 04/30/03 04:09:16 PM CDT

**INTERSECTION PLANS**

PROJ. NO. 472-83537 SEDGWICK CO.

MKEC ENGINEERING CONSULTANTS, INC.  
WICHITA, KANSAS

DESIGNED BY: JRA	CHECKED BY: JRA
DRAWN BY: DPG	DATE: Jan. 2003 SHEET 11 OF 73