

EXIST. TREES TO BE PRESERVED
THINNING SHALL BE REQUIRED
& DETERMINED IN THE FIELD BY L.A. (TYP)
(COST SUBSIDIARY TO PROJECT)

INSTALL 1.8 M CHAINLINK FENCE (TYP)
(REFER TO REQUIREMENTS SHEET 37)

NOTES:

1. All embankment material to be placed in median to be Select Soil.
2. Contractor to resod all disturbed areas outside of designated sodding limits.
3. Top 150 mm of all embankments west of Hillside to be Select Soil.

Scale: 1 : 200

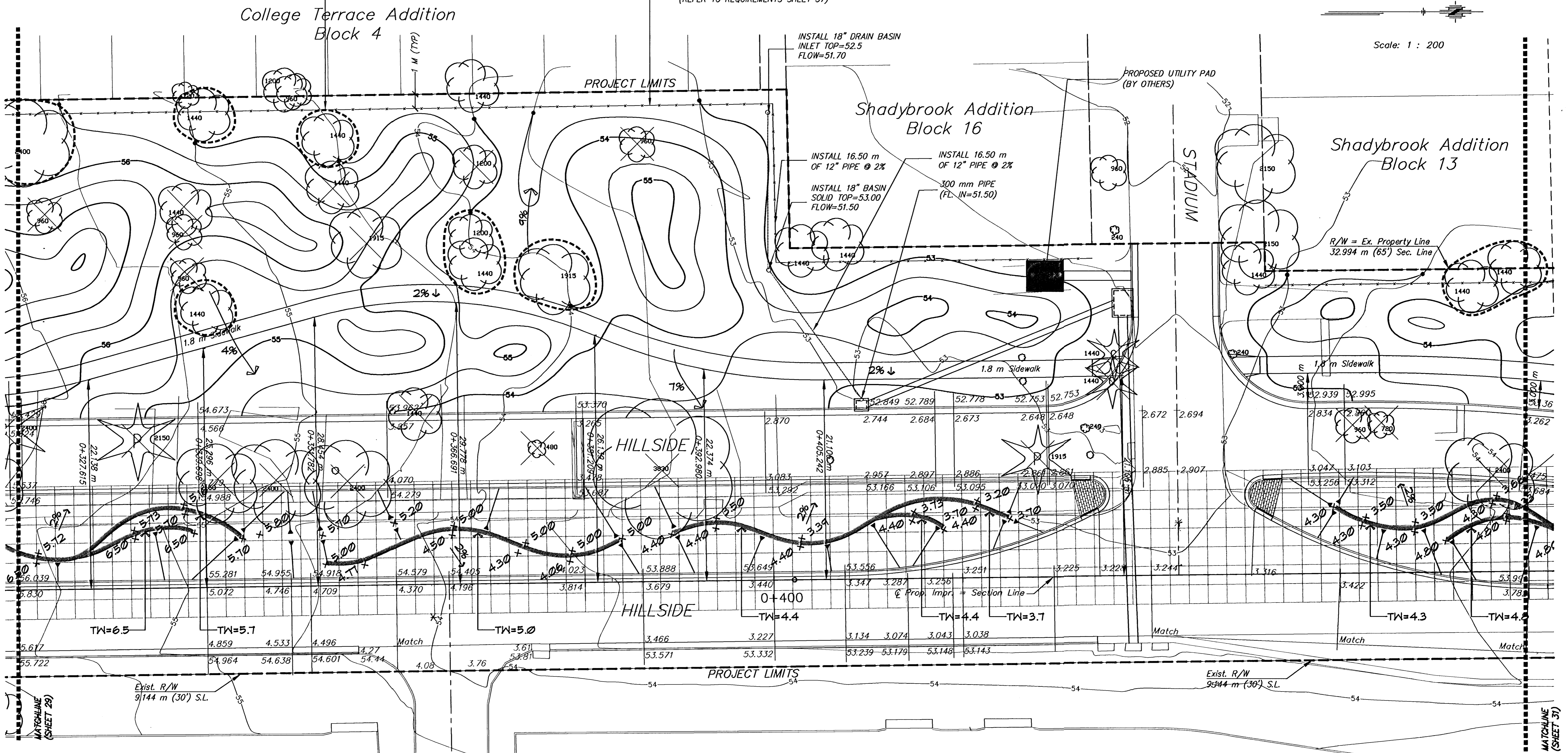

Wichita State University

LEGEND

- 2 m Grid
- Sodding Limits
- 59.0 Proposed Grading Contour
- Tree to be removed
- Slope Arrow

H:\CIVIL\01053\PAVE\01053RS2.DWG 05/01/03 02:41:24 PM CDT

ROADSIDE IMPROVEMENTS	
STA. 0+320 TO STA. 0+480	
PROJ. NO. 472-83537	SEDGWICK CO.
MKEC ENGINEERING CONSULTANTS, INC. WICHITA, KANSAS	
DESIGNED BY: MKEC	CHECKED BY: MKEC
DRAWN BY: BJH	DATE: 04/03
SHEET 30 OF 73	