

Scale: 1 : 200

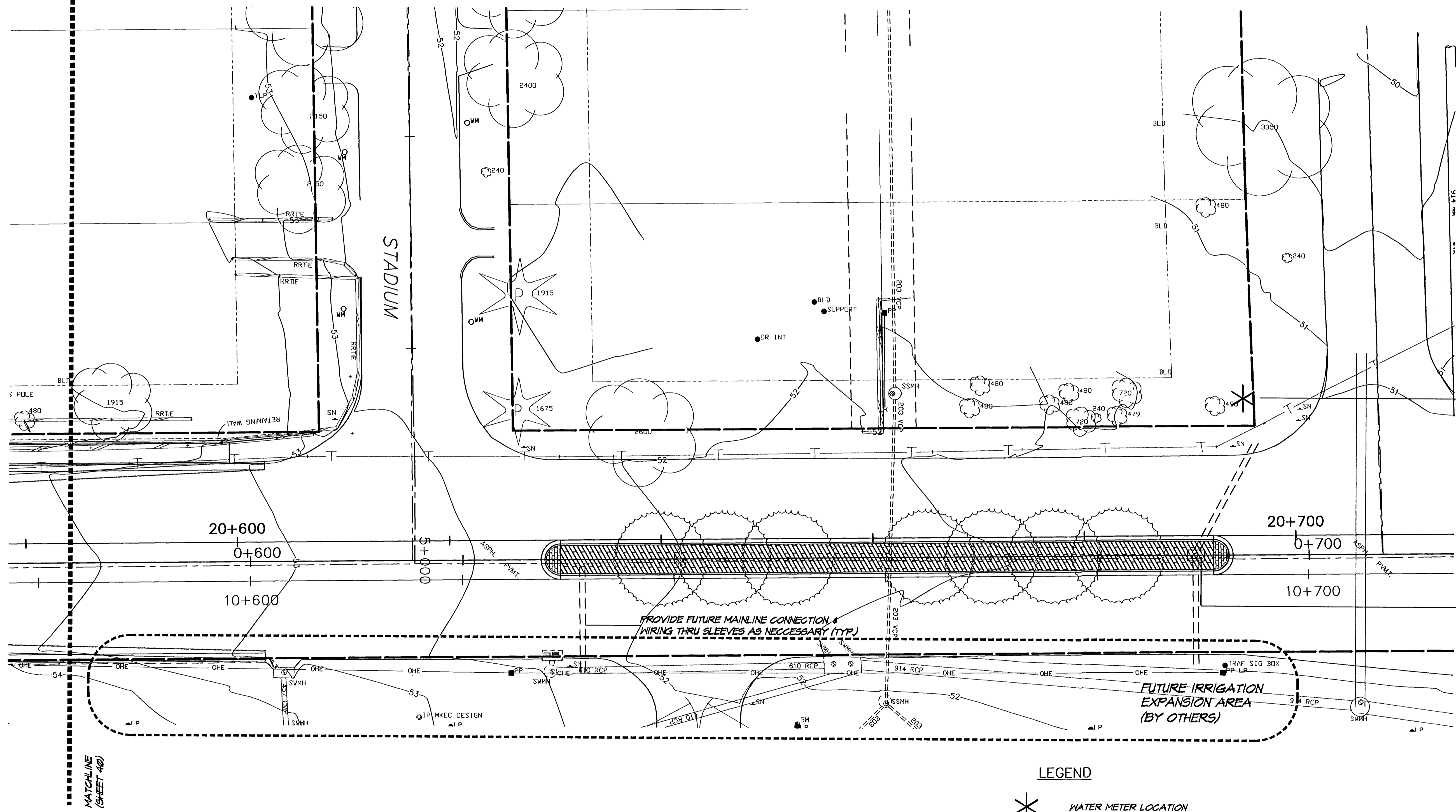

CONTRACTOR TO FURNISH & INSTALL WATER METER AT THIS LOCATION IF OTHER MEANS OF SUPPLYING WATER IS NOT POSSIBLE

PROVIDE BATTERY OPERATED CONTROLLER & BACKFLOW DEVICE AT THIS APPROXIMATE LOCATION IF NO OTHER MEANS OF SERVICE IS POSSIBLE

PROVIDE FUTURE MAINLINE CONNECTION & WIRING THRU SLEEVES AS NECESSARY (TYP)

FUTURE IRRIGATION EXPANSION AREA (BY OTHERS)

MATCHLINE (SHEET 40)

NOTE:  
 1. REFER TO UNDERGROUND SPRINKLER SPECIFICATION SECTION 02210 FOR DETAILED INFORMATION REGARDING THE IRRIGATION SYSTEM REQUIREMENTS.  
 2. ADDITIONAL BORING IF REQUIRED SHALL BE SUBSIDIARY TO THE 'IRRIGATION SYSTEM' BID ITEM.

LEGEND

- WATER METER LOCATION (PAID FOR & FURNISHED BY CONTRACTOR IF NECESSARY)
- CONTROLLER/BACKFLOW DEVICE
- SPRAY LIMITS (TURF)
- ROTOR LIMITS (TURF)
- SPRAY LIMITS (BED AREAS/100MM POP-UPS)

H:\CIVIL\01053\PAVE\01053R4.DWG 05/01/03 03:19:12 PM CDT

IRRIGATION PLAN	
STA. 0+600 TO STA. 0+700	
PROJ. NO. 472-83537	SEDGWICK CO.
MKEC ENGINEERING CONSULTANTS, INC. WICHITA, KANSAS	
DESIGNED BY: MKEC	CHECKED BY: MKEC
DRAWN BY: B.J.H.	DATE: 04/03 SHEET 41 OF 73