

GENERAL NOTES:  
 Refer to Std. TE710SI for identification of signs for handling traffic through construction.  
 Refer to Std. TE700SI for dimensions.  
 Paving operations will be phased at entrances to allow continued use of the points of access.  
 Lane closure will be limited to one lane at a time. Multiple Closure is shown here for information only.  
 Refer to Typical Side Street Closure details for side street and entrance traffic control as necessary.

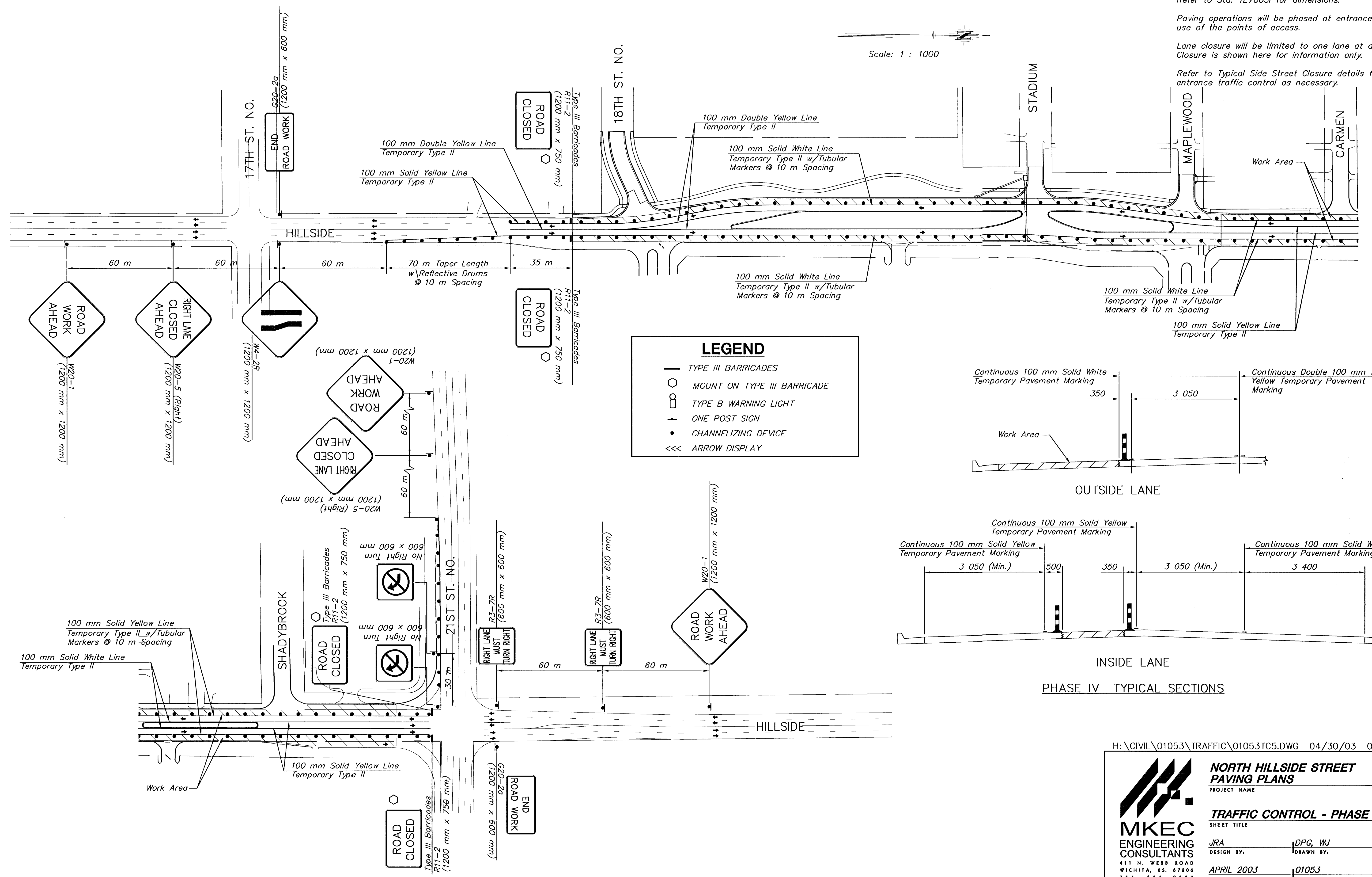

**LEGEND**

- TYPE III BARRICADES
- MOUNT ON TYPE III BARRICADE
- TYPE B WARNING LIGHT
- ↑ ONE POST SIGN
- CHANNELIZING DEVICE
- <<< ARROW DISPLAY

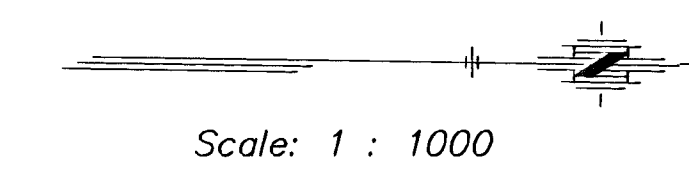
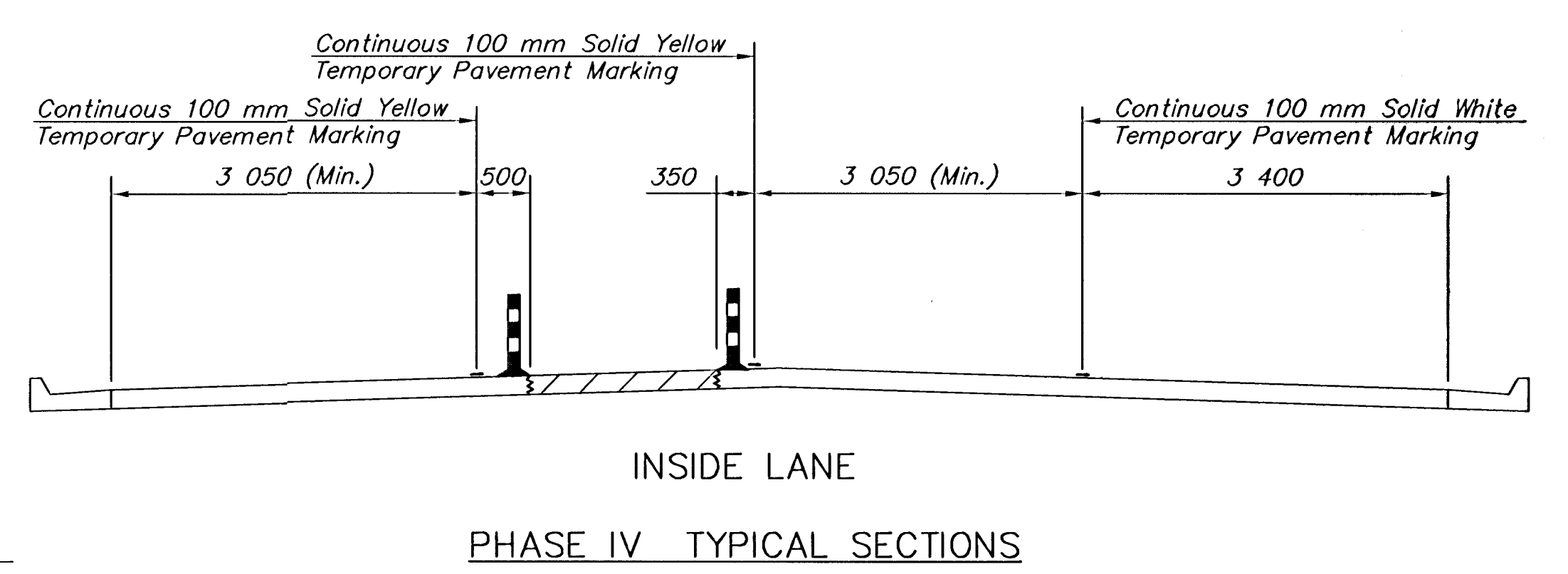
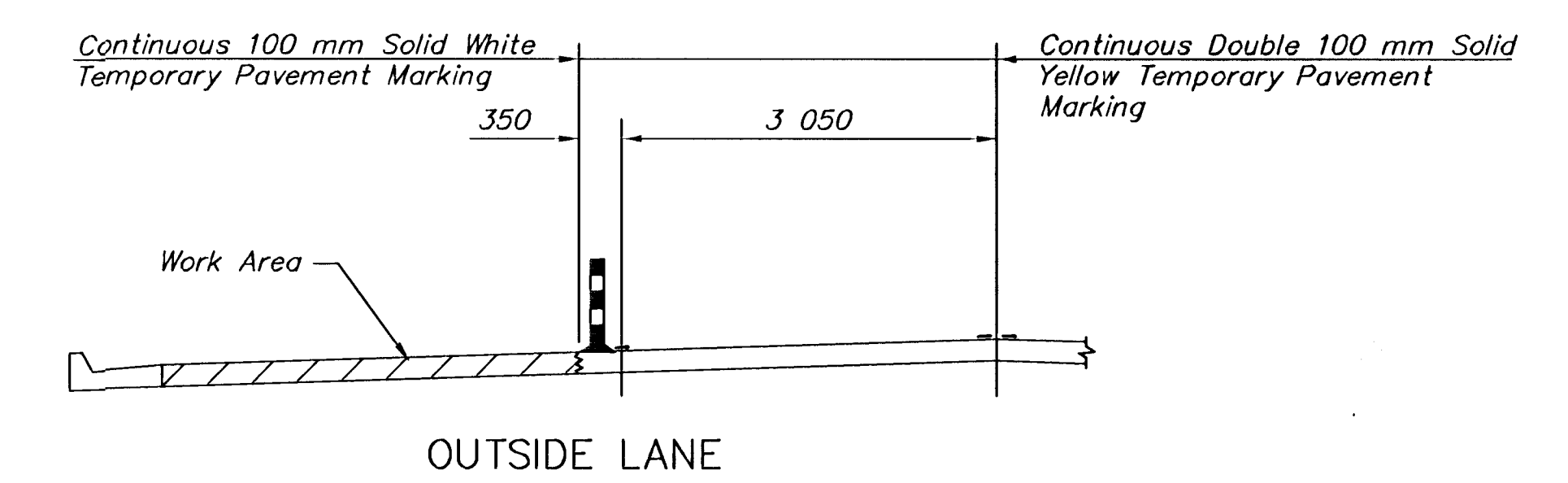

H:\CIVIL\01053\TRAFFIC\01053TC5.DWG 04/30/03 03:37:36 PM CDT

 <b>MKEC</b> ENGINEERING CONSULTANTS 411 N. WEBB ROAD WICHITA, KS. 67206 316 - 684 - 9600	<b>NORTH HILLSIDE STREET</b>	
	<b>PAVING PLANS</b>	
	PROJECT NAME	
	<b>TRAFFIC CONTROL - PHASE IV</b>	
SHEET TITLE		
JRA	DPG, WJ	JRA
DESIGN BY:	DRAWN BY:	CHECKED BY:
APRIL 2003	01053	50 / 73
DATE	JOB NO.	SHEET/OF