

- SURVEY MARKER LEGEND**
- ⊙ = CITY OF WICHITA CONTROL THIMBLE (FOUND)
 - 1" IP = 1" IRON PIPE (FOUND)
 - 1/2" IP = 1/2" IRON PIPE (FOUND)
 - 1/2" IP IN CONC = 1/2" IRON PIPE IN CONCRETE (FOUND)
 - 1/2" SP = 1/2" STEEL PIN (FOUND)
 - 3/4" IP = 3/4" IRON PIPE (FOUND)
 - WMPA 5/8" = 5/8" REBAR W/AMPA CAP (FOUND)
 - SAV 1/2" = 1/2" REBAR W/SAVOY CAP (SET) OVER 1/2" IRON PIPE (FOUND)
 - SAV = 1/2" REBAR W/SAVOY CAP (SET)
 - MB = MAGNETIC NAIL (SET)
 - IN = "V" NOTCH IN CONCRETE (SET)
 - CROSS = CROSS CHISELED IN CONCRETE (SET)

CONTROL POINT LIST

C.P. #1 N 2000.000 E 2000.000	C.P. #16 N 2008.397 E 19008.777	C.P. #31 N 2148.639 E 19132.423	C.P. #46 N 21048.698 E 18283.585
C.P. #2 N 20837.000 E 19862.704	C.P. #17 N 20592.324 E 18907.814	C.P. #32 N 21248.128 E 19101.099	C.P. #47 N 20982.699 E 18284.832
C.P. #3 N 21688.752 E 19500.930	C.P. #18 N 20580.051 E 18460.692	C.P. #33 N 21251.475 E 19048.834	C.P. #48 N 20834.778 E 18228.635
C.P. #4 N 21697.098 E 19441.334	C.P. #19 N 20840.032 E 18458.170	C.P. #34 N 21282.325 E 19048.344	C.P. #49 N 20724.878 E 18228.180
C.P. #5 N 21487.199 E 19444.268	C.P. #20 N 20652.203 E 18906.252	C.P. #35 N 21282.652 E 19108.345	C.P. #50 N 20710.327 E 18288.319
C.P. #6 N 21488.789 E 19503.901	C.P. #21 N 20684.098 E 18999.582	C.P. #36 N 21418.217 E 19108.465	C.P. #51 N 20709.688 E 18228.322
C.P. #7 N 21500.507 E 19938.744	C.P. #22 N 20677.510 E 19104.762	C.P. #37 N 21416.603 E 19048.482	C.P. #52 N 20814.861 E 18234.983
C.P. #8 N 21440.138 E 19928.658	C.P. #23 N 20679.141 E 19164.744	C.P. #38 N 21462.140 E 18912.603	C.P. #53 N 20624.707 E 18293.997
C.P. #9 N 21428.117 E 19504.361	C.P. #24 N 20691.686 E 19160.184	C.P. #39 N 21460.257 E 18442.628	C.P. #54 N 20665.680 E 18303.560
C.P. #10 N 21427.226 E 19444.785	C.P. #25 N 20990.810 E 19100.190	C.P. #40 N 21454.158 E 18218.004	C.P. #55 N 20469.709 E 18328.940
C.P. #11 N 21227.174 E 19447.610	C.P. #26 N 21017.727 E 19088.972	C.P. #41 N 21448.995 E 18936.174	C.P. #56 N 20450.910 E 18312.219
C.P. #12 N 21227.157 E 19447.011	C.P. #27 N 21002.980 E 18948.403	C.P. #42 N 21389.098 E 18930.662	C.P. #57 N 20209.355 E 18312.801
C.P. #13 N 20897.023 E 19454.639	C.P. #28 N 21062.916 E 18948.889	C.P. #43 N 21394.278 E 18218.673	C.P. #58 N 20211.007 E 18372.791
C.P. #14 N 20828.655 E 19515.469	C.P. #29 N 21077.118 E 19089.923	C.P. #44 N 21395.931 E 18278.635	C.P. #59 N 20097.286 E 18374.329
C.P. #15 N 20817.532 E 19108.392	C.P. #30 N 21126.630 E 19075.857	C.P. #45 N 21230.793 E 18281.005	

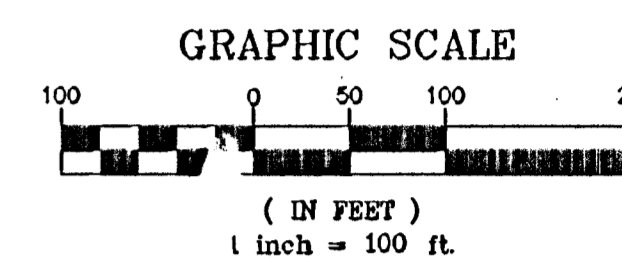
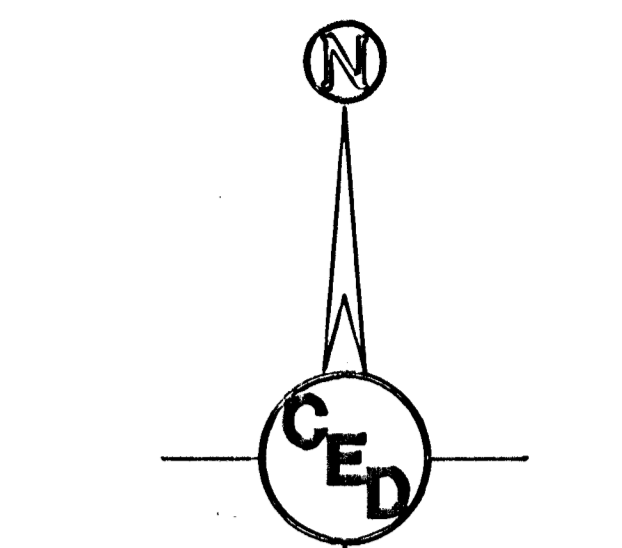

- LEGEND**
- G = GAS MAIN
 - W = WATER MAIN
 - SS = SANITARY SEWER
 - SMS = STORM WATER SEWER
 - UGT = UNDER GROUND ELECTRIC
 - UGT = UNDER GROUND TELEPHONE
 - B.M. = BENCH MARK
 - TELE. PED. = TELEPHONE PEDESTAL
 - F.H. = FIRE HYDRANT
 - ← = GUY ANCHOR
 - G.P. = GUARD POST
 - HL.P. = HIGH LINE POLE
 - L.P. = LIGHT POLE
 - M.B. = MAIL BOX
 - SP.P. = SPINNER POLE
 - SH = SPRINKLER HEAD
 - SIGN = SIGN
 - WELL = WATER WELL
 - W.V. = WATER VALVE
 - SS.M.H. = SANITARY SEWER MANHOLE

NOTE: Evidence indicates the streets have been tarred or asphalted at a previous time, thickness and quality undetermined.

Reference Ben Mark: City of Wichita Std. Disc Wheeland & S. N. S. Kelly & N. S. Kelly N.W. Cor Hubguard Elevation = 1322.50 N.G.V.D.

B.M.#1: R.R. Spike in High Line Pole N.W. Cor Kallagy & Hornecker Elevation = 1322.50 N.G.V.D.

B.M.#2: Stop Bench in Light Pole N.E. Cor Walker & Hornecker Elevation = 1321.28 N.G.V.D.

B.M.#3: R.R. Spike in Light Pole N.E. Cor Irving & Hornecker Elevation = 1318.91 N.G.V.D.

B.M.#4: R.R. Spike in Light Pole S.E. Cor Lynndale & Hornecker Elevation = 1317.64 N.G.V.D.

B.M.#5: Stop Bench in High Line Pole S.W. Cor Rogers & Lynndale Elevation = 1320.15 N.G.V.D.

B.M.#6: 1/2" Iron Pipe in Concrete N.W. Cor Rogers & Irving Elevation = 1321.81 N.G.V.D.

B.M.#7: R.R. Spike in Light Pole N.W. Cor Rogers & Walker Elevation = 1332.54 N.G.V.D.

B.M.#8: Stop Bench in Light Pole S.W. Cor Wheatridge & Walker Elevation = 1340.24 N.G.V.D.

B.M.#9: Stop Bench in Light Pole S.W. Cor Wheatridge & Lynndale Elevation = 1322.79 N.G.V.D.

B.M.#10: Stop Bench in Power Pole S.W. Cor Lynndale & 115th Elevation = 1328.10 N.G.V.D.

IMPROVEMENT DISTRICT

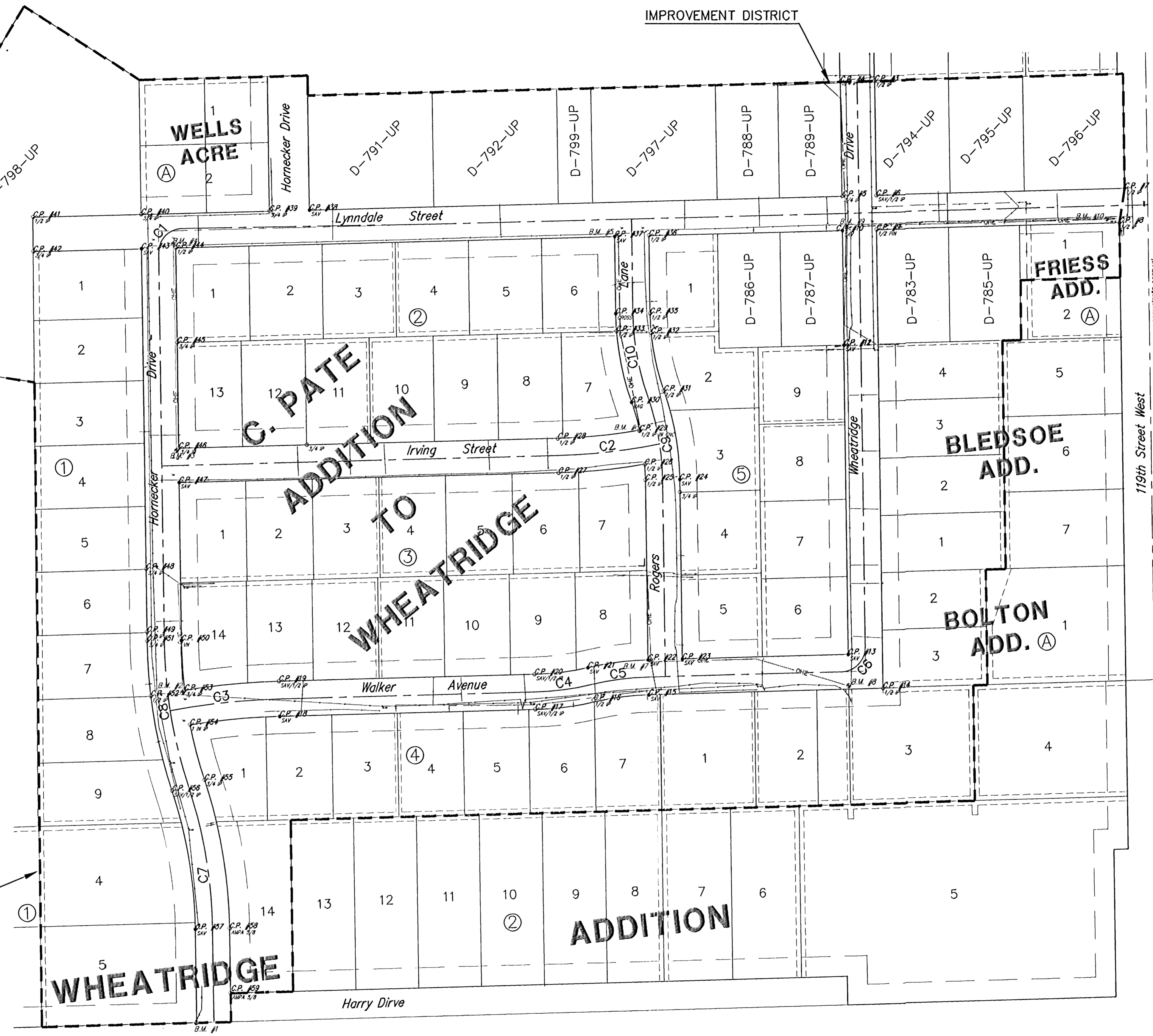

US Highway 54 (CC No. A-38302)

S.E. Cor SE 1/4 Sec 25-27S-2W

CURVE TABLE

CURVE	RADIUS	DELTA	TANGENT	ARC LENGTH	CHORD BEARING	CHORD
C1	42.00	90°52'48"	42.65	86.82	S44°37'46"W	59.85
C2	1021.24	10°01'54"	89.63	178.81	N83°25'38"E	178.58
C3	1226.71	8°58'22"	96.25	192.11	S83°57'24"W	191.91
C4	500.99	11°28'00"	50.30	100.26	N82°42'35"E	100.10
C5	500.99	11°28'00"	50.30	100.26	S82°42'35"W	100.10
C6	42.00	89°15'12"	41.46	65.43	N43°48'59"E	59.01
C8	827.48	17°38'00"	128.10	254.18	S09°38'38"E	253.19
C9	457.57	18°36'00"	74.93	148.54	N10°08'38"W	147.89
C10	457.57	18°36'00"	74.93	148.54	S10°08'38"E	147.89

UTILITIES SHOWN REPRESENT THE BEST INFORMATION AVAILABLE FOR DESIGN. ADDITIONAL UTILITIES MAY BE PRESENT ON THIS PROJECT. THE CONTRACTOR SHALL BE RESPONSIBLE FOR DETERMINING THE EXACT LOCATION, DEPTH AND SIZE OF ALL UNDERGROUND UTILITIES PRIOR TO CONSTRUCTION. THE CONTRACTOR SHALL BE LIABLE FOR ANY DAMAGE CAUSED BY THE FAILURE TO DO SO.

SURVEY DISCLAIMER:
TOPOGRAPHIC SURVEY AND CONTOUR MAP USED IN PREPARING PLANS WAS PROVIDED BY SAVOY COMPANY, P.A., 535 S. EMPORIA, SUITE 104, WICHITA, KS. ENGINEER DOES NOT GUARANTEE SURVEY ELEVATIONS FOR ACCURACY. CONTRACTOR SHALL VERIFY ELEVATIONS AND NOTIFY ENGINEER OF ANY DISCREPANCIES.

STREET PAVING PLANS
SITE/CONTROL PLAN
 WICHITA, SEDG. WICK COUNTY, KANSAS
 CED PROJ. NO.: 20030988
CERTIFIED ENGINEERING DESIGN, P.A.
 810 WEST DOUGLAS, SUITE C
 WICHITA, KANSAS 67203
 PH.(316)262-8808 FAX.(316)262-1669

DESIGNED: HDF SCALE: 1"=100' SHEET 2
 DRAWN: CKW DATE: 8/03
 CHECKED: HDF CED FILE: Wheat-Bose.dwg TOTAL: 43