

REFERENCES NOTED	
REFERENCES CHECKED	

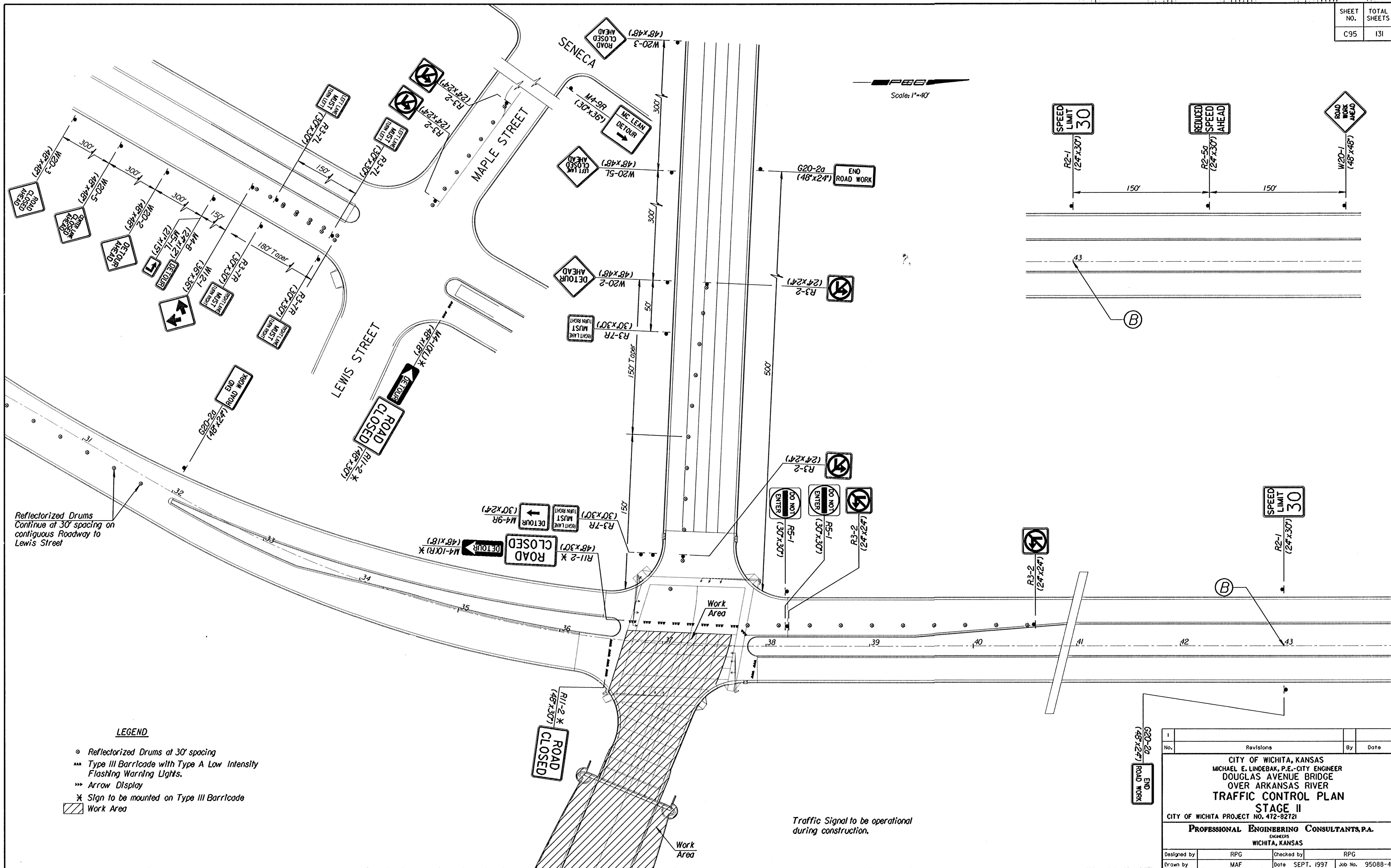

Reflectorized Drums
Continue at 30' spacing on
contiguous Roadway to
Lewis Street

- LEGEND**
- Reflectorized Drums at 30' spacing
 - ▬ Type III Barricade with Type A Low Intensity Flashing Warning Lights.
 - ➡ Arrow Display
 - * Sign to be mounted on Type III Barricade
 - ▨ Work Area

Traffic Signal to be operational during construction.

No.	Revisions	By	Date

CITY OF WICHITA, KANSAS
 MICHAEL E. LINDEBAK, P.E., CITY ENGINEER
 DOUGLAS AVENUE BRIDGE
 OVER ARKANSAS RIVER
TRAFFIC CONTROL PLAN
STAGE II
 CITY OF WICHITA PROJECT NO. 472-82721
PROFESSIONAL ENGINEERING CONSULTANTS, P.A.
 ENGINEERS
 WICHITA, KANSAS

Designed by	RPG	Checked by	RPG
Drawn by	MAF	Date	SEPT. 1997
		Job No.	95088-4

i:/1995/95088/douglas/trafficplan.dgn
 Drawn by: maf
 Plotted by: wil 1-16-98