

FHWA REG NO.	STATE	PROJECT NO.	YEAR	SHEET NO.	SHEETS
7	KANSAS	54-87-TE-0039-01	1997	10	43

GENERAL NOTES CONCRETE PAVING UNITS

- IT WILL BE THE RESPONSIBILITY OF THE CONTRACTOR TO OBSERVE ALL CITY, COUNTY AND STATE CODES AND REGULATIONS THAT APPLY TO THIS JOB.
- UNDERGROUND FACILITIES, STRUCTURES AND UTILITIES HAVE BEEN DRAWN FROM AVAILABLE RECORDS. THEREFORE, THE RELATIONSHIP BETWEEN PROPOSED WORK AND EXISTING FACILITIES, STRUCTURES AND UTILITIES MUST BE CONSIDERED APPROXIMATE AND IT IS THE CONTRACTOR'S RESPONSIBILITY TO DETERMINE THEIR EXACT LOCATION AND THE EXISTENCE OF ANY NOT SHOWN BY CONTACTING KANSAS ONE-CALL CENTER AT (316) 687-2470 A MINIMUM OF 48 HOURS PRIOR TO THE COMMENCEMENT OF DIGGING OPERATIONS.
- UTILITY OWNERS:
CITY OF WICHITA WATER AND SEWER DEPARTMENT (316) 268-4908
MULTIMEDIA CABLEVISION (316) 262-0661
SOUTHWEST BELL TELEPHONE 800-734-7630
WILLIAMS NATURAL GAS PIPELINE (918) 588-4200
KANSAS GAS AND ELECTRIC (316) 832-3169 OR 832-3180
KANSAS DEPARTMENT OF TRANSPORTATION (AREA ENGINEER) (316) 744-1271
- EXISTING CONDITIONS SHALL BE VERIFIED BY GENERAL CONTRACTOR. DISCREPANCIES ARE TO BE REPORTED TO LANDSCAPE ARCHITECT PRIOR TO CONSTRUCTION.
- THE CONTRACTOR SHALL RESTORE TO THE ORIGINAL CONDITION, ANY AND ALL PROPERTY DISTURBED BY HIS OPERATIONS.
- THE CONTRACTOR WILL BE RESPONSIBLE TO MAINTAIN STRICT COMPLIANCE WITH MINIMUM WIDTHS OF EXISTING ASPHALT THAT IS TO REMAIN. ALONG THE JERSEY BARRIER A 2'-6" STRIP IS TO REMAIN. ALONG THE BRIDGE WALLS A 3'-0" STRIP IS TO REMAIN. THE CONTRACTOR WILL BE RESPONSIBLE FOR THE REPAIR OF ANY ASPHALT THAT IS DAMAGED DURING THE DEMOLITION OR CONSTRUCTION.
- DAMAGE TO EXISTING CONCRETE CURB AND GUTTER, EXISTING ASPHALT AND EXISTING SIGNAGE TO BE REMOVED AND REPLACED BY CONTRACTOR.
- ALL EXISTING TRAFFIC SIGNS ARE TO REMAIN DURING THE PROGRESS OF CONSTRUCTION. CONTRACTOR IS TO PROTECT THESE SIGNS FROM DAMAGE.
- EXISTING TRAFFIC SIGNALS ARE TO REMAIN AND STAY OPERATIONAL DURING THE PROGRESS OF CONSTRUCTION.
- PROTECT ALL SUPPORT POST FOOTINGS, SIGN POSTS, FIRE HYDRANTS UTILITIES AND SIDEWALKS DURING EXCAVATION. ANY DAMAGE TO EXISTING FACILITIES IS THE RESPONSIBILITY OF THE CONTRACTOR.
- ALL CONCRETE PAVERS SHALL BE INSTALLED TO MATCH BACK OF CURB ELEVATION WHILE MAINTAINING POSITIVE DRAINAGE TOWARDS CURB AND GUTTER.
- SEE PLANTING PLANS FOR LOCATION AND TYPE OF PLANT MATERIAL.
- THE CONTRACTOR SHALL BE RESPONSIBLE FOR COORDINATING DRAIN TILE TRENCHING AND INSTALLATION WITH PLANT MATERIAL AND IRRIGATION TRENCHING AND INSTALLATION.
- SEE SPECIAL PROVISION TITLED: SOLID INTERLOCKING CONCRETE PAVING UNITS FOR ADDITIONAL REQUIREMENTS: BID ITEM: PAVING BRICK - SQ.YDS.
- GENERAL CONTRACTOR SHALL BE RESPONSIBLE FOR ALL PERMITS, FEES, INSPECTIONS, AND OTHER SUBMITTALS TO APPROPRIATE REGULATORY AGENCY REQUIRED DURING THE DURATION OF WORK.
- GENERAL CONTRACTOR SHALL BE RESPONSIBLE FOR REQUIRED UTILITY COMPANY SUBMITTALS, CONNECTION FEES, AND INSPECTIONS.

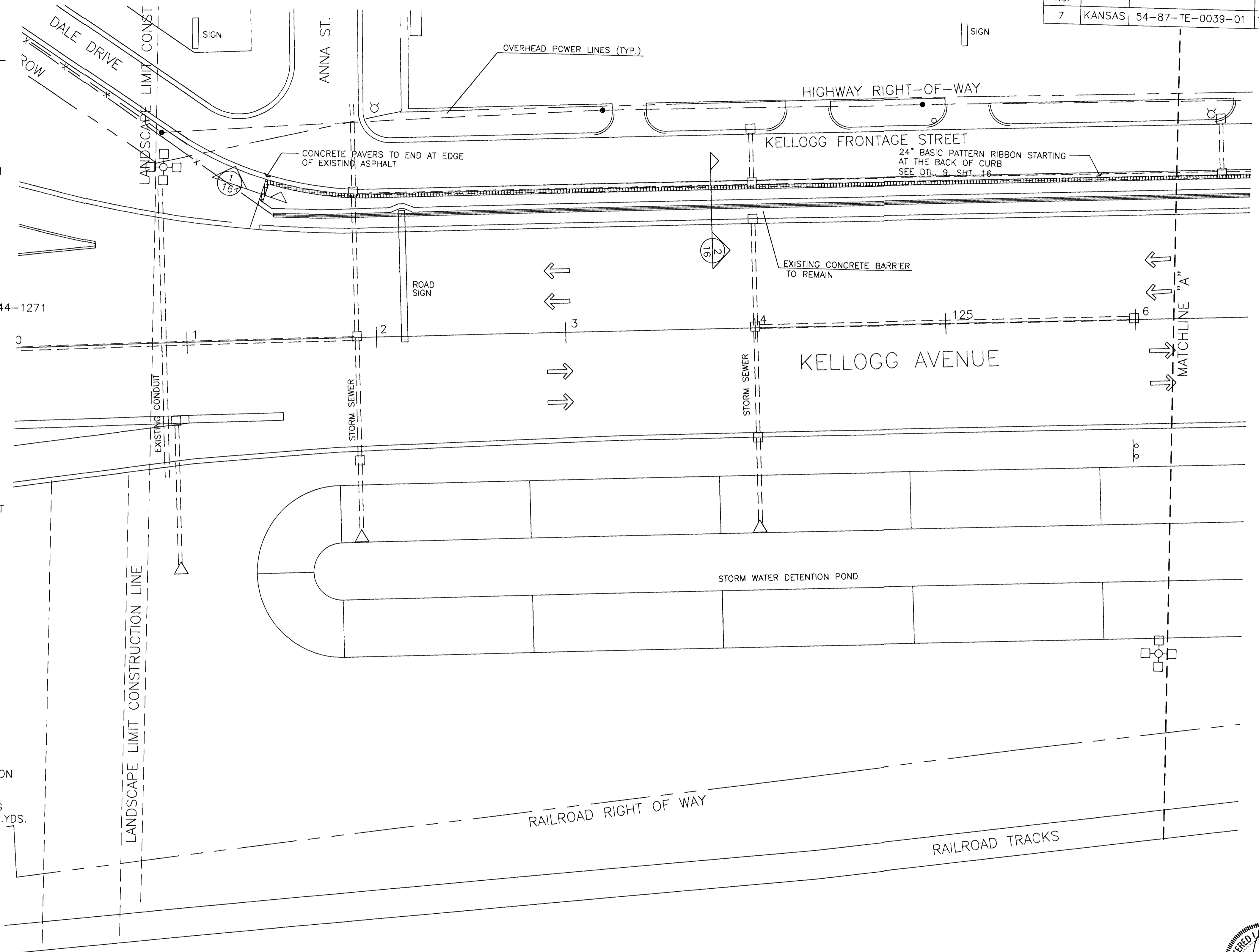

LEGEND

 CONCRETE PAVERS INSTALLED PER PLANS

SEE SHEET 16 FOR PAVER SECTIONS AND DETAIL

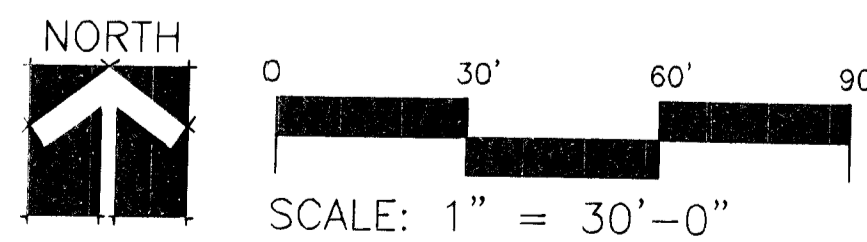

BID ITEMS - THIS SHEET	
PAVING BRICK	106.70 SQ. YDS.
COMPACTION TYPE B MR-90 (SUBSIDIARY)	17.78 CU. YDS.
PAVING RESTRAINT (SUBSIDIARY)	489'-0" LIN. FT.
UNDERDRAIN (4") (TYPE H) (PERFORATED)	0 LIN. FT.
EXCAVATION & GRANULAR BACKFILL SUBSIDIARY	0 LIN. FT.
UNDERDRAIN (4") (TYPE K) (SOLID)	0 UNITS
CATCH BASIN CORE DRILLING & GROUTING SUBSIDIARY	0 UNITS



KANSAS DEPARTMENT OF TRANSPORTATION
**KELLOGG AND WEST STREET
 STATION 119+00 TO 126+00
 PAVING PLANS**
 PROJECT NO. #7C1227

Wilson Darnell Mann
 architecture site planning interiors
 Wichita, Kansas

DESIGNED BY: **WDM, PA** CHECKED BY: **LME**
 DRAWN BY: **SKW** DATE: **7/31/97** SHEET **10** OF **43**

2-17-97
E:\94082\PAV-1
E:\94082\MAINBASE E:\94082\PAVERS