

UTILITY OWNERS:
 CITY OF WICHITA WATER AND SEWER DEPARTMENT (316) 268-4908
 MULTIMEDIA CABLEVISION (316) 262-0661
 SOUTHWEST BELL TELEPHONE 800-734-7630
 WILLIAMS NATURAL GAS PIPELINE (918) 588-4200
 KANSAS GAS AND ELECTRIC (316) 832-3169 OR 832-3180
 CONTRACTOR TO VERIFY LOCATIONS OF ALL UTILITIES PRIOR TO DIGGING.

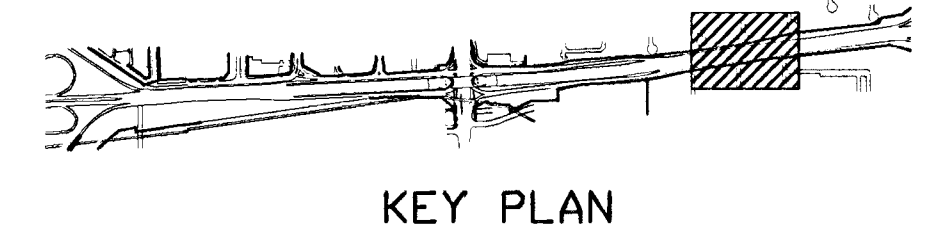

NOTE:
 SEE SHT. 18 FOR GENERAL NOTES.
 SEE SHT. 26 FOR PLANTING LEGEND,
 NOTES AND DETAILS.

BID ITEM (AS PER SHEET)		
QTY.	BOTANICAL NAME	COMMON NAME
2	FRAXINUS PENNSYLVANICA "MARSHALL"	MARSHALL GREEN ASH
4	CERCIS CANADENSIS	EASTERN REDBUD
117	PYRACANTHA COCCINEA "KASAN"	KASAN SCARLET FIRETHORN
87	EUONYMUS ALATA	WINGED EUONYMUS
84	VIBURNUM RHYTIDOPHYLLUM	LEATHER LEAF VIBURNUM
SEEDING - TURF TYPE TALL FESCUE (OVERSEEDING)		.67 ACRES
SEEDING - TURF TYPE TALL FESCUE (BARE SOIL)		0 ACRES

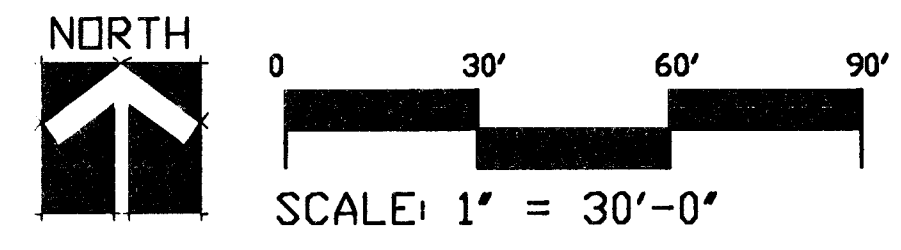
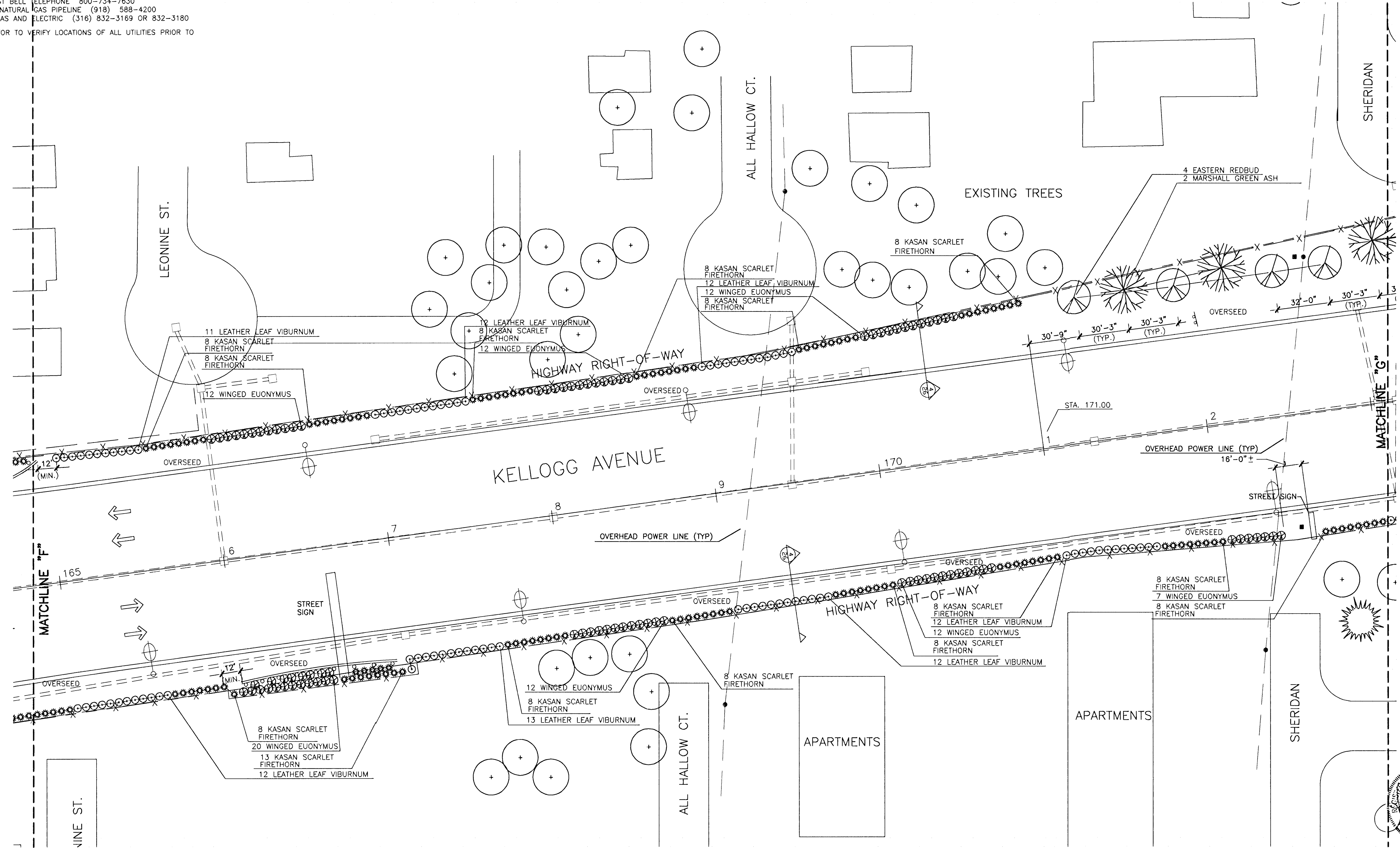
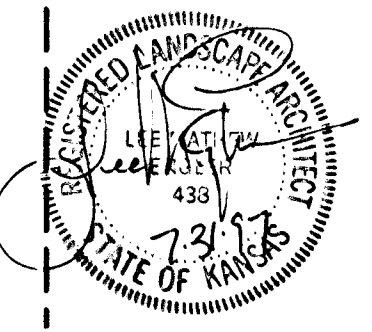

KANSAS DEPARTMENT OF TRANSPORTATION
KELLOGG AND WEST STREET STATION 165+00 TO 173+00 PLANTING PLAN
 PROJECT NO. #701221

Wilson Darnell Mann
 architecture site planning interiors
 Wichita, Kansas

DESIGNED BY: WDM, PA	CHECKED BY: LME
DRAWN BY: SKW	DATE: 7/31/97 SHEET 24 OF 43

8-24-95
 E:\94082\LP-7
 E:\94082\WANDA E:\94082\PLANTS E:\94082\PAVERS