

FHWA REG NO.	STATE	PROJECT NO.	YEAR	SHEET NO.	SHEETS
7	KANSAS	54-87-TE-0039-01	1997	29	43

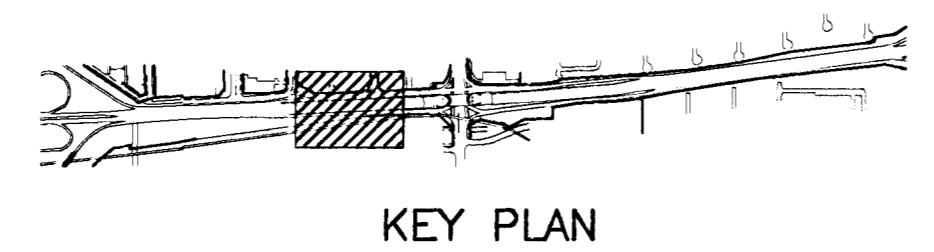
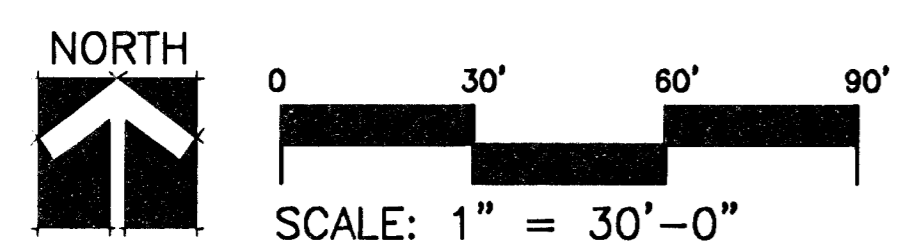
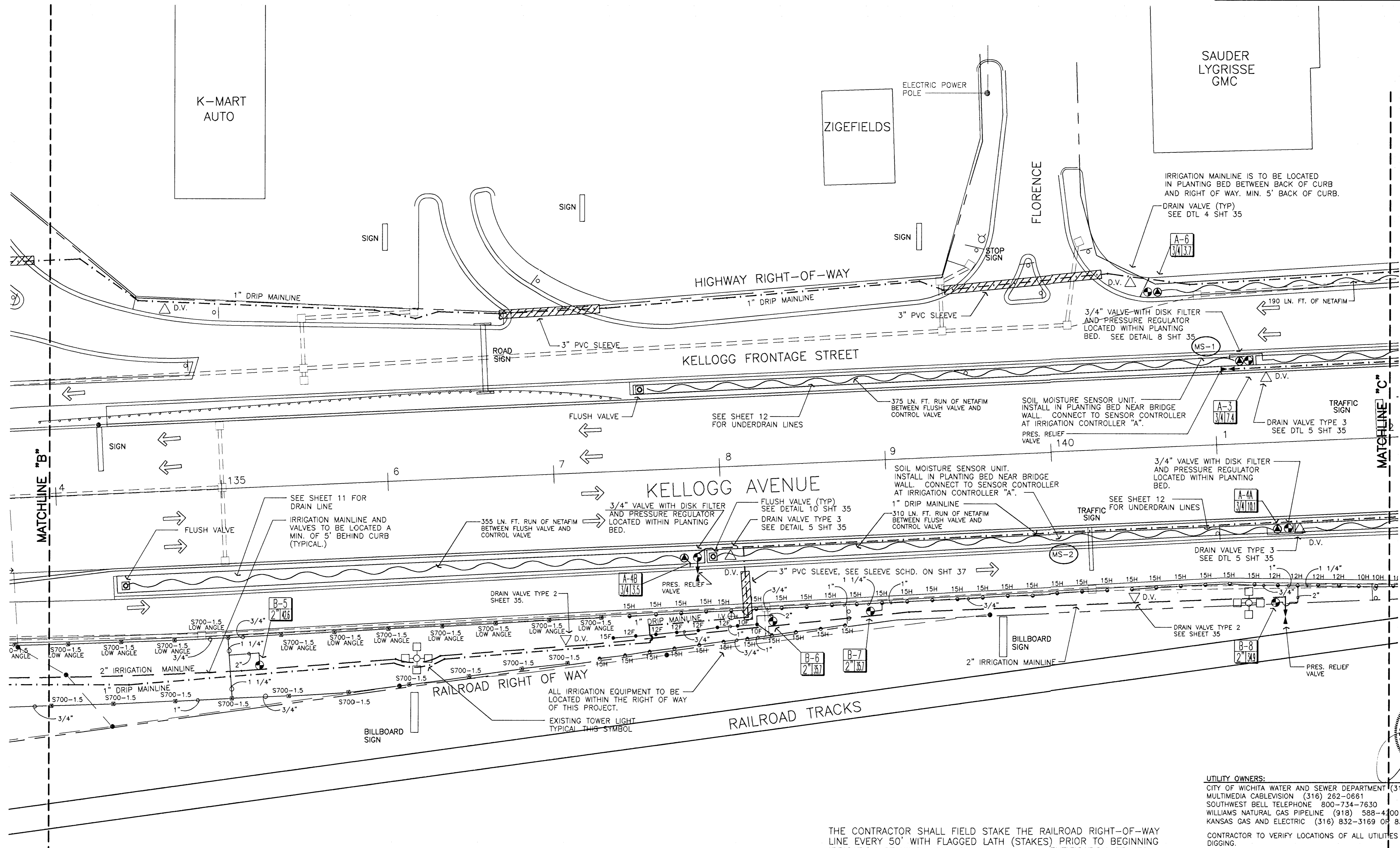

NOTE:
 SEE SHEETS 35 AND 36 FOR IRRIGATION DETAILS
 SEE SHEET 37 FOR IRRIGATION NOTES AND LEGEND
 SEE SHEET 12 FOR DRAIN TILE LOCATIONS

THE CONTRACTOR SHALL FIELD STAKE THE RAILROAD RIGHT-OF-WAY LINE EVERY 50' WITH FLAGGED LATH (STAKES) PRIOR TO BEGINNING IRRIGATION STAKING. MAINTAIN THE R.O.W. IDENTIFICATION STAKES THROUGHOUT THE IRRIGATION CONSTRUCTION PERIOD. INSTALL ALL SPRINKLERS A MINIMUM OF 18" WITHIN KDOT R.O.W. UNLESS SPECIFICALLY APPROVED OTHERWISE BY THE RAILROAD. DO NOT DISTURB ANY SOIL OR VEGETATION SOUTH OF THE KDOT - RR R.O.W. LINE.

ASK THE RAILROAD REPRESENTATIVE TO REVIEW AND APPROVE SHEETS 28, 29 AND 30 OF THESE DRAWINGS. PROVIDE THE CITY AND KDOT A LETTER FROM THE RAILROAD APPROVING THE THREE SHEETS MENTIONED ABOVE.

UTILITY OWNERS:
 CITY OF WICHITA WATER AND SEWER DEPARTMENT (316) 268-4908
 MULTIMEDIA CABLEVISION (316) 262-0661
 SOUTHWEST BELL TELEPHONE 800-734-7630
 WILLIAMS NATURAL GAS PIPELINE (918) 588-4300
 KANSAS GAS AND ELECTRIC (316) 832-3169 OR 832-3180

CONTRACTOR TO VERIFY LOCATIONS OF ALL UTILITIES PRIOR TO DIGGING.

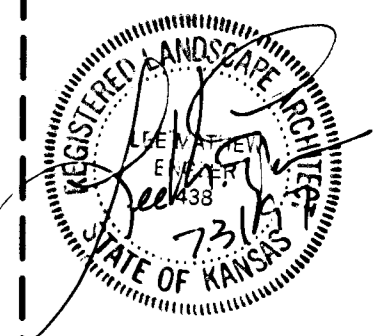

KANSAS DEPARTMENT OF TRANSPORTATION
**KELLOGG AND WEST STREET
 STATION 134+00 TO 142+00
 IRRIGATION PLAN**
 PROJECT NO. #701227

Wilson Darnell Mann
 architecture site planning interiors
 Wichita, Kansas

DESIGNED BY: WDM, PA CHECKED BY: LME
 DRAWN BY: SKW DATE: 7/31/97 SHEET 29 OF 43

2-17-97
 E:\94082\U-3
 E:\94082\MAINBASE E:\94082\IRRIC