

FHWA REG. NO.	STATE	PROJECT NO.	YEAR	SHEET NO.	SHEETS
7	KANSAS	54-87-TE-0039-01	1997	33	43

UTILITY OWNERS:  
 CITY OF WICHITA WATER AND SEWER DEPARTMENT (316) 268-4908  
 MULTIMEDIA CABLEVISION (316) 262-0661  
 SOUTHWEST BELL TELEPHONE 800-734-7630  
 WILLIAMS NATURAL GAS PIPELINE (918) 588-4200  
 KANSAS GAS AND ELECTRIC (316) 832-3169 OR 832-3180

CONTRACTOR TO VERIFY LOCATIONS OF ALL UTILITIES PRIOR TO DIGGING.

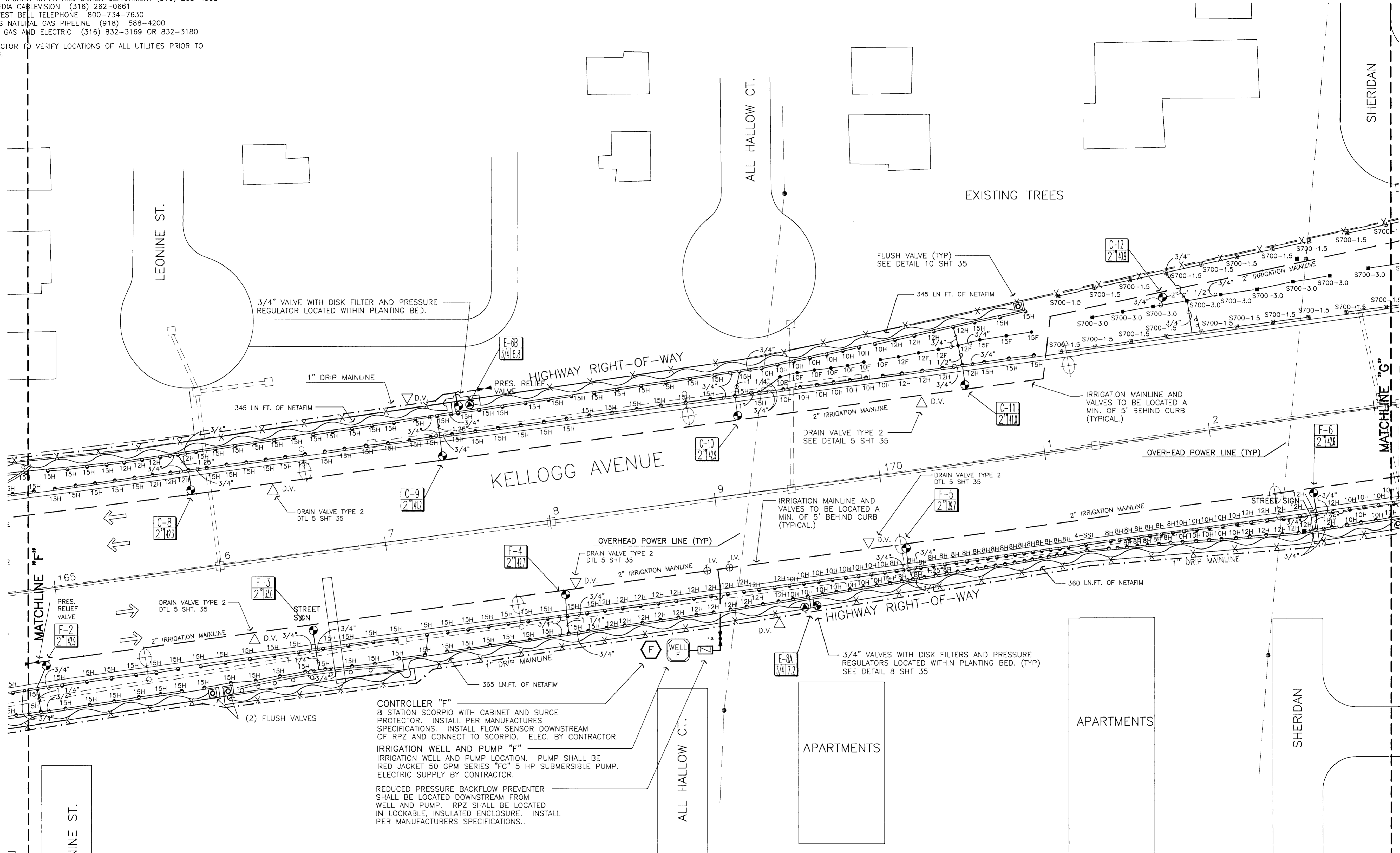

**CONTROLLER "F"**  
 8 STATION SCORPIO WITH CABINET AND SURGE PROTECTOR. INSTALL PER MANUFACTURERS SPECIFICATIONS. INSTALL FLOW SENSOR DOWNSTREAM OF RPZ AND CONNECT TO SCORPIO. ELEC. BY CONTRACTOR.

**IRRIGATION WELL AND PUMP "F"**  
 IRRIGATION WELL AND PUMP LOCATION. PUMP SHALL BE RED JACKET 50 GPM SERIES "FC" 5 HP SUBMERSIBLE PUMP. ELECTRIC SUPPLY BY CONTRACTOR.

REDUCED PRESSURE BACKFLOW PREVENTER SHALL BE LOCATED DOWNSTREAM FROM WELL AND PUMP. RPZ SHALL BE LOCATED IN LOCKABLE, INSULATED ENCLOSURE. INSTALL PER MANUFACTURERS SPECIFICATIONS.

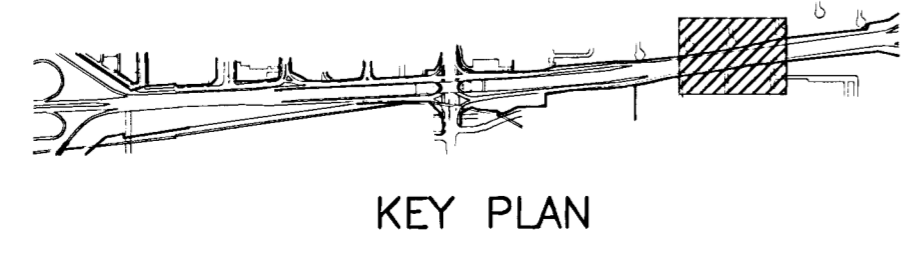
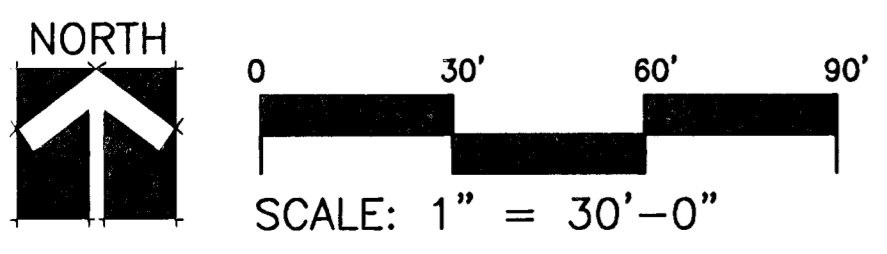

NOTE:  
 SEE SHEETS 35 AND 36 FOR IRRIGATION DETAILS  
 SEE SHEET 37 FOR IRRIGATION NOTES AND LEGEND

KANSAS DEPARTMENT OF TRANSPORTATION  
 KELLOGG AND WEST STREET  
 STATION 165+00 TO 173+00  
 IRRIGATION PLAN  
 PROJECT NO. # 101227

**Wilson Darnell Mann**  
 architecture site planning interiors  
 Wichita, Kansas

DESIGNED BY: WDM, PA      CHECKED BY: LME  
 DRAWN BY: SKW      DATE: 7/31/97      SHEET 33 OF 43

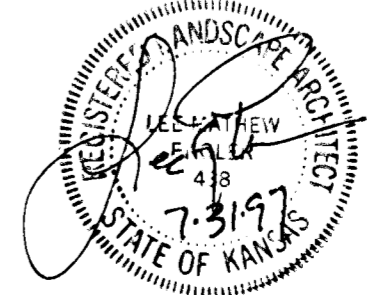

13-10  
 08/19/1997  
 K: 94082 IRRIGALI-7  
 E: 94082 MAINBASE E: 94082 IRRIG