

BENCHMARKS:

BM #1: "□" Cut in top of curb, south of SE corner of Lot 82, Block A, Turkey Creek 3rd Addition.
Elev. = 1335.49 NGVD29

BM #2: "□" Cut in top of curb inlet, SW of the SE corner of Lot 81, Block A, Turkey Creek 3rd Addition.
Elev. = 1335.95 NGVD29

BM #3: "□" Cut in top of yard inlet, 5' N & 43.5' E of the SE corner of Lot 28, Block H, Turkey Creek 3rd Addition.
Elev. = 1335.95 NGVD29

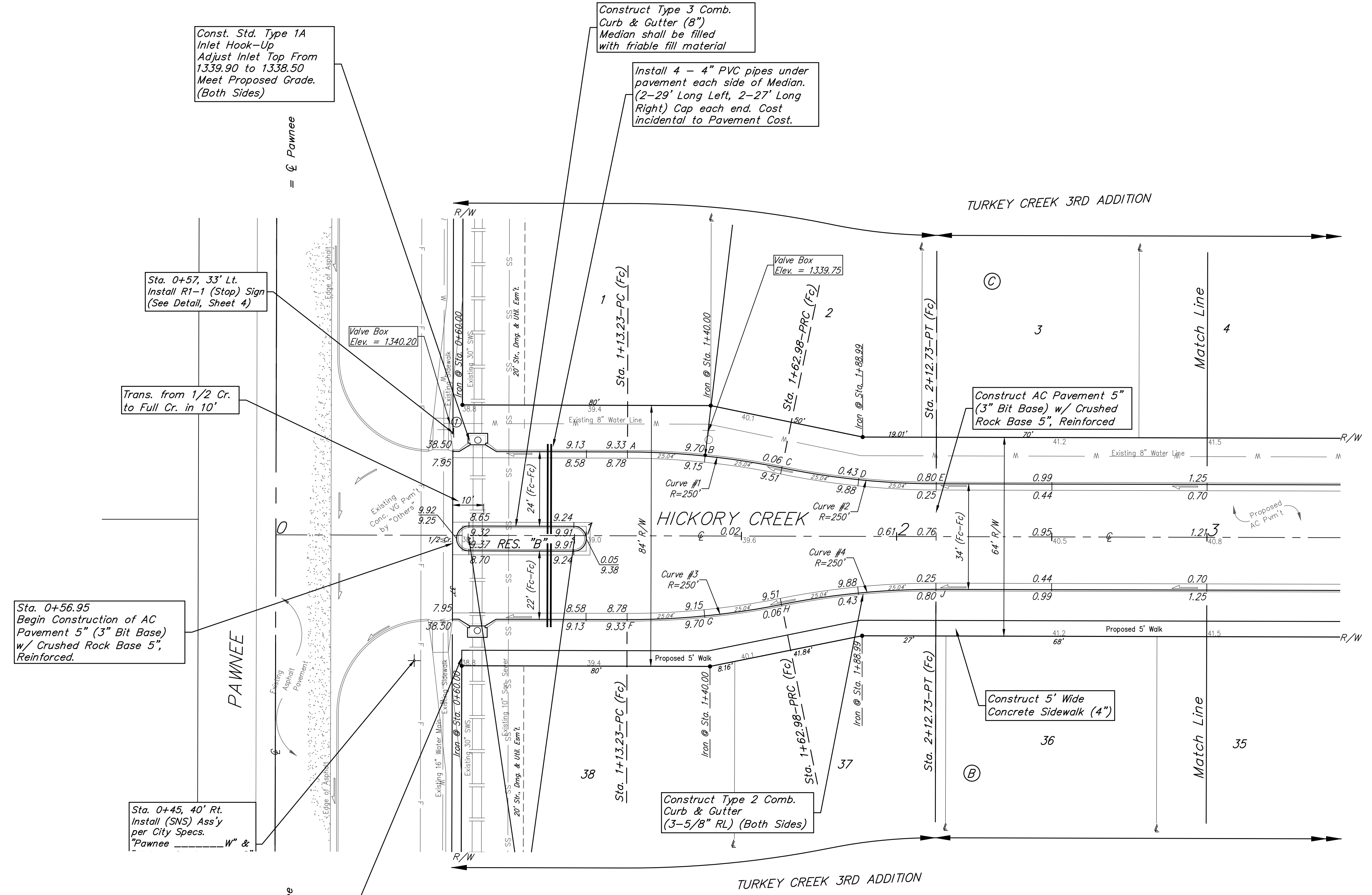
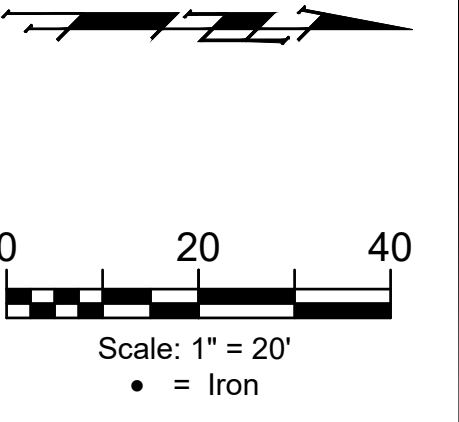

Sta. 0+56.95
Begin Construction of AC
Pavement 5" (3" Bit Base)
w/ Crushed Rock Base 5",
Reinforced.

Sta. 0+45, 40' Rt.
Install (SNS) Ass'y
per City Specs.
"Pawnee" W" &

Sta. 0+56.95
Begin Construct of
5' Wide Concrete
Sidewalk (4")

Const. Std. Type 1A
Inlet Hook-Up
Adjust Inlet Top From
1339.90 to 1338.50
Meet Proposed Grade.
(Both Sides)

Construct Type 3 Comb.
Curb & Gutter (8")
Median shall be filled
with friable fill material

Install 4 - 4" PVC pipes under
pavement each side of Median.
(2-29' Long Left, 2-27' Long
Right) Cap each end. Cost
incidental to Pavement Cost.

Construct AC Pavement 5"
(3" Bit Base) w/ Crushed
Rock Base 5", Reinforced

Construct 5' Wide
Concrete Sidewalk (4")

Construct Type 2 Comb.
Curb & Gutter
(3-5/8" RL) (Both Sides)

Curve #1

Curve Data Based on Face of Curb

Rad. = 250' Delta = 1128'42" Tangent = 25.13'
Arc = 50.08' L.C. = 50.00' Def./Ft. = 6.87600 Min.

Station	Arc	Chord 8' Lt.	Defl. 8' Lt.	Total Defl.
A	-	-	0'00"00"	0'00"00"
B	25.04'	25.83'	2'52"11"	2'52"11"
C	25.04'	25.83'	2'52"10"	5'44"21"

Curve #2

Curve Data Based on Face of Curb

Rad. = 250' Delta = 1128'42" Tangent = 25.13'
Arc = 50.08' L.C. = 50.00' Def./Ft. = 6.87600 Min.

Station	Arc	Chord 8' Lt.	Defl. 8' Lt.	Total Defl.
C	-	-	0'00"00"	0'00"00"
D	25.04'	24.23'	2'52"11"	2'52"11"
E	25.04'	24.23'	2'52"10"	5'44"21"

Curve #3

Curve Data Based on Face of Curb

Rad. = 250' Delta = 1128'42" Tangent = 25.13'
Arc = 50.08' L.C. = 50.00' Def./Ft. = 6.87600 Min.

Station	Arc	Chord 8' Rt.	Defl. 8' Rt.	Total Defl.
F	-	-	0'00"00"	0'00"00"
G	25.04'	25.83'	2'52"11"	2'52"11"
H	25.04'	25.83'	2'52"10"	5'44"21"

Curve #4

Curve Data Based on Face of Curb

Rad. = 250' Delta = 1128'42" Tangent = 25.13'
Arc = 50.08' L.C. = 50.00' Def./Ft. = 6.87600 Min.

Station	Arc	Chord 8' Rt.	Defl. 8' Rt.	Total Defl.
H	-	-	0'00"00"	0'00"00"
I	25.04'	24.23'	2'52"11"	2'52"11"
J	25.04'	24.23'	2'52"10"	5'44"21"

Roll type curb & gutter to
be constructed on the pavement
on this sheet.
Top of curb elevation are given
for full height curb.

**BAUGHMAN
COMPANY**
315 Ellis St.
Wichita, KS 67211
316-262-7271
BaughmanCo.com

TURKEY CREEK 3RD ADDITION
PHASE 4

HICKORY CREEK

Street Paving Improvements
Sta. 0+00 to Sta. 3+00

PROJECT NUMBER:
472-2020-085616

DESIGN: DMV DRAWN: JAK
DATE: Mar. 31, 2021

SHEET OF
7 26

File: E:\Projects\Turkey Creek 3rd\Engineering\Phase 4\Str. 20-02-E497\STR PLANS.dwg