

BENCHMARKS:

BM #1: "□" Cut in top of curb, south of SE corner of Lot 82, Block A, Turkey Creek 3rd Addition.
Elev. = 1335.49 NGVD29

BM #2: "□" Cut on top of curb inlet, SW of the SE corner of Lot 81, Block A, Turkey Creek 3rd Addition.
Elev. = 1335.95 NGVD29

BM #3: "□" Cut on top of yard inlet, 5' N & 43.5' E of the SE corner of Lot 28, Block H, Turkey Creek 3rd Addition.
Elev. = 1335.95 NGVD29

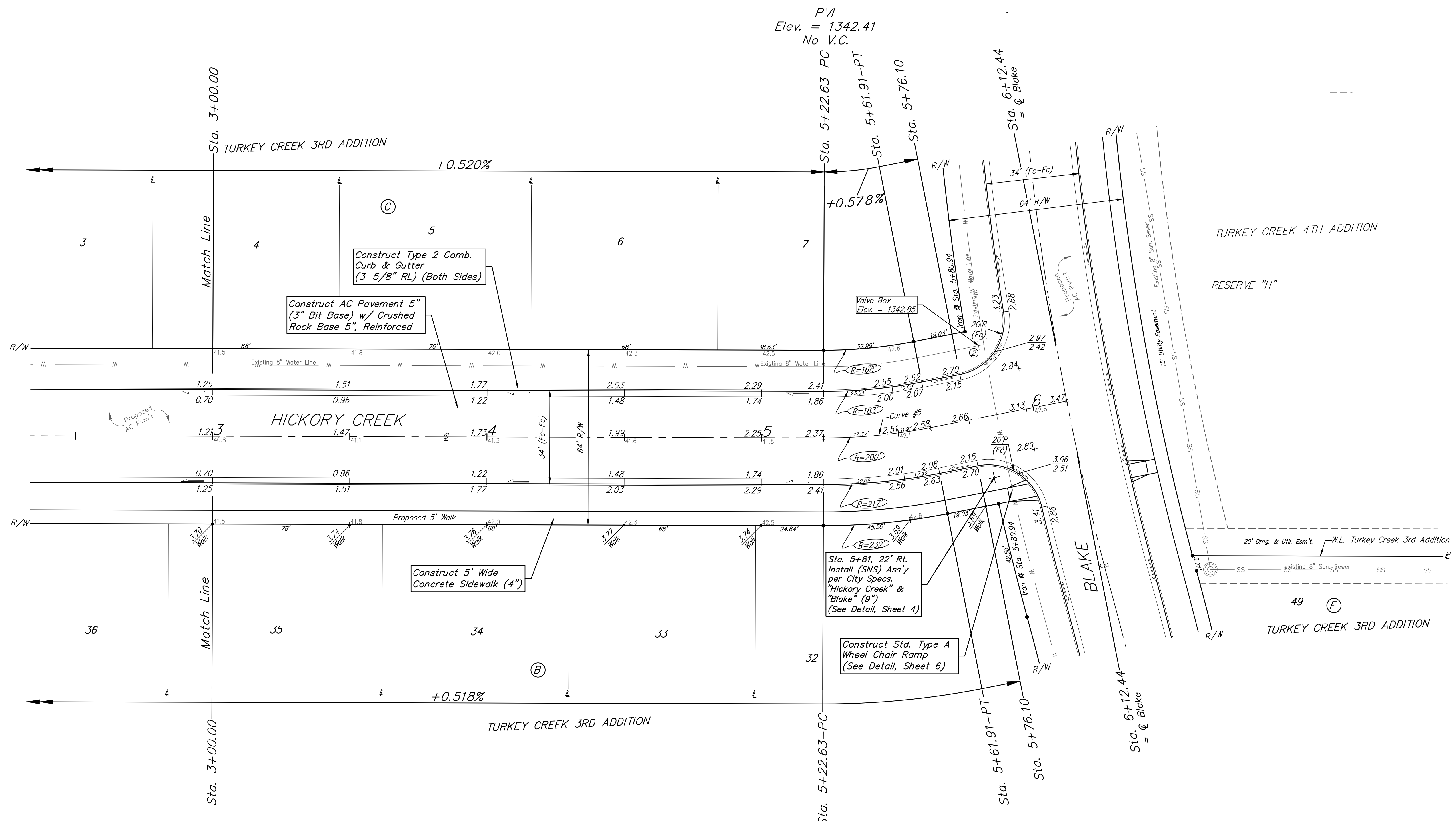
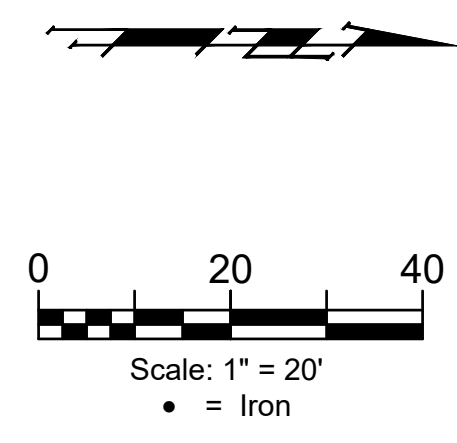

Curve #5
Curve Data Based on Centerline
Rad. = 200' Delta = 11°15'03" Tangent = 19.70'
Arc = 39.28' L.C. = 39.21' Def./Ft. = 8.59280 Min.

Station	Arc	Face Chord Lengths		Defl.	Total Defl.
		8' Left	8' Right		
5+22.63	-	-	-	0°00'00"	0°00'00"
5+25.00	2.37'	2.07'	2.67'	0°20'22"	0°20'22"
5+50.00	25.00'	21.86'	28.10'	3°34'49"	3°55'11"
5+61.91	11.91'	10.42'	13.39'	1°42'20"	5°37'31"

Roll type curb & gutter to be constructed on the pavement on this sheet.
Top of curb elevation are given for full height curb.



BAUGHMAN COMPANY

315 Ellis St.
Wichita, KS 67211
316-262-7271
BaughmanCo.com

TURKEY CREEK 3RD ADDITION
PHASE 4

HICKORY CREEK

Street Paving Improvements
Sta. 3+00 to Sta. 5+76.10

PROJECT NUMBER:
472-2020-085616

DESIGN: DMV DRAWN: JAK

DATE: Mar. 31, 2021

SHEET OF
8 26

File: E:\Projects\Turkey Creek 3rd\Engineering\Phase 4\Str. 20-02-E497\STR PLANS.dwg