

Street Paving for HASKELL ST to serve

TURKEY CREEK 4TH ADDITION - PHASE 1A

HASKELL ST: From the West Line of the Plat, East to the Line of Lot 13, Block A

HASKELL CT: (Lots 1-13, Block A) From the South Line of Haskell St, South to and including the Cul-de-sac

HASKELL CT: (Lots 44-53, Block A) From the North Line of Haskell St, North to and including the Cul-de-sac

CITY OF WICHITA, KANSAS

Gary Janzen, P.E. City Engineer

Project Number: 472-2020-085617

47466220 E0071

GENERAL NOTES:

- Contractor will be required to provide notice to utility companies a minimum of forty-eight (48) hours prior to any excavation, as follows:

Kansas One-Call	687-2470
Cox Communications	262-4270
Kansas Gas Service	1-888-482-4950
Westar Energy	383-8650
Aquila Energy	1-800-303-0357
ATT	268-2245
City of Wichita Water Dept.	268-4563
City of Wichita Sewer Maint.	268-4024
City of Wichita Storm Sewer Maint.	268-4090
City of Wichita Traffic Maint.	268-4034
Conoco Phillips Pipeline Co.	1-877-267-2290
Southern Star Pipeline Co.	529-6600
Kinder-Morgan Pipeline Co.	1-888-844-5658

The Contractor must notify the following in case of an emergency:
- A saw cut of at least one-half the depth of existing surface courses or one-fourth the depth of the existing total pavement thickness shall be provided at locations where proposed construction abuts the existing surface course or pavement for which partial removal of that surface or pavement is required. Sawed joint to facilitate removal within three (3) feet of existing joints will not be permitted and for such instances the limits of removal shall extend to the existing joint. Such saw cuts will not be paid for directly and this cost shall be considered as subsidiary to the removal of the surface or pavement.
- All areas disturbed during construction shall be seeded as follows:
(Temporary Seeding)
SEED --- Rye grass (PLS) --- 5 Lbs/1,000 Sq Ft.
- The Contractor shall drain any standing water in sump areas of the proposed pavement. Contractor shall overexcavate and recompact these areas as required to maintain compaction of 95% Standard Proctor Density. Cost to be incidental to pavement.
- Limits of earthwork shall match existing ground elevations at the right-of-way line unless otherwise noted on the plans with a new finished grade elevation. When a new finished grade elevation is shown, the earthwork shall extend one foot beyond the right-of-way line and then slope up or down using permissible slopes to match the existing ground surface.
- The Developer for this project is Paul Kelsey, 716 N. 119th St. #112, Wichita, KS 67212
PH# (316)722-1077 email paul.kelsey@gmail.com
- Excess excavation shall be spread on-site evenly on lots within the benefit district outside of easements.

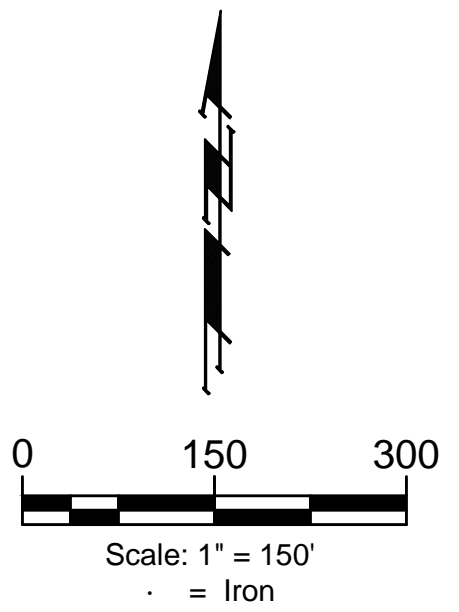
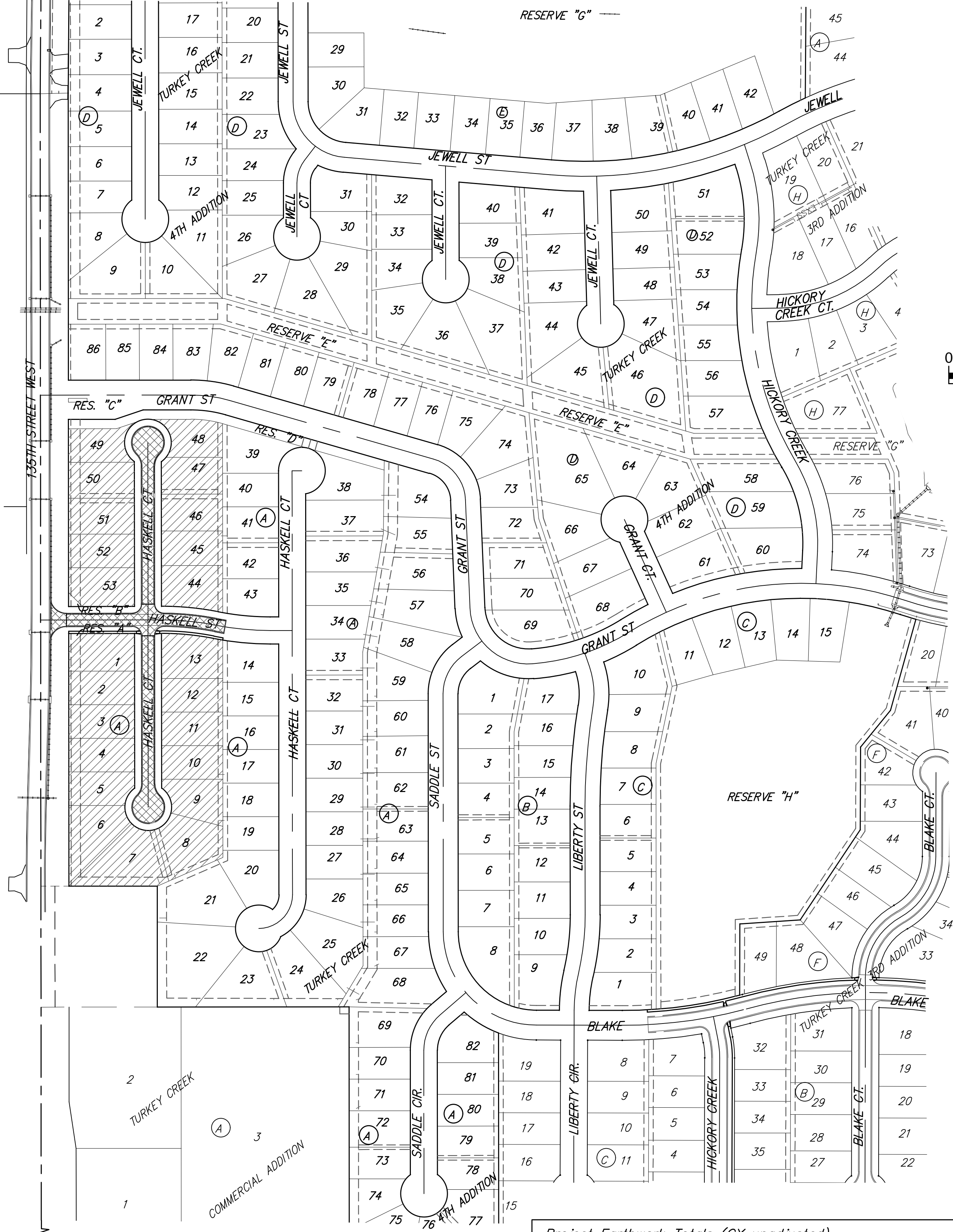

SHEET INDEX

Title Sheet	1
Asphalt Paving Detail	2
Curb & Gutter Details	3
Sign Details	4
Valley Gutter Details	5
Haskell Street	6
Haskell Ct (Lots 1-13)	7
Haskell Ct (Lots 44-53)	8
Erosion Control Plan	9
Erosion Control BMP Details	10-14
Inlet Underdrain Detail	15
Cross Sections	16-20
Coordinate Sheet	21
Copy of Plat	22

BENCHMARKS

135th St. W. & Pawnee
City of Wichita Benchmark Disc,
Northeast Corner of Intersection
On SW Corner of Concrete Base
of High Line Pole.
Elev. = 1359.65 NGVD29

City of Wichita Benchmark Disc,
0.4 Mi. South of Kellogg On
135th St. W., West Side of
Concrete Base for High Line
Pole, West of K.G.&E.
Substation, 135'± South of
Railroad Tracks On East Side of
135th St. W.
Elev. = 1367.77 NGVD29

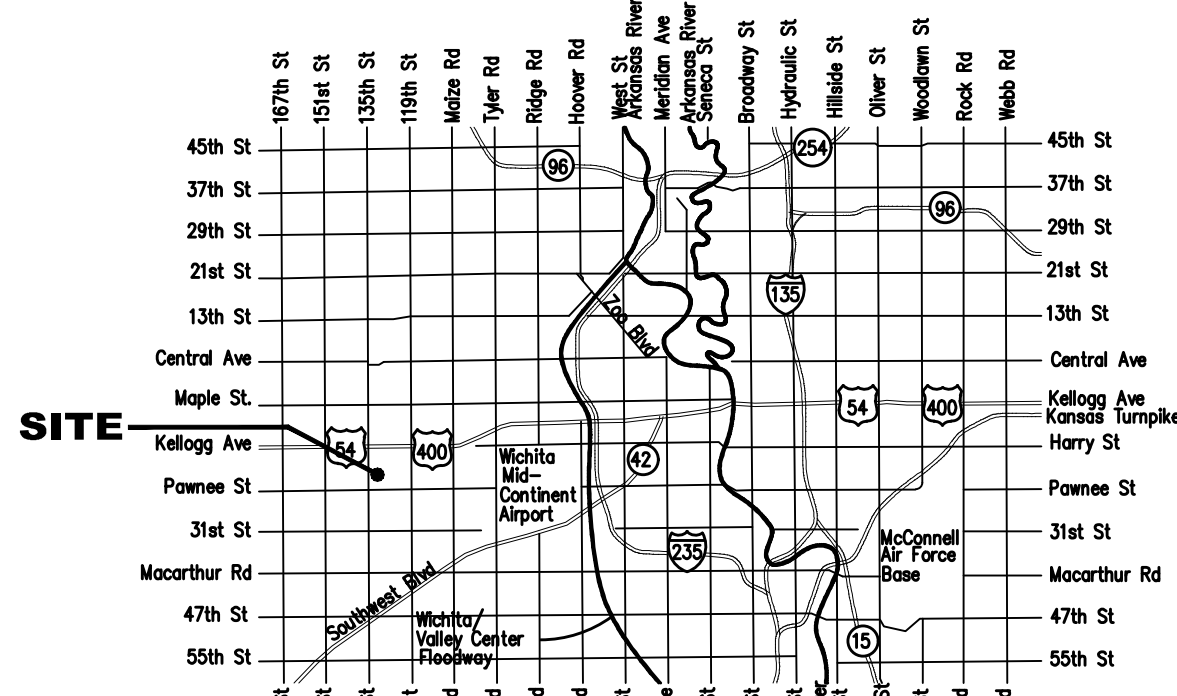

Project Earthwork Totals (CY unadjusted)			
	Excavation	Compacted Fill	Loose Fill
Street (R/W)	625	15	485
Total Project Length			
1,129 L.F. = 0.21 Miles			

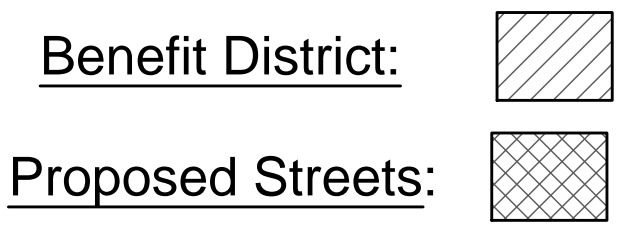

E:\Projects\Turkey Creek 4th Engineering\Phase 1A\Str_2001-E4571\STR PLANS.dwg

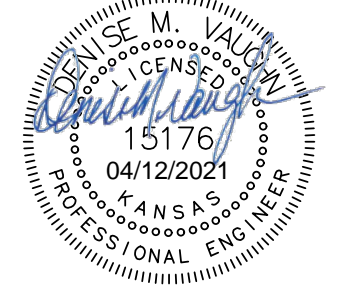

APR. 2, 2021

BAUGHMAN COMPANY
315 Ellis St. Wichita, KS 67211 316-262-7271
BaughmanCo.com