

**BENCHMARKS:**  
 135th St. W. & Pawnee  
 City of Wichita Benchmark Disc,  
 Northeast Corner of Intersection  
 On SW Corner of Concrete Base  
 of High Line Pole.  
 Elev. = 1359.65 NGVD29

City of Wichita Benchmark Disc,  
 0.4 Mi. South of Kellogg On  
 135th St. W., West Side of  
 Concrete Base for High Line  
 Pole, West of K.G.&E.  
 Substation, 135± South of  
 Railroad Tracks On East Side of  
 135th St. W.  
 Elev. = 1367.77 NGVD29

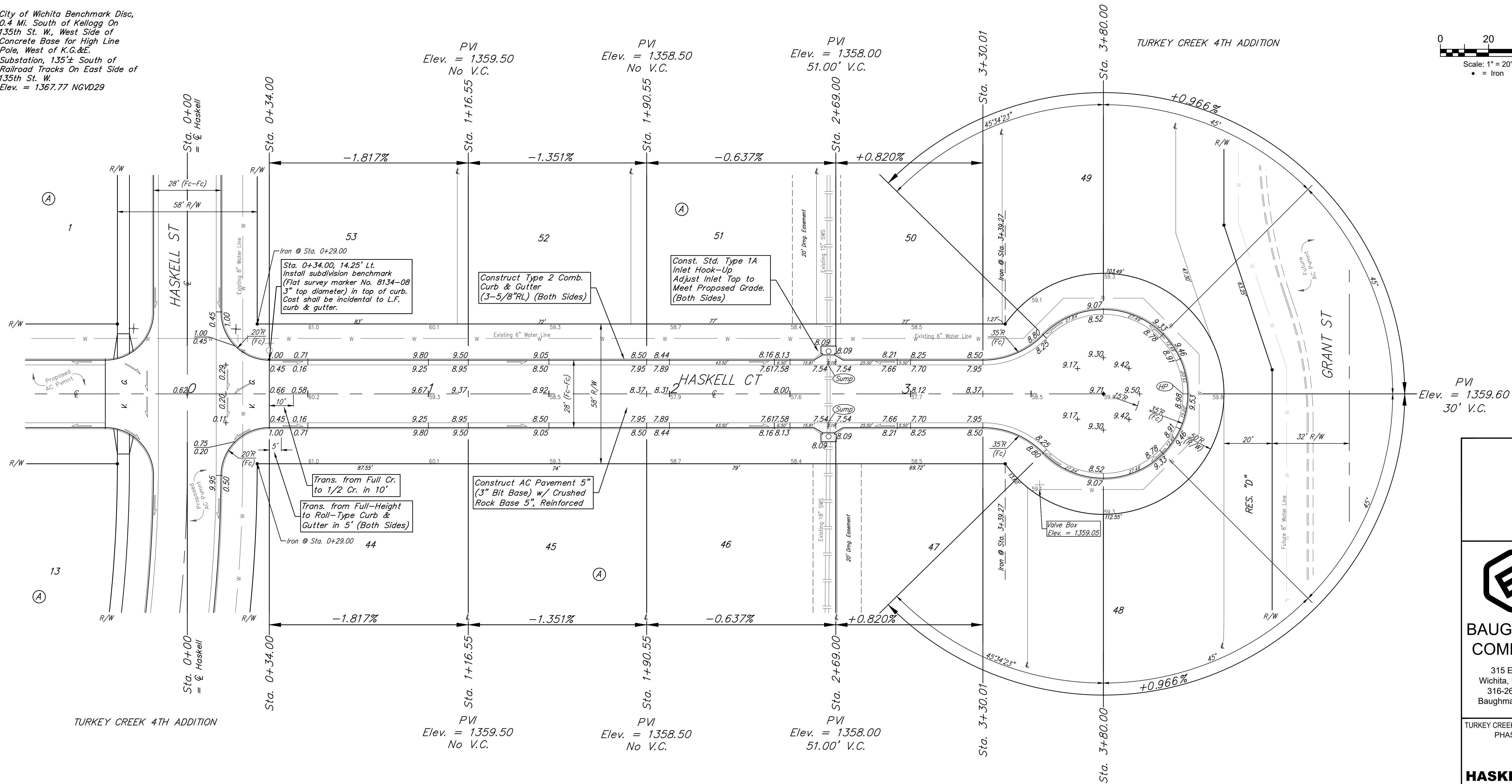
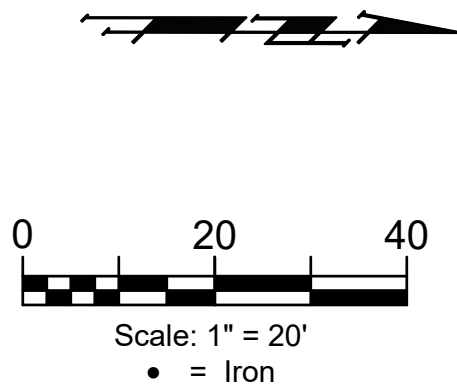

**Subdivision Bench Marks**

Street & Station	Location Description	Elevation
Haskell Ct. 2+19.67, 14.25' Lt.	Adjacent to Fire Hydrant East of the NE Cor., Lot 3, Blk A, Turkey Creek 4th Addn.	
Haskell Ct. 0+34.00, 14.25' Lt.	Adjacent to Fire Hydrant at North End of the West Return Haskell & Haskell Ct, SE Cor., Lot 53, Blk A, Turkey Creek 4th Addn.	

**VALVE LOCATION TABLE**

VALVE NUMBER	STREET	BASELINE STATION	OFFSET DISTANCE	OFFSET DIRECTION
1	Haskell	0+52.00	23'	Lt.
2	Haskell	2+07.00	21'	Lt.
3	Haskell	2+07.00	23'	Lt.
4	Haskell	3+95.77	27'	Lt.

Roll type curb & gutter to be constructed on the pavement on this sheet.  
 Top of curb elevation are given for full height curb.

**BAUGHMAN COMPANY**  
 315 Ellis St.  
 Wichita, KS 67211  
 316-262-7271  
 BaughmanCo.com

TURKEY CREEK 4TH ADDITION  
 PHASE 1A

**HASKELL CT**

Street Paving Improvements  
 Lots 44-53, Block A  
 PROJECT NUMBER:  
 472-2020-085617  
 DESIGN: DMV DRAWN: JAK  
 DATE: APR. 2, 2021  
 SHEET OF  
**8 22**

File: E:\Projects\Turkey Creek 4th Addn\Engineering\Phase 1A\Str. 20-01-E457\STR PLANS.dwg