

**BENCHMARKS:**  
 135th St. W. & Pawnee  
 City of Wichita Benchmark Disc,  
 Northeast Corner of Intersection  
 On SW Corner of Concrete Base  
 of High Line Pole.  
 Elev. = 1359.65 NGVD29

City of Wichita Benchmark Disc,  
 0.4 Mi. South of Kellogg On  
 135th St. W., West Side of  
 Concrete Base for High Line  
 Pole, West of K.G.&E.  
 Substation, 135± South of  
 Railroad Tracks On East Side of  
 135th St. W.  
 Elev. = 1367.77 NGVD29

Contractor to grade  
 easement per section  
 C-C, this sheet.

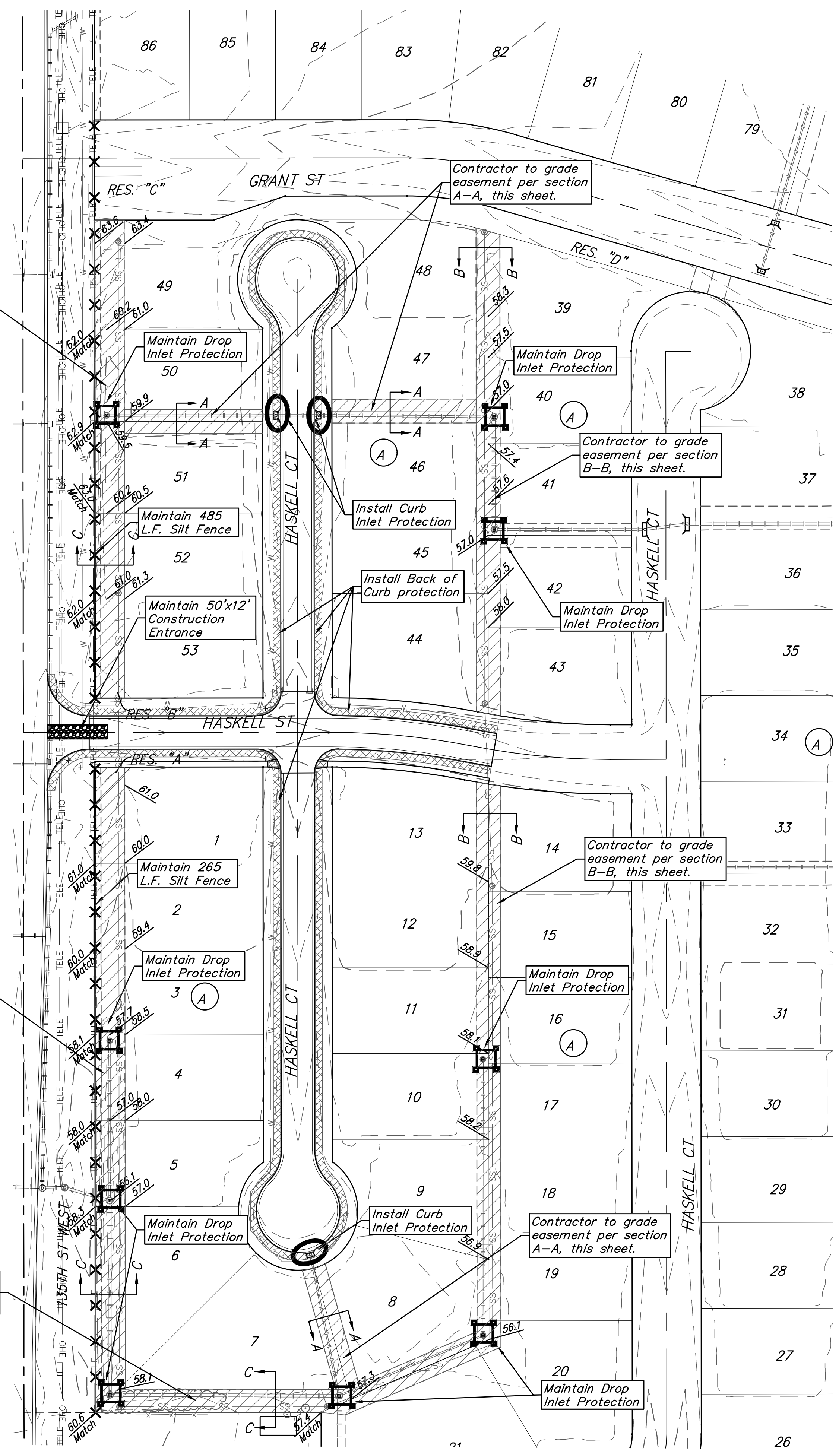

Contractor to grade  
 easement per section  
 C-C, this sheet.

Contractor to grade  
 easement per section  
 C-C, this sheet.

= Easements To Be Graded

All Easement have been previously graded with the Storm Water Drain Project. The Contractor of this project shall "fine grade" all designated easements to the specified elevations.

The Contractor shall grade the easements as shown to the elevations given on the easement grading plan.

The Contractor shall 'straight' grade the easements between the elevations given. Where a callout designates 'Match', the Contractor will grade to the existing ground elevation.

Excess excavation from easement grading and from sanitary sewer construction shall be placed on the lots as indicated to the elevations shown.

All cost to be included in the Lump Sum bid item "Easement Grading"

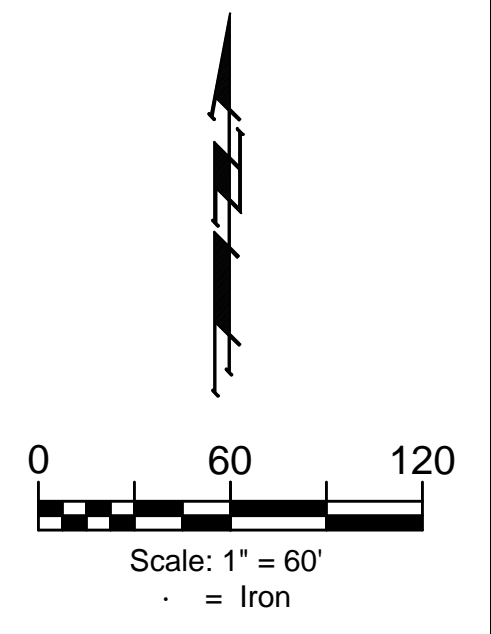

Existing Ground --- 1364 ---

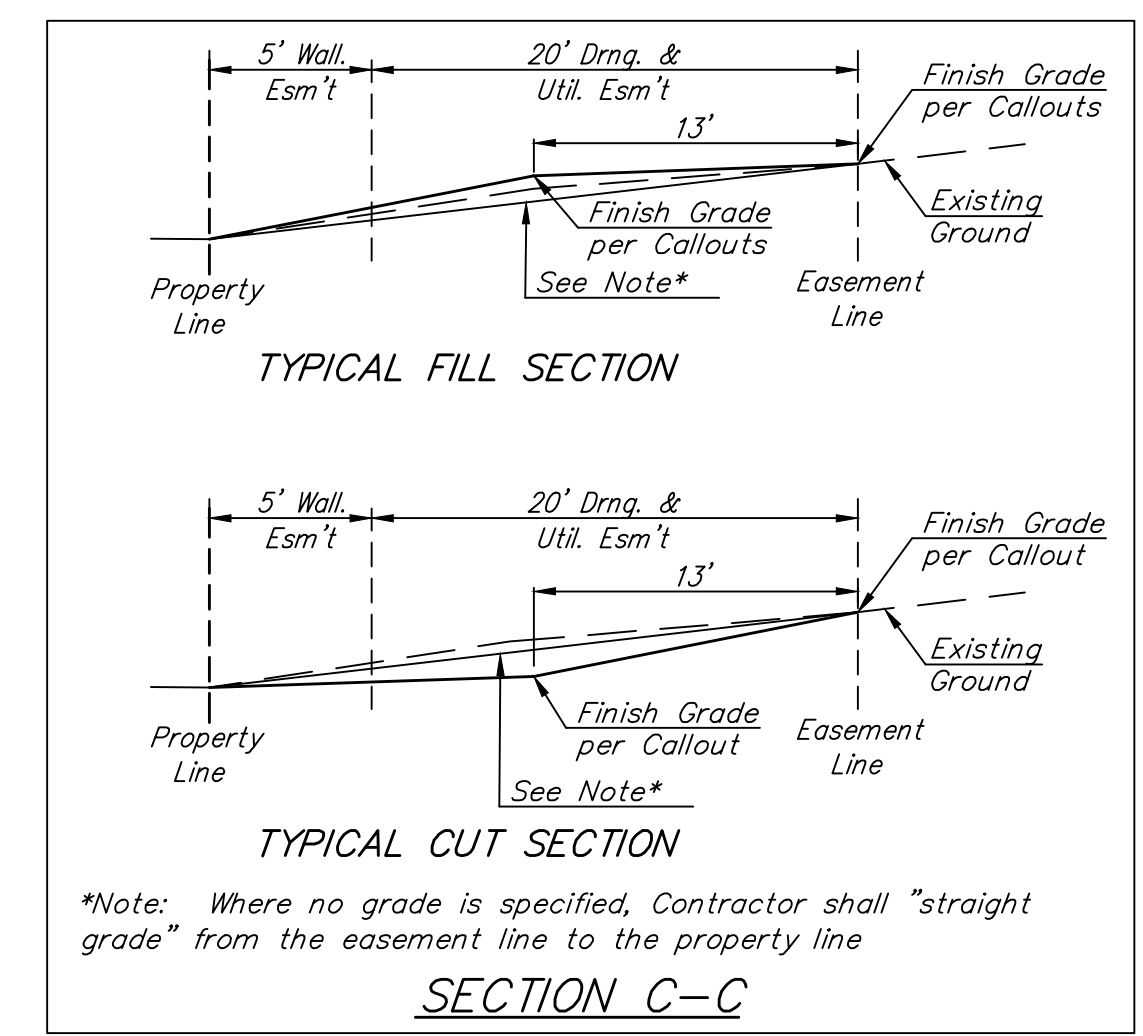
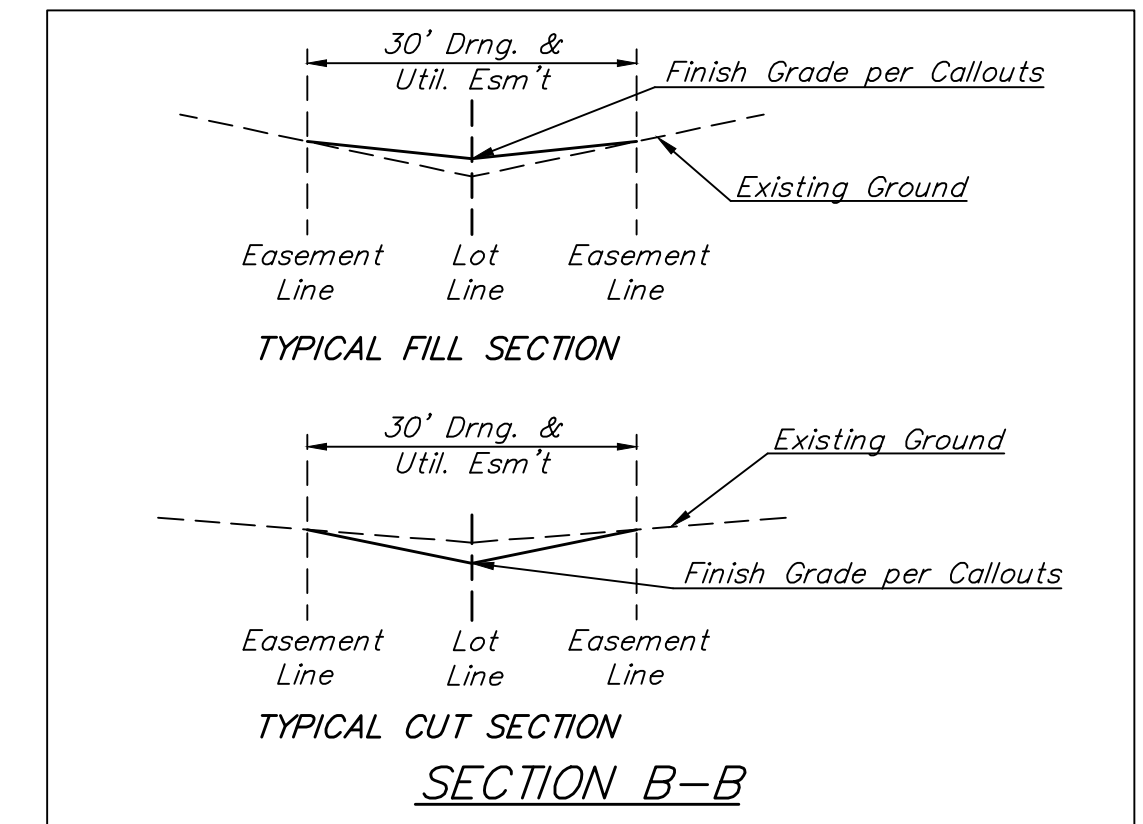
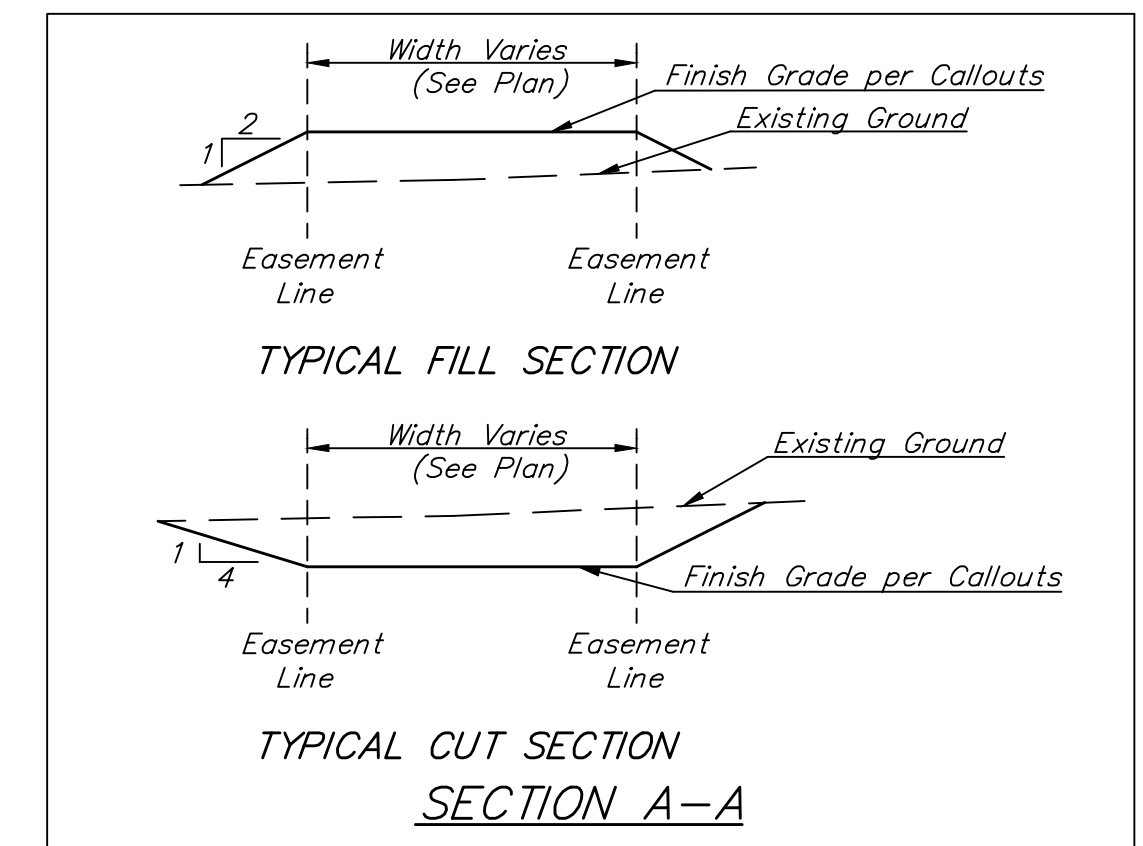
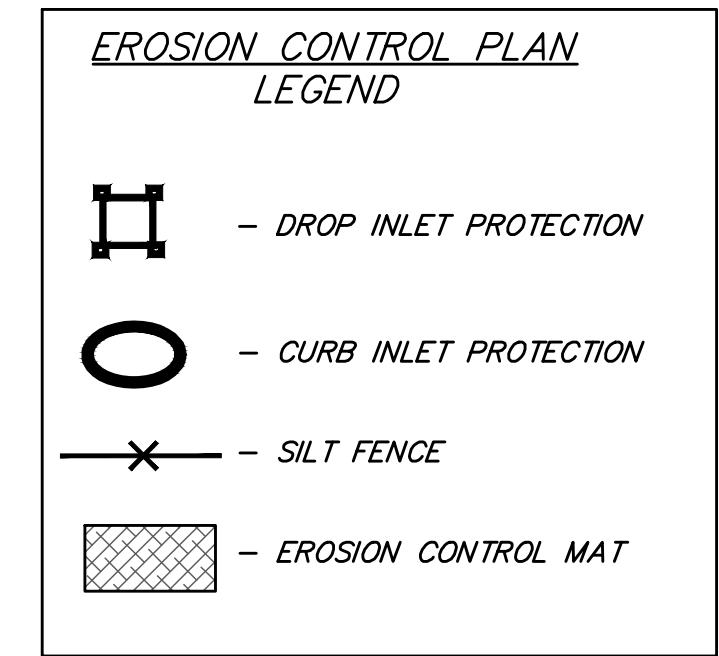

\*Note: Where no grade is specified, Contractor shall "straight grade" from the easement line to the property line

**NOTES:**

1. Contractor shall make sure all erosion control is in place before project is accepted. This plan represents the minimum standard. Any additional erosion control measures shall be installed by the Contractor as needed.

2. Removal of Gravel Construction Entrance for pavement construction shall be included in bid item "Site Clearing & Restoration"

3. This Plan is Not To Be Used As A Comprehensive Grading Plan. All Spot Elevations Are Proposed & Subject To Change.

All areas disturbed during construction shall be seeded, mulched, and fertilized as per Cover Sheet General Notes.

EROSION CONTROL MEASURE	INSTALL	MAINTAIN
BACK OF CURB PROTECTION (LF)	2,451	0
CONSTRUCTION ENTRANCE (EA)	0	1
CURB INLET BARRIER (EA)	3	0
DROP INLET PROTECTION (EA)	0	9

\* ALL EXISTING BMPs INCLUDING CONSTRUCTION ENTRANCE, SEDIMENT BARRIERS, SILT FENCE, CUT-OFF TRENCH, AND EROSION CONTROL MAT SHALL BE MAINTAINED AND REPAIRED IF NECESSARY.

**BAUGHMAN COMPANY**

315 Ellis St.  
 Wichita, KS 67211  
 316-262-7271  
 BaughmanCo.com

TURKEY CREEK 4TH ADDITION  
 PHASE 1A

**EROSION CONTROL EASEMENT GRADING**

Street Paving Improvements  
 Sta. 0+59.06 to Sta. 3+34.42

PROJECT NUMBER:  
 472-2020-085617

DESIGN: DMV DRAWN: JAK

DATE: Apr. 2, 2021

SHEET OF  
 9 22

File: E:\Projects\Turkey Creek 4th\Engineering\Phase 1A\STR\_20-01-E457\STR PLANS.dwg