

**BENCHMARKS:**  
 CUT OFF "T"-POST, DOWN 0.25'  
 13.5' WEST OF POWER POLE  
 30' SOUTH OF FIRE HYDRANT  
 +/- 200' SOUTH OF CENTERLINE  
 DRIVE TO HOUSE # 2816 S MAIZE RD.  
 ELEV. = 1328.386 (NAVD 88)

SQUARE CUT WITH + IN SW QUARTER  
 OF THE SOUTHERNMOST OF THREE  
 CONCRETE DITCH CHECKS  
 +/- 1125' WEST OF CENTERLINE S.  
 MAIZE RD, BEHIND HOUSE #2951 S  
 MAIZE RD.  
 ELEV. = 1332.383 (NAVD88)

**CAUTION!**  
 O/H Elec. Near

**CAUTION!**  
 AT&T Cable Relocated to Area. Verify Location Prior to Construction.

Sta. 0+11.00 to Sta. 0+75.00  
 Install 64.00 L.F. 20" Steel Casing Pipe by Boring and Jacking.\*

BL Sta. 0+00.00 =  $\bar{C}$  Maize Rd.

**\* NOTE:**  
 Cost of 8" Pipe within Steel Casing Pipe shall be bid as L.F. Pipe, WL 8". Cost of Boring and Jacking shall be included in bid item Pipe, Casing (20" ID min.).

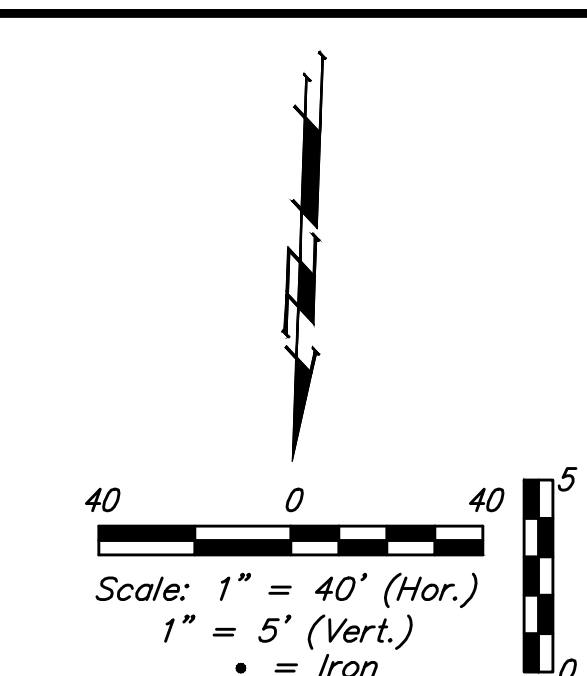

SCHULTE-JOHNSON  
 2ND ADDITION

Pipe layout is shown to be circular for radii under 300'. Contractor may use short pipe lengths, high deflection couplers, and manufacturer recommended pipe deflections and pipe bending to meet planned alignment.

**NOTE:** Maintain 10 ft. of horizontal separation (outside dimension to outside dimension) between the water lines and sanitary sewer lines and manholes.

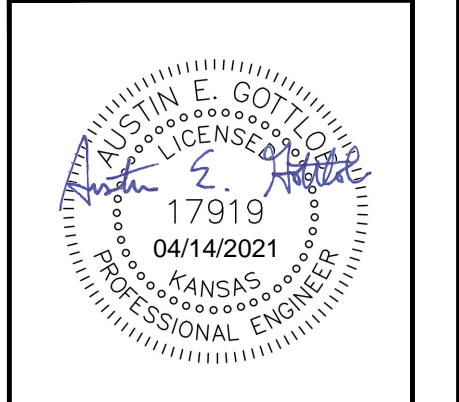
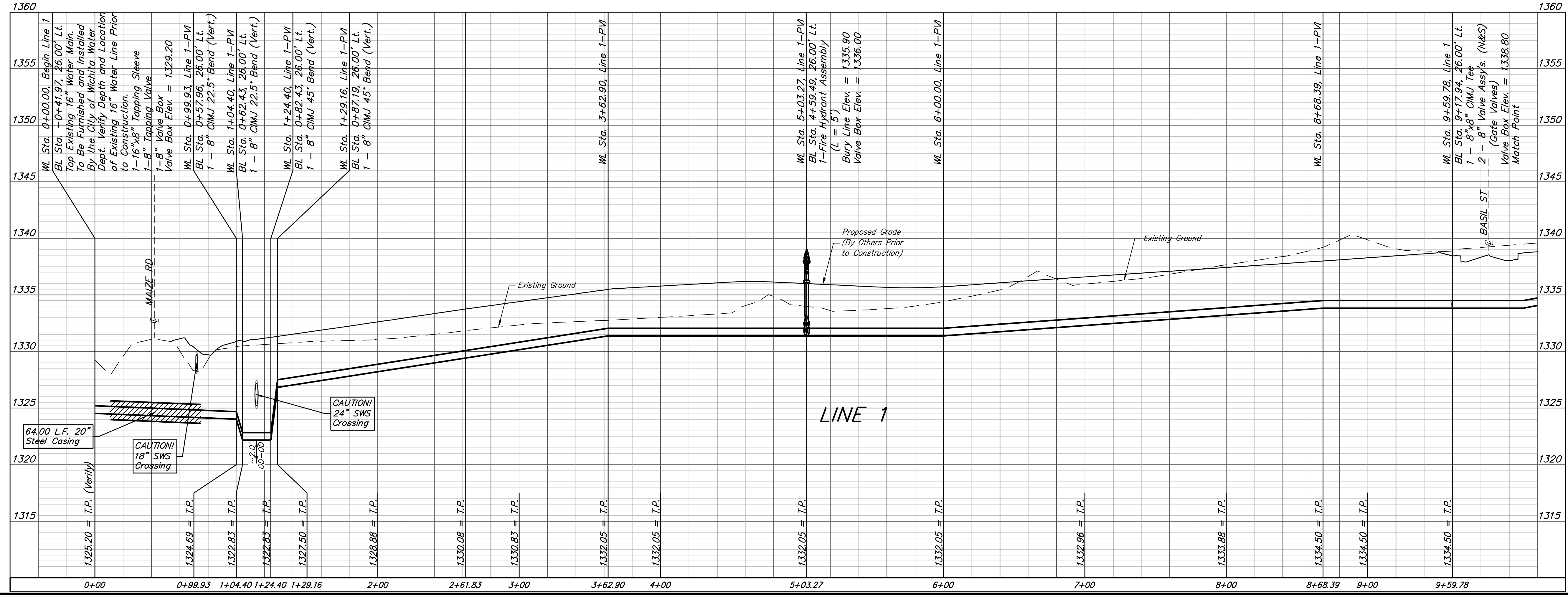

**BAUGHMAN COMPANY**  
 315 Ellis St.  
 Wichita, KS 67211  
 316-262-7271  
 BaughmanCo.com

SCHULTE-JOHNSON 2ND  
 ADD. - PHASE I

LINE 1

WATER DISTRIBUTION  
 SYSTEM

PROJECT NUMBER:  
 448-2019-009457

DESIGN: AEG DRAWN: HWJ  
 DATE: April 12, 2021

SHEET OF  
 4 18

File: C:\Projects\Schulte-Johnson 2nd Addition\Engineering\Phase 1\WTRWTR Plans.dwg