

BENCHMARKS:
 CUT OFF "T"-POST, DOWN 0.25'
 13.5' WEST OF POWER POLE
 30' SOUTH OF FIRE HYDRANT
 +/- 200' SOUTH OF CENTERLINE
 DRIVE TO HOUSE # 2816 S MAIZE RD.
 ELEV. = 1328.386 (NAVD 88)

SQUARE CUT WITH + IN SW WINGWALL
 OF THE SOUTHERNMOST OF THREE
 CONCRETE DITCH CHECKS
 +/- 1125' WEST OF CENTERLINE S.
 MAIZE RD, BEHIND HOUSE #2951 S
 MAIZE RD.
 ELEV. = 1332.383 (NAVD88)

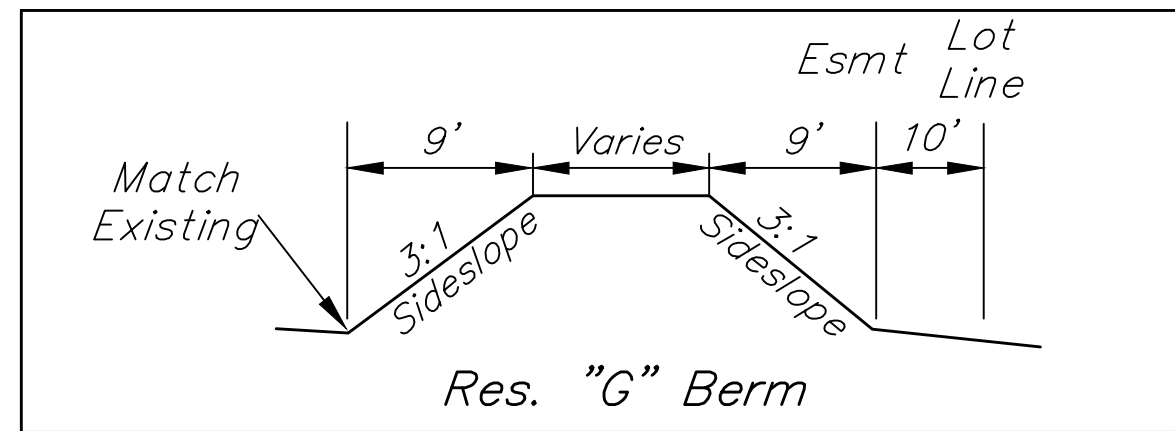

Existing trees which are in direct conflict with proposed new construction shall be removed by the Contractor ONLY with approval of the Developer or Engineer. Trees not in direct conflict with proposed new construction shall remain and be protected from damage. Cost shall be included in bid item "Site Clearing"

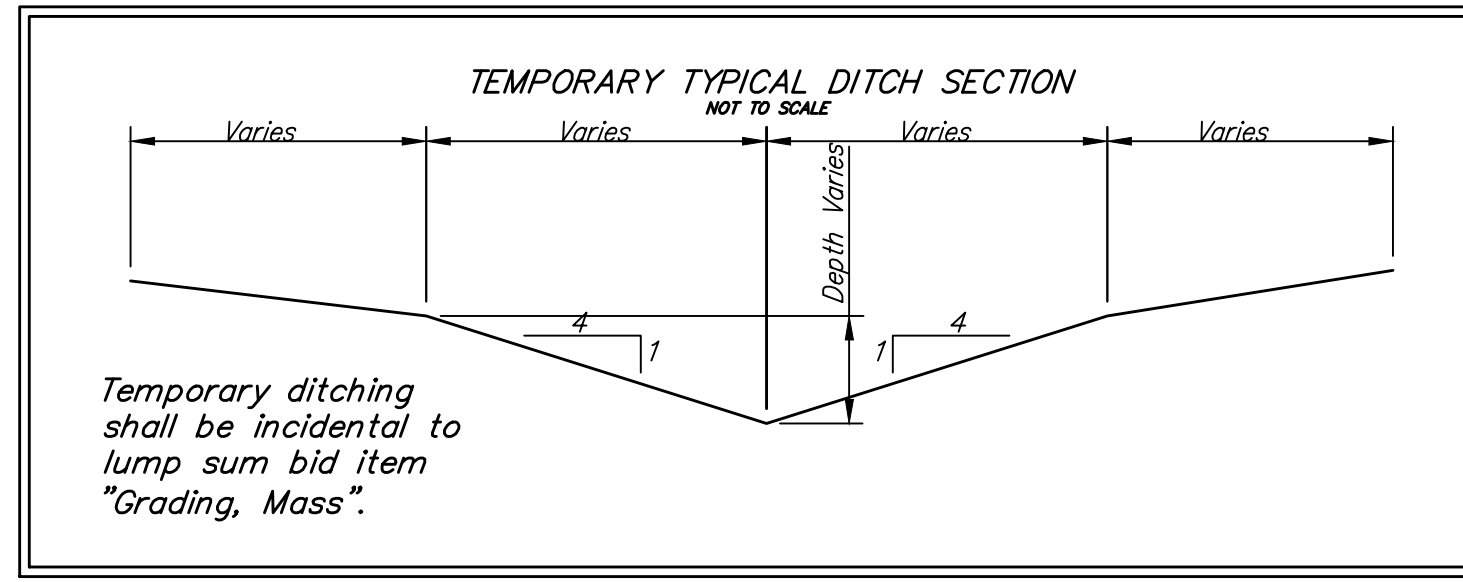
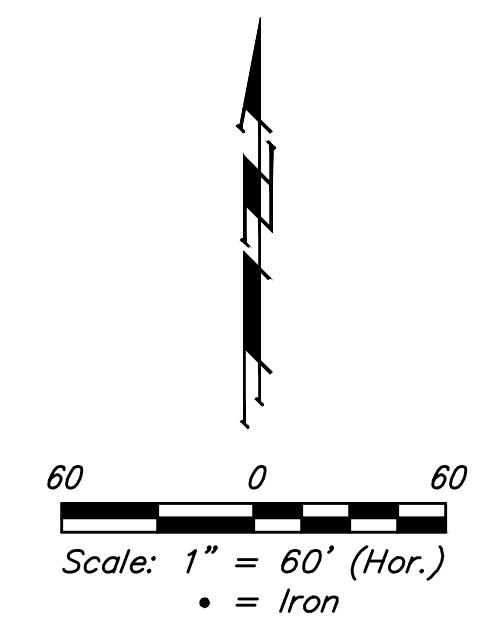
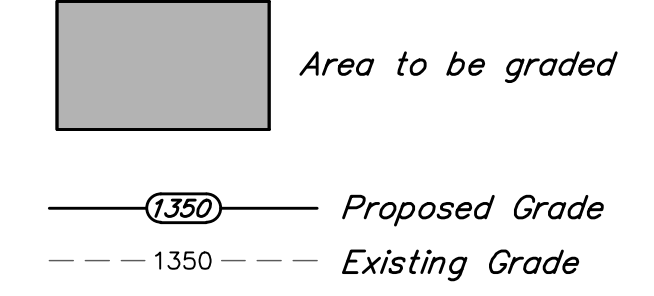

- Mass Grading General Notes:**
- Excess material shall remain on-site and be spread or stockpiled on undeveloped areas of site to be determined by the Engineer. Earthwork quantities are unadjusted and are for reference only. All cost associated with mass grading shall be incidental to lump sum bid item "Grading, Mass".
 - Contractor to strip top 4-6" of soil within street right-of-way and Res. "A", Res. "B", Res. "C", Res. "D", Res. "E", and Res. "K" before mass grading. Following pond construction, topsoil is to be spread over Res. "A", Res. "B", Res. "C", Res. "D", Res. "E", and Res. "K" above static water surface.
 - Compaction of 95% Standard Proctor Density shall be obtained in all areas. Fill shall be placed within 0% to +4% of optimum moisture content of the soil at the time of placement. All testing shall be incidental to Lump Sum bid item "Testing". Contractor shall plan on 25 compaction tests at 3 different mobilizations.
 - It shall be the Contractor's responsibility to protect existing utilities during mass grading. Any damage done to these systems by Contractor or subcontractor shall be repaired at no additional cost to the project.
 - All areas disturbed during construction shall be seeded, mulched, and fertilized as per Cover Sheet General Notes.
 - Street elevations are top of dirt at centerline.
 - Grade points around cul-de-sacs are located at 1' behind back of proposed curb.

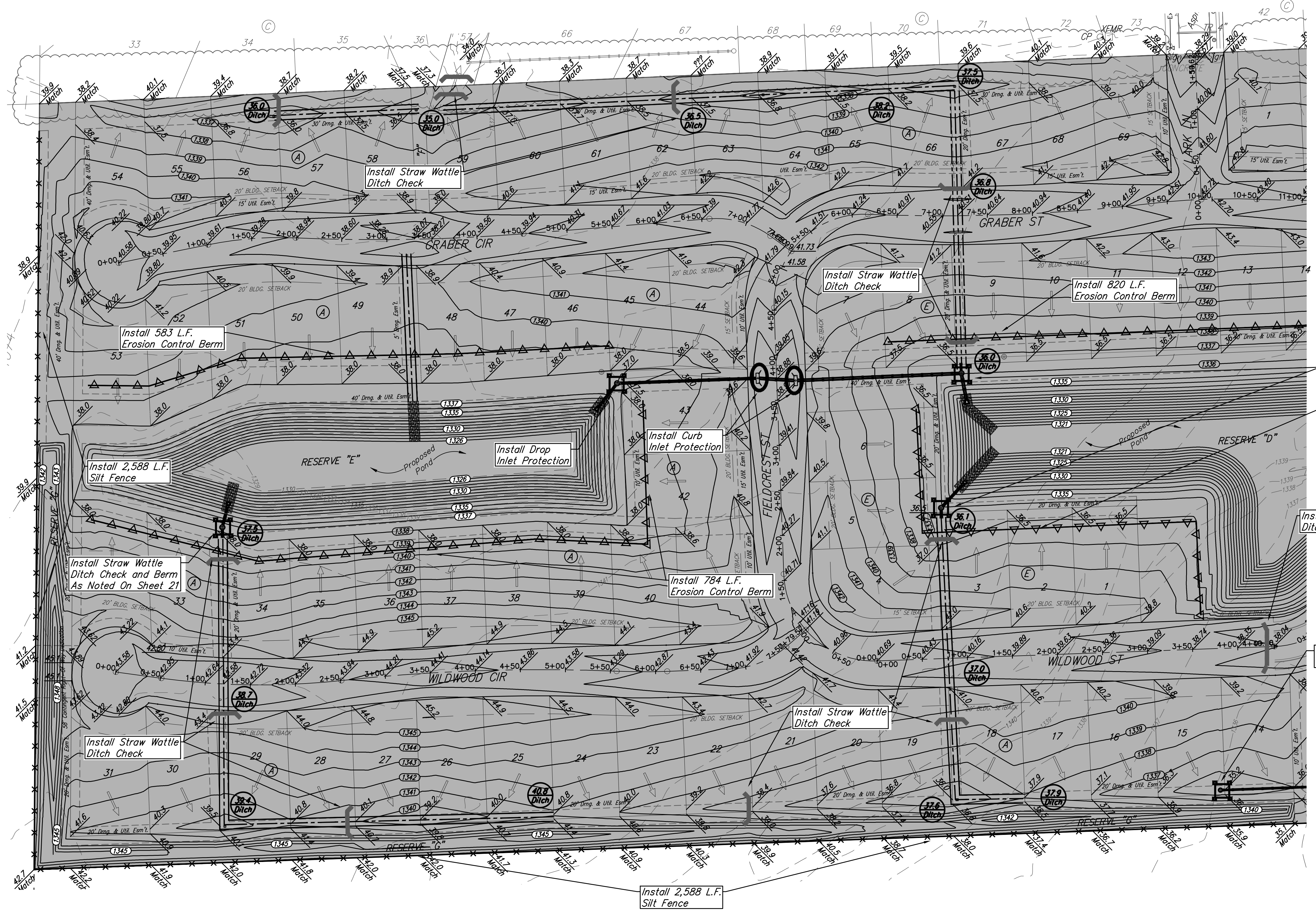

- Install Straw Wattle Ditch Check and Berm As Noted On Sheet 21
- Install 545 L.F. Erosion Control Berm
- Install Straw Wattle Ditch Check
- Install Drop Inlet Protection
- Install Straw Wattle Ditch Check
- Install Drop Inlet Protection

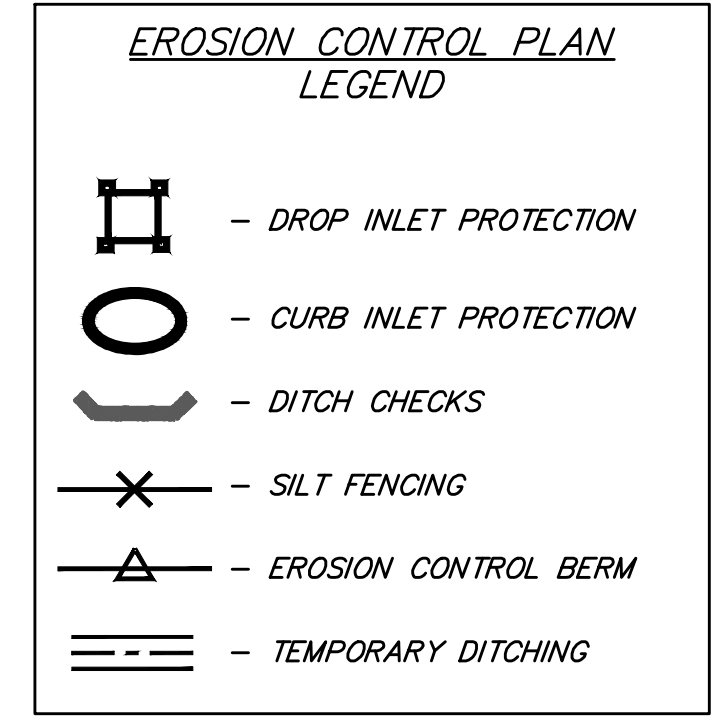

EROSION CONTROL MEASURE	INSTALL	MAINTAIN
CONSTRUCTION ENTRANCE (EA)	0	1
SILT FENCE (LF)	2,588	1,706
EROSION CONTROL BERM (LF)	3,495	0
DITCH CHECKS (EA)	14	0
CURB INLET PROTECTION (EA)	18	0
DROP INLET PROTECTION (EA)	17	0
EROSION CONTROL MAT (SY)	12,145	0
MULCH WATTLE SED. BARRIER (LF)	0	0

* ALL EXISTING BMPs INCLUDING CONSTRUCTION ENTRANCE, SEDIMENT BARRIERS, SILT FENCE, CUT-OFF TRENCH, AND EROSION CONTROL MAT SHALL BE MAINTAINED AND REPAIRED IF NECESSARY.

Contractor shall make sure all erosion control is in place before project is accepted. This plan represents the minimum standard. Any additional erosion control measures shall be installed by the Contractor as needed.

BAUGHMAN COMPANY

315 Ellis St.
 Wichita, KS 67211
 316-262-7271
 BaughmanCo.com

SCHULTE-JOHNSON
 2ND ADDITION

MASS GRADING

STORMWATER DRAIN IMPROVEMENTS

PROJECT NUMBER:
 468-2019-085425

DESIGN: AEG DRAWN: HWJ

DATE: April 12, 2021

SHEET OF
 20 37