

BENCHMARKS:  
 CUT OFF "T"-POST, DOWN 0.25'  
 13.5' WEST OF POWER POLE  
 30' SOUTH OF FIRE HYDRANT  
 +/- 200' SOUTH OF CENTERLINE  
 DRIVE TO HOUSE # 2816 S MAIZE RD.  
 ELEV. = 1328.386 (NAVD 88)

SQUARE CUT WITH + IN SW WINGWALL  
 OF THE SOUTHERNMOST OF THREE  
 CONCRETE DITCH CHECKS  
 +/- 1125' WEST OF CENTERLINE S.  
 MAIZE RD, BEHIND HOUSE #2951 S  
 MAIZE RD.  
 ELEV. = 1332.383 (NAVD88)

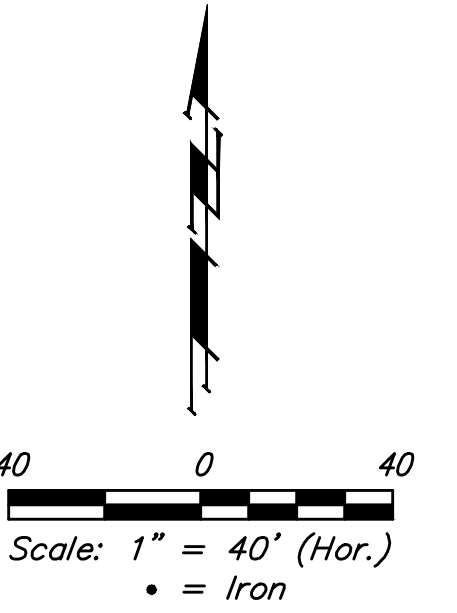
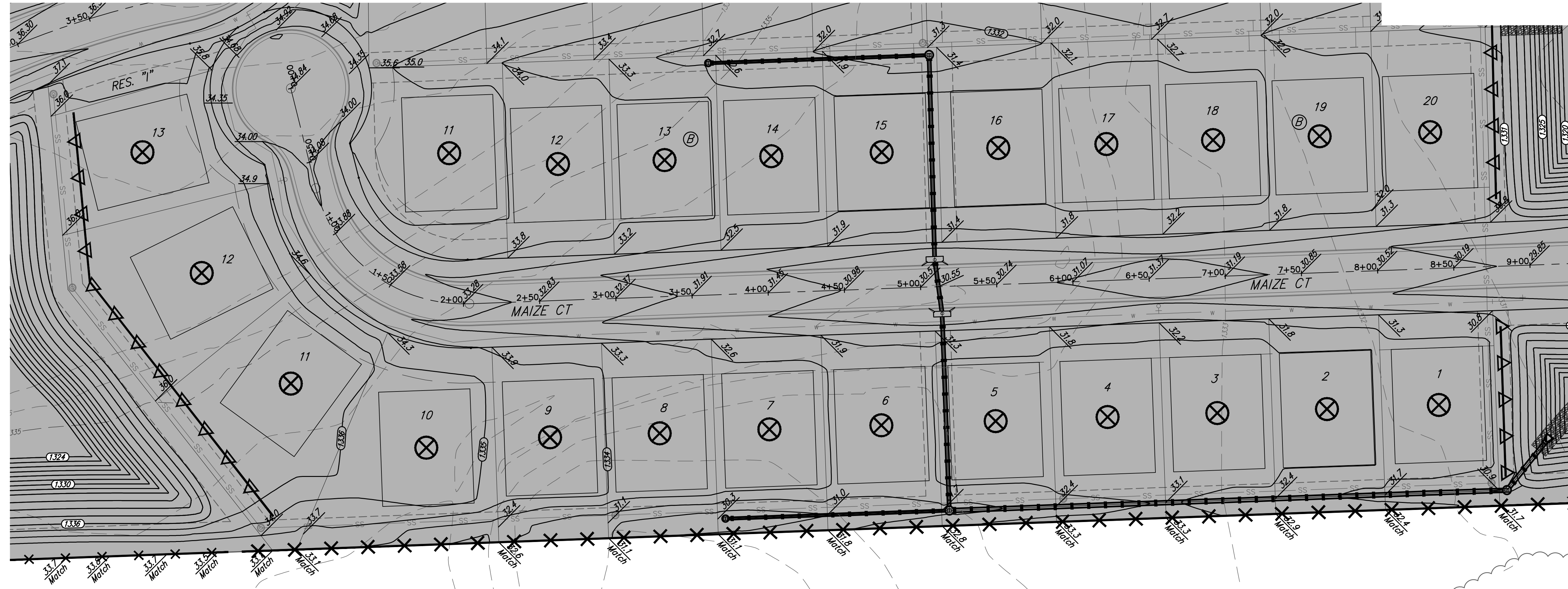

Lot	Location		Ex. Elev.	Compaction % and Test Elevation										
	Northing	Easting		-0.5'	1329	1330	1331	1332	1333	1334	1335	1336	1337	1338
1A	1668781.72	1612765.57	1330.9	X					X	X	X	X	X	X
2A	1668779.04	1612692.18	1331.7	X	X				X	X	X	X	X	X
3A	1668776.42	1612620.23	1332.4	X	X	X			X	X	X	X	X	X
4A	1668773.80	1612548.28	1332.8	X	X	X			X	X	X	X	X	X
5A	1668771.12	1612474.83	1332.6	X	X	X			X	X	X	X	X	X
6A	1668768.39	1612399.88	1331.7	X	X				X	X	X	X	X	X
7A	1668765.71	1612326.43	1331.3	X	X				X	X	X	X	X	X
8A	1668763.09	1612254.47	1331.2	X	X				X	X	X	X	X	X
9A	1668760.47	1612182.52	1331.3	X	X				X	X	X	X	X	X
10A	1668753.69	1612101.38	1332.5	X	X	X					X	X	X	X
11A	1668795.75	1612012.49	1333.4	X	X	X	X					X	X	X
12A	1668868.28	1611954.03	1335.0	X	X	X	X	X					X	X
13A	1668947.48	1611915.20	1335.4	X	X	X	X	X	X				X	X
11B	1668946.83	1612116.40	1335.2	X	X	X	X	X				X	X	X
12B	1668939.78	1612187.72	1333.9	X	X	X	X				X	X	X	X
13B	1668942.33	1612257.68	1333.4	X	X	X	X				X	X	X	X
14B	1668944.88	1612327.64	1332.9	X	X	X					X	X	X	X
15B	1668947.52	1612400.09	1332.8	X	X	X					X	X	X	X
16B	1668950.30	1612476.54	1332.8	X	X	X					X	X	X	X
17B	1668952.89	1612547.50	1332.5	X	X	X					X	X	X	X
18B	1668955.44	1612617.46	1331.8	X	X						X	X	X	X
19B	1668957.99	1612687.41	1330.9	X	X						X	X	X	X
20B	1668960.63	1612759.87	1330.0	X				X	X	X	X	X	X	X

X = No testing required at this elevation

Lot	Location		Ex. Ground Elevation	Compaction % and Test Elevation																
	Northing	Easting		1333	1334	1335	1336	1337	1338	1339	1340	1341	1342	1343	1344	1345	1346			
Graber Cir. (NE), Sta. 5+00.00			1334.7	X											X	X	X	X	X	X
Graber St., Sta. 11+50.00			1339.0	X	X	X	X	X	X								X	X	X	X
North of Lot 15 Blk A Wildwood St., Sta. 3+50.00			1336.8	X	X	X									X	X	X	X	X	X
Wildwood Cir., Sta. 3+25.00			1340.9	X	X	X	X	X	X	X										X
Graber Cir. (NW), Sta. 7+00.00			1338.6	X	X	X	X	X									X	X	X	X
Reserve "A" Pond																				Test to top of clay liner
Reserve "B" & "K" Pond																				Test to top of clay liner
Reserve "C" Pond																				Test to top of clay liner
Reserve "D" Pond																				Test to top of clay liner
Reserve "E" Pond																				Test to top of clay liner

X = No testing required at this elevation

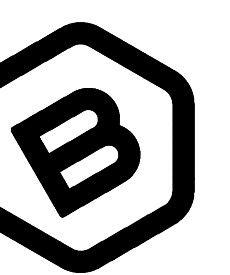
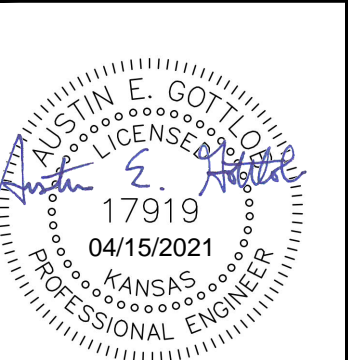

**BAUGHMAN COMPANY**  
 315 Ellis St.  
 Wichita, KS 67211  
 316-262-7271  
 BaughmanCo.com

SCHULTE-JOHNSON  
 2ND ADDITION

**COMPACTION TESTING TABLE**

STORMWATER DRAIN IMPROVEMENTS

PROJECT NUMBER:  
 468-2019-085425

DESIGN: AEG DRAWN: HJW

DATE: April 12, 2021

SHEET OF  
 22 37

File: C:\Projects\Schulte-Johnson\2nd Addition\Engineering\SWD\Plans.dwg