

# TYPE 170 CONTROLLER SETTINGS

INTERVAL	"WAPITI PROGRAM"								NORMAL DISPLAY									
	PHASE								TIME CLOCK				FEATURES					
	1	2	3	4	5	6	7	8	C				F					
MAX	0	0	30	0	50	0	0	0	0	YEAR				VEH RECALL	X	X		
MAX 2	1	0	30	0	50	0	0	0	0	MON TH				PED RECALL	X	X		
WALK	2	0	5	0	20	0	0	0	0	DAY/MONTH				RED LOCK				
FL DW	3	0	11	0	12	0	0	0	0	DAY/WEEK				YEL LOCK				
MAX INIT.	4	0	16	0	32	0	0	0	0	HOUR				Ø PERMIT	X	X	X	
MIN GREEN	5	0	15	0	31	0	0	0	0	MINUTE				PED PHASES	X	X	X	
TBR	6	0	0	0	0	0	0	0	0	SECOND				LEAD PHASES	X	X	X	X
TTR	7	0	0	0	0	0	0	0	0					DBL ENTRY				
	8	0.0	0.0	0.0	0.0	0.0	0.0	0.0	0.0					SEQUENTIAL				
PASSAGE	9	0.0	0.0	0.0	0.0	0.0	0.0	0.0	0.0					START UP				
MIN GAP	a	0.0	0.0	0.0	0.0	0.0	0.0	0.0	0.0					OVERLAP A				
ADD ACT	b	0.0	0.0	0.0	0.0	0.0	0.0	0.0	0.0					OVERLAP B				
YELLOW	c	0.0	3.0	0.0	3.0	0.0	0.0	0.0	0.0					OVERLAP C				
RED CLR	d	0.0	1.0	0.0	1.0	0.0	0.0	0.0	0.0					OVERLAP D				
RED REV	e	0.0	0.0	0.0	0.0	0.0	0.0	0.0	0.0					EXCLUSIVE				
WALK II	f	0	0	0	0	0	0	0	0					SIM GAP				

## WIRING DIAGRAM

≠ Denotes #BAWG Equipment Ground  
 \* For Street Lights (Wiring to be installed by Westar Energy)

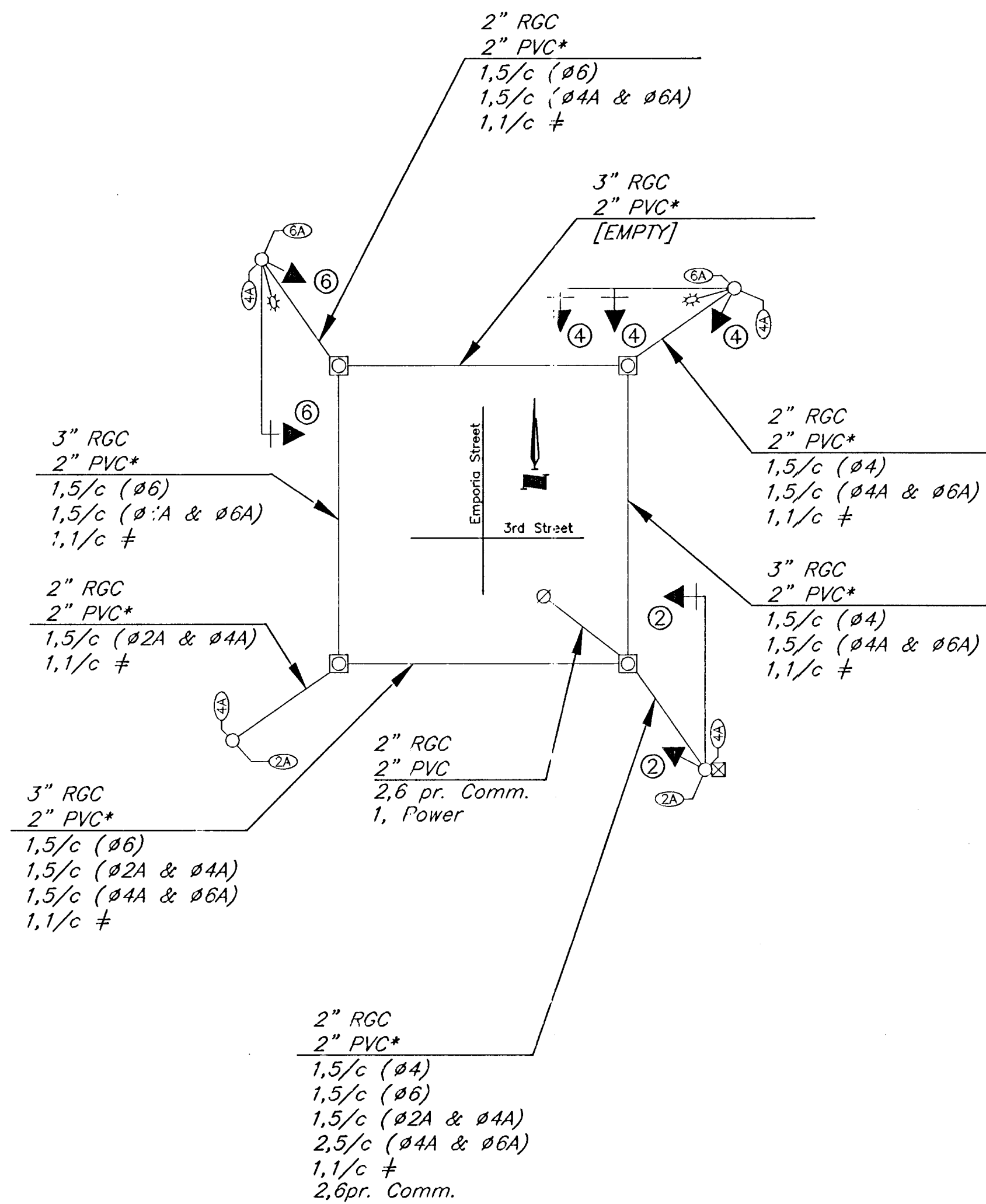

## TRAFFIC SIGNAL POLE SUMMARY

POLE NO.	STATION	OFFSET/SIDE	TYPE	ARM LENGTH	X1	X2	ARM BRACKET TYPE	BRACKET NO.	REMARKS
1	8+40	28' Lt.	C	24'	22'	-	1	1	② ④
2	9+08	39' Lt.	C	35'	21'	12'	1	2	② ④
3	9+25	22.5' Rt.	B	18'	16'	-	1	1	② ③ ④
4	8+50	26' Rt.	A	-	-	-	-	-	②

- ① A - Pedestal Pole (15' Aluminum)
- B - Pole (20' Steel with Mast Arm)
- C - Joint use Pole (30' Steel with Mast Arm)
- D - Joint use Pole (30' Steel)
- ② R6-1 Sign
- ③ Meter & Controller Pole Mounted
- ④ Street Name Sign

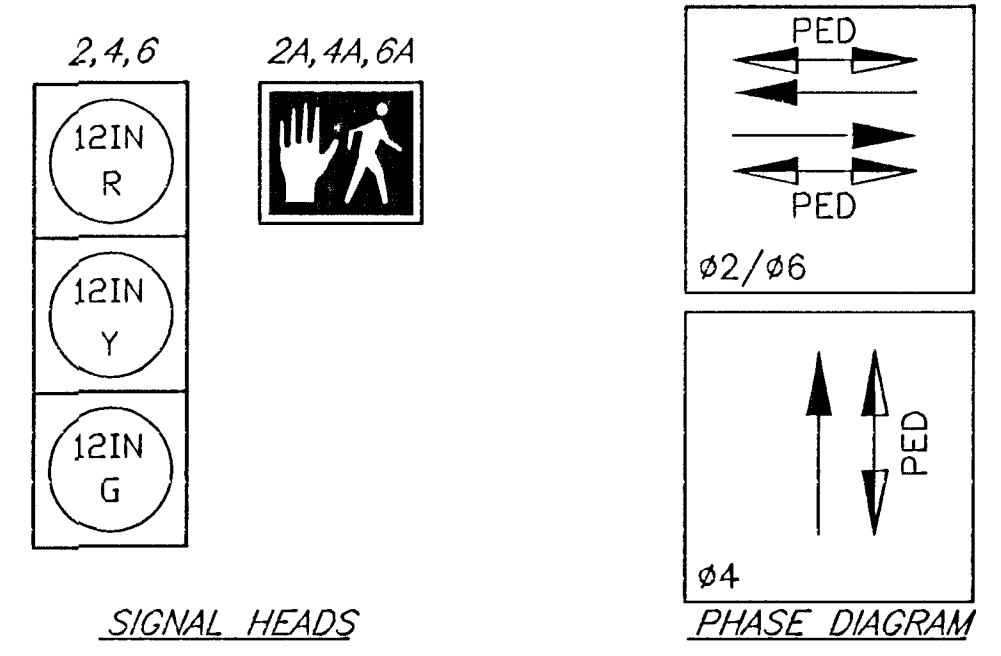

### LEGEND

Proposed Existing

- ⊠ Traffic Signal Controller
- Traffic Signal Head
- ⊠ Traffic Signal Head with Backplate
- ⊙ Pedestrian Signal Pole
- ⊙ Traffic Signal Pole
- ☀ Luminaire
- Ⓢ Movement Number
- ⊗ Pole Number
- ⊠ Street Name Sign
- ⊠ Signal Service Box
- ⊠ Westar Energy Manhole
- Westar Energy Wood Pole
- Westar Energy Metal Pole
- SWB Wood Pole
- City Metal Pole
- ⊠ Fire Hydrant
- ⊠ Water Valve
- ▨ Pavement & Walk Removal

3	11
---	----

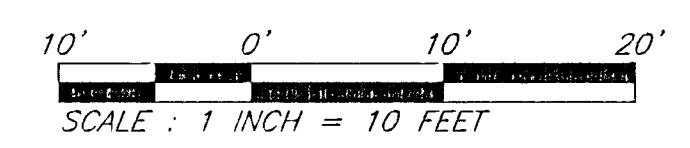
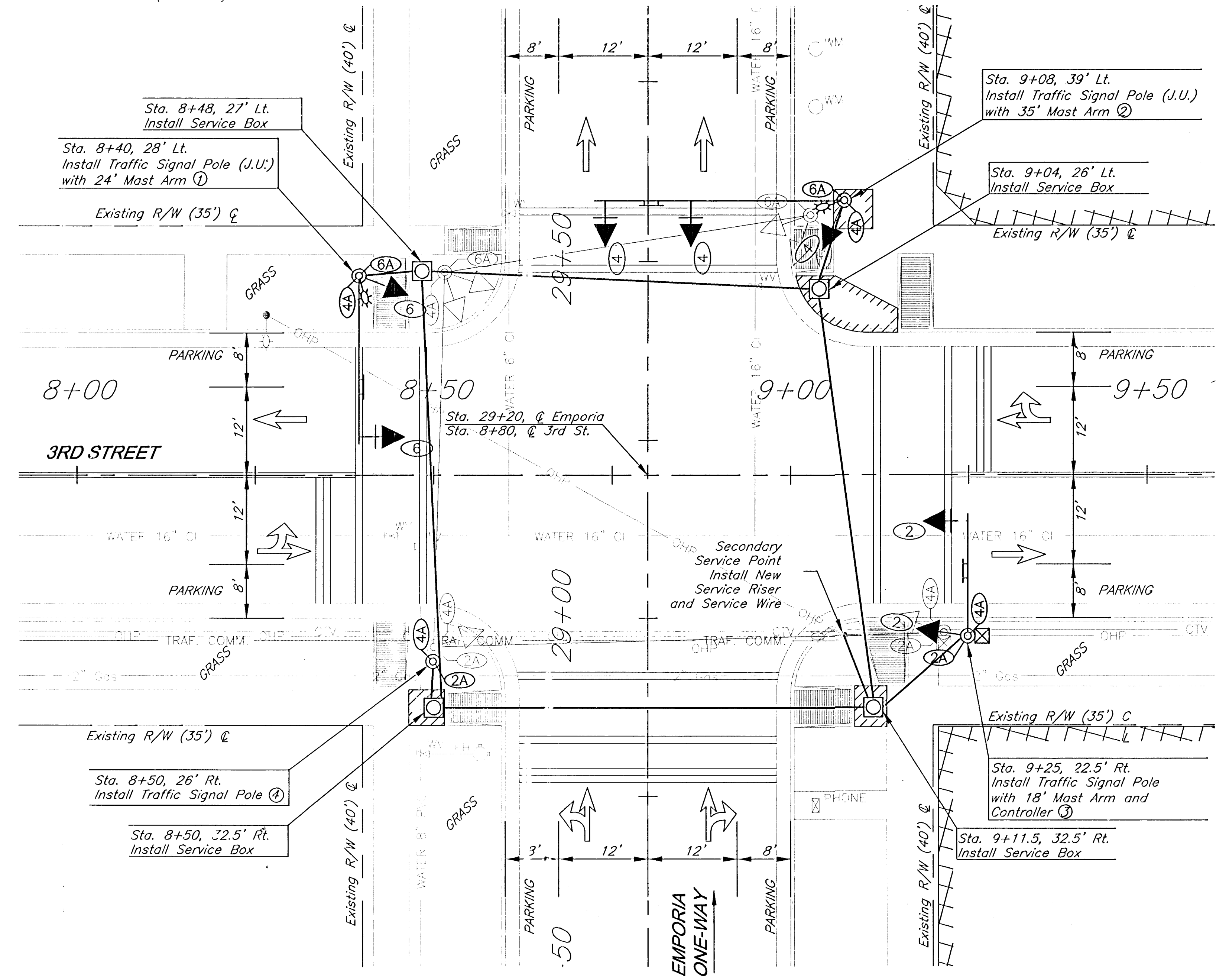

NOTES:  
 Existing underground (U/G), overhead (O.H.) utilities and drainage structures have been plotted from available information and therefore, their locations must be considered approximate only. It is the responsibility of the individual contractors to exactly locate each utility before actual construction.

Poles to be galvanized prior to black powder coating.  
 Communication Cable shall be pulled back to existing Westar Energy Pole. Contractor to install aerial splice and re-route communication cable through new service box to new controller.  
 All existing traffic signal equipment to be removed unless otherwise noted.  
 Service boxes within sidewalk shall use a 1981 Deeter Rim and Cover.

Meter Address:  
 362 N. Emporia

NO.	DATE	REVISIONS	BY	APP'D
1	8/09/02	PER CITY COMMENTS	RLC	SAC

CITY OF WICHITA, KANSAS  
 SEDGWICK COUNTY  
 TRAFFIC SIGNAL PLAN  
 EMPORIA & 3RD ST.  
 PROJECT NO. 472-83510 (MS-231001)

**GBA** GEORGE BUTLER ASSOCIATES, INC.  
 Engineers - Architects

DESIGNED SAC	CHECKED SAC	PROJ. NO. 9807.00
DRAWN JDB	DATE JUL. 19, 2002	

G:\9807\Civil\9807LDDT\DWG\Traffic\98078600.dwg Layout: E&3 Wednesday August 14, 2002, 12:55pm Copyright 2002, George Butler Associates, Inc.