

# TYPE 170 CONTROLLER SETTINGS

"WAPITI PROGRAM"										NORMAL DISPLAY							
INTERVAL	PHASE								TIME CLOCK				FEATURES				
	1	2	3	4	5	6	7	8	C				F				
	WBLT	EB	SBLT	MB	EBLT	WB	SBLT	SB	1	2	3	4	5	6	7	8	
MAX	0	0	40	0	40	0	0	0	0	YEAR	VEH RECALL	X	X				
MAX 2	1	0	40	0	40	0	0	0	1	MON TH	PED RECALL	X	X				
WALK	2	0	5	0	17	0	0	0	2	DAY/MONTH	RED LOCK						
FL DW	3	0	12	0	12	0	0	0	3	DAY/WEEK	YEL LOCK						
MAX INIT.	4	0	17	0	29	0	0	0	4	HOUR	Ø PERMIT	X	X				
MIN GREEN	5	0	16	0	28	0	0	0	5	MINUTE	PED PHASES	X	X				
TBR	6	0	0	0	0	0	0	0	6	SECOND	LEAD PHASES	X	X	X	X		
TTR	7	0	0	0	0	0	0	0	7		DBL ENTRY						
	8	0.0	0.0	0.0	0.0	0.0	0.0	0.0	8		SEQUENTIAL						
PASSAGE	9	0.0	0.0	0.0	0.0	0.0	0.0	0.0	9		START UP						
MIN GAP	a	0.0	0.0	0.0	0.0	0.0	0.0	0.0	a		OVERLAP A						
ADD ACT	b	0.0	0.0	0.0	0.0	0.0	0.0	0.0	b		OVERLAP B						
YELLOW	c	0.0	3.0	0.0	3.0	0.0	0.0	0.0	c		OVERLAP C						
RED CLR	d	0.0	1.0	0.0	1.0	0.0	0.0	0.0	d		OVERLAP D						
RED REV	e	0.0	0.0	0.0	0.0	0.0	0.0	0.0	e		EXCLUSIVE						
WALK II	f	0	0	0	0	0	0	0	f		SIM GAP						

TRAFFIC SIGNAL POLE SUMMARY										
POLE NO.	STATION	OFFSET/SIDE	TYPE ①	ARM LENGTH	X1	X2	ARM BRACKET		POL. BRACKET TYPE	REMARKS
							TYPE	NO.		
1	8+38.5	31' Lt.	D	-	-	-	-	-	II	② ③
2	9+12	23' Lt.	C	42'	29'	11'	1	2	III	② ③ ④
3	9+21	29' Rt.	C	35'	21'	12'	1	2	III	② ③ ④
4	8+47	31' Rt.	D	-	-	-	-	-	II	②

- ① A - Pedestal Pole (15' Aluminum)
- B - Pole (20' Steel with Mast Arm)
- C - Joint use Pole (30' Steel with Mast Arm)
- D - Joint use Pole (30' Steel)
- ② R6-1 Sign
- ③ Meter & Controller Pole Mounted
- ④ Street Name Sign

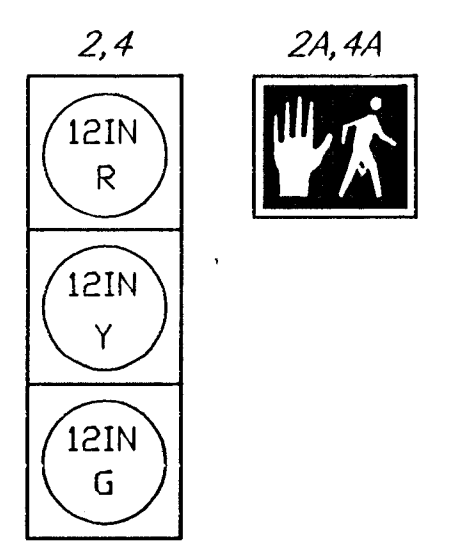

- ### LEGEND
- |          |          |                                    |  |
|----------|----------|------------------------------------|--|
| Proposed | Existing |                                    |  |
| ⊠        | ⊠        | Traffic Signal Controller          |  |
| ➔        | ➔        | Traffic Signal Head                |  |
| ➔        | ➔        | Traffic Signal Head with Backplate |  |
| ⊙        | ⊙        | Pedestrian Signal Pole             |  |
| ⊙        | ⊙        | Traffic Signal Pole                |  |
| ☀        | ☀        | Luminaire                          |  |
| Ⓢ        | Ⓢ        | Movement Number                    |  |
| ⊗        | ⊗        | Pole Number                        |  |
| ⊥        | ⊥        | Street Name Sign                   |  |
| ⊠        | ⊠        | Signal Service Box                 |  |
| ⊠        | ⊠        | Westar Energy Manhole              |  |
| •        | •        | Westar Energy Wood Pole            |  |
| ○        | ○        | Westar Energy Metal Pole           |  |
| •        | •        | SWB Wood Pole                      |  |
| ○        | ○        | City Metal Pole                    |  |
| FH       | FH       | Fire Hydrant                       |  |
| WV       | WV       | Water Valve                        |  |
|          |          | Pavement & Walk Removal            |  |

## WIRING DIAGRAM

⊕ Denotes #8AWG Equipment Ground  
 \* For Street Lights (Wiring to be installed by Westar Energy)

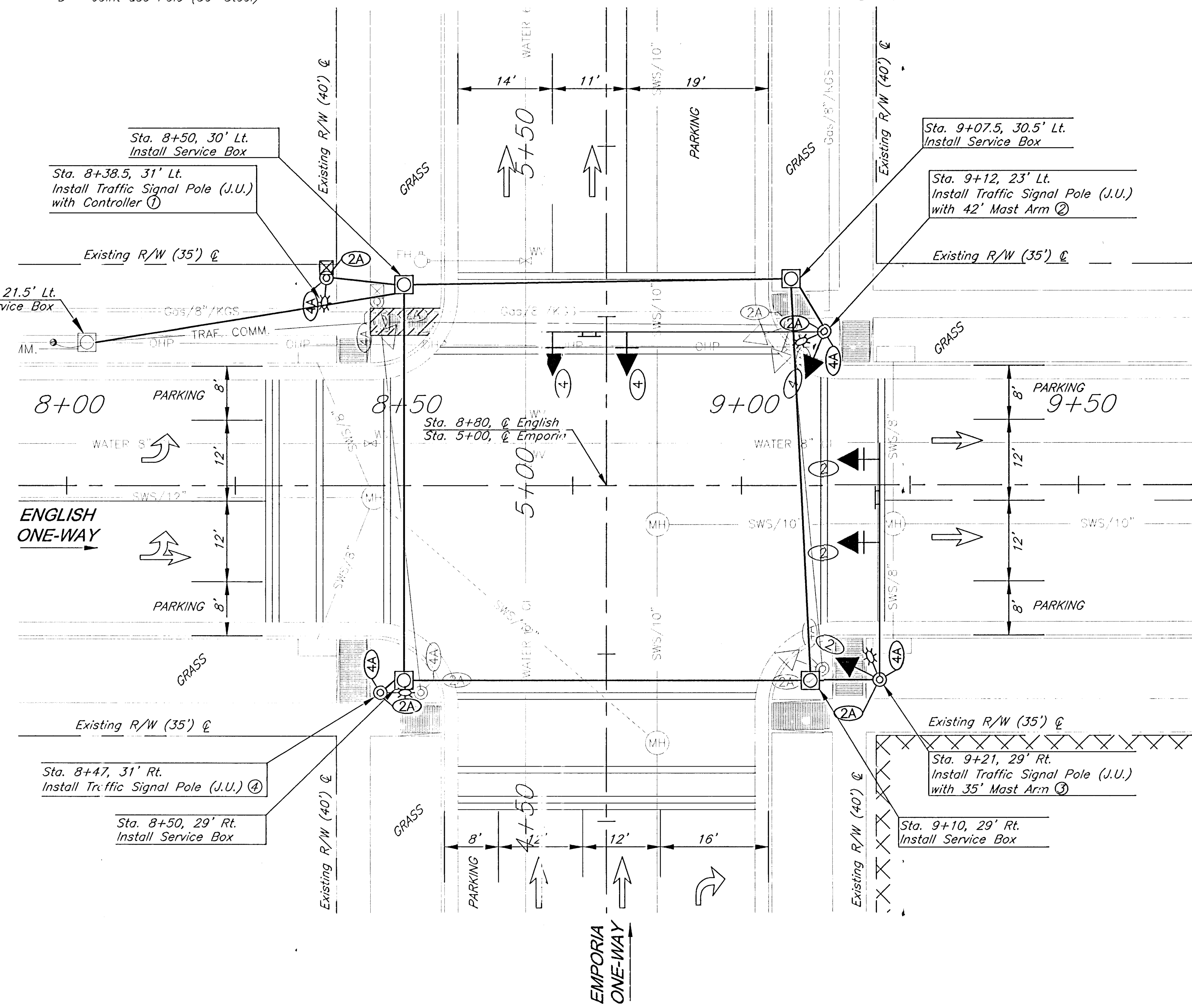
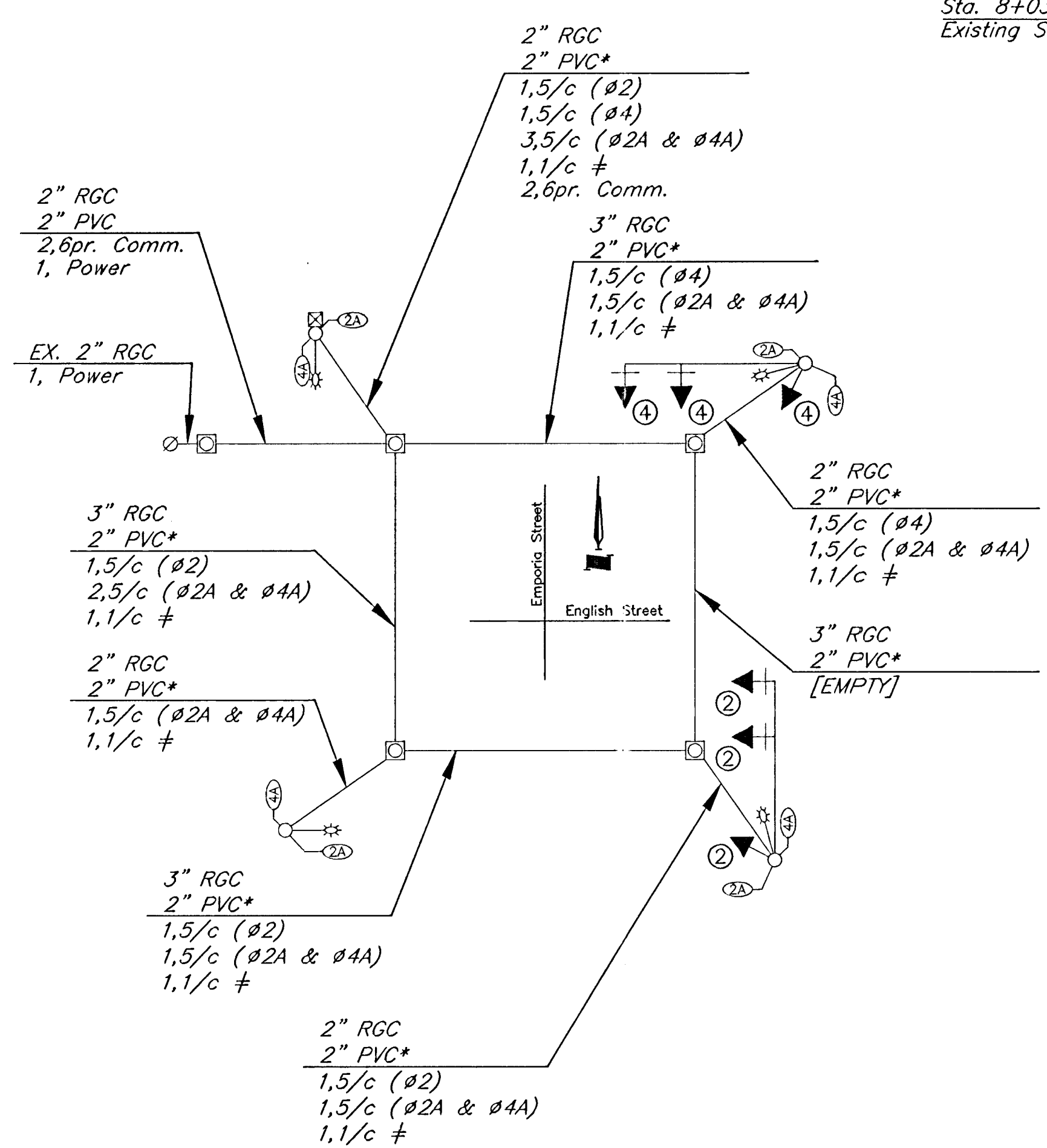

**NOTES:**  
 Existing underground (U/G), overhead (O.H.) utilities and drainage structures have been plotted from available information and therefore, their locations must be considered approximate only. It is the responsibility of the individual contractors to exactly locate each utility before actual construction.

Poles to be galvanized prior to black powder coating.  
 Communication Cable shall be pulled back to existing City Service Box (Sta. 8+03, 21.5' Lt.). Contractor to install underground splice and re-route communication cable through new service box to new controller.

All existing traffic signal equipment to be removed unless otherwise noted.

Service boxes within sidewalk shall use a 1981 Deeter Rim and Cover.

3				
2				
1	8/09/02	PER CITY COMMENTS	RLC	SAC
NO.	DATE	REVISIONS	BY	APP'D
CITY OF WICHITA, KANSAS SEDGWICK COUNTY TRAFFIC SIGNAL PLAN EMPORIA & ENGLISH				
PROJECT NO. 472-83510 (MS-231001)				
<b>GBA</b> GEORGE BUTLER ASSOCIATES, INC. Engineers - Architects				
DESIGNED	SAC	CHECKED	SAC	PROJ. NO. 9807.00
DRAWN	JDB			DATE JUL. 19, 2002

Meter Address:  
 444 E. English

G:\9807\Civil\9807LDDT\DWG\Traffic\98078600.dwg Layout: E&E -- Wednesday August 14, 2002, 12:55pm -- Copyright 2002, George Butler Associates, Inc.