

BL Sta 20+40.65 18.70' Lt.  
1-5' RCMH  
Top=112.02  
FL(N)=108.37  
FL(S)=108.12  
FL(E)=107.12  
FL(W)=107.12

BL Sta 65+58.58 18.96' Rt.\*  
1-Driveway Grated Inlet  
Top=111.60  
FL(W)=109.29

BL Sta 20+99.14 29.95' Lt.  
Light Fixture

Construct 15' Concrete Drive  
Approach (Sheet CV 4.9)  
232 S.F. 8" Reinf. Conc.

BL Sta 21+38.50 18.70' Lt.  
1-6' RCMH  
Top=112.06  
FL(E)=107.00  
FL(S)=107.00  
FL(N)=108.75

BL Sta 23+26.50 18.70' Lt.  
1-6' RCMH  
Top=111.84  
FL(E)=106.27  
FL(W)=106.77  
FL(S)=108.52  
FL(N)=108.52

BL Sta 28+48.32 38' Lt.  
Light Fixture

BL Sta 23+96.57 18.70' Lt.  
1-5' RCMH  
Top=111.77  
FL(N)=108.44  
FL(S)=108.19  
FL(E)=105.99  
FL(W)=106.19

BL Sta 75+54.94 20.09' Rt.\*  
1-Type 1 Curb Inlet  
Top=111.67  
FL(W)=108.84

KGE MH. See note  
1 Sheet CV 1.1  
BL Sta 24+54.88 29.94' Lt.  
Light Fixture

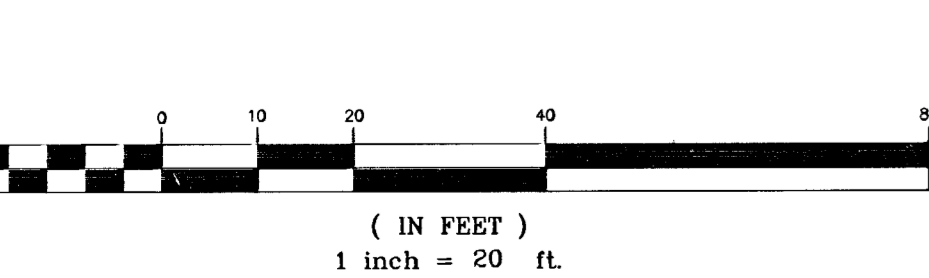
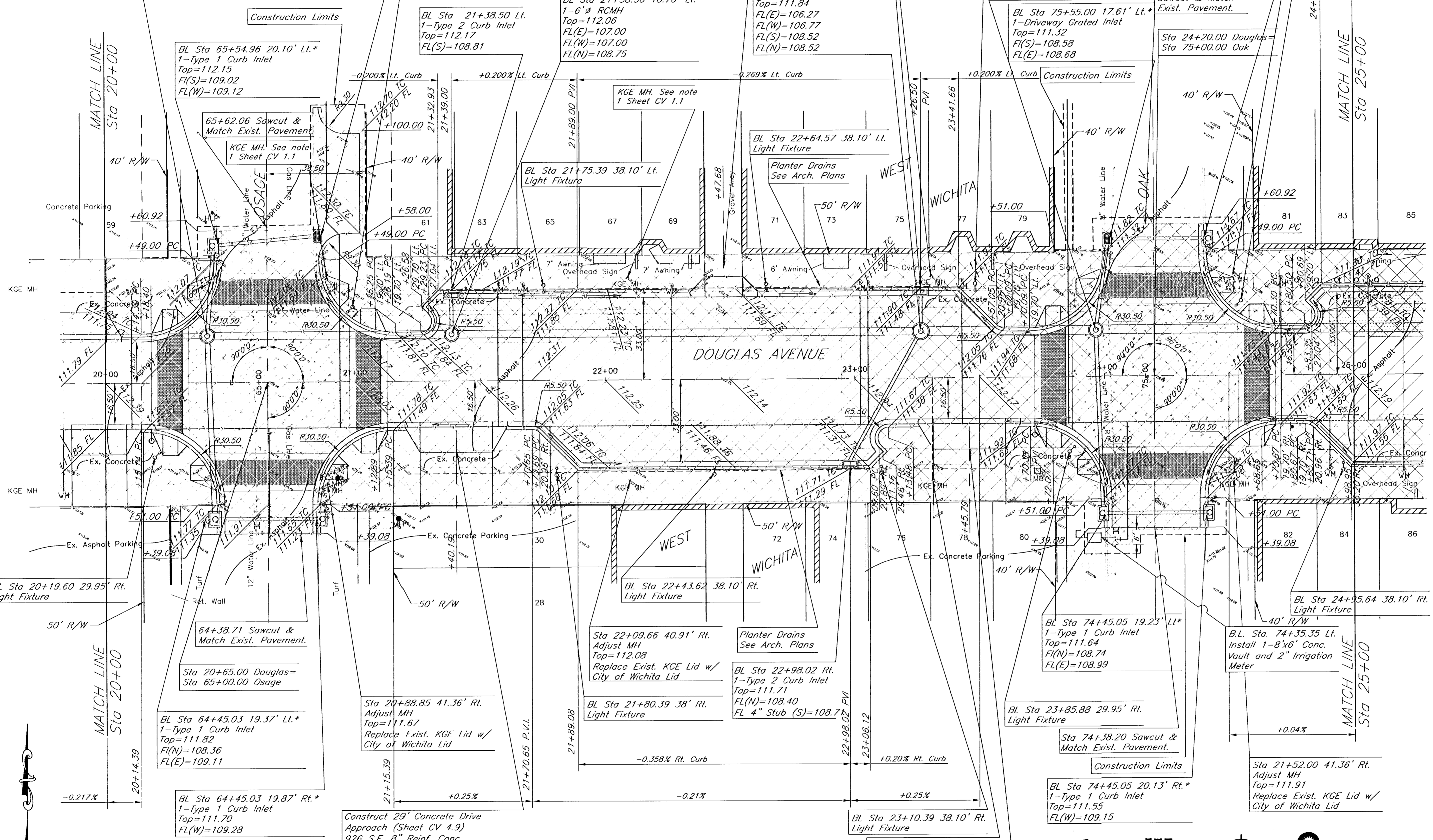

\* Offset dimension for inlets are measured from the inside face of the box structure nearest the curb to the centerline of the street right of way

	Remove
	Mill and Overlay
	Concrete Intersection Pavmnt' See Detail Sheet CV 1.7
	6" Asphalt Pavement See Detail Sheet CV 1.7
	Construct 29' Concrete Drive Approach (Sheet CV 4.9) 926 S.F. 8" Reinf. Conc.



516 S. Market,  
Wichita, KS 67202

316/264-0242

PAVING PLAN 3

PROJECT NO. 472 83608 OCA: 706846  
MVP PROJECT NO. 101008  
DATE: August 7, 2002  
REVISED: August 30, 2002

SHEET  
CV 1.3

WEST, DOUGLAS STREETSCAPE  
ARKANSAS RIVER TO SENECA  
WICHITA, KANSAS

ARCHITECTS PLANNERS LANDSCAPE ARCHITECTS  
122 S. WASHINGTON WICHITA, KANSAS 67202  
P.O. BOX 346 WICHITA, KANSAS 67201  
TEL: 316/264-0242 FAX: 316/264-0245



MCCLUGGAGE VAN SICKLE & PERRY