

ELECTRICAL PLAN 3

1" = 30'

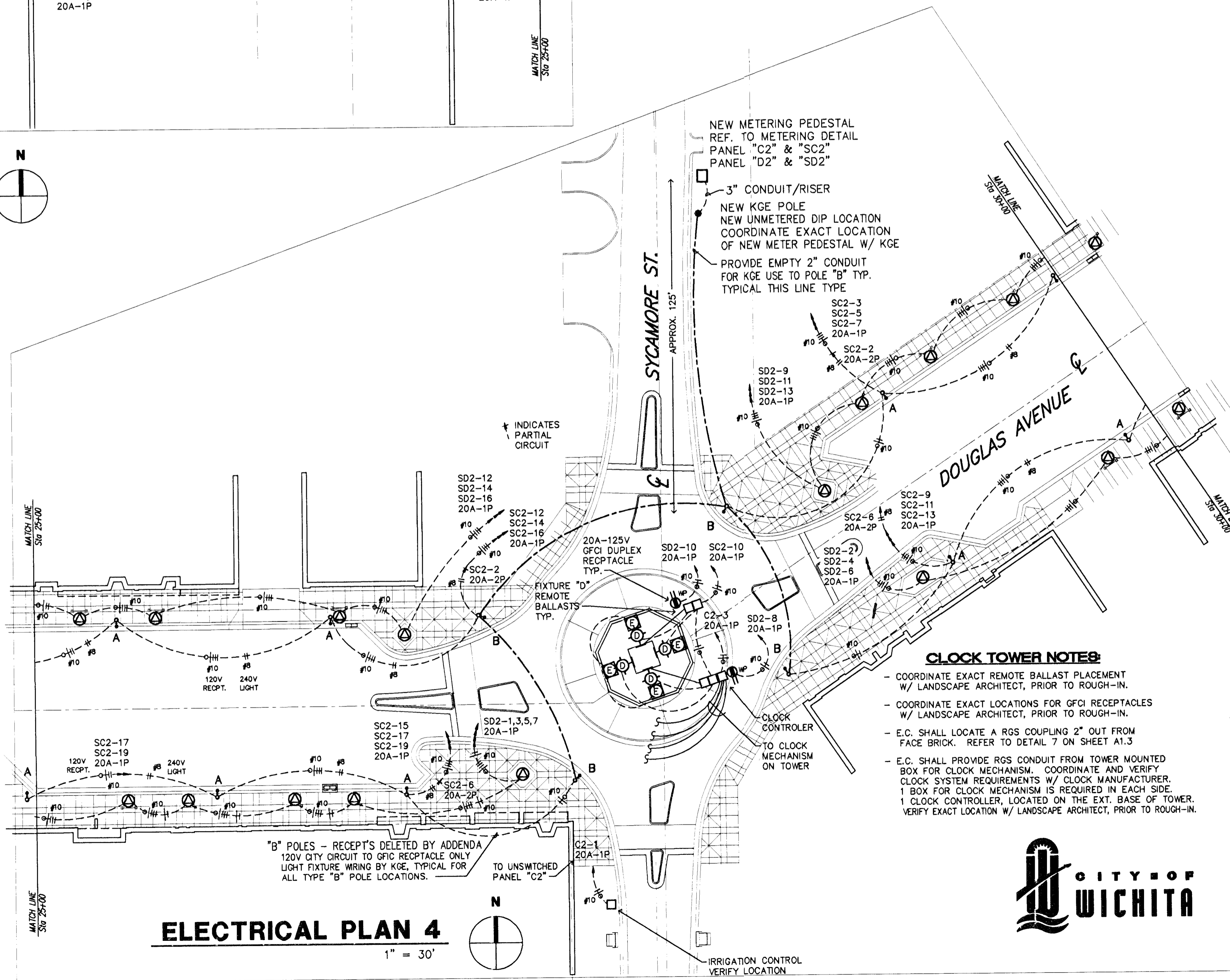
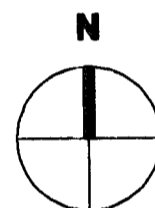

ELECTRICAL PLAN 4

1" = 30'

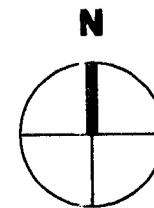

JOHNSON ENGINEERING
 330 S. LAURA
 WICHITA, KS 67211
 (316) 264-1953
 (316) 264-1956 FAX



CLOCK TOWER NOTES:

- COORDINATE EXACT REMOTE BALLAST PLACEMENT W/ LANDSCAPE ARCHITECT, PRIOR TO ROUGH-IN.
- COORDINATE EXACT LOCATIONS FOR GFCI RECEPTACLES W/ LANDSCAPE ARCHITECT, PRIOR TO ROUGH-IN.
- E.C. SHALL LOCATE A RGS COUPLING 2" OUT FROM FACE BRICK. REFER TO DETAIL 7 ON SHEET A1.3
- E.C. SHALL PROVIDE RGS CONDUIT FROM TOWER MOUNTED BOX FOR CLOCK MECHANISM. COORDINATE AND VERIFY CLOCK SYSTEM REQUIREMENTS W/ CLOCK MANUFACTURER. 1 BOX FOR CLOCK MECHANISM IS REQUIRED IN EACH SIDE. 1 CLOCK CONTROLLER, LOCATED ON THE EXT. BASE OF TOWER. VERIFY EXACT LOCATION W/ LANDSCAPE ARCHITECT, PRIOR TO ROUGH-IN.

ELECTRICAL PLAN 3 and 4

**WEST DOUGLAS STREETSCAPE
 ARKANSAS RIVER TO SENECA
 WICHITA, KANSAS**

PROJECT NO. 472 83608
 MVP PROJECT NO. 10/008
 JE PROJECT NO. 02/006
 DATE: AUGUST 1, 2002
 REVISED
 REVISED CONST. SET:
 FEBRUARY 1, 2003

SHEET
E1.3

MCCUIGGAGE VAN SICKLE & PERRY
 ARCHITECTS • PLANNERS • LANDSCAPE ARCHITECTS
 125 S. WASHINGTON WICHITA, KANSAS 67202
 P.O. BOX 346 WICHITA, KANSAS 67204
 TEL: 316.264.0400 FAX: 316.264.0405