

WIRING NOTES

- * THE CONTROLLER AND CABINET SHALL INCLUDE THE FOLLOWING:
 - MODEL 170 CONTROLLER UNIT COMPLETE WITH WAIKS (53A OR LATEST REVISION) TRAFFIC PROGRAM ON 412B SYSTEM - MEMORY MODULE AND MODEL 400 MODEM
 - ONE MODEL 336 CABINET (MEETING CITY OF WICHITA SPECIFICATIONS) COMPLETE WITH ALL ACCESSORIES INCLUDING:
 - 1 - MODEL 210 ECL OR MS CONFLICT MONITOR.
 - 4 - TRANSFER RELAYS
 - 2 - MODEL 204 FLASHER UNITS.
 - 2 - MODEL 242 TWO CHANNEL ISOLATORS
 - 2 - MODEL 200 SWITCH PACKS

THE CONTRACTOR SHALL BE RESPONSIBLE FOR FURNISHING AND INSTALLING THE CONTROLLER, CABINET AND SOFTWARE AND FOR ALL EQUIPMENT NECESSARY FOR THE COMPLETE AND SATISFACTORY OPERATION OF THE TRAFFIC SIGNAL, WHETHER OR NOT SAID EQUIPMENT IS SPECIFICALLY MENTIONED.

THE CONTRACTOR SHALL FURNISH AND INSTALL ALL POWER SUPPLY CABLE AND TRAFFIC SIGNAL CABLE FOR THE COMPLETE OPERATION OF THE TRAFFIC SIGNAL. NO SPLICES WILL BE ALLOWED OUTSIDE POLE BASES, SERVICE BOXES, OR JUNCTION BOXES.

EACH SEPARATE MAST ARM MOUNTED SIGNAL HEAD SHALL HAVE ONE CONTINUOUS RUN OF FIVE-CONDUCTOR CABLE FROM THE POLE BASE TO THE SIGNAL HEAD. A ONE-CONDUCTOR #8 AWG (GREEN) SHALL BE INSTALLED TO CONNECT ALL GROUNDING LUGS IN POLE BASES AND CONTROLLER BASE.

ONE, SEVEN-CONDUCTOR CABLE SHALL BE RUN FROM THE CONTROLLER TO EACH POLE SUPPORTING A MAST ARM-MOUNTED VEHICLE INDICATION. THE FOLLOWING COLOR CODE SHALL BE USED.

WHITE	COMMON
RED	RED BALL
GREEN	GREEN BALL
ORANGE	YELLOW BALL
WHITE/BLACK	DON'T WALK
BLUE	WALK
BLACK	PUSHBUTTON

ONE, FIVE-CONDUCTOR CABLE SHALL BE RUN FROM EACH 3-SECTION THRU SIGNAL HEAD TO THE POLE BASE.

ONE, FIVE-CONDUCTOR CABLE SHALL BE RUN FROM EACH 2-WAY SIDE-OF-POLE PEDESTRIAN SIGNAL TO THE POLE BASE. THE FOLLOWING COLOR CODE SHALL BE USED.

RED	DON'T WALK
GREEN	WALK
WHITE	COMMON
ORANGE	SPARE
BLACK	SPARE

ONE, TWO-CONDUCTOR CABLE SHALL BE RUN FROM PUSHBUTTON TO POLE BASE.

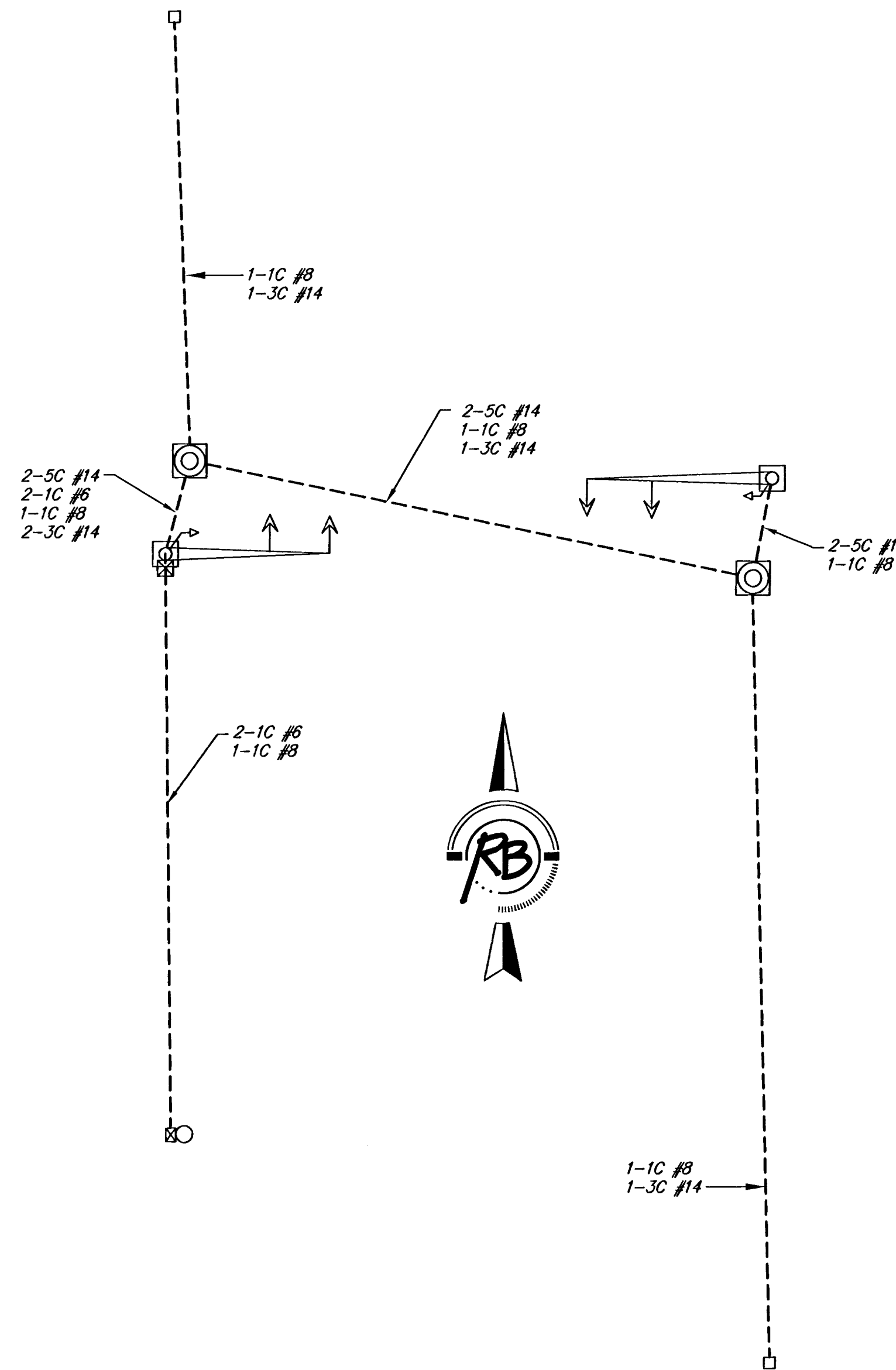

WIRING DIAGRAM

MATERIAL LIST

ITEM	UNIT	QUANTITY
* MODEL 170 CONTROLLER	EACH	1
* CONTROLLER CABINET	EACH	1
METER BOX	EACH	1
POWER DISCONNECT W/ BREAKER	EACH	1
TRAFFIC SIGNAL POLE & MAST ARM (20')	EACH	2
CONCRETE BASE FOR SIGNAL POLE	EACH	2
TRAFFIC SIGNAL HEAD (TYPE A) W/ BRACKETS	EACH	4
PEDESTRIAN SIGNAL HEAD (TYPE L) W/ BRACKETS	EACH	2
PEDESTRIAN PUSHBUTTON W/SIGN (ONE PC.)	EACH	2
TRAFFIC SIGNAL LAMP	EACH	16
GROUND ROD AND CLAMP	EACH	5
SERVICE BOX	EACH	2
3" RGC CONDUIT	L.F.	96
2" RGC CONDUIT	L.F.	453
1" RGC CONDUIT	L.F.	78
MULTI-CONDUCTOR CABLE 3C #14 AWG	L.F.	590
MULTI-CONDUCTOR CABLE 5C #14 AWG	L.F.	448
GROUND WIRE (THHN #8 AWG)	L.F.	190
POWER SUPPLY WIRE (THHN #6 AWG)	L.F.	180

**MAIZE AND HARVEST
PEDESTRIAN SIGNAL PLAN
WICHITA, KANSAS**

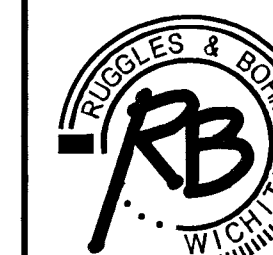

Ruggles & Bohm, P.A.
Engineering, Surveying, Land Planning
924 North Main
Wichita, Kansas 67203
www.rbkansas.com
(316) 264-8008
(316) 264-4621 fax
E-mail: info@rbkansas.com

DRAWING FILE: Base {Layout1}
PROJECT NUMBER: 472-83509
DATE: Nov. 26, 2002

DESIGN: KWL
DRAWN: KWL
REVIEW: KWL
UTILITY
SHEET: 3 OF 7