

BENCHMARKS:
 Brass benchmark disc in top of curb, east of wheelchair ramp NE cor. of Funston and Lynnrae Elev. = 1343.69 NAVD88

Brass benchmark disc in top of curb, north of wheelchair ramp NW cor. of Funston and Herrington Elev. = 1344.71 NAVD88

Existing trees shall be trimmed/removed ONLY with approval of the Developer. Trimming of overhanging limbs will be permitted only with chainsaws. Trees not in direct conflict with proposed new construction shall remain and be protected from damage. All trimming or removal shall be included in bid item "Site Clearing"

Remove & replace existing wire fence only as necessary for construction. Remove any existing Rip-Rap from drainage channel. Cost to be included in bid item "Site Clearing"

Sta. 0+00, Line 6
 Begin Construction of 24" RCP w/ Restrained End Section and 30 S.Y. of Light Stone Rip-Rap as Indicated.

Sta. 0+00, Line 5
 Begin Construction of 24" RCP w/ Restrained End Section and 30 S.Y. of Light Stone Rip-Rap as Indicated.

Sta. 0+35.0, Line 6
 End Construction of 24" RCP w/ Restrained End Section and 30 S.Y. of Light Stone Rip-Rap as Indicated.

Sta. 0+35.0, Line 5
 End Construction of 24" RCP w/ Restrained End Section and 30 S.Y. of Light Stone Rip-Rap as Indicated.

POND DATA:
 STATIC POOL ELEVATION 1336.0
 100-YR ELEVATION 1339.6
 BOTTOM ELEVATION 1328.0

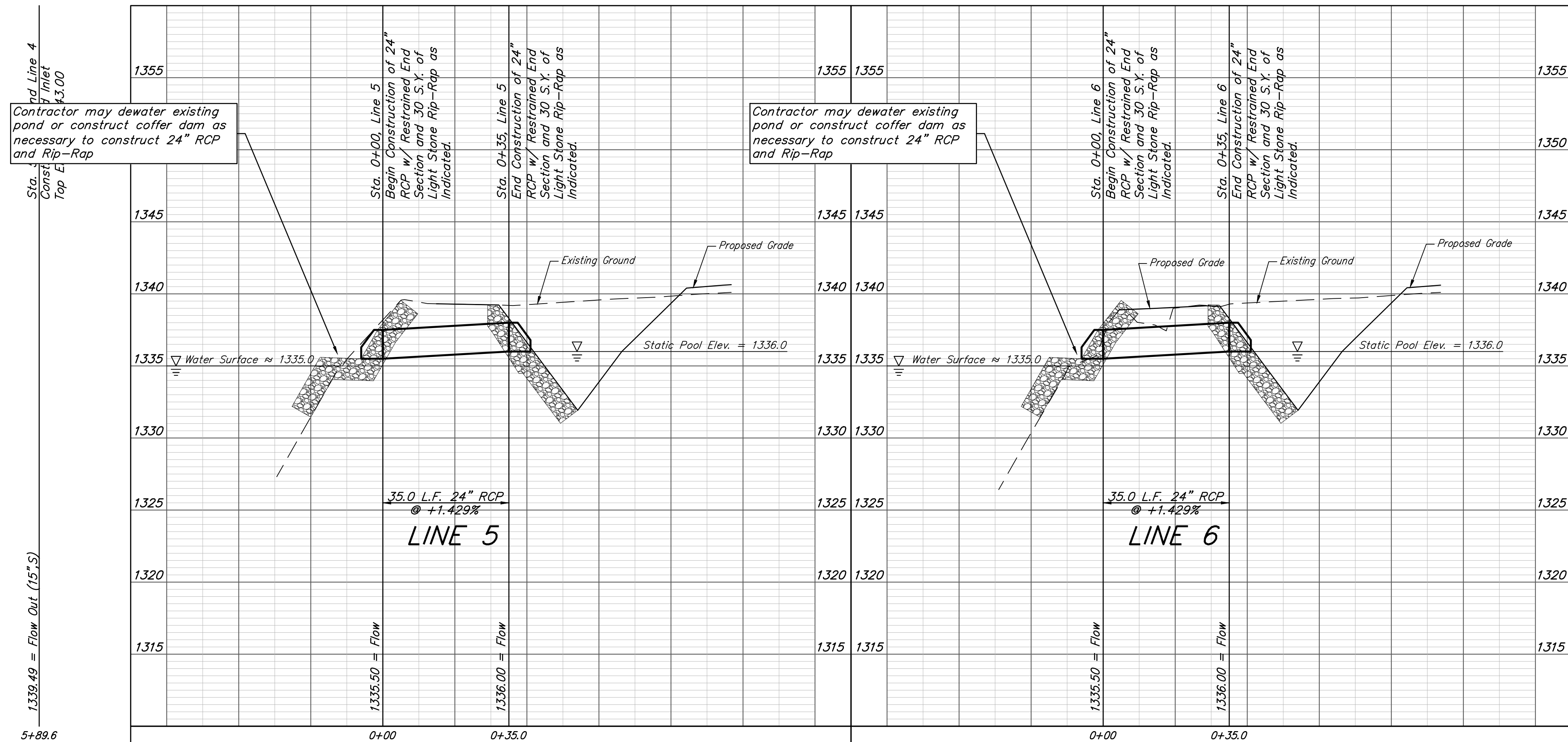
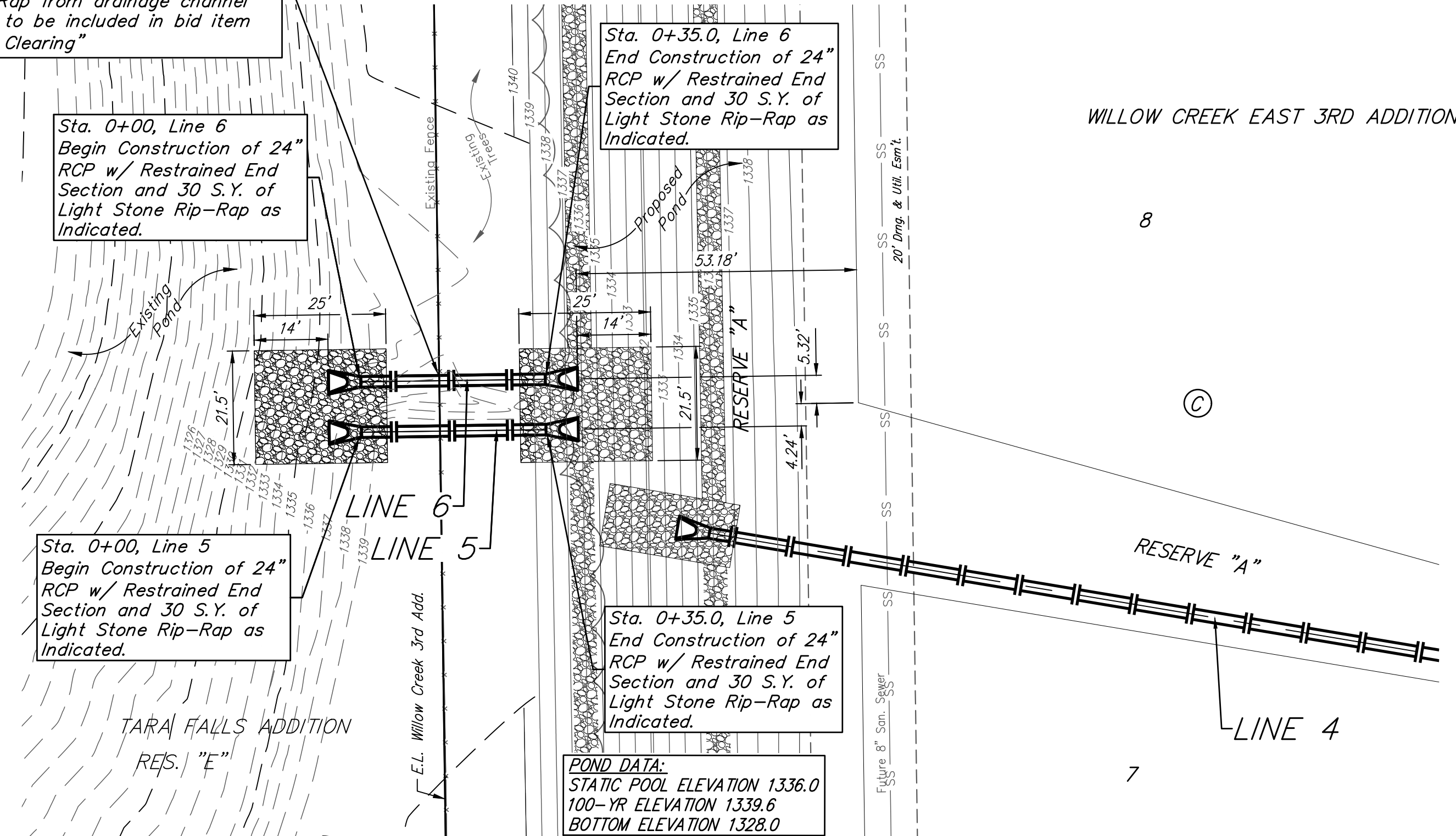



BAUGHMAN COMPANY

315 Ellis St.
 Wichita, KS 67211
 316-262-7271
 BaughmanCo.com

WILLOW CREEK EAST 3RD ADDITION - PHASE II

LINE 5 & LINE 6

STORM WATER DRAIN IMPROVEMENTS

PROJECT NUMBER:

DESIGN: DMV DRAWN: JAK
 DATE: April 14, 2021

SHEET **9** OF **23**

File: E:\Projects\Willow Creek East 3rd Addition_17-04-P283\Engineering\Phase 3\SWD.dwg