

MURDOCK & WICHITA INTERSECTION IMPROVEMENTS

Project No. 472-76-245-82026
Index Code 706002

CITY OF WICHITA, KANSAS
Michael E. Lindebak, P.E. City Engineer

BENCHMARKS

BM #1 - Little Arkansas River & Murdock, Brass Cap on Walk,
NW Corner of Bridge, Stamped Elev. 1306.22 MSL.
Use Elev. = 1306.38 MSL
Use Elev. = 118.98 City Datum

BM #2 - "□" On Top of Brick Ledge on the NW Corner
of Bldg. #744 No. Waco, @ Sta. 4+34.5, 38' Rt.,
of the Centerline of Murdock.
Elev. = 117.18 City Datum

Project Area

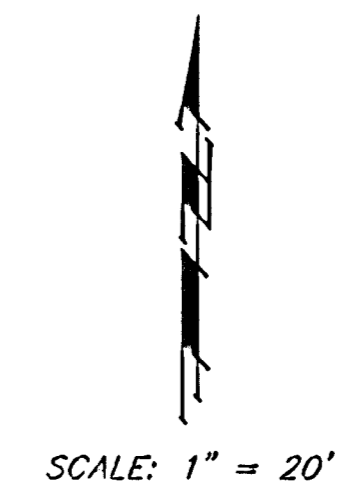
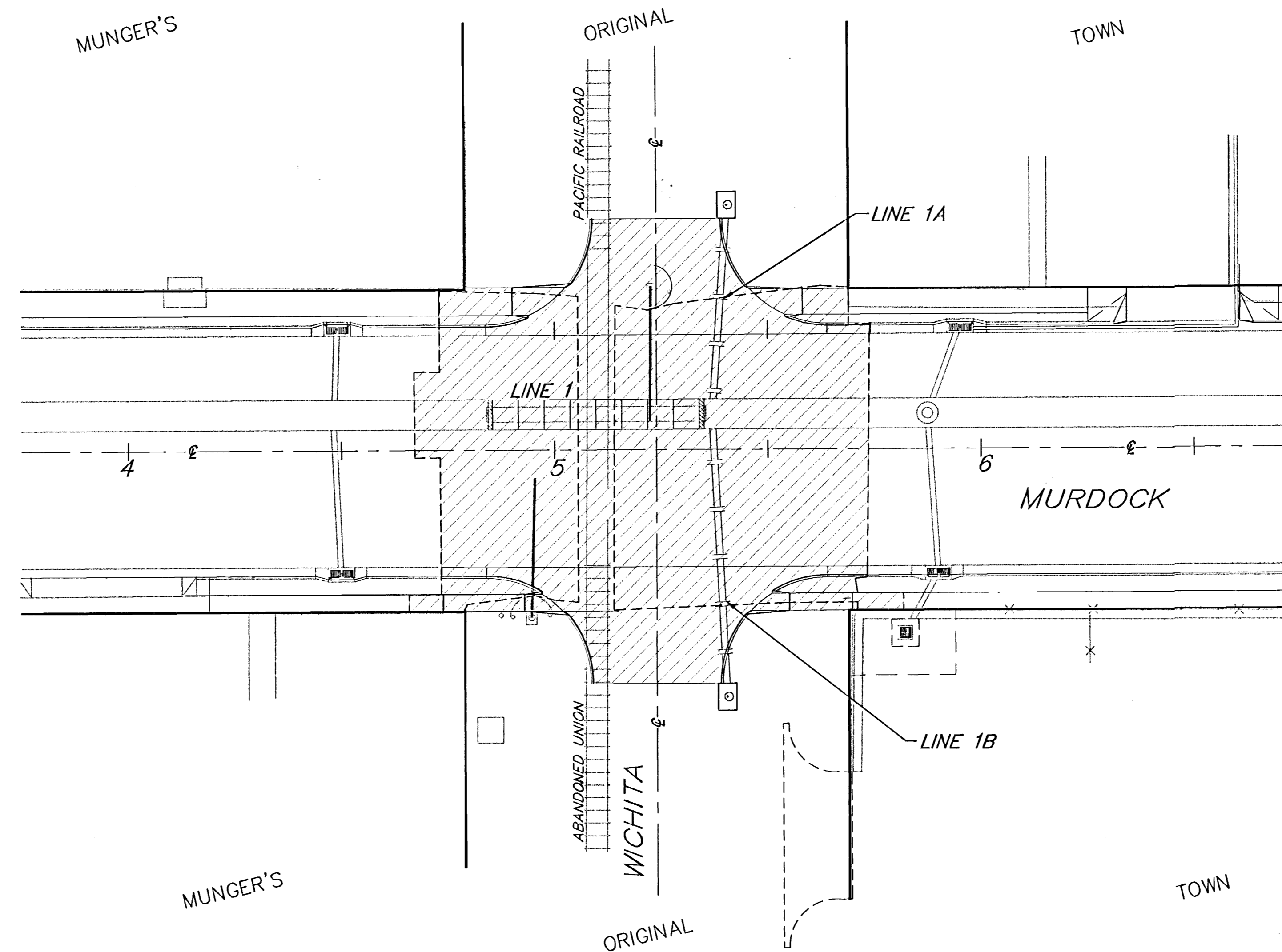

Index

Cover Sheet	1
General Notes	2
Pavement Details	3-4
Pavement Plan	5
Storm Sewer Plan/Profile	6
Precast Concrete Box Culvert Details	7
Beehive Inlet Detail	8
Traffic Control Detail	9
Signing Detail	10

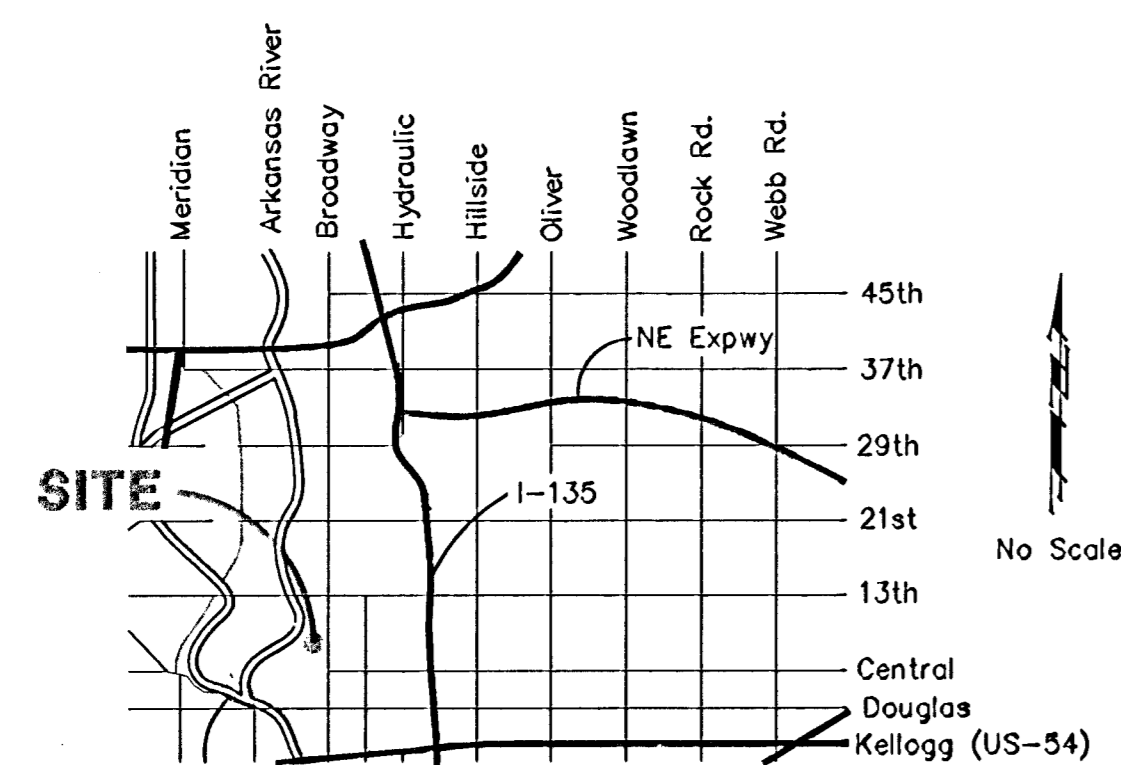

Vicinity Map

Professional Engineer Seal
Michael E. Lindebak
13078
9/15/99
Professional Engineer
Kansas State Board of Professional Engineers

September, 1999