

REPLAT OF BLOCK 8 PURCELL'S SIXTH ADDITION

BLOCK 7
PURCELL'S SEVENTH ADDITION

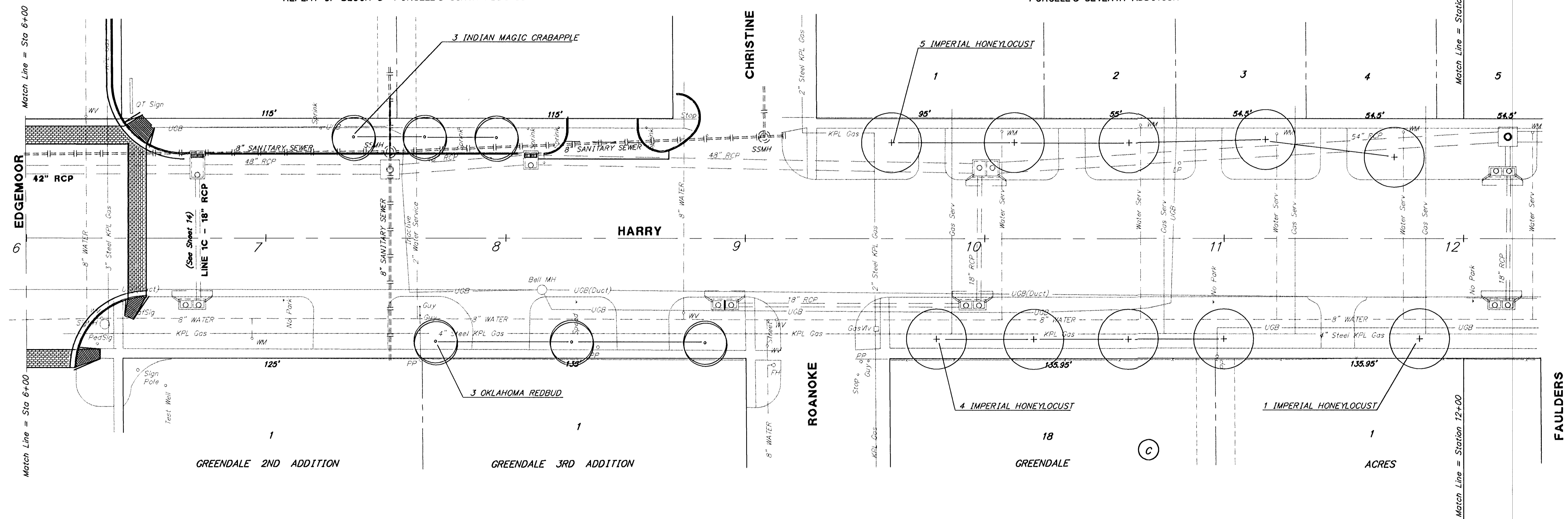

PLANT MATERIAL LOCATIONS

7+37	42' Lt	Indian Magic Crabapple
7+67	42' Lt	Indian Magic Crabapple
7+71	43' Rt	Oklahoma Redbud
7+97	42' Lt	Indian Magic Crabapple
8+27	43' Rt	Oklahoma Redbud
8+83	43' Rt	Oklahoma Redbud
9+61	40' Lt	Imperial Honeylocust
9+80	42' Rt	Imperial Honeylocust
10+12	40' Lt	Imperial Honeylocust
10+20	42' Rt	Imperial Honeylocust
10+60	40' Lt	Imperial Honeylocust
10+60	42' Rt	Imperial Honeylocust
11+00	42' Rt	Imperial Honeylocust
11+17	41' Lt	Imperial Honeylocust
11+71	34' Lt	Imperial Honeylocust
11+82	42' Rt	Imperial Honeylocust

Note: Stationing based off Centerline.

PLANT MATERIAL SHEET COUNT

-	Prairie Pride Hackberry
3	Oklahoma Redbud
10	Imperial Honeylocust
3	Indian Magic Crabapple
-	Autumn Blaze Pear
-	Lacebark Elm

HARRY & EDGEMOOR IMPROVEMENTS
LANDSCAPE PLANS

BAUGHMAN COMPANY P. A.
ENGINEERING & SURVEYING
316/262-7271 • 315 ELLIS • WICHITA, KANSAS 67211

DESIGN	DRAWN	UTIL. CHECK'D	DATE	SCALE	SHEET 34 OF 38
P.J.M.	P.J.M.	T.C.R.	AUG. 3, 1992	1" = 20'	

92-00-5000