

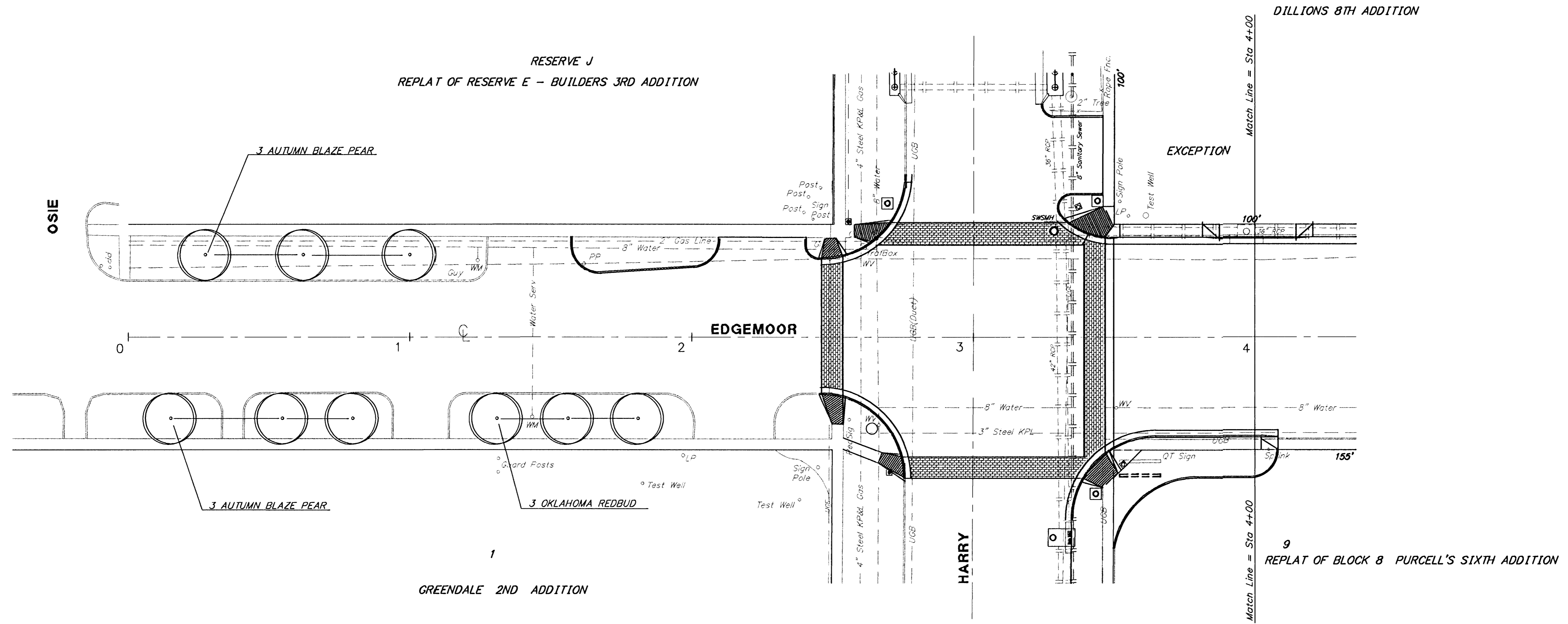

Scale: 1" = 20'



PLANT MATERIAL LOCATIONS

0+15	29' Rt	Autumn Blaze Pear
0+27	29' Lt	Autumn Blaze Pear
0+35	29' Rt	Autumn Blaze Pear
0+63	29' Lt	Autumn Blaze Pear
0+80	29' Rt	Autumn Blaze Pear
1+00	29' Lt	Autumn Blaze Pear
1+31	29' Rt	Oklahoma Redbud
1+56	29' Rt	Oklahoma Redbud
1+81	29' Rt	Oklahoma Redbud

Note: Stationing based off Centerline.

PLANT MATERIAL SHEET COUNT

-	Prairie Pride Hackberry
3	Oklahoma Redbud
-	Imperial Honeylocust
-	Indian Magic Crabapple
6	Autumn Blaze Pear
-	Lacabark Elm

HARRY & EDGEMOOR IMPROVEMENTS
LANDSCAPE PLANS

BAUGHMAN COMPANY P. A.
ENGINEERING & SURVEYING
316/282-7271 • 315 ELLIS • WICHITA, KANSAS 67211

PROJECT NUMBER
468-82138 & 472-82668

DESIGN	DRAWN	UTIL. CHECK'D	DATE	SCALE	SHEET 37 OF 38
P.J.M.	P.J.M.	T.C.R.	AUG. 3, 1992	1" = 20'	