

FHWA REGION NO.	STATE	PROJECT NUMBER	FISCAL YEAR	SHEET NUMBER	TOTAL SHEETS
7	KANSAS	87N-0127-01	1999	12	90

BY	DATE

REFERENCES NOTED	REFERENCES CHECKED

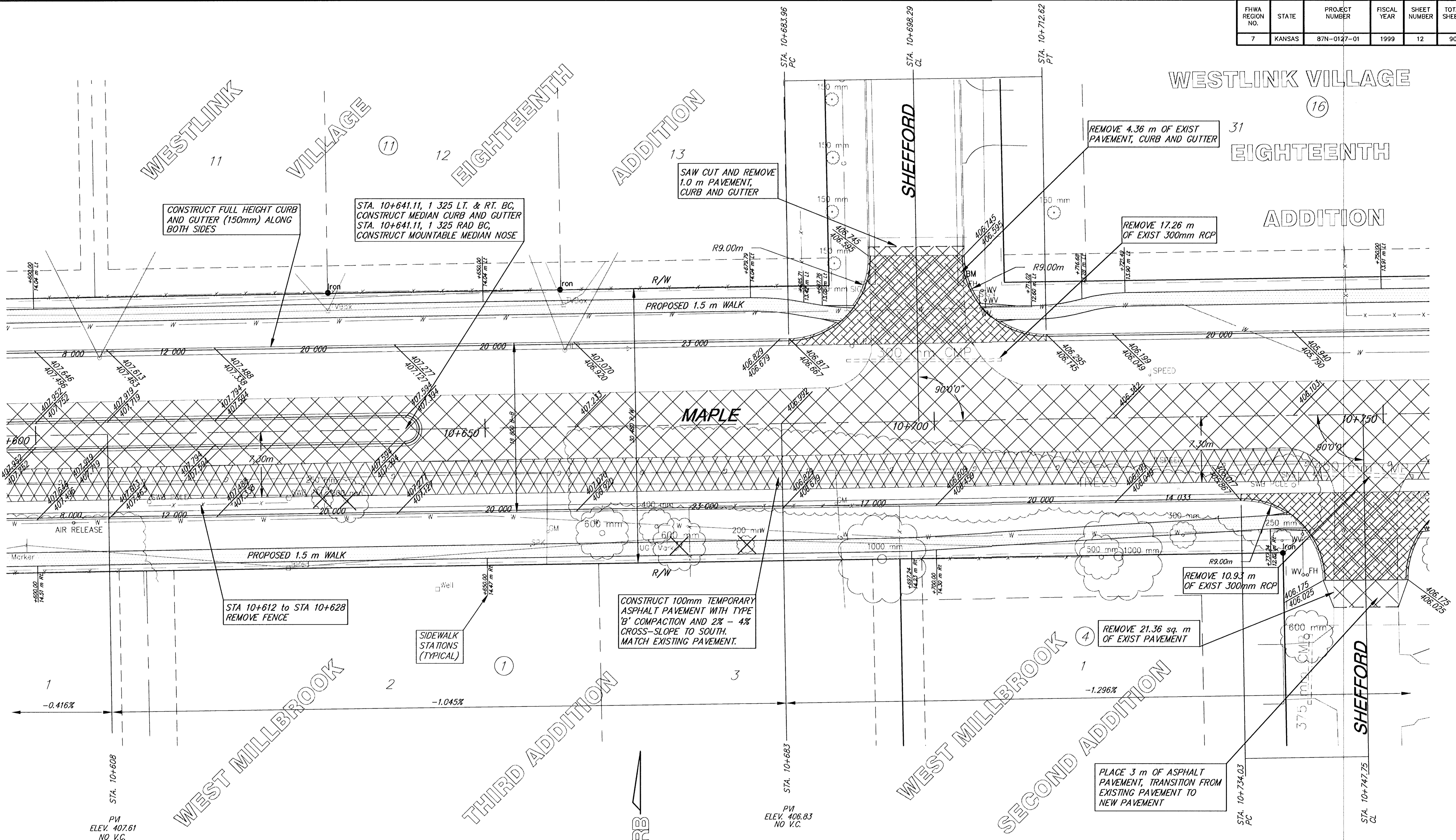

WEST MILLBROOK

THIRD ADDITION

WEST MILLBROOK
SECOND ADDITION

WESTLINK VILLAGE
16
EIGHTEENTH
ADDITION

SRB

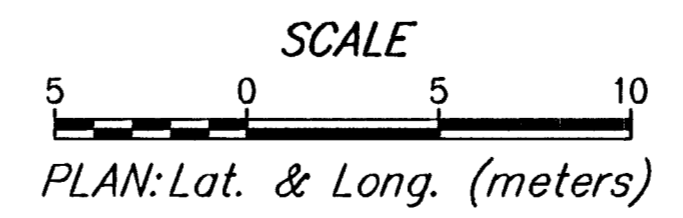

MAPLE ST. IMPROVEMENTS - 119TH ST. W. TO MAIZE RD.
PAVEMENT PLAN-STA. 10+600 TO STA. 10+750

SRB 924 NORTH MAIN WICHITA, KANSAS 67203
316-264-8006 FAX 264-4621
http://www.srb.com/ E-Mail: wsr@srb.com

SAVOY, RUGGLES & BOHM, P.A.
ENGINEERING & SURVEYING

PROJECT NUMBER: 472-76-245-83053-000-000-001

DESIGN	REVIEW	DATE	UTILITY	SRB JOB
Staff	Staff	8-13-00		1216T

12
90