

FHWA REGION NO.	STATE	PROJECT NUMBER	FISCAL YEAR	SHEET NUMBER	TOTAL SHEETS
7	KANSAS	87N-0127-01	1999	13	90

BY	DATE
REFERENCES NOTED	
REFERENCES CHECKED	

WESTLINK VILLAGE  
EIGHTEENTH ADDITION

OAK CLIFF ESTATES 3RD ADDITION

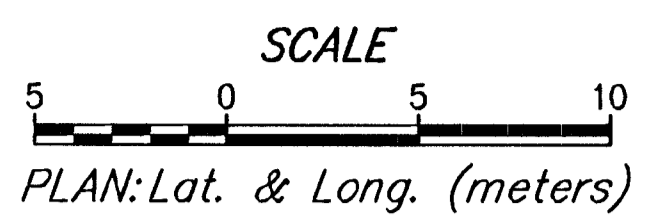
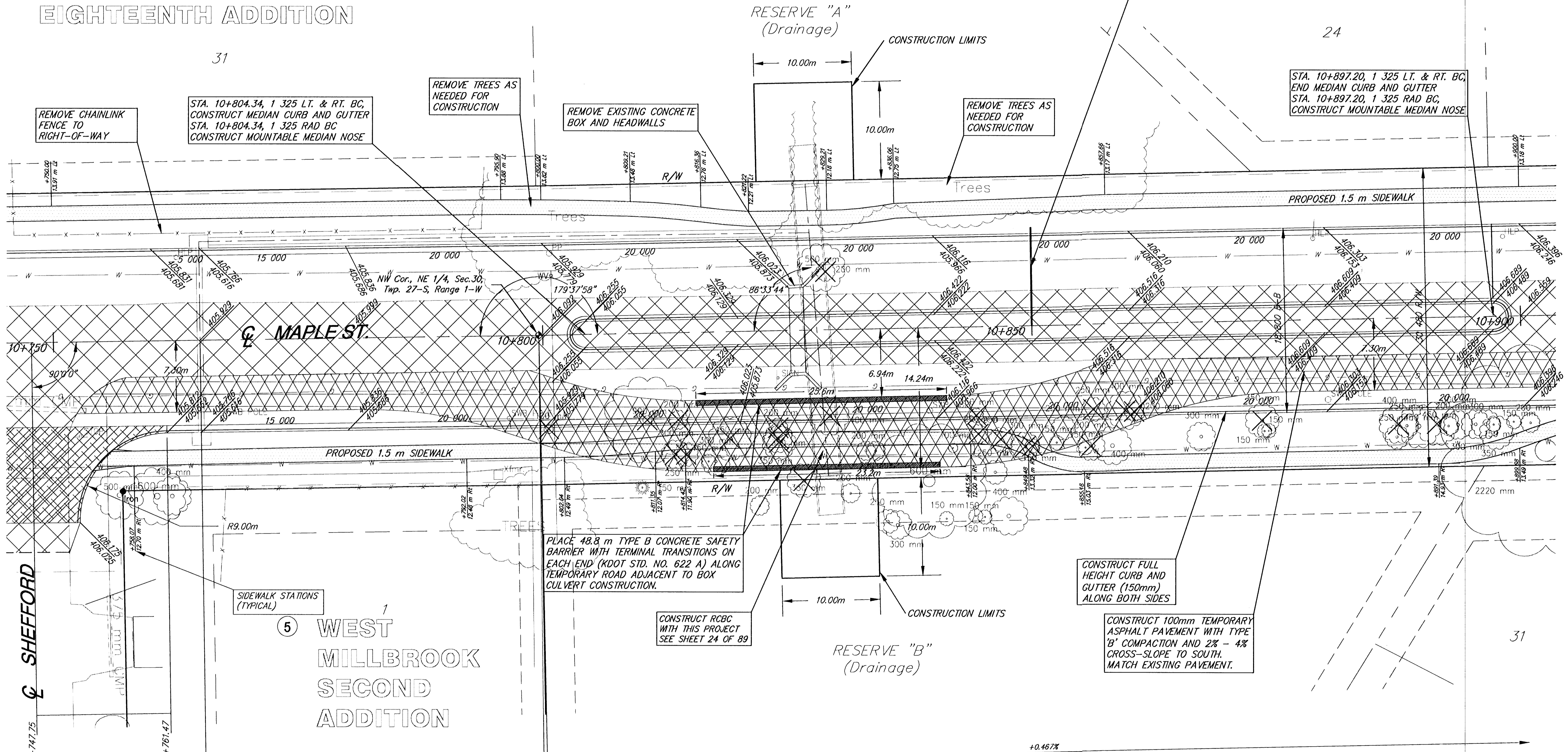

STA. 10+850.00, CL TO 10 000 LT,  
INSTALL 100mm C-900 IRRIGATION  
SLEEVE BELOW PAVEMENT SUBGRADE,  
100mm CAP ON ENDS & MARK WITH  
25mm PVC PIPE PROTRUDING 500mm  
FROM FINISHED GRADE.

STA. 10+897.20, 1 325 LT. & RT. BC,  
END MEDIAN CURB AND GUTTER  
STA. 10+897.20, 1 325 RAD BC,  
CONSTRUCT MOUNTABLE MEDIAN NOSE

PLACE 48.8 m TYPE B CONCRETE SAFETY  
BARRIER WITH TERMINAL TRANSITIONS ON  
EACH END (KDOT STD. NO. 622 A) ALONG  
TEMPORARY ROAD ADJACENT TO BOX  
CULVERT CONSTRUCTION.

CONSTRUCT FULL HEIGHT CURB AND  
GUTTER (150mm)  
ALONG BOTH SIDES

CONSTRUCT 100mm TEMPORARY  
ASPHALT PAVEMENT WITH TYPE  
'B' COMPACTION AND 2% - 4%  
CROSS-SLOPE TO SOUTH.  
MATCH EXISTING PAVEMENT.

CONSTRUCT RCBC  
WITH THIS PROJECT  
SEE SHEET 24 OF 89

SIDEWALK STATIONS  
(TYPICAL)

⑤ WEST  
MILLBROOK  
SECOND  
ADDITION

MAPLE ST. IMPROVEMENTS - 119TH ST. W. TO MAIZE RD.  
PAVING PLANS STA 10+750 TO 10+900

	224 NORTH MAIN WICHITA, KANSAS 67203 http://www.srb.com/~srb	318-264-8008 FAX 264-4621 E-Mail: srb@srb.com
	<b>SAVOY, RUGGLES &amp; BOHM, P.A.</b> ENGINEERING & SURVEYING	
PROJECT NUMBER <b>472-76-245-83053-000-000-001</b>		
DRAWN Staff	DESIGN Staff	REVIEW DATE 6-13-00
UTILITY SRB JOB 1218T		SHEET NUMBER <b>13</b> TOTAL SHEETS <b>90</b>