

P.O.T. #5 Sta. 13+00.23
 1. 1/2" Bar and Cap

P.O.T. #6 Sta. 11+56.60
 1. 1/2" Bar and Cap
 2. PK Nail in North End of Expansion Joint in Exist. Sidewalk 19.45 N.E.
 3. PK Nail in North End of Expansion Joint in Exist. Sidewalk 31.9 W.
 4. South Edge of Sidewalk 5.4 S.

P.O.T. #7 Sta. 10+00.00
 1. 1/2" Bar and Cap on South side Cowskin Creek 12.0 S.E.
 2. 8" Tree 9.0 N.E.
 3. 8" Tree 17.0 N.W.
 4. 10" Tree

Sta. 10+98.00 Const.
 92'-0" Steel Span
 Pedestrian Bridge
 6'-0" Treadway

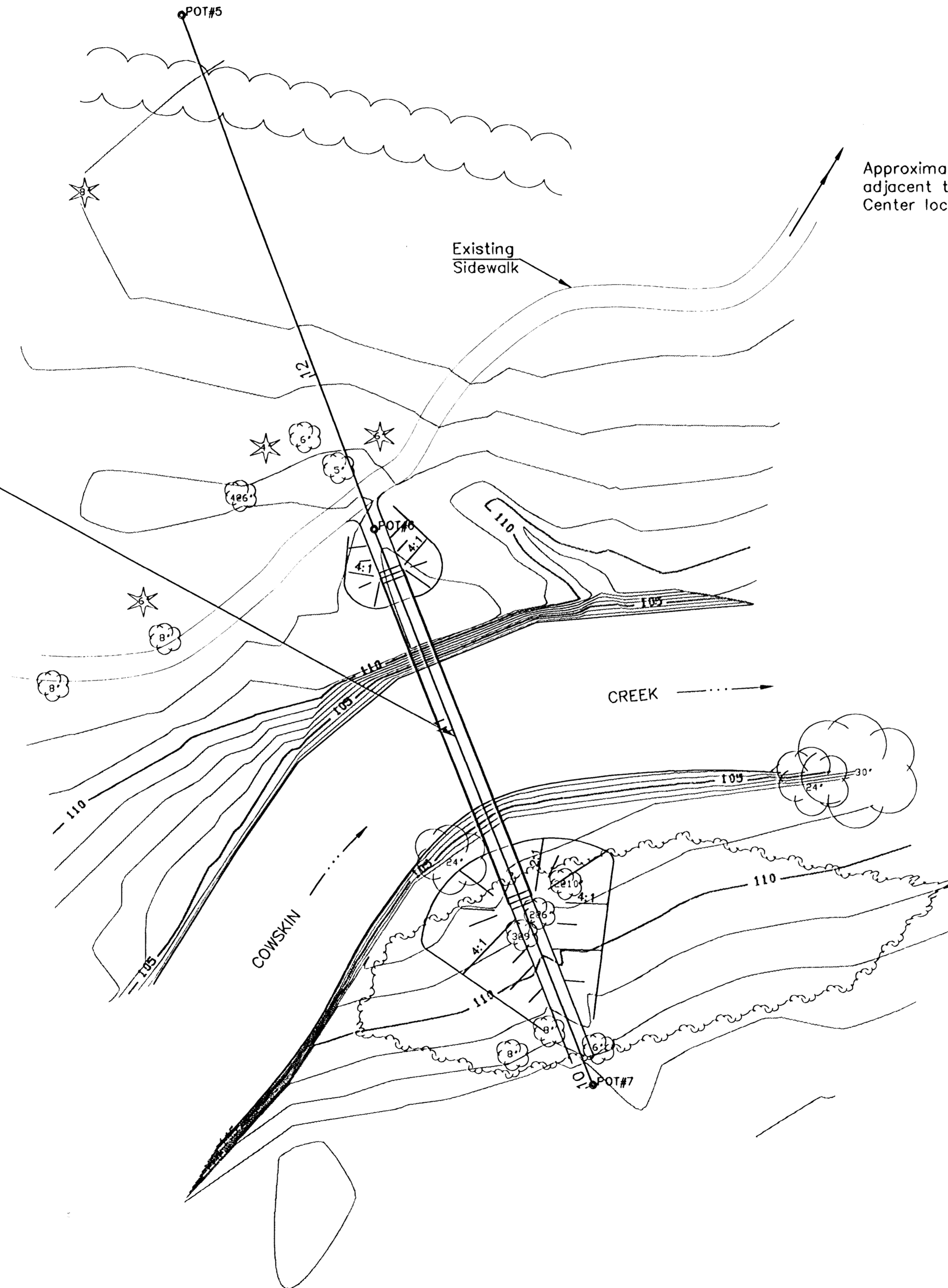

Approximately 1200' to parking area adjacent to Pawnee Prairie Park Nature Center located at 2625 S. Tyler Road

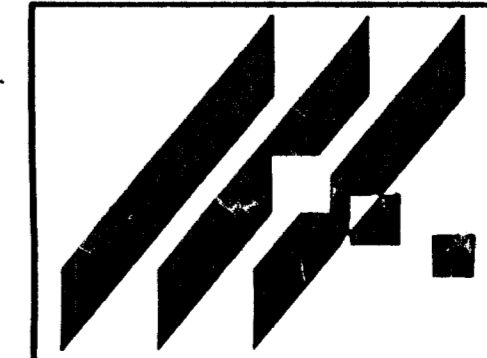
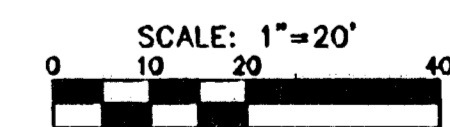

MID-KANSAS ENGINEERING
 CONSULTANTS, INC.
 411 N. WEBB ROAD
 WICHITA, KS. 67206
 316-684-9600

| | | |
|----------------------------|------------------|---------------|
| PAWNEE PRAIRIE PARK | | |
| PROJECT NAME | | |
| CONTOUR MAP | | |
| SHEET TITLE | | |
| KJS | ADL, KLH | KJS |
| DESIGN BY: | DRAWN BY: | CHECKED BY: |
| 3-29-95 | 94146-113 | 2 / 4 |
| DATE | JOB NO. | SHEET / TOTAL |