

PROJECT NO.	YEAR	SHEET NO.	TOTAL SHEETS
618-34	1998	27	100

- P.I. @ STA. 23+43.48 (50)
- FOUND 1" IRON PIPE
 - NAIL & SHINER IN POWER POLE 47.44' W
 - SPIKE & KDOT WASHER TOP FENCE POST 63.78' SW
 - NAIL & SHINER IN POWER POLE 62.00' SE
 - NAIL & SHINER IN FENCE POST 62.00' NE

Scale: 1"=20'

COORDINATE TABLE		
POINT NO.	NORTH COORDINATE	EAST COORDINATE
50	579370.4480	374538.9985

SW 1/4, Sec. 15, T27S, R2E

NW 1/4, Sec. 15, T27S, R2E

BALTHROP ADDITION

Preston Trails LC MI-8248

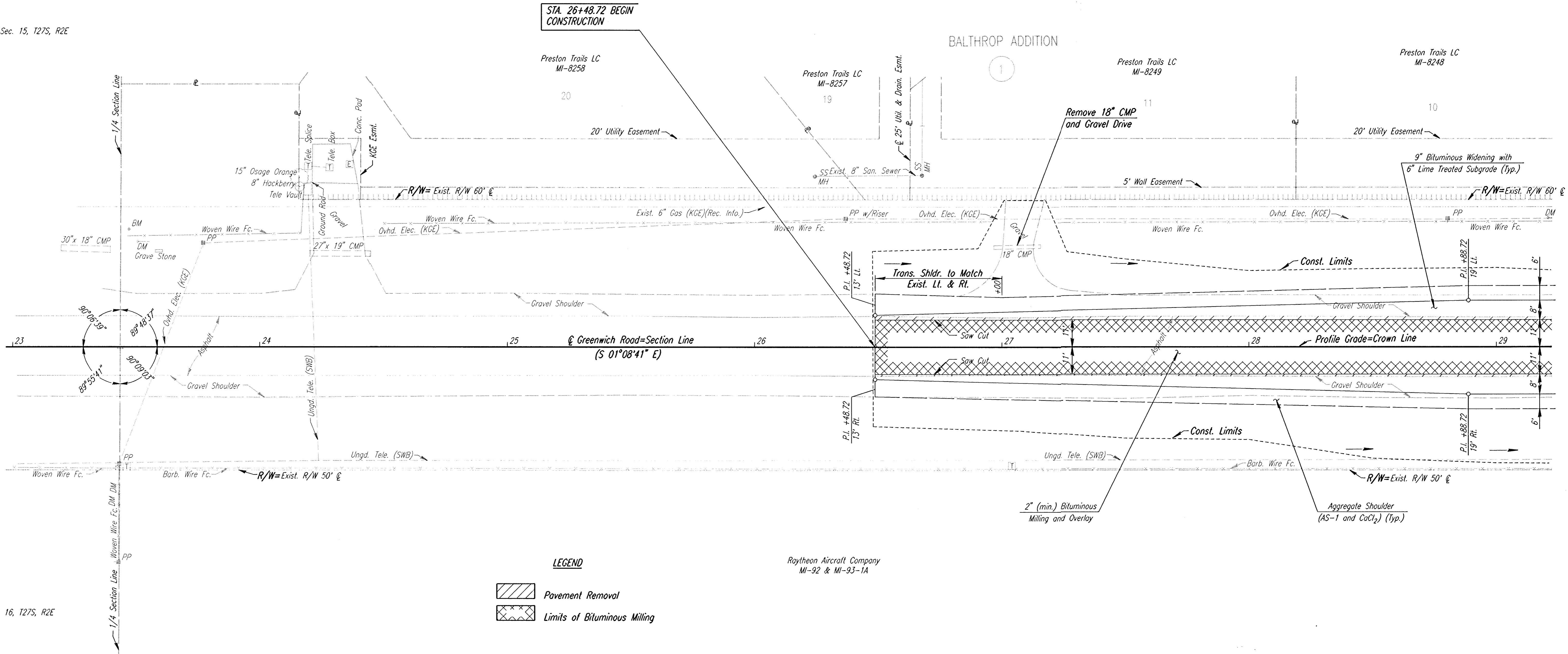

- LEGEND**
- Pavement Removal
 - Limits of Bituminous Milling

Raytheon Aircraft Company MI-92 & MI-93-1A

- UTILITIES**
- Power Kansas Gas & Electric
 - Gas Kansas Gas & Electric
 - Telephone Southwestern Bell
 - San. Sewer Sedgwick County

- W 1/4 COR. SEC. 15, T27S, R2E (50)
- Q STA. 23+43.48 GREENWICH ROAD
- FOUND 1" IRON PIPE
 - NAIL & SHINER IN POWER POLE 47.44' W
 - SPIKE & KDOT WASHER TOP FENCE POST 63.78' SW
 - NAIL & SHINER IN POWER POLE 62.00' SE
 - NAIL & SHINER IN FENCE POST 62.00' NE

BM #53: CITY OF WICHITA DISC 48' EAST OF Q GREENWICH RD.,
1/2 MILE NORTH OF CENTRAL AVENUE.
48' LT. STA. 23+47 ELEV.=1389.22

No.		Revisions		By	Date
SEDGWICK COUNTY BUREAU OF PUBLIC SERVICES					
GREENWICH ROAD STA. 23+00 TO STA. 29+00					
PROJECT NO. 618-34			SEDGWICK COUNTY		
PROFESSIONAL ENGINEERING CONSULTANTS, P.A. ENGINEERS WICHITA, KANSAS					
Designed by	JPS	Checked by	WDH		
Drawn by	BJS/MAF	Date	JULY 1997	Job No. 95297-2	

1:1995/95297/002/st23-29.dgn
 Drawn by: BJS/maf
 Plotted by: maf 8-14-97