

PROJECT NO.	YEAR	SHEET NO.	TOTAL SHEETS
618-34	1998	114	100

Scale: 1"=40'

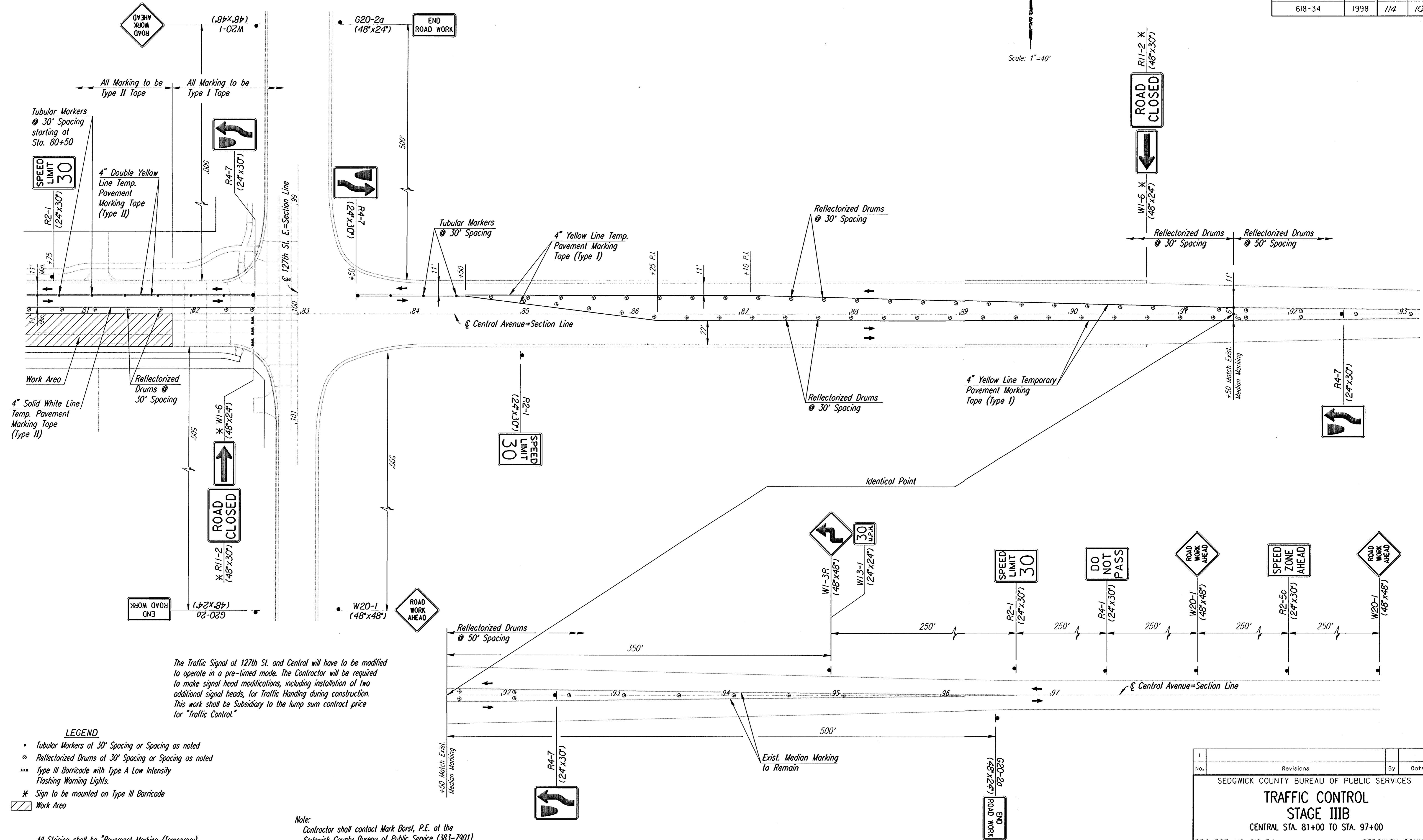

The Traffic Signal at 127th St. and Central will have to be modified to operate in a pre-timed mode. The Contractor will be required to make signal head modifications, including installation of two additional signal heads, for Traffic Handling during construction. This work shall be Subsidiary to the lump sum contract price for "Traffic Control."

**LEGEND**

- Tubular Markers at 30' Spacing or Spacing as noted
- Reflectorized Drums at 30' Spacing or Spacing as noted
- \*\*\* Type III Barricade with Type A Low Intensity Flashing Warning Lights.
- \* Sign to be mounted on Type III Barricade
- ▨ Work Area

All Striping shall be "Pavement Marking (Temporary) (Type as shown)".

Note: Contractor shall contact Mark Borst, P.E. at the Sedgewick County Bureau of Public Service (383-7901) prior to beginning work that affects the Traffic Signal at Central and 127th Street E.

i:/1995/95297/002/1/traconr1/traconr13d.dgn  
Drawn by: maf  
Plotted by: maf 7-25-97

Revisions		By	Date
No.			
SEDGWICK COUNTY BUREAU OF PUBLIC SERVICES			
<b>TRAFFIC CONTROL</b>			
<b>STAGE IIIB</b>			
CENTRAL STA. 81+00 TO STA. 97+00			
PROJECT NO. 618-34		SEDGWICK COUNTY	
<b>PROFESSIONAL ENGINEERING CONSULTANTS, P.A.</b>			
ENGINEERS WICHITA, KANSAS			
Designed by	WDH	Checked by	RPG
Drawn by	MAF	Date	JULY 1997
		Job No.	95297-2