

GENERAL NOTES

- THE ENGINEER IN CHARGE OF CONSTRUCTION SHALL APPROVE ALL LOCATIONS FOR TRAFFIC SIGNAL POLES TO BE INSTALLED. FINAL POSITIONS & POINTING OF SIGNAL FACES TO BE DETERMINED IN THE FIELD.
- THE TRAFFIC SIGNAL SYSTEM SHALL CONFORM TO AND BE OPERATED ACCORDING TO THE REQUIREMENTS OF THE CURRENT M.U.T.C.D.
- THE CONTRACTOR SHALL CONTACT LOCAL UTILITY COMPANIES TO ADVISE THEM OF INSTALLATION AND COORDINATE POWER HOOK-UP.
- ALL WIRING INSTALLED SHALL CONFORM TO THE NATIONAL ELECTRICAL CODE AND LOCAL ORDINANCES & REQUIREMENTS.
- THE POWER SUPPLY AND THE OPERATION & MAINTENANCE OF THE SIGNAL SYSTEM SHALL BE THE RESPONSIBILITY OF THE CONTRACTOR.
- THE CONTRACTOR SHALL FURNISH, INSTALL AND MAINTAIN THE RIO-6 SIGNS AND RAISED PAVEMENT MARKERS AND SHALL BE SUBSIDIARY TO THE TEMPORARY SIGNALS.
- THE UNI-DIRECTIONAL TEMPORARY PAVEMENT MARKER, APPROXIMATELY 4" X 4" X 1/2", SHALL BE A HIGH-IMPACT PLASTIC UNIT, YELLOW IN COLOR AND REFLECTORIZED WITH A 1.6 SQ. IN. MINIMUM AREA YELLOW REFLECTOR OF AN INTERNAL PRISMATIC CUBE CORNER DESIGN. THESE MARKERS SHALL BE APPLIED TO THE PAVEMENT WITH A BITUMEN ADHESIVE, SHALL BE REMOVABLE WITHOUT DAMAGE TO THE ROADWAY SURFACE, AND SHALL BE APPROVED BY THE ENGINEER PRIOR TO INSTALLATION.

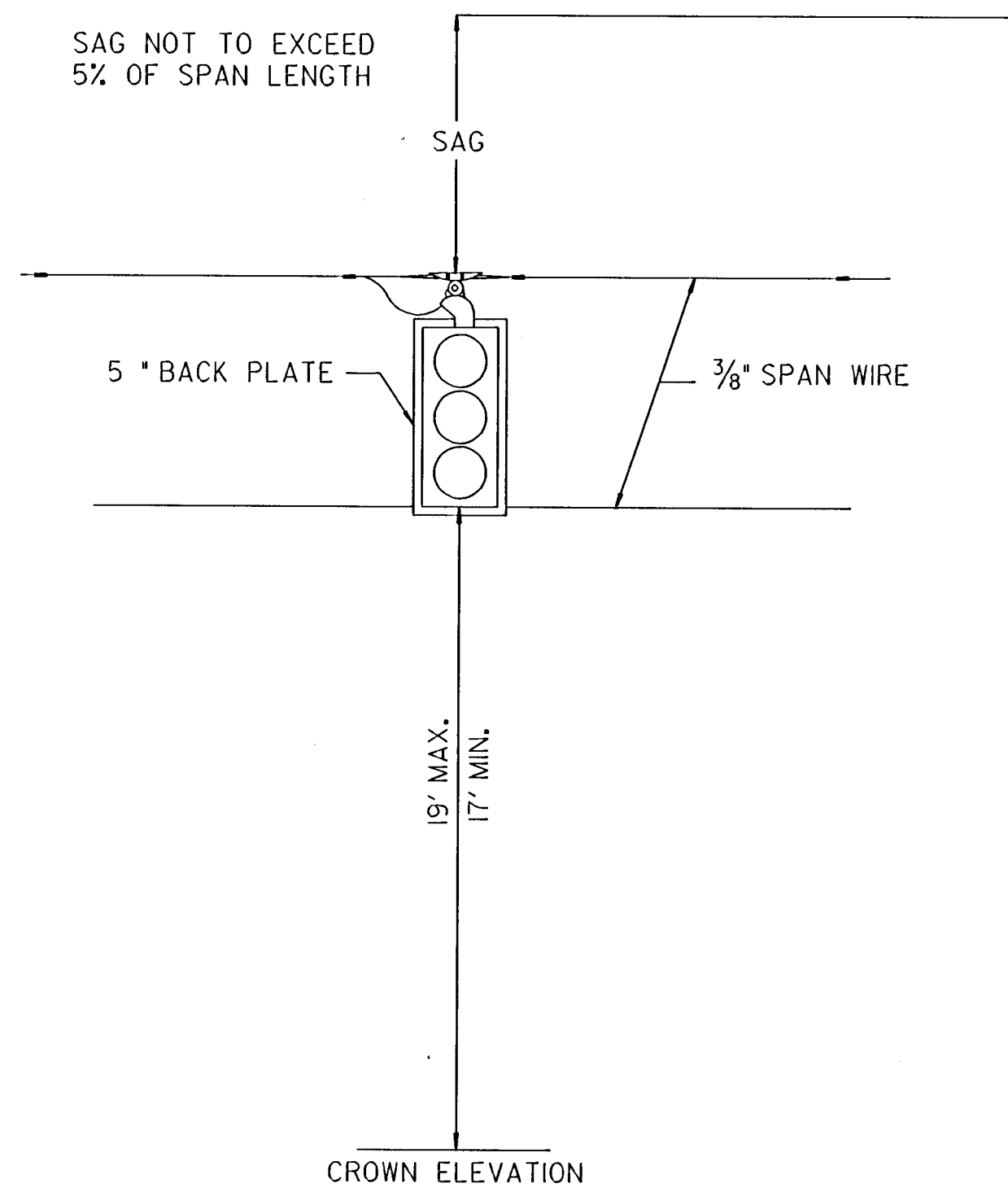

DETECTOR SHALL BE SET TO OPERATE IN THE LOCKING MODE

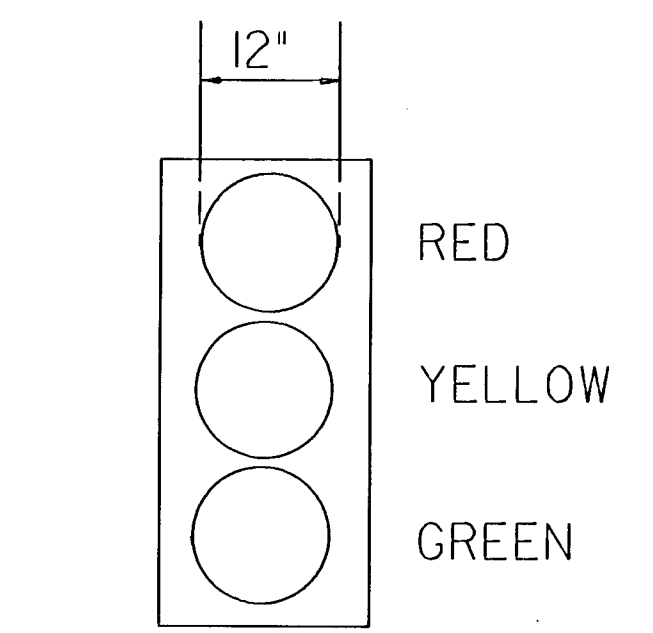
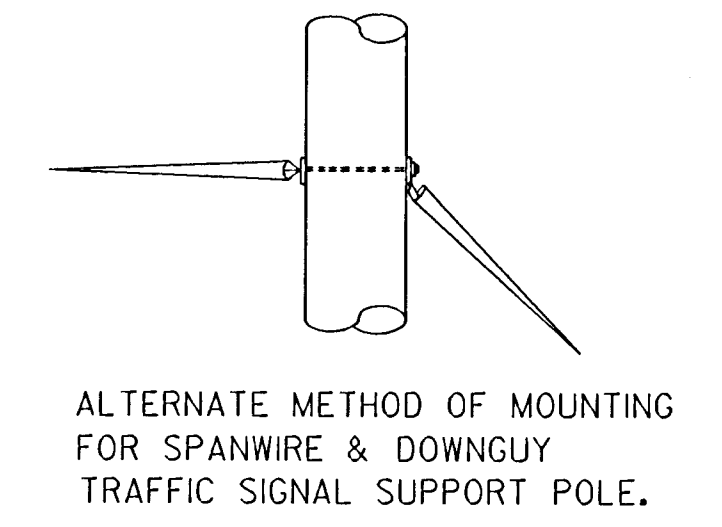
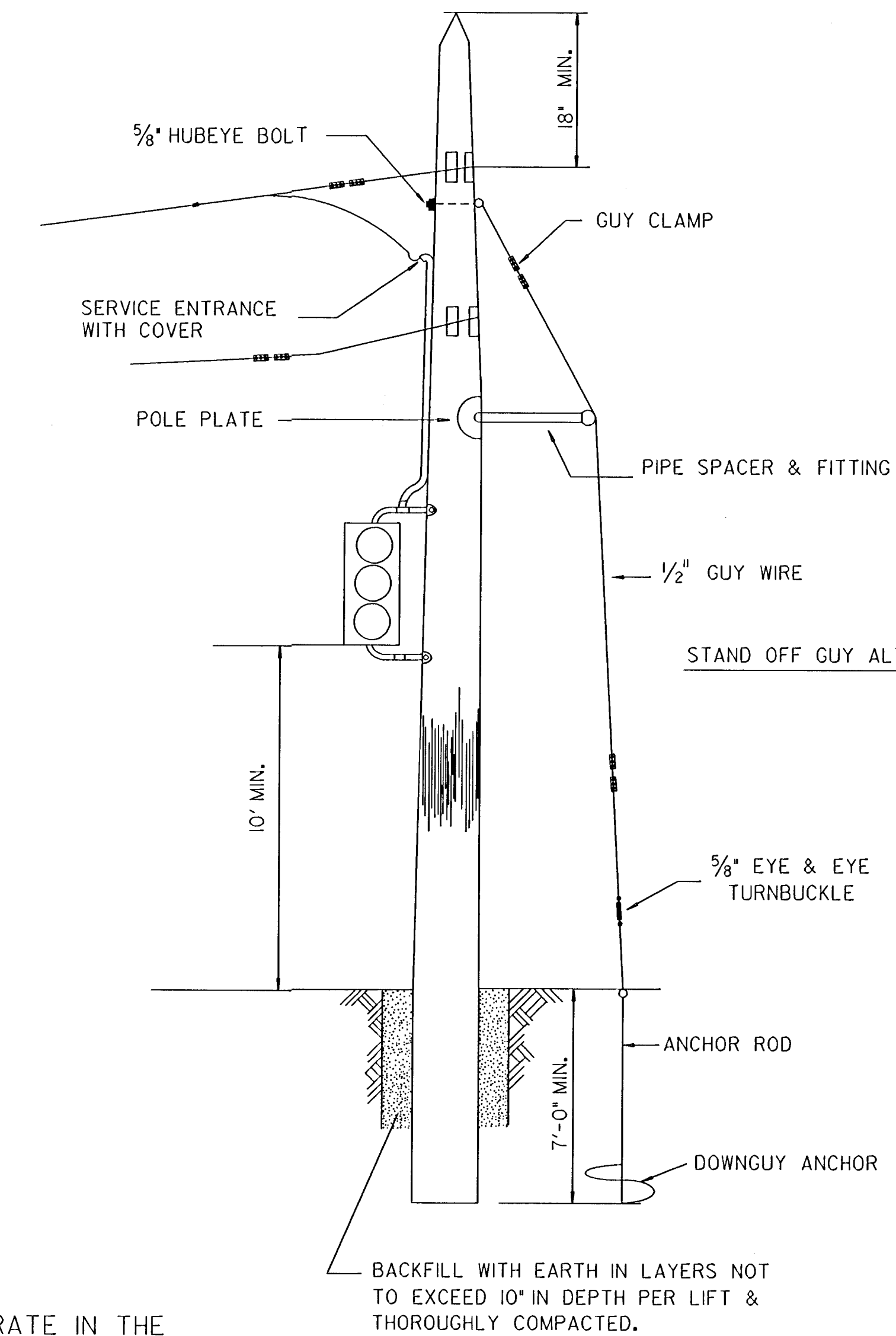

SIGNAL INDICATIONS

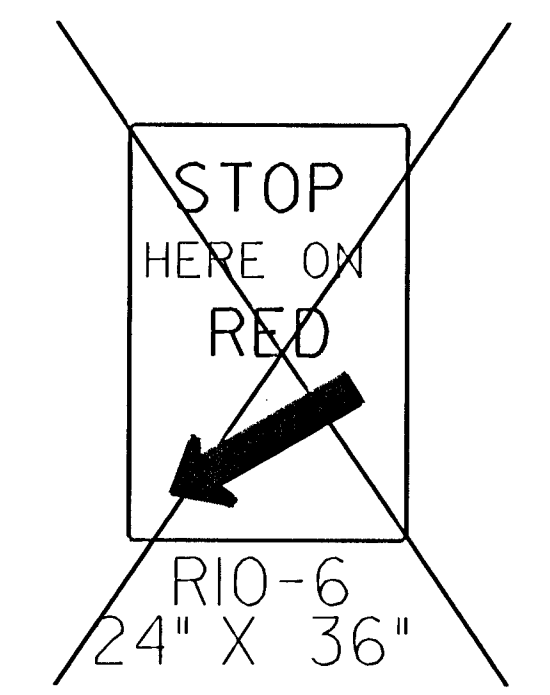
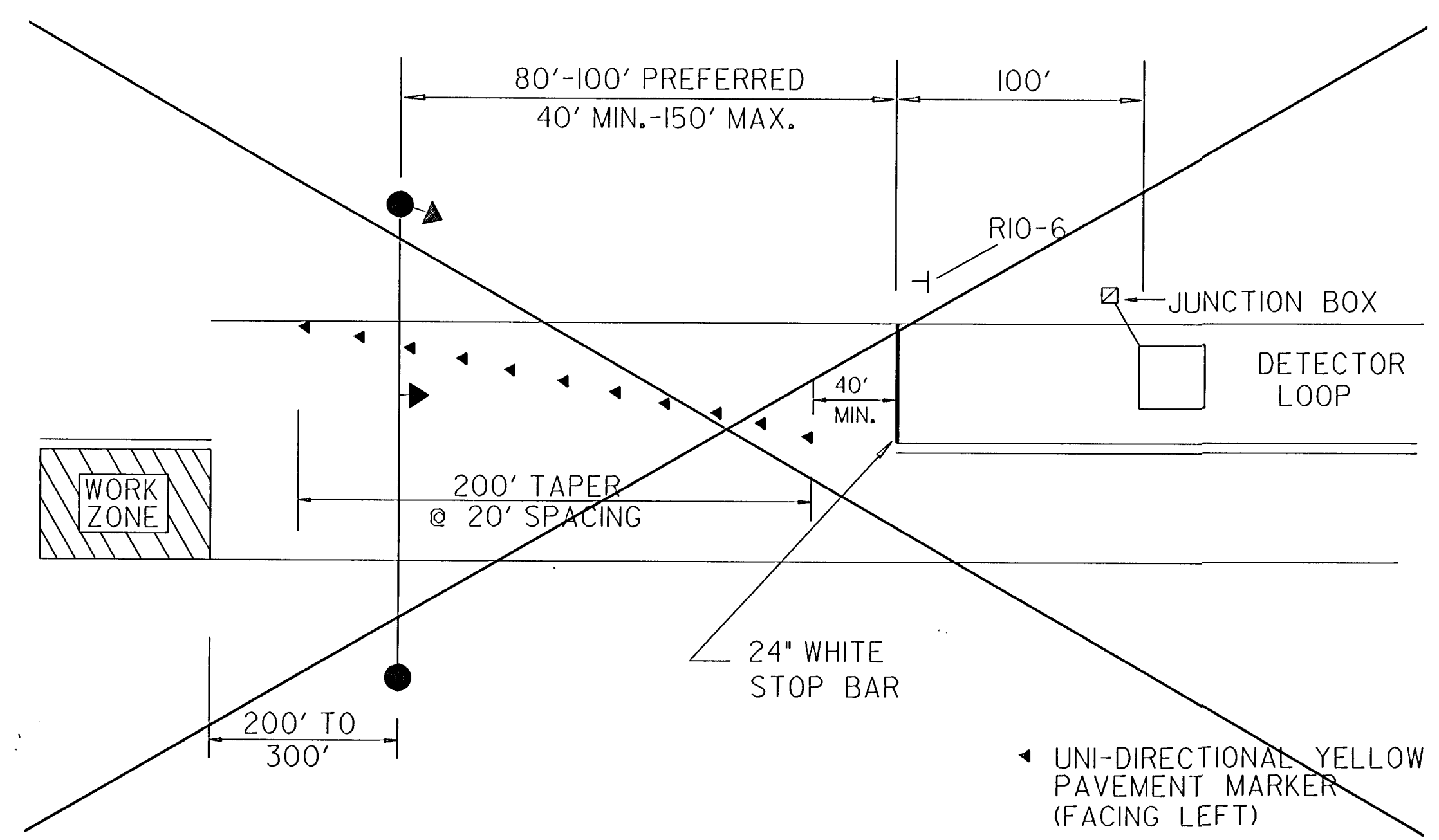

3					
2					
1	7-1-93	BACKPLATE & DETECTOR LOCATION	KFH	NAJ	
NO.	DATE	REVISIONS	BY	APP'D	

KANSAS DEPARTMENT OF TRANSPORTATION
TEMPORARY TRAFFIC SIGNALS
FOR ONE-LANE OPERATION
(TYPICAL INSTALLATION)
 11-6-91 SHEET 1 OF 2

DESIGNED	QUANTITIES	TRACED
DETAIL CK.	QUAN. CK.	TRACE CK.

FHWA APPROVED 10-06-93 APP'D Arlen F. Toppan

i:/1995/95298/002/standard/te804.dgn
 Drawn by: KD0T
 Plotted by: maf 7-25-97