

PLWA REGION NO.	STATE	PROJECT NO.	YEAR	SHEET NUMBER	TOTAL SHEETS
7	KANSAS	87 N-0022-01	1999	12	69

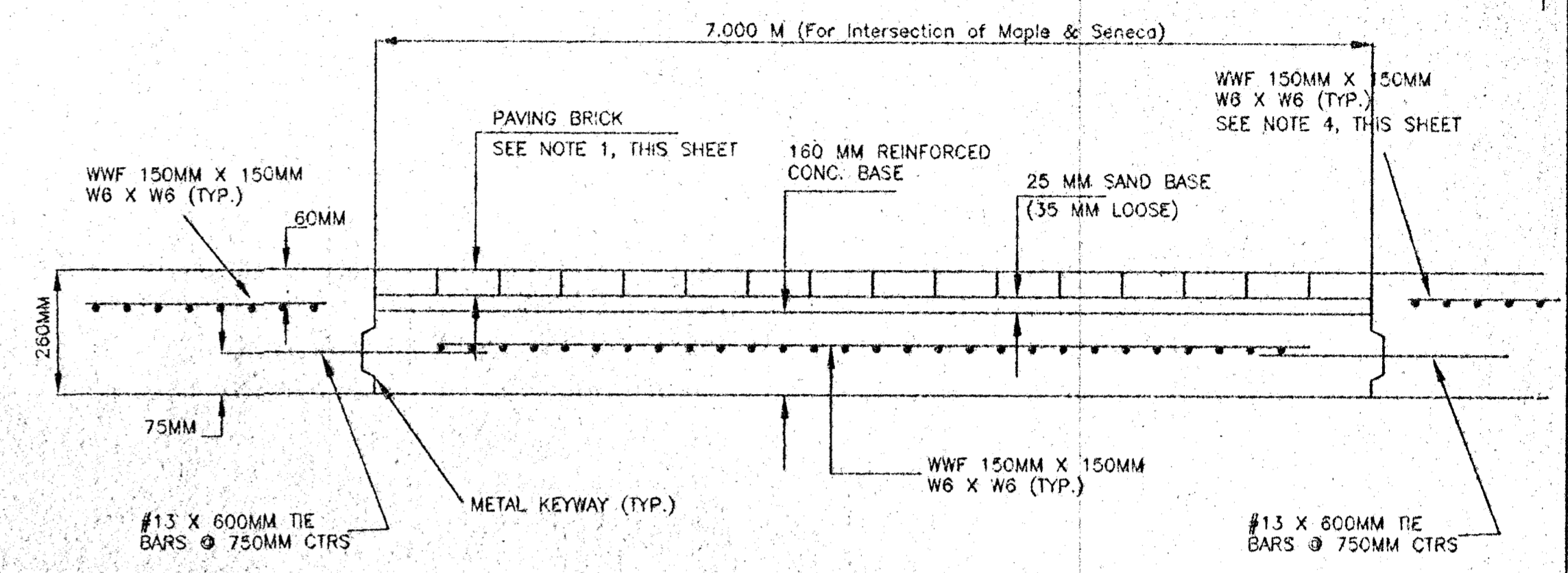
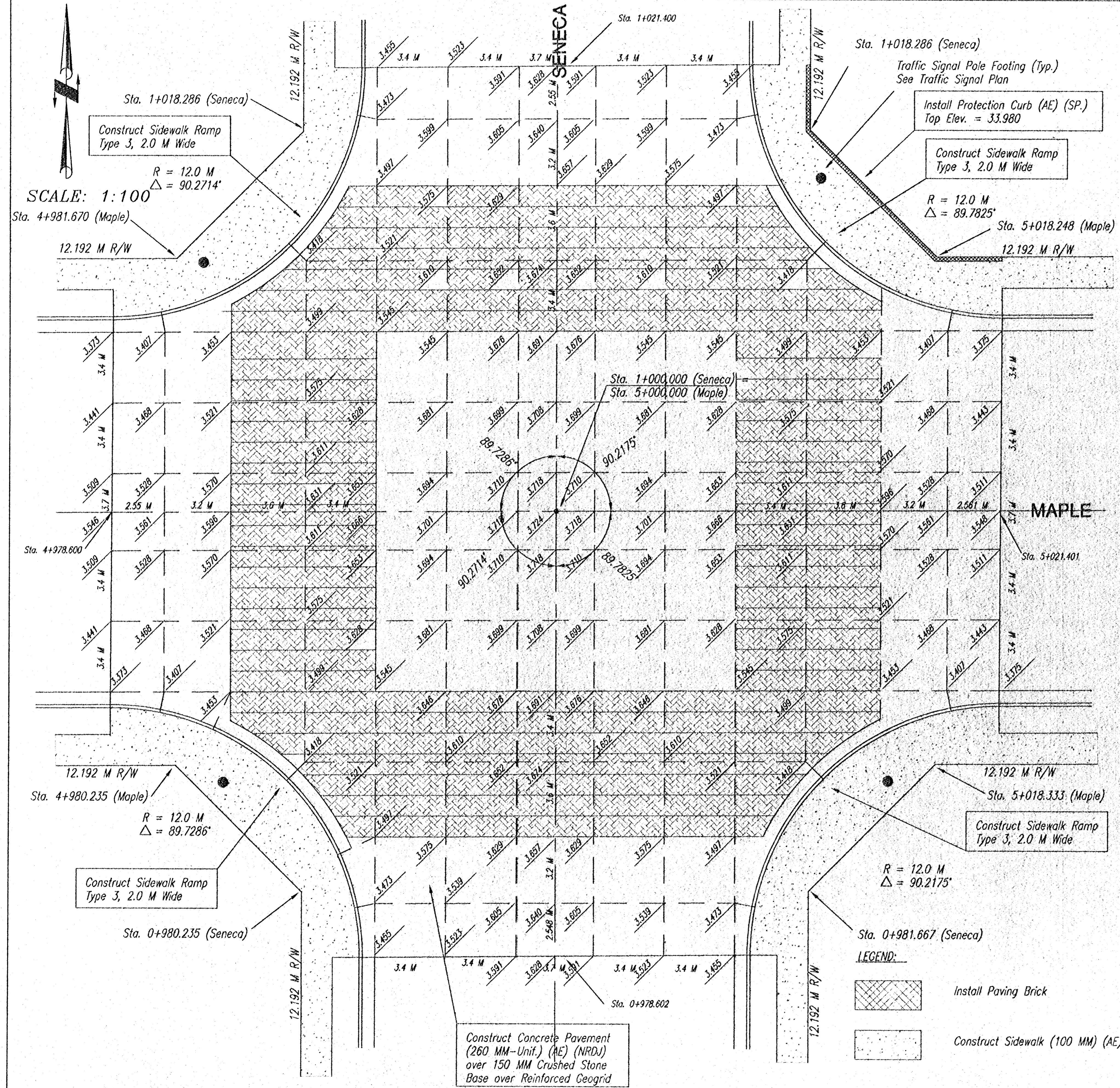

PAVING BRICK

GENERAL NOTES

1. Paving Brick shall be designed for heavy duty vehicular traffic and shall meet ASTM C 1272, Type F, Application PX. Two colors of paving brick shall be used: a. Golden Buff Velour by Endicott Clay Products Company and b. Manganese Ironspot by Endicott Clay Products Company. Paving Brick shall be chamfered or rounded to minimize chipping. Distributor for this brick is Lusco Brick (316-262-0406).
2. 15 MM sand base shall be Subsidiary to "Paving Brick".
3. 160 MM Reinforced Concrete Base shall be paid for under Bid Item 160 MM-Conc. Pavement (AE)
4. This reinforcement to be placed in concrete panels adjacent to brick crosswalk and is Subsidiary to PAVING BRICK.
5. Additional work involved in forming pavement for Paving Brick will be Subsidiary to PAVING BRICK.

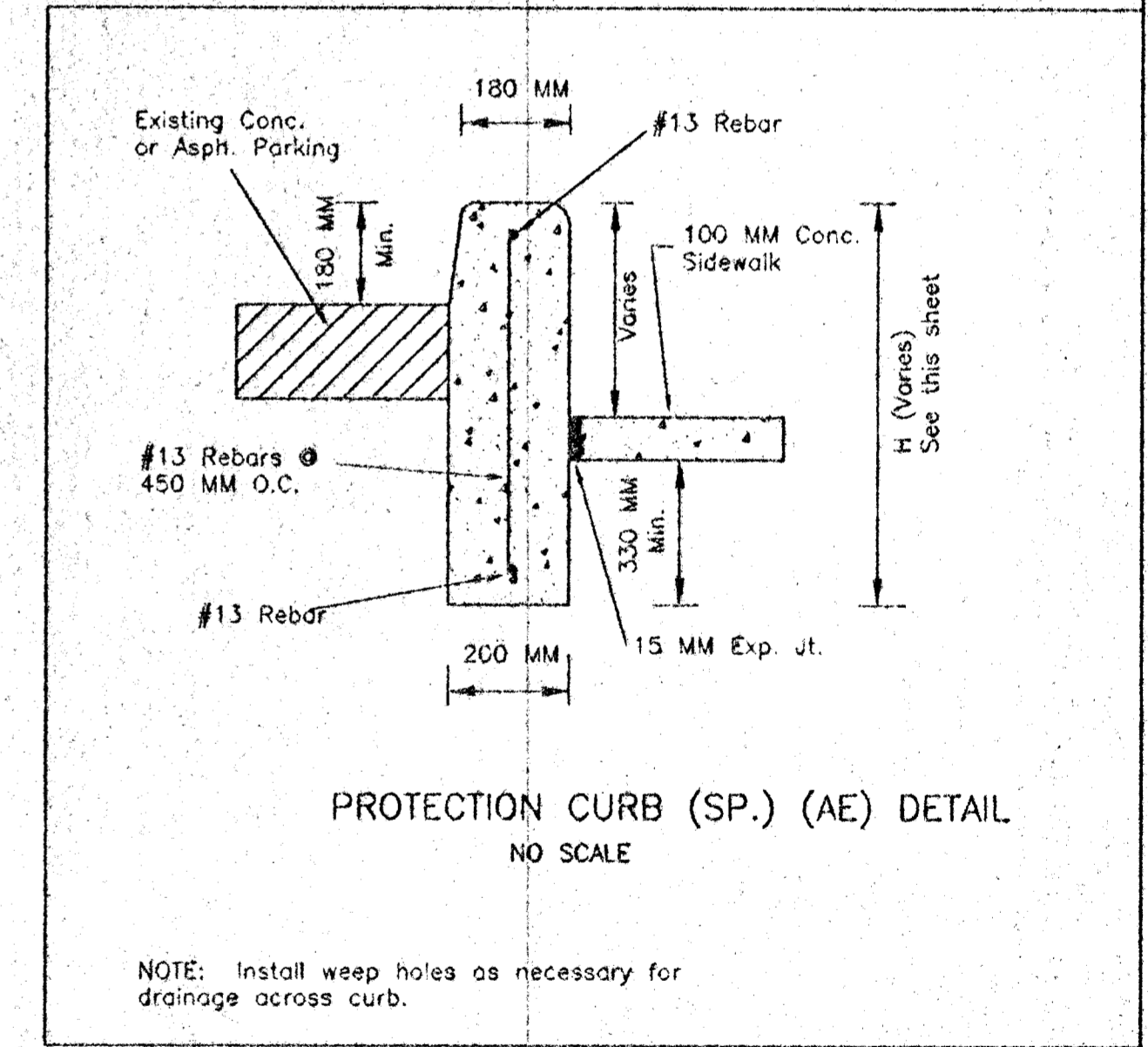

PROTECTION CURB (SP.) (AE) DETAIL
NO SCALE

LEGEND:

- Install Paving Brick
- Construct Sidewalk (100 MM) (AE)

INTERSECTION DETAILS

SCALE:	APPROVED:	DRAWN BY:
DATE:	CHECKED:	CHECKED:
PROJECT NO:		SHEET NO.: