

STREET	STATION	OFFSET	PROPOSED ELEVATION
WILD ROSE	22+51.5	24' R	143.6
WILD ROSE	24+96.03	26' R	144.0

SCALE: 1"=20'

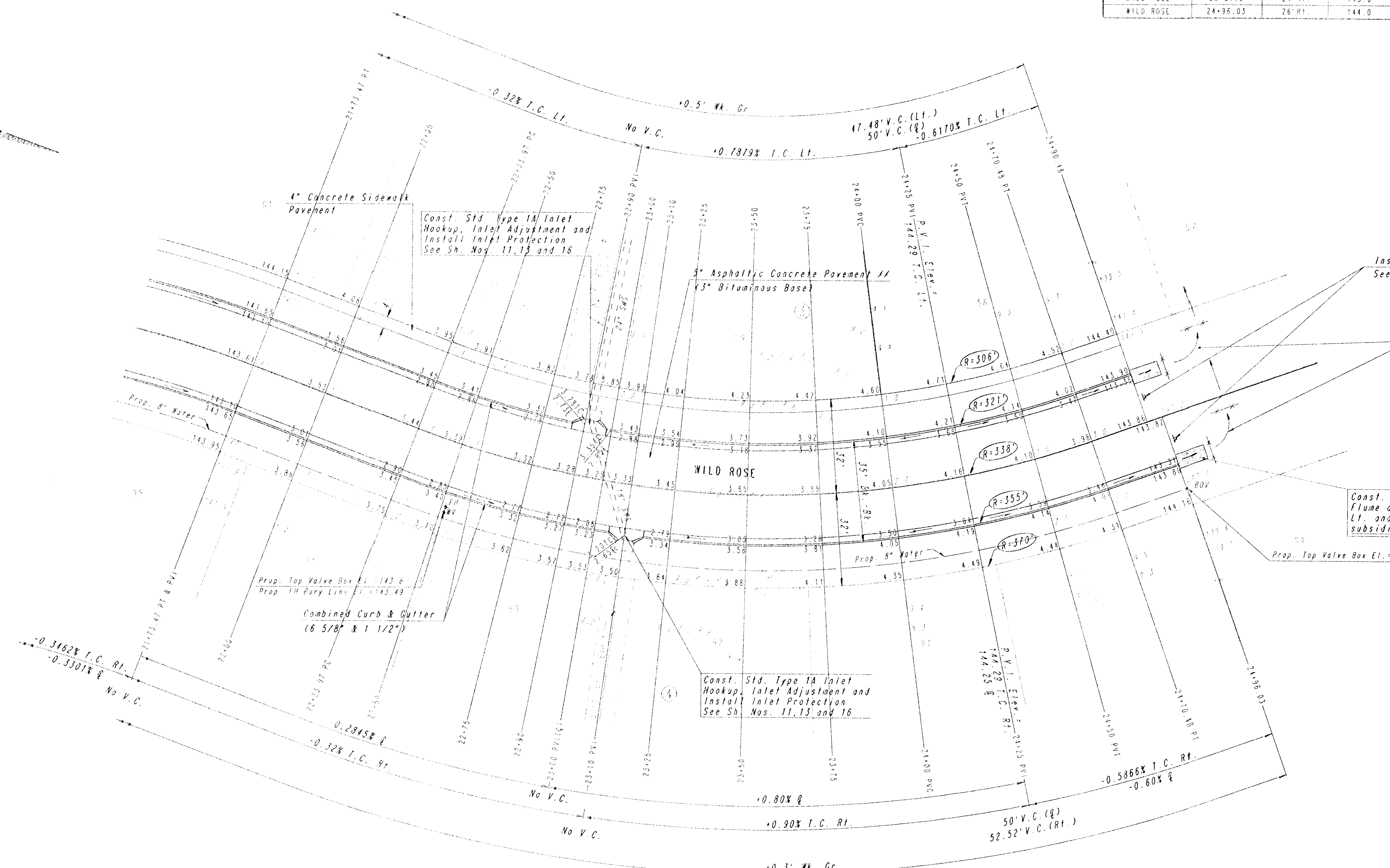

PLAN	SUBMITTED	DATE
NOISE BOOK	PLOTTED	
NO.	ALIGNMENT	CHECKED
		BY
		DATE

Q STATION	Q ARC LENGTH	FACE CURB LENGTH LEFT CURB	FACE CURB LENGTH RIGHT CURB	CHORD LENGTH	DEFLECTION ANGLE	Q TOTAL DEFLECTION
22+33.97	16.03'	15.23'	16.93'	14.84'	17.21'	0°00'00"
22+50	25.00'	23.74'	26.26'	23.15'	26.84'	1°21'31"
22+75	25.00'	23.74'	26.26'	23.15'	26.84'	2°43'02"
22+90	15.00'	14.24'	15.76'	13.89'	16.11'	1°16'17"
23+10	10.00'	9.50'	10.50'	9.26'	10.74'	0°50'51"
23+25	15.00'	14.24'	15.76'	13.89'	16.11'	1°16'17"
23+50	25.00'	23.74'	26.26'	23.15'	26.84'	2°43'02"
23+75	25.00'	23.74'	26.26'	23.15'	26.84'	3°58'33"
24+00	25.00'	23.74'	26.26'	23.15'	26.84'	5°14'04"
24+25	25.00'	23.74'	26.26'	23.15'	26.84'	6°29'35"
24+50	25.00'	23.74'	26.26'	23.15'	26.84'	7°45'06"
24+70.48	20.48'	19.47'	21.50'	18.96'	21.99'	17°44'04"
TOTAL	236.51'	224.62'	248.41'			20°02'46.5"

NOTE: STORM WATER SEWER INLETS AND PIPES TO BE CONSTRUCTED BY OTHERS UNDER C.O.W. PROJECT NO. 468-86-245-82324-000-000-001
 ** 7" ASPHALTIC CONCRETE PAVEMENT (5" BIT. BASE) FOR ALTERNATE 2 PAVEMENT

FOREST LAKES
 PHASE NO. 8
WILD ROSE
 STA. 21+73.47 TO STA. 24+96.03

PROFESSIONAL ENGINEERING CONSULTANTS, P.A.
 ENGINEERS
 WICHITA, KANSAS

Designed by	WMB, GDD	Checked by	
Drawn by	DEP	Date	FEB., 1994
		Job No.	93695

DRAWING NAME: 30-93695 WILD ROSE 2
 LOCATION: 47119
 CENTER COORDINATES:
 DATE LAST WORKED ON:
 DRAWING DUNK