

CITY OF WICHITA, KANSAS

MICHAEL E. LINDEBAK, P.E., CITY ENGINEER

ROCK ROAD IMPROVEMENTS

**ROCK ROAD - FROM APPROXIMATELY 500 FEET SOUTH OF DOUGLAS AVENUE TO
A POINT APPROXIMATELY 1600 FEET SOUTH OF DOUGLAS AVENUE**

INDEX OF SHEETS

1. TITLE SHEET
2. PLAT
- 3.-4. TYPICAL SECTIONS
- 5.-7. PAVING PLANS
8. LANDSCAPING AND ISLAND DETAILS
9. VALLEY GUTTER DETAILS
10. MISCELLANEOUS PAVING DETAILS
11. PLAN AND PROFILE-SWS LINE NO. 1
12. STANDARD TYPE II INLET
- 13.-15. MARKING AND SIGNING PLANS
16. SIGNING DETAILS
17. TRAFFIC SIGNAL PLAN
18. TRAFFIC SIGNAL QUANTITIES
- 19.-22. TRAFFIC SIGNAL DETAILS
23. CONSTRUCTION SEQUENCE
- 24.-25. TRAFFIC CONTROL DETAILS
- 26.-32. CROSS SECTIONS

PROJECT SURVEY CONTROL

SEE PAVING PLANS FOR CONTROL POINTS

BM - CHS 7th SOUTH SIDE CONC. LP BASE 340th EAST
OF DILLARD'S EAST ENTRANCE. ELEVATION=173.76

**CITY OF WICHITA PROJECT NO. 472-83222
OCA NO. 765636**

GENERAL NOTES

THE CONTRACTOR SHALL BE REQUIRED TO COORDINATE HIS WORK WITH OTHER CONTRACTORS, INCLUDING, BUT NOT LIMITED TO, UTILITY COMPANIES, JAYHAWK PIPELINE, AND THE SITE CONTRACTOR FOR KELLOGG MALL ADDITION.

UNDERGROUND UTILITY SERVICE LINES AND OVERHEAD UTILITY POLE LINES ARE TO BE ADJUSTED AS NECESSARY BY OTHERS PRIOR TO CONSTRUCTION UNLESS THE PLANS SPECIFICALLY CALL FOR THEIR ADJUSTMENT BY THE CONTRACTOR. EXISTING UTILITIES AND THEIR LOCATION, AS SHOWN ON THE PLANS, REPRESENT THE BEST INFORMATION OBTAINABLE FOR DESIGN. LOCATION INFORMATION HAS BEEN OBTAINED FROM THE VARIOUS UTILITY COMPANIES AND IS EITHER FROM COMPANY RECORD DRAWINGS OR COMPANY PROVIDED FIELD LOCATIONS. THE CONTRACTOR WILL BE REQUIRED TO WORK AROUND EXISTING UTILITIES WITHIN THE RIGHT-OF-WAY WHICH DO NOT CONFLICT WITH PROPOSED CONSTRUCTION.

TREES AND SHRUBS IN PUBLIC RIGHT-OF-WAY WHICH ARE IN DIRECT CONFLICT WITH PROPOSED NEW CONSTRUCTION SHALL BE REMOVED BY THE CONTRACTOR WITH THE ENGINEER'S APPROVAL. TREES AND SHRUBS WHICH ARE NOT IN DIRECT CONFLICT WITH PROPOSED NEW CONSTRUCTION SHALL BE SAVED AND PROTECTED FROM DAMAGE.

THE LUMP SUM BID ITEM "SITE CLEARING" SHALL INCLUDE THE REMOVAL OF THE TREES, SIGNS, AND TRAFFIC SIGNAL EQUIPMENT WHICH ARE IN DIRECT CONFLICT WITH PROPOSED NEW CONSTRUCTION, AS WELL AS ANY INCIDENTALS.

RUBBLE FROM THE REMOVAL OF MISCELLANEOUS STRUCTURES SHALL BE DISPOSED OF ON SITES TO BE PROVIDED BY THE CONTRACTOR AND APPROVED AS NOTED BELOW.

ALL DISPOSAL SITES MUST BE APPROVED BY THE KANSAS DEPARTMENT OF HEALTH AND ENVIRONMENT. MATERIAL EITHER STOCKPILED OR DISPOSED OF IN A FLOOD PLAIN WOULD REQUIRE A KANSAS STATE BOARD OF AGRICULTURE PERMIT. ANY MATERIAL DUMPED IN WATERS OF THE UNITED STATES OR WETLANDS IS SUBJECT TO U.S. CORPS OF ENGINEERS PERMITTING REGULATIONS. ANY MATERIAL BURIED OR STOCKPILED BEYOND APPROVED CONSTRUCTION LIMITS WOULD REQUIRE ADDITIONAL ARCHEOLOGICAL INVESTIGATIONS UNLESS BURIED IN A PREVIOUSLY APPROVED BORROW LOCATION.

CONTRACTOR SHALL SATISFY HIMSELF OF SURFACE AND SUBSURFACE CONDITIONS PRIOR TO BIDDING.

CONTRACTOR SHALL PROVIDE A MINIMUM FORTY-EIGHT (48) HOUR ADVANCE NOTICE (EXCLUDING WEEKENDS AND HOLIDAYS) PRIOR TO BEGINNING ANY EXCAVATION, TO KANSAS ONE-CALL SYSTEM, A UTILITY LOCATION SERVICE, AT (316) 687-2470 TO REQUEST THE FOLLOWING UTILITY COMPANIES TO LOCATE ALL EXISTING LINES WITHIN THE PROJECT AREA: K.G.S GAS, JAYHAWK PIPELINE, K.G.E. ELECTRIC, SOUTHWESTERN BELL TELEPHONE, COX COMMUNICATIONS, CITY OF WICHITA SEWER MAINTENANCE AND CITY OF WICHITA WATER DEPARTMENT.

THE CONTRACTOR SHALL BE RESPONSIBLE FOR PRESERVING PROPERTY IRONS. THE CONTRACTOR WILL BE REQUIRED TO RE-ESTABLISH ANY PROPERTY IRONS WHICH ARE DAMAGED OR DESTROYED BY HIS CONSTRUCTION OPERATIONS, OR WHICH ARE COVERED BY 12" OR MORE OF FILL MATERIAL BY THIS PROJECT. SUCH IRONS SHALL BE RE-ESTABLISHED BY A LICENSED LAND SURVEYOR IN ACCORDANCE WITH STATE LAWS AND AT NO ADDITIONAL COST TO THE OWNER.

THE WATER DEPARTMENT SHALL FIELD LOCATE WATER VALVES ONE TIME DURING CONSTRUCTION WHEN REQUESTED BY THE CONTRACTOR. IT SHALL BE THE CONTRACTOR'S RESPONSIBILITY TO PRESERVE SUCH FIELD LOCATIONS DURING THE CONSTRUCTION PROCESS. WATER VALVES, WATER VALVE BOXES OR FIRE HYDRANTS DAMAGED DURING CONSTRUCTION SHALL BE REPAIRED BY THE CONTRACTOR AT HIS OWN EXPENSE.

THE CONTRACTOR SHALL ADJUST WATER VALVE BOXES AS DIRECTED BY THE ENGINEER. THIS WORK TO BE SUBSIDIARY TO OTHER BID ITEMS.

INLET HOOKUPS SHALL BE BID PER EACH REGARDLESS OF INLET SIZE.

THIS PROJECT DOES NOT INCLUDE ANY PROVISIONS FOR CONSTRUCTION OF DRIVEWAYS.

A FULL DEPTH SAW CUT SHALL BE PROVIDED IN CURB AND GUTTER AND/OR SIDEWALK AT THE REMOVAL LIMIT SHOWN ON THE PLANS. THE LIMITS OF REMOVAL SHALL EXTEND TO THE EXISTING JOINT IF A JOINT IS WITHIN 3 FEET OF THE PLAN REMOVAL LIMITS. CUTS SHALL BE CONSIDERED SUBSIDIARY TO THE BID ITEM "PAVEMENT REMOVAL".

ALL DISTURBED AREAS SHALL BE SEEDED, FERTILIZED AND MULCHED IN ACCORDANCE WITH THE CITY OF WICHITA STANDARD SPECIFICATIONS.

— PEG —
SCALE: 1" = 150'

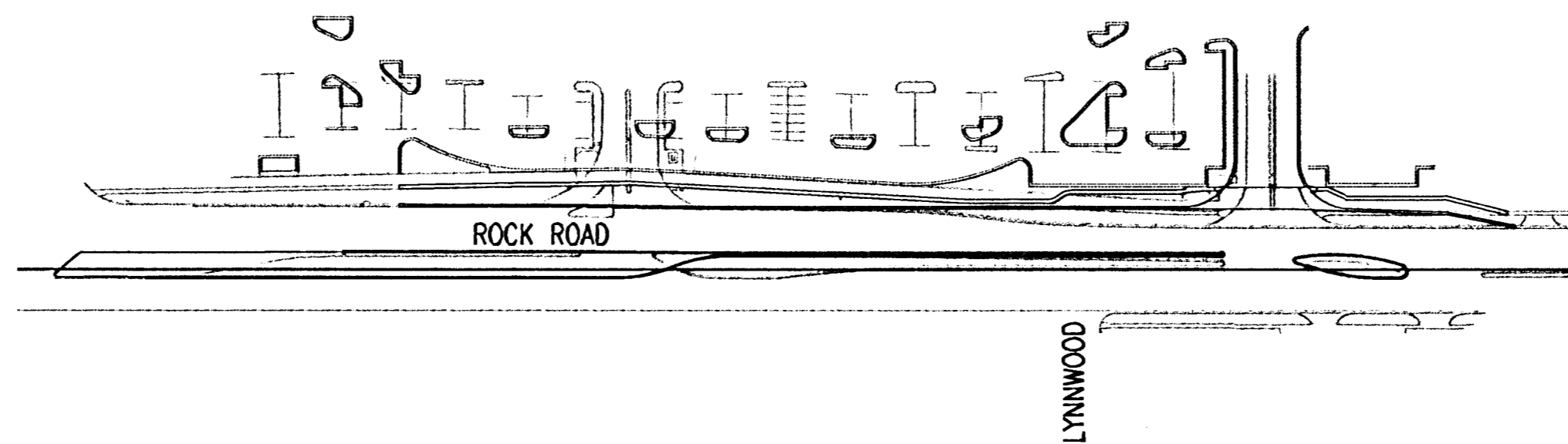

EARTHWORK

EXCAVATION 755 CU. YDS.
COMPACTED FILL 170 CU. YDS.
CONTRACTOR FURNISHED BORROW 504 CU. YDS.
PROJECT LENGTH = 1,480 LIN. FT.

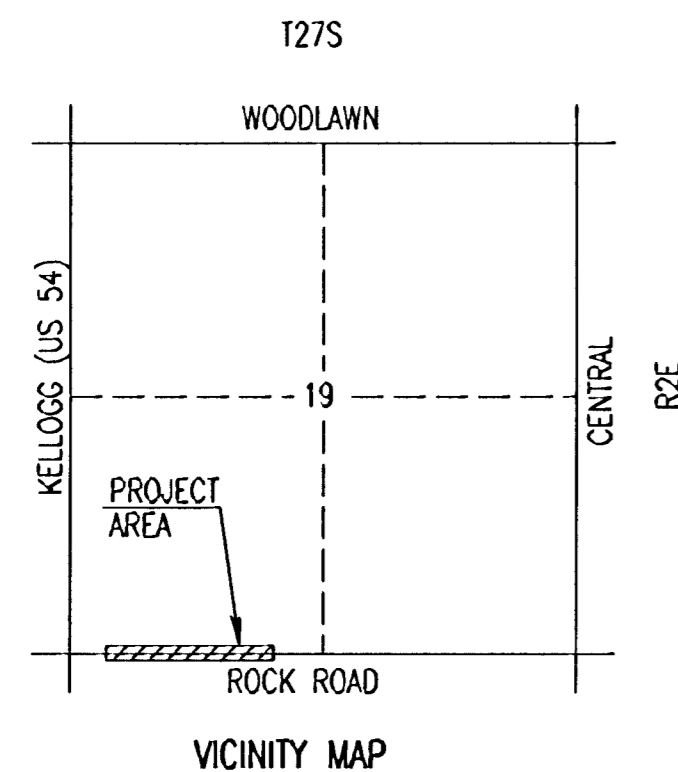

JUNE 2000

**PLANS PREPARED BY
PROFESSIONAL ENGINEERING CONSULTANTS, P.A.
ENGINEERS
WICHITA, KANSAS**

