

TYPE 170 CONTROLLER SETTINGS

INTERVAL	"WAPITI PROGRAM"								NORMAL DISPLAY							
	PHASE								TIME CLOCK				FEATURES			
	1	2	3	4	5	6	7	8	C				F			
MAX	0	0	30	0	30	0	0	0	0	YEAR	VEH RECALL	X	X			
MAX 2	1	0	30	0	30	0	0	0	0	MONTH	PED RECALL	X	X			
WALK	2	0	7	0	7	0	0	0	0	DAY/MONTH	RED LOCK					
FL DW	3	0	13	0	12	0	0	0	0	DAY/WEEK	YEL LOCK					
MAX INIT.	4	0	19	0	19	0	0	0	0	HOUR	Ø PERMIT	X	X			
MIN GREEN	5	0	18	0	18	0	0	0	0	MINUTE	PED PHASES					
TBR	6	0	0	0	0	0	0	0	0	SECOND	LEAD PHASES	X	X	X	X	
TTR	7	0	0	0	0	0	0	0	0		DBL ENTRY					
	8										SEQUENTIAL					
PASSAGE	9	0.0	0.0	0.0	0.0	0.0	0.0	0.0	0.0		START UP					
MIN GAP	a	0.0	0.0	0.0	0.0	0.0	0.0	0.0	0.0		OVERLAP A					
ADD ACT	b	0.0	0.0	0.0	0.0	0.0	0.0	0.0	0.0		OVERLAP B					
YELLOW	c	0.0	3.0	0.0	3.0	0.0	0.0	0.0	0.0		OVERLAP C					
RED CLR	d	0.0	1.0	0.0	1.0	0.0	0.0	0.0	0.0		OVERLAP D					
RED REV	e	0.0	0.0	0.0	0.0	0.0	0.0	0.0	0.0		EXCLUSIVE					
WALK II	f	0	0	0	0	0	0	0	0		SIM GAP					

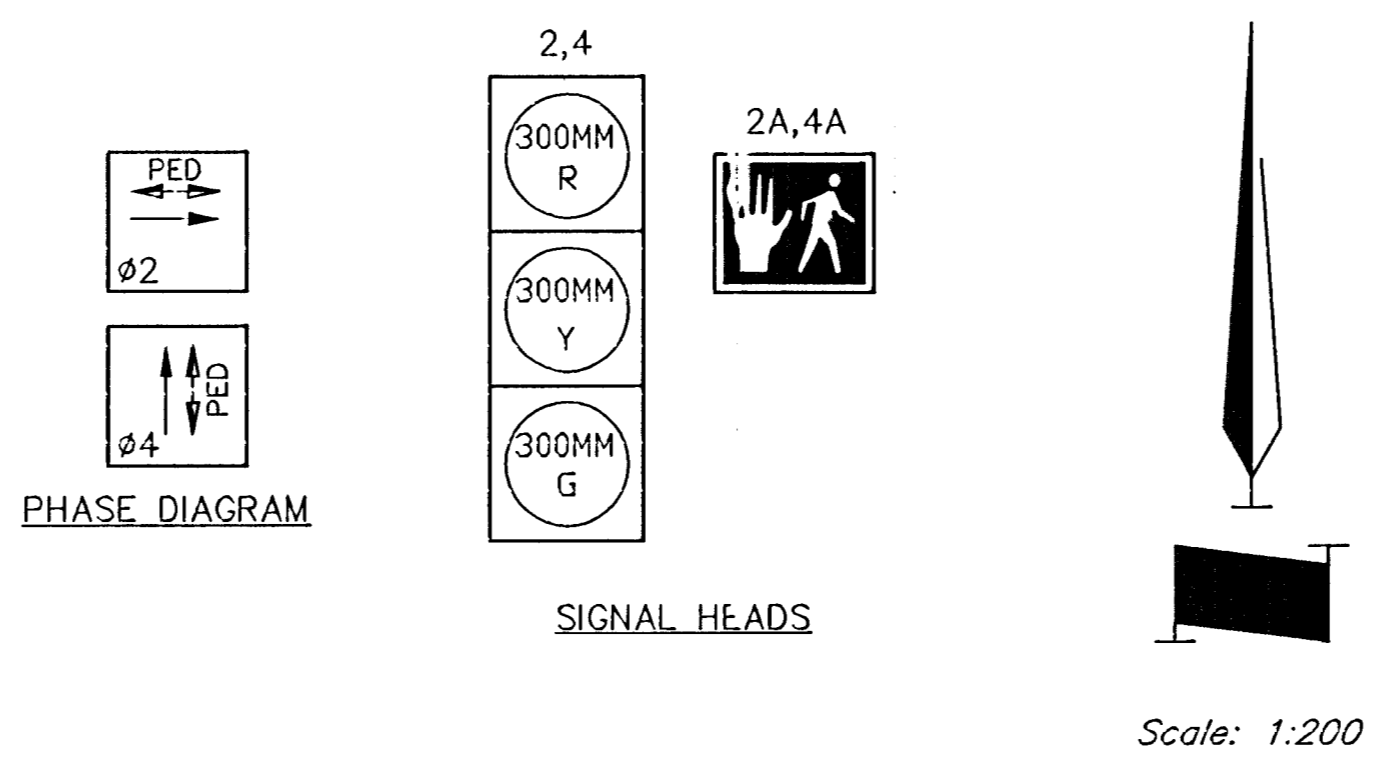

TRAFFIC SIGNAL POLE SUMMARY										
POLE NO.	STATION	OFFSET/SIDE	TYPE ①	ARM LENGTH	X1	X2	ARM BRACKET		POLE BRACKET TYPE	REMARKS
							TYPE	NO.		
1	40+007.5	9.63m Lt.	D	-	-	-	-	-	II	②
2	40+010.4	10.02m Rt.	C	1.30m	3.30m	-	-	1	2	② ③ ④
3	39+992.4	12.39m Rt.	C	10.0m	3.30m	-	-	1	2	② ③ ④
4	39+992.2	10.30m Lt.	D	-	-	-	-	-	II	②

- ① A - Pedestal Pole (4.5m [15'] Aluminum)
 B - Pole (6.0m [20'] Steel with Mast Arm)
 C - Joint use Pole (9.1m [30'] Steel with Mast Arm)
 D - Joint use Pole (9.1m [30'] Steel)
- ② R6-1 Sign
 ③ Meter & Controller Pole Mounted
 ④ Street Name Sign

LEGEND		
Proposed	Existing	
☒	☒	Traffic Signal Controller
→	→	Signal Traffic Head
→	→	Signal Traffic Head with Backplate
⊙	⊙	Pedestrian Signal Head
⊙	⊙	Traffic Signal Pole
☀		Luminaire
Ⓜ		Movement Number
⊗		Pole Number
⊥		Street Name Sign
☐	☐	Signal Service Box
⊠	⊠	Westar Energy Manhole
•	•	Westar Energy Wood Pole
○	○	Westar Energy Metal Pole
●	●	SWB Wood Pole
○	○	City Metal Pole
FH	FH	Fire Hydrant
WV	WV	Water Valve
		Pavement & Walk Removal

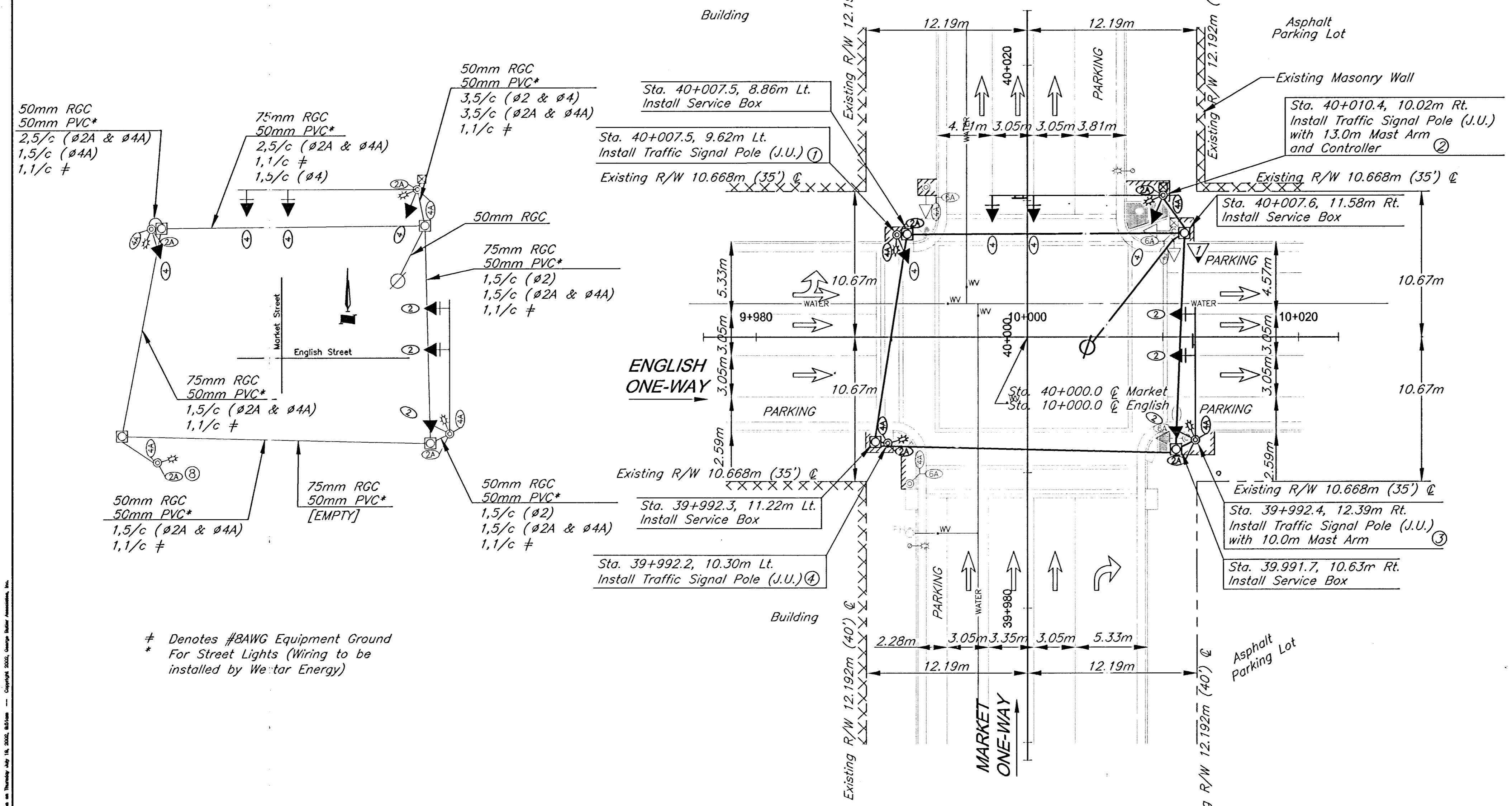

Denotes #BAWG Equipment Ground
 * For Street Lights (Wiring to be installed by Westar Energy)

UTILITIES	
Power	KGE Electric
Telephone	Southern Bell Telephone Co.
Cable TV	Multimedia Cablevision
Water	City of Wichita
Sanitary Sewer	City of Wichita
Gas	Peoples Natural Gas
Telecommunications	Wichita Public Schools

NOTES:
 Existing underground (U/G), overhead (O.H.) utilities and drainage structures have been plotted from available information and therefore, their locations must be considered approximate only. It is the responsibility of the individual contractors to exactly locate each utility before actual construction.

Poles to be galvanized prior to black powder coating. Joint-use poles are to be drilled for credenza fixture.

Communication Cable shall be pulled back to existing Westar Energy manhole. Contractor to install underground splice and re-route communication cable through new service box to new controller.

CONSTRUCTION NOTES:
 Power currently supplied to traffic signal pole on Northeast corner. Contractor to extend existing conduit into proposed service box for hook-up.

METER ADDRESS:
 202 E. English

NO.	DATE	REVISIONS	BY	APP'D
3	08/25/2002	PER CITY/ KDOT COMMENTS	RLC	SAC
2	05/22/2002	PER CITY/ KDOT COMMENTS	JDB	SAC
1	02/01/2002	PER CITY/ KDOT COMMENTS	JDB	SAC

CITY OF WICHITA, KANSAS
 SEDGWICK COUNTY
 TRAFFIC SIGNAL PLAN
 MARKET & ENGLISH

PROJECT NO. 472-83419

GBA GEORGE BUTLER ASSOCIATES, INC.
 Engineers - Architects

DESIGNED	SAC	CHECKED	SAC	PROJ. NO.	9674.00
DRAWN	JDB			DATE	Dec. 10, 2001