

FHWA REG NO.	STATE	PROJECT NO.	YEAR	SHEET NO.	SHEETS
7	KANSAS	472-83084	2000	6	58

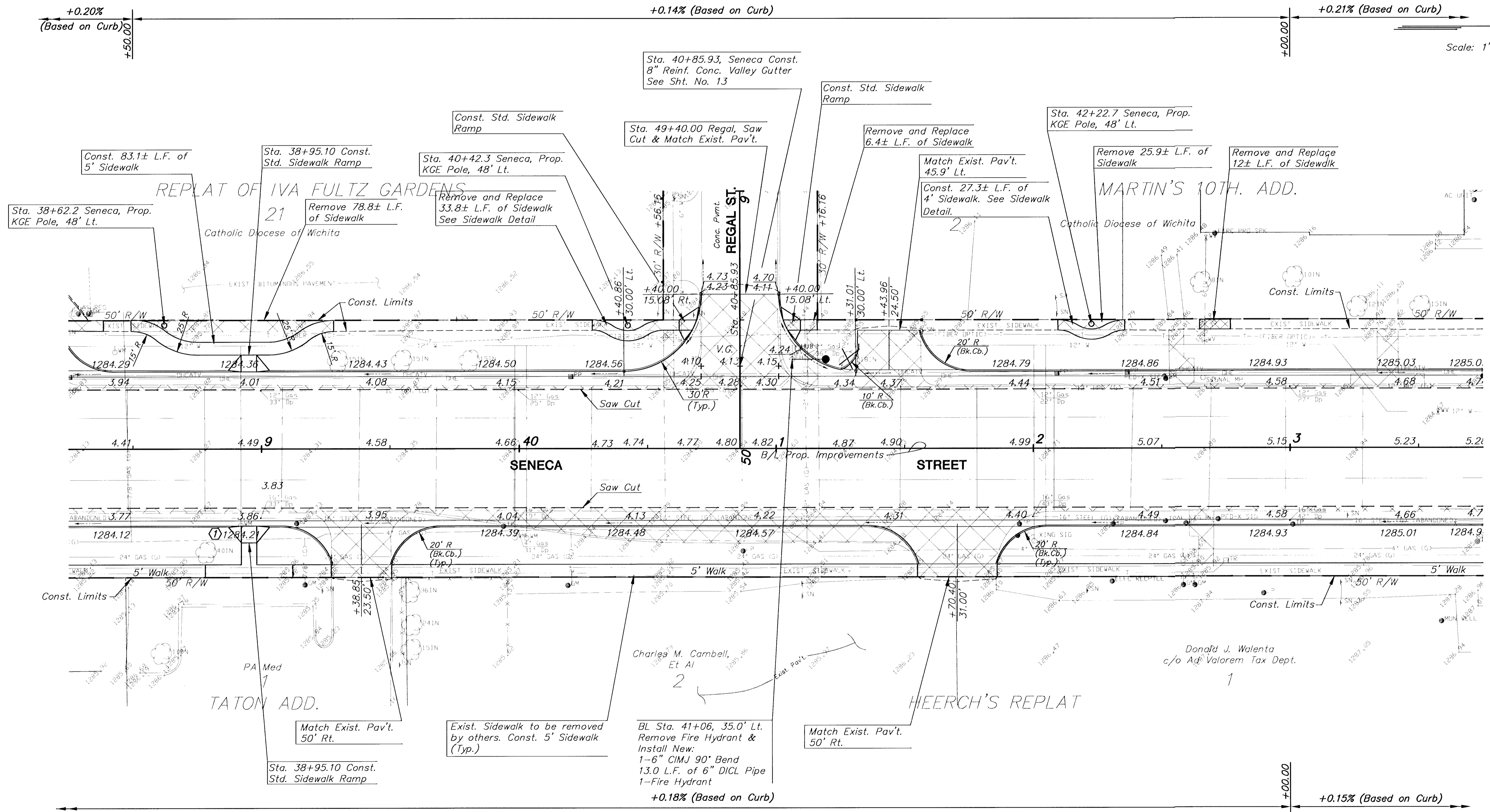

+0.20%
(Based on Curb)
+50.00

+0.14% (Based on Curb)

+0.21% (Based on Curb)
+00.00

Scale: 1" = 20'

① = New 1" Service Lines are to be installed from the existing 12" Main to the New Coppersettlers, Meter Boxes and Lids being installed behind the new curb line.

LEGEND

 PAVEMENT, DRIVEWAY AND/OR SIDEWALK REMOVAL.

- UTILITY OWNERS**
- G - Kansas Gas Service (316)383-8600
 - W - City of Wichita Water & Sewer Department (316)268-4940
 - T - Southwestern Bell Telephone Co. (800)246-8464, press ## for assistance
 - E - Kansas Gas and Electric (316)383-8600
 - CATV - Cox Communications (316)262-4270
 - SS - City of Wichita Water & Sewer Department (316)268-4940
 - SWS - City of Wichita Stormwater Utility (316)268-4071

KANSAS DEPARTMENT OF TRANSPORTATION

**SOUTH SENECA STREET
38+50 TO 43+50**

PROJECT NO. 472-83084 SEDGWICK CO.

MID-KANSAS ENGINEERING CONSULTANTS, INC.
WICHITA, KANSAS

DESIGNED BY: DCH	CHECKED BY: DCH
DRAWN BY: WNJ	DATE: MAY 1, 2000 SHEET 6 OF 58

H:\ACT\11\SENECA\94005-2\PAV\94005E4.DWG Plot May 01 15:41:40 2000