

FHWA REG NO.	STATE	PROJECT NO.	YEAR	SHEET NO.	SHEETS
7	KANSAS	472-83084	2000	8	58

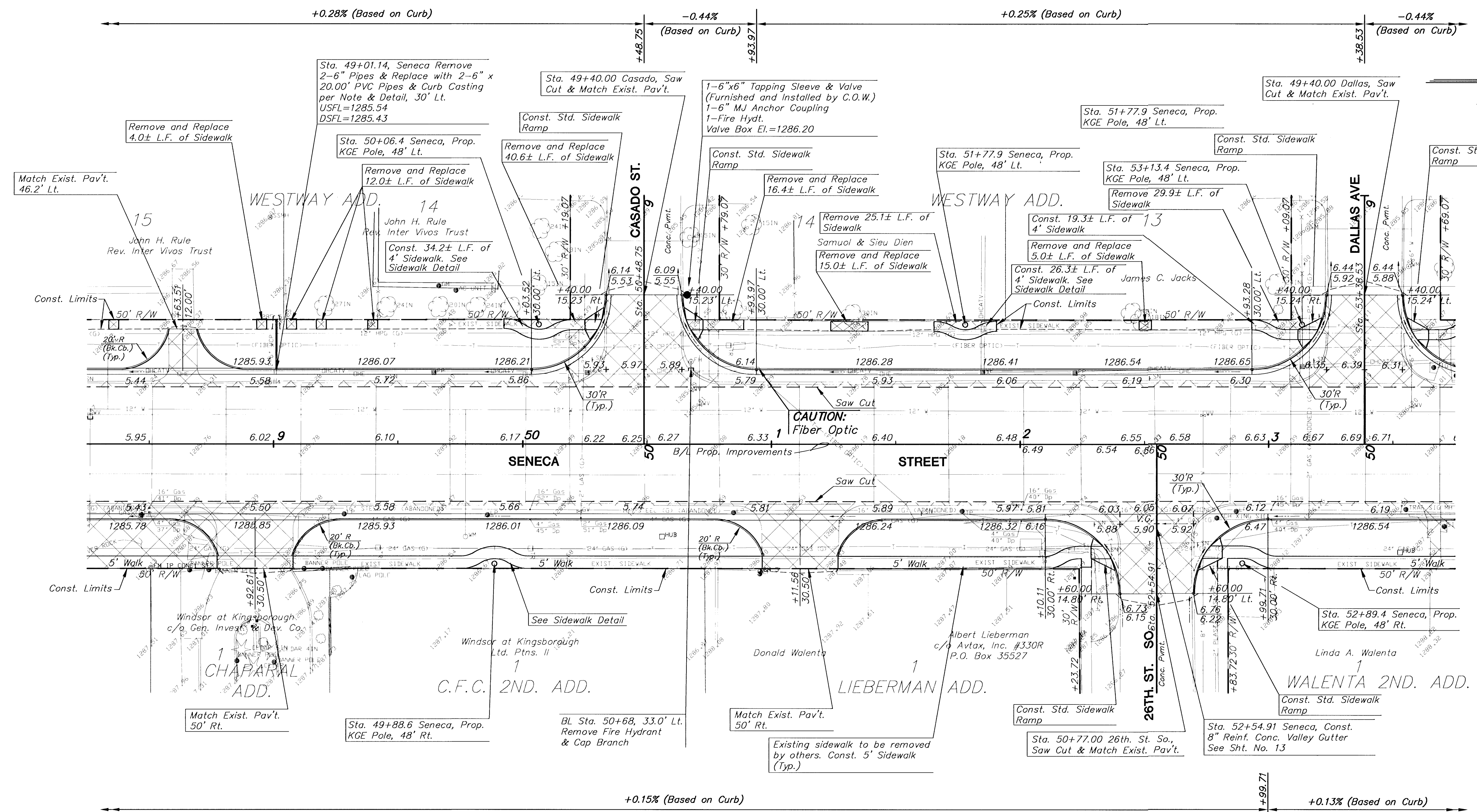

Scale: 1" = 20'

**UTILITY OWNERS**

- G - Kansas Gas Service (316)383-8600
- W - City of Wichita Water & Sewer Department (316)268-4940
- T - Southwestern Bell Telephone Co. (800)246-8464, press ## for assistance
- E - Kansas Gas and Electric (316)383-8600
- CATV - Cox Communications (316)262-4270
- SS - City of Wichita Water & Sewer Department (316)268-4940
- SWS - City of Wichita Stormwater Utility (316)268-4071

LEGEND  
 PAVEMENT, DRIVEWAY AND/OR SIDEWALK REMOVAL.

KANSAS DEPARTMENT OF TRANSPORTATION

**SOUTH SENECA STREET  
48+50 TO 53+50**

PROJECT NO. 472-83084 SEDGWICK CO.

**MID-KANSAS ENGINEERING CONSULTANTS, INC.**  
WICHITA, KANSAS

DESIGNED BY: DCH	CHECKED BY: DCH
DRAWN BY: WNJ	DATE: MAY 1, 2000 SHEET 8 OF 58

BM #5 "I" cut on the West side conc. light pole base. Sta. 50+95.53  
51.16' Rt. Elev.=1288.14

H:\CIVIL\SENECA\472-83084-2\PAV\472-83084-2.DWG Mon May 01 15:43:54 2000