

SCALE:  
 1" = 20' HORIZONTAL  
 1" = 5' VERTICAL

Remove & Replace Concrete Sidewalk As Necessary For Storm Sewer Construction. Contractor To Remove Concrete Sidewalk To The Nearest Construction Joint If Within 3' Of Joint. Saw Cut If Over 3' From Joint. Removal And Replacement Of Pavement Shall Not Be Paid For Directly, But Shall Be Considered Incidental To Other Items In The Project. See Note #4 Replacement.

Bench Mark:  
 Sheridan and McCormick  
 City of Wichita Bench Mark. Southeast corner of  
 intersection.  
 24.00 Ft. East of center line  
 48.30 Ft. South of center line  
 Elevation = 1299.76 (MSL)

Contractor Shall Follow All Applicable Best Management Practices (BMP) For Erosion Control.

Contractor To Use Extreme Caution When Excavating Near Utility Lines. Contractor To Hand Dig To Expose All Utility Lines Prior To Construction. Verify Depth To Determine Conflict If Any.

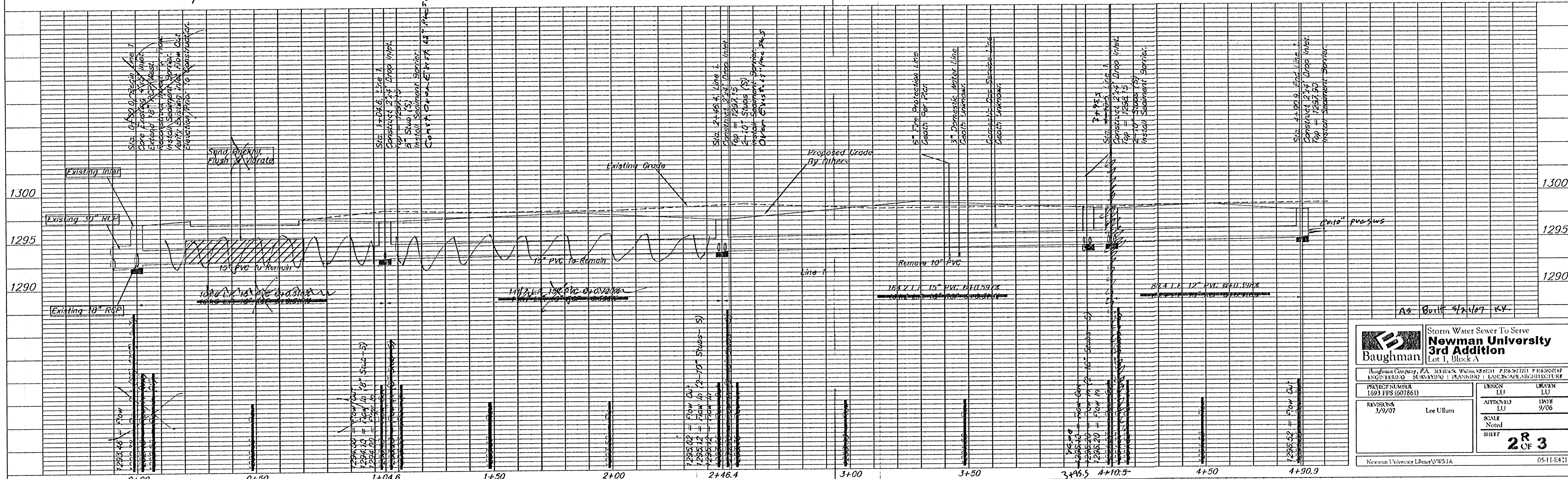

		<b>Storm Water Sewer To Serve Newman University 3rd Addition</b> Lot 1, Block A	
<small>Engineering Company, P.A. 315 Elm St., Wichita, KS 67211 P. 316.261.7271 F. 316.261.4749</small> <small>ENGINEERING SURVEYING PLANNING LANDSCAPE ARCHITECTURE</small>			
PROJECT NUMBER 1693 FFS (607861)	REVISIONS 3/9/07	LEE ULLUM	LESSON LU
APPROVED LU		DATE 9/06	DRAWN LU
SCALE Noted		SHEET <b>2 OF 3</b>	
<small>Newman University Library/SWS18</small>			<small>05-11-E421</small>