

SW Cor. Sec. 33, T26S, R2E

W 1/4 Cor. Sec. 33, T26S, R2E

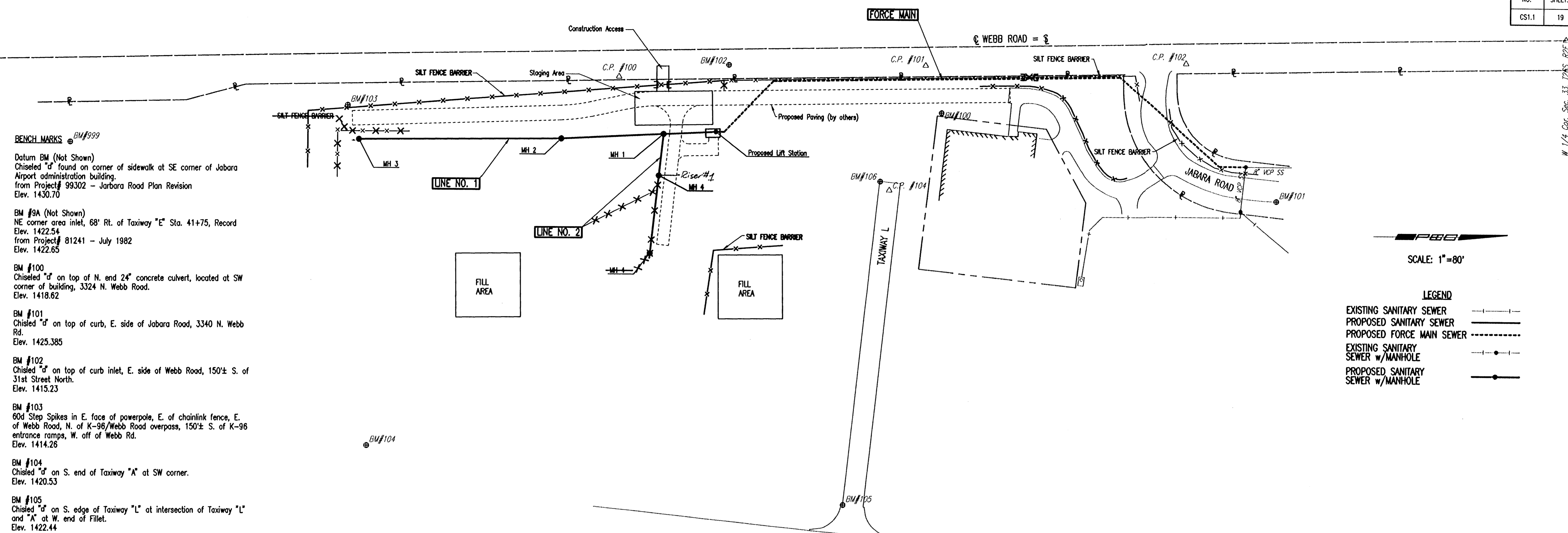

**BENCH MARKS** BM #999  
 Datum BM (Not Shown)  
 Chiseled "d" found on corner of sidewalk at SE corner of Jabara Airport administration building from Project # 99302 - Jarbara Road Plan Revision Elev. 1430.70

BM #9A (Not Shown)  
 NE corner area inlet, 68' Rt. of Taxiway "E" Sta. 41+75, Record Elev. 1422.54  
 from Project # 81241 - July 1982 Elev. 1422.65

BM #100  
 Chiseled "d" on top of N. end 24" concrete culvert, located at SW corner of building, 3324 N. Webb Road. Elev. 1418.62

BM #101  
 Chiseled "d" on top of curb, E. side of Jabara Road, 3340 N. Webb Rd. Elev. 1425.385

BM #102  
 Chiseled "d" on top of curb inlet, E. side of Webb Road, 150'± S. of 31st Street North. Elev. 1415.23

BM #103  
 60d Step Spikes in E. face of powerpole, E. of chainlink fence, E. of Webb Road, N. of K-96/Webb Road overpass, 150'± S. of K-96 entrance ramps, W. off of Webb Rd. Elev. 1414.26

BM #104  
 Chiseled "d" on S. end of Taxiway "A" at SW corner. Elev. 1420.53

BM #105  
 Chiseled "d" on S. edge of Taxiway "L" at intersection of Taxiway "L" and "A" at W. end of Fillet. Elev. 1422.44

BM #106  
 Chiseled "d" at SW corner at W. end of Taxiway "L". Elev. 1419.91

**CONTROL POINTS** C.P. #999

CP #100 N-393,577.2380, E-368,629.0740  
 Mag Nail in C of concrete driveway approach E. off of Webb Road  
 In line, Centerline of drive at face of sidewalk  
 First drive going E. and N. of K-96  
 Across from 3121 N. Webb Road

CP #101 N-394092.9030, E-368606.1730  
 #4 Bar C of E. side of curb inlet on the E. side of Webb Road  
 75'± N. of 31st Street North  
 No ties taken

CP #102 N-394,531.3820, E-368,600.5200  
 #4 Bar on E. side of Webb Road, N. of S. entrance to Jabara Airport.  
 17.80' N, SE corner of curb inlet  
 51.00' S, to centerline of Jabara Road, E. off of Webb Road  
 8.00' W, E. back of curb of Webb Road

CP #104 N-394,033.4990, E-368,815.9720  
 2" Mag Nail in conc. joint 135' E. of the W. end in centerline of Taxiway "L".  
 No ties taken

**GENERAL NOTES**

- ALL ELEVATIONS SHOWN ARE U.S.G.S. DATUM (NGVD29)
- CONTRACTOR WILL BE REQUIRED TO PROVIDE A MINIMUM ADVANCE NOTICE OF FORTY-EIGHT (48) HOURS TO UTILITY COMPANIES PRIOR TO STARTING ANY EXCAVATION AS FOLLOWS:  

KANSAS ONE-CALL	687-2470
THE CONTRACTOR MUST NOTIFY THE FOLLOWING IN CASE OF AN EMERGENCY:	
WAA	946-4740
COX COMMUNICATIONS	262-0661
KANSAS GAS SERVICE	832-3169
WESTAR ENERGY	383-8600
AQUILA NETWORK	1(800)-527-0357
SBC	1(800)-870-8390
CITY OF WICHITA WATER DEPARTMENT	262-6000
CITY OF WICHITA SEWER MAINTENANCE	262-6000
- ALL CONSTRUCTION AND MATERIALS TO COMPLY WITH THE PROJECT SPECIFICATIONS AND STANDARDS.
- THE CONTRACTOR SHALL NOT START WORK ON THE PROJECT UNTIL THE PROJECT INSPECTOR IS ASSIGNED TO THE PROJECT AND IS PRESENT ON THE SITE. ANY WORK DONE WITHOUT INSPECTION WILL BE REQUIRED TO BE UNCOVERED FOR INSPECTION.
- WITHIN THREE (3) FEET OF AN EXISTING UTILITY THE CONTRACTOR SHALL EXPOSE THE UTILITY TO VIEW BY HAND OR OTHER MEANS SO AS TO NOT DAMAGE THE UTILITY. IT IS THE CONTRACTOR'S RESPONSIBILITY TO CONTACT KANSAS ONE-CALL (1-800-344-7233) PRIOR TO WORK IN AN AREA AND FOLLOW THE REQUIREMENTS REGARDING TIME ALLOWED TO MARK THE UTILITIES FROM THE NOTICE.  
 THE CONTRACTOR SHALL BE RESPONSIBLE FOR ANY DAMAGE TO AN EXISTING UTILITY AS WELL AS ANY COSTS ASSOCIATED WITH INTERRUPTION OF SERVICE OR LOSS OF BUSINESS FROM THE DAMAGED UTILITY. THE OWNER'S ADMINISTRATIVE FEE FOR WORKING THE DAMAGE UTILITY AND PROCESSING THE PAPERWORK IS 12%. THIS FEE WILL BE INCLUDED ON THE BILL SENT TO THE CONTRACTOR.  
 IT IS THE RESPONSIBILITY OF THE CONTRACTOR TO NOTIFY THE OWNER OF EVERY UTILITY COMPANY THAT HAS A UTILITY IN THE AREA OF THE EXCAVATION NOT LESS THAN 24 HOURS OR MORE THAN 72 HOURS PRIOR TO EXCAVATING. THE CONTRACTOR SHALL MAINTAIN AND KEEP CURRENT A WRITTEN LOG OF EVERY CONTACT, WHEN AND HOW IT WAS MADE, WHO IT WAS MADE TO, THE RESPONSE OF THE UTILITY, ETC. A COPY OF SUCH LOG SHALL BE PROVIDED TO THE OWNER WITHIN FOUR (4) HOURS OF THE REQUEST.  
 THE CONTRACTOR WILL BE RESPONSIBLE TO PROTECT AT ALL TIMES AND LOCATE UPON REQUEST THE NEW UTILITIES PLACED AS A PART OF THIS PROJECT UNTIL FINAL ACCEPTANCE BY THE OWNER.

- THE CONTRACTOR SHALL BE RESPONSIBLE FOR PRESERVING PROPERTY AND LEASE IRONS. THE CONTRACTOR WILL BE REQUIRED TO RE-ESTABLISH ANY IRONS WHICH ARE DAMAGED OR DESTROYED BY HIS CONSTRUCTION OPERATIONS. SUCH IRONS SHALL BE RE-ESTABLISHED BY A LICENSED LAND SURVEYOR IN ACCORDANCE WITH STATE LAWS. ALL COSTS FOR THIS WORK SHALL BE SUBSIDIARY TO THE LUMP SUM PRICE BID FOR "SITE RESTORATION".
- CONTRACTOR SHALL PROVIDE POSITIVE DRAINAGE AWAY FROM ALL MANHOLE COVERS.
- MANHOLES SHALL BE TYPE "P" MANHOLES. MANHOLES SHALL BE CONSTRUCTED IN ACCORDANCE WITH THE STANDARD SPECIFICATIONS AND THE STANDARD DETAIL DRAWINGS.
- THE CONTRACTOR SHALL AVOID REMOVAL OR TRIMMING OF ANY TREES OR SHRUBS WHERE POSSIBLE. WHERE THE CONTRACTOR BELIEVES THE REMOVAL OR TRIMMING IS UNAVOIDABLE, HE SHALL COORDINATE SUCH WORK WITH THE ENGINEER. COSTS FOR TREE/SHRUB REMOVAL AND TRIMMING REGARDLESS OF SIZE SHALL BE CONSIDERED SUBSIDIARY TO THE LUMP SUM PRICE BID FOR "SITE CLEARING".
- THE CONTRACTOR SHALL PREVENT ANY CONSTRUCTION DEBRIS FROM ENTERING THE EXISTING SANITARY SEWER DURING CONSTRUCTION.
- THE CONTRACTOR SHALL GIVE ALL PROPERTY OWNERS AND/OR TENANTS OF DEVELOPED PROPERTY ABUTTING THE CONSTRUCTION OF THIS PROJECT A MINIMUM OF TEN (10) DAYS ADVANCE NOTICE PRIOR TO START OF CONSTRUCTION.
- CONTRACTOR IS REQUIRED TO MAINTAIN CONTINUOUS FLOW OF SEWAGE IN EXISTING MAINS AT ALL TIMES.
- THE CONTRACTOR SHALL NOT BURY MANHOLES THAT HAVE RIM ELEVATIONS WHICH ARE LOWER THAN EXISTING GROUND AT THE MANHOLE. THE GROUND AROUND SUCH MANHOLES AND ALONG THE SEWER ALIGNMENT SHALL BE BACKFILLED TO THE APPROXIMATE ELEVATION OF THE PROPOSED GROUND ELEVATION SHOWN ON THE PLAN/PROFILE SHEETS. THE CONTRACTOR SHALL PROVIDE DRAINAGE AWAY FROM THESE MANHOLES AND SEWER LINES BY CONSTRUCTION OF TEMPORARY DITCHES OR SLOPING THE GROUND AS REQUIRED. ALL COSTS FOR THIS WORK SHALL BE CONSIDERED SUBSIDIARY TO THE INSTALLED BID PRICE FOR MANHOLES OR PIPE.
- THE CONTRACTOR SHALL PROVIDE MOUNDING EARTH AT MANHOLES AND CLEANOUTS THAT HAVE TOP ELEVATIONS GREATER THAN 1 FOOT ABOVE EXISTING GRADE, AS SHOWN ON THE PLANS. COSTS FOR MOUNDING SHALL BE CONSIDERED SUBSIDIARY TO THE PRICE BID PER EACH FOR MANHOLES. MOUNDING EARTH SHALL HAVE 1:15 SLOPE.
- WHERE INDICATED IN THE PLANS, THE SANITARY SEWER EXCAVATION SHALL BE SAND FILLED AND FLUSHED (JETTED AND VIBRATED) WITH WATER PER THE REQUIREMENTS LISTED IN THE STANDARD SPECIFICATIONS FOR THE CITY OF WICHITA, UNLESS FLOWABLE FILL OR OTHER IMPROVED BACKFILL MATERIAL IS OTHERWISE SPECIFIED. ALL COSTS FOR SAND FILLING AND FLUSHING SHALL BE INCLUDED IN TO THE UNIT PRICE BID FOR "JETTED SAND BACKFILL"

- THE CONTRACTOR SHALL RESTORE ALL DITCHES, SWALES, ROAD SHOULDERS, ENTRANCES, AND BANKLINES TO THEIR ORIGINAL SLOPES AND GRADES EXCEPT AS SHOWN OTHERWISE.
- INTERURBAN TRAFFIC GENERATED OUTSIDE THE PROJECT AREA AND LOCAL BUSINESS OR RESIDENTIAL TRAFFIC GENERATED WITHIN THE PROJECT AREA ARE TO BE CARRIED THROUGH CONSTRUCTION AS FURTHER PROMULGATED BY PROJECT SPECIAL PROVISIONS. THE CONTRACTOR SHALL UTILIZE BARRICADES, SIGNS, GUARDS, AND FLAGMEN IN ACCORDANCE WITH THE MANUAL ON UNIFORM TRAFFIC CONTROL DEVICES.
- RUBBLE FROM THE REMOVAL OF MISCELLANEOUS STRUCTURES INCLUDING ANY TREES REMOVED AND TREE TRIMMINGS AND EXCESS EXCAVATED MATERIAL SHALL BE DISPOSED OF ON SITES PROVIDED BY THE CONTRACTOR. THESE SITES SHALL ALSO BE APPROVED OF BY THE ENGINEER AS TO SUITABILITY, APPEARANCE, AND SITE LOCATION. LOCATIONS THAT, IN THE OPINION OF THE ENGINEER, LEAVE AN UNSIGHTLY APPEARANCE WILL NOT BE APPROVED. ALL DISPOSAL SITES MUST BE APPROVED BY THE KANSAS DEPARTMENT OF HEALTH AND ENVIRONMENT. MATERIAL EITHER STOCKPILED OR DISPOSED OF IN A FLOOD PLAIN WILL REQUIRE A KANSAS STATE BOARD OF AGRICULTURE PERMIT. ANY MATERIAL DUMPED IN WATERS OF THE UNITED STATES OR WETLANDS IS SUBJECT TO U.S. CORPS OF ENGINEERS PERMITTING REGULATIONS. ANY MATERIAL BURIED OR STOCKPILED BEYOND APPROVED CONSTRUCTION LIMITS MAY REQUIRE ARCHAEOLOGICAL INVESTIGATIONS UNLESS BURIED IN A PREVIOUSLY APPROVED DISPOSAL LOCATION.
- ALL APPROVED EXCESS EXCAVATION WHICH IS TO BE WASTED SHALL BE DISPOSED OF BY THE CONTRACTOR AT NO ADDITIONAL COST TO THE OWNER. STOCKPILE LOCATIONS SHALL BE IN ACCORDANCE WITH GENERAL NOTE NO. 18 ABOVE. APPROVED EXCESS EXCAVATED MATERIAL SHALL BE STOCKPILED ON AIRPORT PROPERTY AS DIRECTED BY THE WAA.
- EACH BIDDER SHALL VISIT THE SITE OF THE PROJECT BEFORE SUBMITTING THE PROPOSAL FOR THIS WORK SO THAT HE WILL BE FULLY INFORMED OF THE EXISTING FIELD CONDITIONS AND THE OBSTACLES WHICH MIGHT BE ENCOUNTERED. UPON AWARD OF THE CONTRACT THE CONTRACTOR WILL NOT BE GRANTED ANY ADDITIONAL COMPENSATION WITH REGARDS TO TIME AND MONEY FOR CONDITIONS THAT MAY HAVE BEEN EVALUATED DURING ANY INSPECTION OF THE SITE.
- THE CONTRACTOR SHALL SEED ALL AREAS DISTURBED BY CONSTRUCTION ACTIVITIES, INCLUDING ACTIVITIES DISTURBED BY PRIVATE UTILITY COMPANIES, WITH TEMPORARY RYE GRASS. RYE GRASS SEED SHALL BE PLANTED AT A MINIMUM RATE OF SIX (6) POUNDS PER ONE THOUSAND (1,000) SQUARE FEET. TEMPORARY SEEDING SHALL BE APPLIED WITHIN 14 DAYS AFTER THE AREA HAS BEEN DISTURBED.

- EROSION CONTROL (BMP'S)  
 THE CONTRACTOR SHALL INSTALL AND/OR MAINTAIN EROSION CONTROL METHODS AS SPECIFIED ON SHEETS CS.0-C5.3. THE FOLLOWING QUANTITIES ARE ESTIMATED, AND SHOULD BE CONSIDERED THE MINIMUM EFFORT REQUIRED. THE GENERAL LOCATION OF THE REQUIRED EROSION CONTROL IS ILLUSTRATED ON THE PROJECT KEY MAP. THE WATERLINE CONTRACTOR SHALL BE RESPONSIBLE FOR MAINTAINING THE EROSION CONTROL SHOWN THROUGH THE COMPLETION OF THIS PROJECT. INSTALLATION OF THESE BMP'S DOES NOT RELIEVE THE CONTRACTOR OF THE RESPONSIBILITY OF ABATING SOIL EROSION.  

SILT FENCE BARRIER	1156 LF.
CONSTRUCTION ENTRANCE	1 EACH
- FORCE MAIN CONSTRUCTION SHALL MEET ALL OF THE REQUIREMENTS OF THE WATERLINE CONSTRUCTION SPECIFICATIONS, INCLUDING TRACER WIRE, UNLESS OTHERWISE NOTED. APPROVED PIPE MATERIAL FOR THE FORCE MAIN SHALL BE ANWA C-900 DR-25 PIPE, PRESSURE CLASS 100 (MINIMUM). THE TEST PRESSURE OF THE COMPLETED FORCE MAIN SHALL BE 100 PSI.
- CONTRACTOR SHALL CONTACT AND COORDINATE WITH KANSAS GAS SERVICE AND WESTAR ENERGY TO INITIATE CONSTRUCTION OF PROPOSED GAS AND ELECTRIC UTILITY EXTENSION. THE COST FOR THE GAS AND ELECTRIC UTILITY SERVICES SHALL BE PAID FOR BY THE WICHITA AIRPORT AUTHORITY.  

KGS	ED KOHLER	832-3169
WESTAR ENERGY	SHANE PRICE	383-8600
- THERE SHALL BE NO CONSTRUCTION ON ANY PART OF THE PROJECT ON AUGUST 25, 26, AND 27.

SCALE: 1"=80'

**LEGEND**

EXISTING SANITARY SEWER ————

PROPOSED SANITARY SEWER ————

PROPOSED FORCE MAIN SEWER - - - - -

EXISTING SANITARY SEWER w/MANHOLE —●—●—

PROPOSED SANITARY SEWER w/MANHOLE —●—●—

*Bill Eichel* 20 JUN 07  
**RECORD DRAWING**

THE WICHITA AIRPORT AUTHORITY  
 COLONEL JAMES JABARA AIRPORT

KEY MAP AND GENERAL NOTES

SANITARY SEWER AND WATER DISTRIBUTION SYSTEM  
 SOUTHWEST AREA SITE DEVELOPMENT IMPROVEMENTS

**Professional Engineering Consultants, P.A.**  
 303 S. TOPEKA • WICHITA, KANSAS 67202  
 316-262-2691 • FAX 316-262-3003

Date SEPTEMBER 2005 Job No. 05471-019

S:\wtd 04-16-2007 4:57:50 PM by JLS  
 Plot Scale: 1:80 05-07-2007 10:06:49 AM by JLS  
 C:\2005\05471\Record Drawings\PS-Record Drawings\05471-000-C-SSKeyMap