

BENCHMARKS:
 BM #1: "□" Cut in top of curb, east
 return of SE corner of Lotus &
 Parkridge.
 Elev. = 145.99 (City Datum)

BM #2: "X" Cut on walk at NW corner
 of Lot 1, Block F, Flat Creek Addition
 Elev. = 146.22 (City Datum)

BM #3: "□" Cut in top of curb at the
 NW corner of Lot 1, Block B, Hunter's
 Ridge Addition.
 Elev. = 146.63 (City Datum)

P.V.I.
 Elev. = 147.70
 30.00' V.C.

Scale: 1" = 20'
 • = Iron

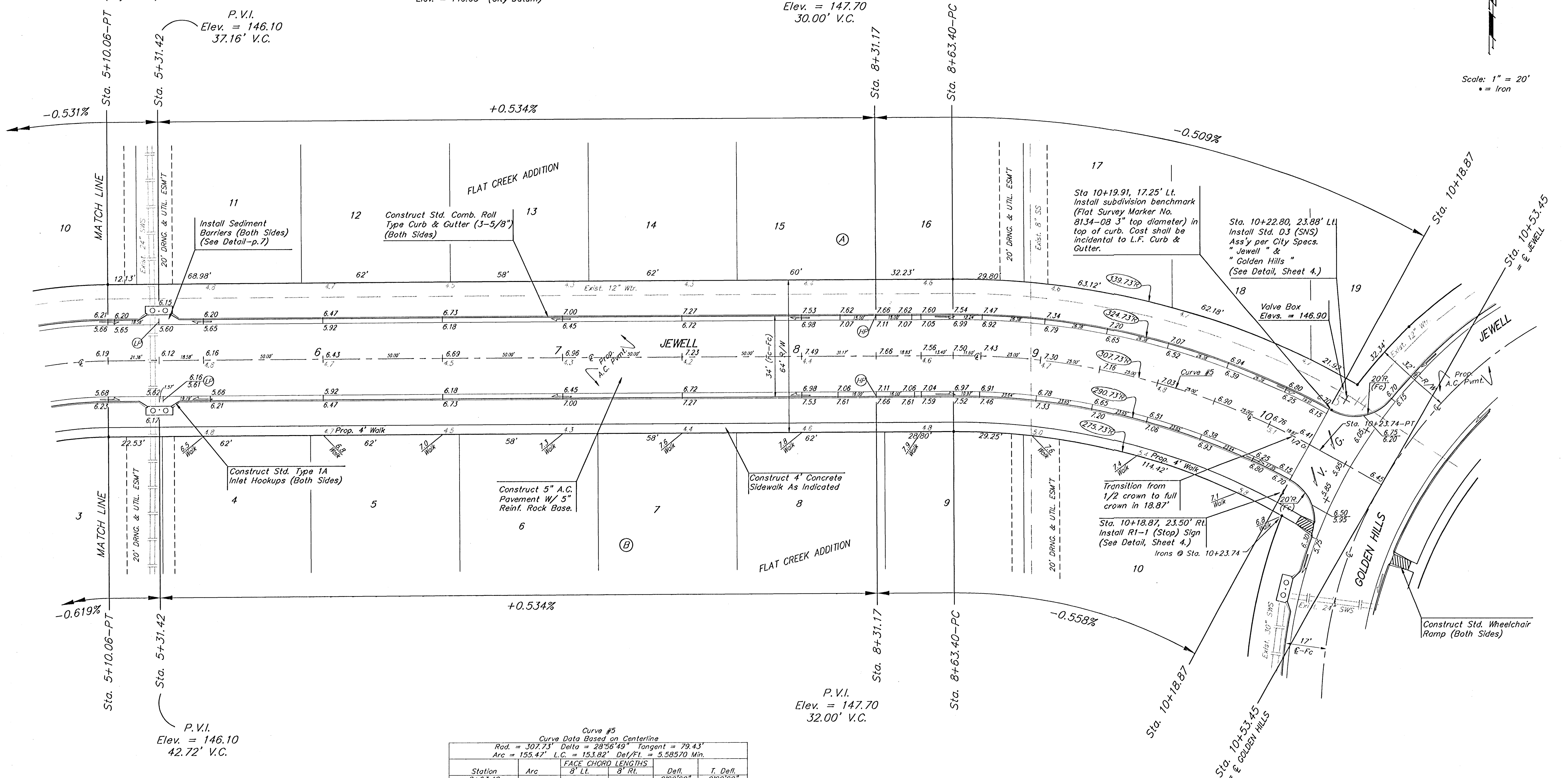

P.V.I.
 Elev. = 146.10
 42.72' V.C.

P.V.I.
 Elev. = 147.70
 32.00' V.C.

Curve #5
 Curve Data Based on Centerline
 Rad. = 307.73' Delta = 28°56'49" Tangent = 79.43'
 Arc = 153.47' L.C. = 153.82' Del./Ft. = 5.58570 Min.

Station	Arc	FACE CHORD LENGTHS		Defl.	T. Defl.
		B' Lt.	B' Rt.		
8+63.40	-	-	-	0°00'00"	0°00'00"
8+75.00	11.60'	12.54'	10.66'	1°04'48"	1°04'48"
9+00.00	25.00'	27.02'	22.96'	2°19'39"	3°24'26"
9+25.00	25.00'	27.02'	22.96'	2°19'39"	5°44'05"
9+50.00	25.00'	27.02'	22.96'	2°19'39"	8°03'43"
9+75.00	25.00'	27.02'	22.96'	2°19'39"	10°23'22"
10+00.00	25.00'	27.02'	22.96'	2°19'39"	12°43'00"
10+18.87	18.87'	20.40'	17.33'	1°45'24"	14°28'25"

NOTE: ROLL TYPE CURB & GUTTER TO BE CONSTRUCTED ON THE PAVEMENT SHOWN ON THIS SHEET. TOP OF CURB ELEVATIONS ARE GIVEN FOR FULL HEIGHT CURB.

FLAT CREEK ADDITION
JEWELL
 STA. 8+10.08 TO STA. 10+53.45

BAUGHMAN COMPANY P.A.
 ENGINEERING, SURVEYING, & PLANNING
 318-262-7271 • 315 ELLIS • WICHITA, KANSAS 67211

PROJECT NUMBER
472-83383

DESIGN: BP/TMG DRAWN: DC APPROVED: DATE: 08-01 SCALE: Noted

SHEET **10** OF **39**